

8100 SC 2 Zyklop Speed Ratchet Set, 1/2" drive, metric, 37 pieces

The Zyklop Speed Ratchet, 1/2"



EAN:	4013288121189	Size:	355x315x70 mm
Part number:	05003645001	Weight:	6340 g
Article number:	8100 SC 2	Country of origin:	CZ
		Customs tariff number:	82041200

- The Wera Zyklop Speed is a really fast mover
- Combines five different types of a ratchet in one
- 37-piece set in a robust metal case
- Freely pivoting ratchet head
- With Take it easy tool finder: colour coding by size

37-piece Zyklop set in robust metal case: Zyklop ratchet with 1/2" drive. The 72 fine-pitched teeth enable a low return angle of only 5°. The ratchet head pivots freely and can be locked into any position by using the slide switch that is positioned on either side. It is even possible to work conveniently in very confined and difficult-to-access areas with enhanced hand clearance. The predefined locking positions at 0°, 15° und 90°, both to the right and left, ensure safe working without any slipping of the ratchet head. The ratchet can be used as a conventional screwdriver in the 0° position by attaching an adaptor and a bit. The flywheel design ensures rapid screwdriving. The rotation-symmetric construction of the Kraftform handle and the free-turning sleeve support rapid twisting. The outstanding design of the Kraftform handle fits perfectly into the hand preventing hand injuries such as blisters and calluses. The hard materials used for the handle ensure quick and easy hand repositioning without any danger of the skin "sticking" to the handle. The softer anti-slip zones enable the low-loss transfer of high torque. For 1/2" square sockets as well as 1/2" adaptors with square drive, equipped with ball lock. Including 17 Zyklop sockets, 2 Zyklop extensions with free-turning sleeve, 1 T-handle, 1 wobble extension, 1 adaptor with quick-release chuck, 13 bits. "Take it easy" Tool Finder with colour coding according to sizes.

Web link

https://products.wera.de/en/ratchets_and_accessories_the_zyklop_ratchets_the_zyklop_ratchets_1_2_the_zyklop_speed_ratchet_1_2_8100_sc_2.html

Wera - 8100 SC 2
05003645001 - 4013288121189



Wera Werkzeuge GmbH
Korzerter Straße 21-25
D-42349 Wuppertal
Tel: +49 (0)2 02 / 40 45-0
E-Mail: info@wera.de

The Zyklop Speed Ratchet, 1/2"

Zyklop "6 in 1"



Incredibly fast 1/4" Zyklop Speed ratchet with pivoting ratchet head and 5 predefined locking positions



1. Fine-tooth ratchet 2. Flex-head ratchet 3. Angle ratchet 4. Quick-release ratchet 5. Power ratchet 6. Screwdriver

Pivots freely



The ratchet head pivots freely and can be locked into any defined position by using the slide switch that is positioned on either side. It is even possible to work in very confined and difficult-to-access areas with enhanced hand clearance. The predefined locking at 0°, 15° and 90°, both to the right and left, ensure safe working without any slipping of the ratchet head.

Fast movers



The Zyklop Speed ratchets are really fast movers. The gyrating mass design means that screwdriving is accelerated. The rotation-symmetric structure of the Kraftform handle and the free-turning sleeve reinforce this rapid twisting process, particularly when the ratchet does not engage due to too little resistance in the thread.

Simple direction change



All Zyklop Speed ratchets feature a thumbwheel that can be used to quickly and easily switch between clockwise and anticlockwise rotation, at any position. No complicated handling, no loss of time!

Low return angle

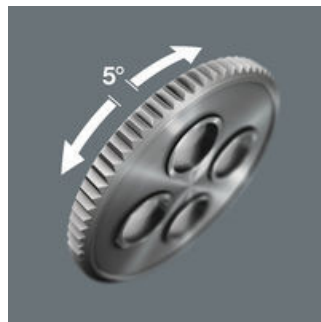

The reversible ratchet with 72 fine-pitched teeth has a low return angle of only 5°. This short stroke allows fast and precise work in all types of installation.

Screwdriver



The ratchet can be used as a conventional screwdriver in the 0° position by attaching a bitholding adaptor and a bit.

Two-tone foam insert



Perfectly conceived in every detail: the storage case for the Zyklop Speed ratchet sets! The two-tone foam insert section means that the tools can be quickly and reliably replaced, and that missing tools can be detected immediately. The tools and their position can be clearly seen in the lid where they have been laser-etched, ensuring that they are legible even when the insert section is covered with grease, dirt or oil. Additionally, the foam section can be removed and placed in the drawer of a tool cabinet or trolley.

Web link

https://products.wera.de/en/ratchets_and_accessories_the_zyklop_ratchets_the_zyklop_ratchets_1_2_the_zyklop_speed_ratchet_1_2_8100_sc_2.html

Wera - 8100 SC 2
05003645001 - 4013288121189

Wera Werkzeuge GmbH
Korzter Straße 21-25
D-42349 Wuppertal
Tel: +49 (0)2 02 / 40 45-0
E-Mail: info@wera.de

8100 SC 2 Zyklop Speed Ratchet Set, 1/2" drive, metric, 37 pieces



The Zyklop Speed Ratchet, 1/2"

Set contents:

8000 C Zyklop Speed Ratchet with 1/2" drive, 1/2" x 277 mm

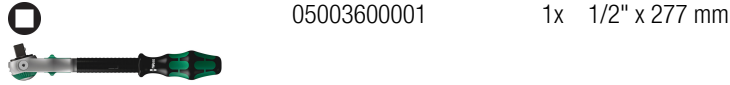

05003600001 1x 1/2" x 277 mm

8790 HMC Zyklop socket with 1/2" drive, 10 x 37 mm



05003601001 1x 10 x 37 mm
05003602001 1x 11 x 37 mm
05003603001 1x 12 x 37 mm
05003604001 1x 13 x 37 mm
05003605001 1x 14 x 37 mm
05003606001 1x 15 x 37 mm
05003607001 1x 16 x 37 mm
05003608001 1x 17 x 37 mm
05003609001 1x 18 x 37 mm
05003610001 1x 19 x 37 mm
05003611001 1x 20 x 37 mm
05003612001 1x 21 x 37 mm
05003613001 1x 22 x 37 mm
05003614001 1x 24 x 37 mm
05003615001 1x 27 x 40 mm
05003616001 1x 30 x 42 mm
05003617001 1x 32 x 42 mm

8789 C Zyklop sliding T-handle, 1/2", 1/2" x 250 mm



05003636001 1x 1/2" x 250 mm

8794 C Zyklop wobble extension, 1/2", 1/2" x 52 mm



05003639001 1x 1/2" x 52 mm

8795 C Zyklop universal joint, 1/2", 1/2" x 69 mm

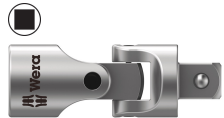

05003640001 1x 1/2" x 69 mm

8784 C2 Zyklop bit adaptor, 1/2", 5/16", 5/16" x 1/2" x 50 mm



05003641001 1x 5/16" x 1/2" x 50 mm

8796 SC Zyklop "flexible-lock" extension with free-turning sleeve, short, 1/2", 1/2" x 125 mm



05003642001 1x 1/2" x 125 mm

Web link

https://products.wera.de/en/ratchets_and_accessories_the_zyklop_ratchets_the_zyklop_ratchets_1_2_the_zyklop_speed_ratchet_1_2_8100_sc_2.html

Wera - 8100 SC 2
05003645001 - 4013288121189

Wera Werkzeuge GmbH
Korzter Straße 21-25
D-42349 Wuppertal
Tel: +49 (0)2 02 / 40 45-0
E-Mail: info@wera.de

8100 SC 2 Zyklop Speed Ratchet Set, 1/2" drive, metric, 37 pieces



The Zyklop Speed Ratchet, 1/2"

8796 LC Zyklop "flexible-lock" extension with free-turning sleeve, long, 1/2", 1/2" x 250 mm

	05003643001	1x	1/2" x 250 mm
---	-------------	----	---------------



851/2 Z bits, PH 3 x 32 mm

	05057715001	1x	PH 3 x 32 mm
---	-------------	----	--------------



855/2 Z bits, PZ 3 x 32 mm

	05058015001	1x	PZ 3 x 32 mm
---	-------------	----	--------------



867/2 Z TORX® bits, TX 25 x 35 mm

	05066900001	1x	TX 25 x 35 mm
	05066901001	1x	TX 20 x 35 mm
	05066905001	1x	TX 30 x 35 mm
	05066910001	1x	TX 40 x 35 mm
	05066915001	1x	TX 45 x 35 mm
	05066920001	1x	TX 50 x 35 mm
	05066925001	1x	TX 55 x 35 mm

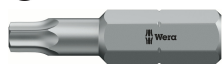

840/2 Z Bits, 5 x 30 mm

	05057515001	1x	5 x 30 mm
	05057520001	1x	6 x 30 mm
	05057525001	1x	8 x 30 mm
	05057530001	1x	10 x 30 mm



Web link

https://products.wera.de/en/ratchets_and_accessories_the_zyklop_ratchets_the_zyklop_ratchets_1_2_the_zyklop_speed_ratchet_1_2_8100_sc_2.html

Wera - 8100 SC 2
05003645001 - 4013288121189

Wera Werkzeuge GmbH
Korzter Straße 21-25
D-42349 Wuppertal
Tel: +49 (0)2 02 / 40 45-0
E-Mail: info@wera.de