

# Near® Smart Switches

## Datasheet



**Product code**  
NSZBSW\_01/02/03G\_WH/BK

### Electrical

**Input voltage:**  
220 - 250V, 50~60Hz

**Power output:**  
3 to 800W per gang  
2,000W maximum

**Current output:**  
10A maximum

**Wiring:**  
No neutral wiring required

### Physical

**IP rating:**  
IP20

**Housing Colour:**  
White / Black

**Warranty:**  
1 Year

**Product size:**  
86mm x 86mm x 41mm

**Material:**  
Fire Retardant Polycarbonate

**Switch:**  
1 Gang / 2 Gang / 3 Gang

**Indicator light:**  
Red LED indicator light

**Type:**  
UK/EU 86 mechanical switch

**Lifetime**  
100,000 clicks

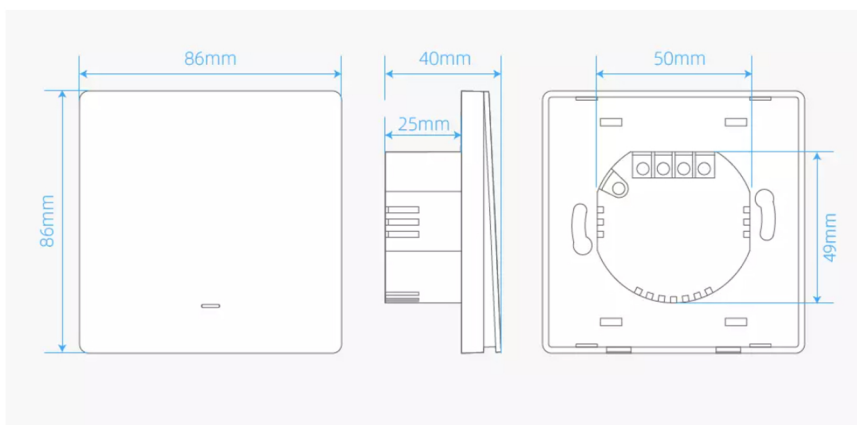

### Compatibility

**Near® Smart Lighting:**  
Zigbee, IEEE 802.15.4 (2.4Ghz)  
Google Assistant  
Amazon Alexa



**Scan QR code**  
to download Near® App



# Near® Smart Switches

## Datasheet



**Product code**  
NSZBSW\_30A\_WH/BK  
Near® Smart Water Heater Switch

### Electrical

**Input voltage:**  
220 - 250V, 50~60Hz

**Power output:**  
6,600W maximum

**Current output:**  
30A maximum

**Wiring:**  
Neutral wiring required

### Physical

**IP rating:**  
IP20

**Housing Colour:**  
White / Black

**Warranty:**  
1 Year

**Product size:**  
86mm x 86mm x 41mm

**Material:**  
Fire Retardant Polycarbonate

**Switch:**  
1 Gang

**Indicator light:**  
Red LED indicator light

**Type:**  
UK/EU 86 mechanical switch

**Lifetime**  
100,000 clicks

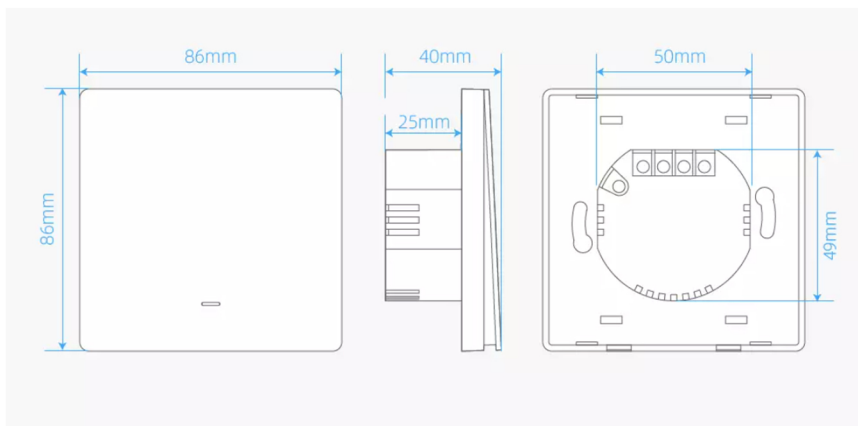

### Compatibility

**Near® Smart Lighting:**  
Zigbee, IEEE 802.15.4 (2.4Ghz)  
Google Assistant  
Amazon Alexa



Scan QR code  
to download Near® App

