

ALLURE™

QUICK START GUIDE

**ALUMINUM PHOTO PANELS
FOR DIRECT AQUEOUS PRINTING**

MATTE SURFACE | 0.040" | 1.02MM

Patent US10166785B2

 BREATHING®
COLOR

WHAT YOU NEED



PRINTER

Allure Aqueous sheets can be fed right through most Epson large-format printers. Below are models that we currently recommend.

- > Epson® P20000 (64" wide, 9 color)
- > Epson® P10000 (44" wide, 9 color)
- > Epson® P9000 (44" wide, 10 color)
- > Epson® P7000 (24" wide, 10 color)
- > Epson® P8000 (44" wide, 8 color)
- > Epson® P6000 (24" wide, 8 color)
- > Epson® P600 (13" wide, 9 color)
- > Epson® P800 (17" wide, 9 color)
- > Epson® P700 (13" wide, 10 color)
- > Epson® P900 (17" wide, 10 color)
- > Epson® P7570 (24" wide, 12 color)
- > Epson® P9570 (44" wide, 12 color)

For a full list of compatible printers, visit: <https://www.breathingcolor.com/allure-directprint-aluminum>



PROTECTIVE LAMINATE

A post-print laminate is not required for Allure, but is recommended. It will add durability to your metal print and will allow you to achieve a satin or glossy finish. Without protective laminate, you can expect prints on Allure to be about as durable as inkjet prints on fine art paper.

Film Laminate

We have found film laminate to work very well in protecting Allure metal. It adds a durable, physical layer between the print and the elements, and also adds depth to your print. Use different finishes of film laminate (gloss, satin, matte, etc.) to achieve your desired finished look. Shop for [film laminators](#) and [Quartz film laminate](#) in our store.

Liquid Laminate

Liquid laminates can also be used to coat Allure panels. Our [Timeless varnish](#) is water-based and can be applied with a roller or HVLP spray gun. Note that there is some visible surface texture when using Timeless glossy or satin finishes. Most people are OK with this texture, but we like to mention it. Timeless matte finish dries smooth and flat. Epoxy resin can also be used to protect Allure; we recommend ArtResin.



MOUNTING FRAME

Our Ready-to-Hang Bars were designed as the perfect mounting system for Allure metal sheets. We use industrial strength double-sided tape to allow you to easily adhere the frame to the back of the print. Our Ready-to-Hang bars have a lip that allows your finished & mounted print to hang perfectly flush against the wall.

Our wood frame bars are sold in 9.5' length moulding as well as preassembled ready-made sizes. We recommend using 3M 4496B double-sided tape.

[Shop Ready-to-Hang Frame Kits](#)

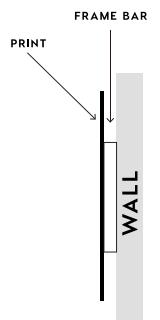

Find everything you need to create the perfect high definition aluminum print at [breathingcolor.com](https://www.breathingcolor.com). For more information on our products contact Breathing Color today!

833.320.1187 | sales@breathingcolor.com

PRINTING INSTRUCTIONS

1 REMOVE THE PROTECTIVE RELEASE LINER

CAREFULLY remove the protective release liner on each sheet before use. The release liner is a thin clear film and can be difficult to see.



2 LOADING THE SHEET

MUST LOAD ALLURE™ PANEL VERTICALLY (PORTRAIT MODE)

Always make sure the Platen Gap/Head Height setting on your printer is set to the highest/widest possible setting.

1. Press the paper release button to open the rollers.
2. Insert and line up the top of the Allure™ sheet with the top of the opening on the printer.
3. Press the paper release button again.

If the printer rejects the sheet due to skew, try again. If the printer accepts the sheet but is slightly askew, firmly grasp the sheet and shift it into alignment without releasing the rollers.

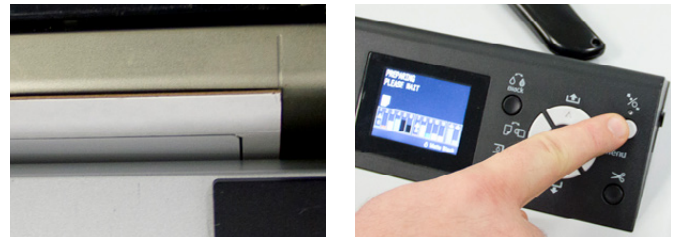

3 CONFIGURE PRINTER SETTINGS

Printing onto an Allure™ panel requires a few minor adjustments to accommodate for the thickness. When configuring your printer settings, please follow the guidelines below.

1. Make sure paper thickness is set to 12.
2. Use the widest possible platen gap.
3. Use the highest possible resolution.
4. Make sure the media type matches the ICC profile.

[Download Our Allure™ ICC Profile From The Breathing Color Website](#)

4 THAT'S IT, NOW PRINT!



Photo shows printed Allure™ removed from carrier.



PRINT SIDE



BACK SIDE



PRINTED & REMOVED FROM CARRIER

