

Pickup Box Ornamentation Bar Package Installation (Instruction ID: 84219049 and 84219050)

Table 1: [Kit Contents](#)

Table 2: [Recommended Tools](#)

Installation Instructions Part Number

84219049

84219050

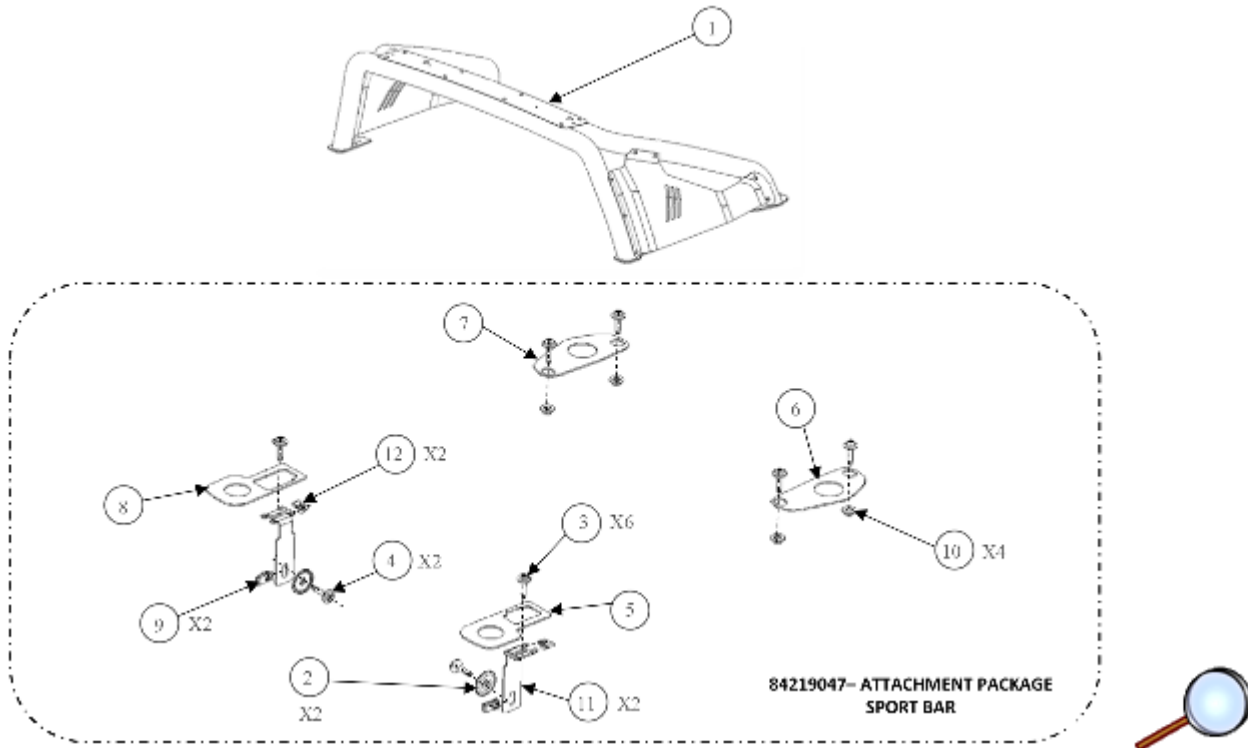

Kit Contents

Item	Qty	Description
1	1	Sport Bar Assembly
2	2	Round Nylon Washer
3	6	M8 - 1.25 X 39.05mm Screw T40 W/CONICAL WASHER
4	2	M8 - 1.25 X 40mm Hex Bolt W/CONICAL WASHER
5	1	DS Front Die Cut Foam Single Side PSA
6	1	DS Rear Die Cut Foam Single Side PSA
7	1	DS Front Die Cut Foam Single Side PSA
8	1	DS Rear Die Cut Foam Single Side PSA
9	1	DS Front Die Cut Foam Single Side PSA
10	1	DS Rear Die Cut Foam Single Side PSA
11	1	DS Front Die Cut Foam Single Side PSA
12	1	DS Rear Die Cut Foam Single Side PSA

Item	Qty	Description
8	1	PS Rear Die Cut Foam Single Side PSA
9	2	J-NUT Wide Range
10	4	M8 – 1.25 X 13mm Nut
11	2	Stake Pocket Bracket 11 GA Steel
12	2	J-NUT Short Range
-	1	Installation Instructions

Tools Required

- Ratchet Wrench
- Torque Wrench
- M8 Hex Socket
- T40 TORX Internal Driver
- Safety Glasses
- Utility Knife
- Drill
- 1mm and 6.4mm Drill Bits
- 25.4mm Hole saw

Note: For vehicles equipped with RPO **UVR** Camera Rearview Mirror. Center the camera image using the mirror control buttons. This will remove the Sports Bar from the image.

Procedure

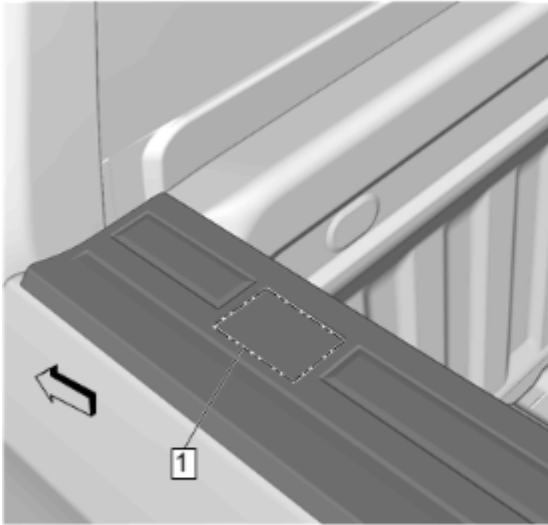

1. Carefully cut the bed rail molding (1) along the rectangular grooves to expose front stake pockets. Repeat for opposite side.

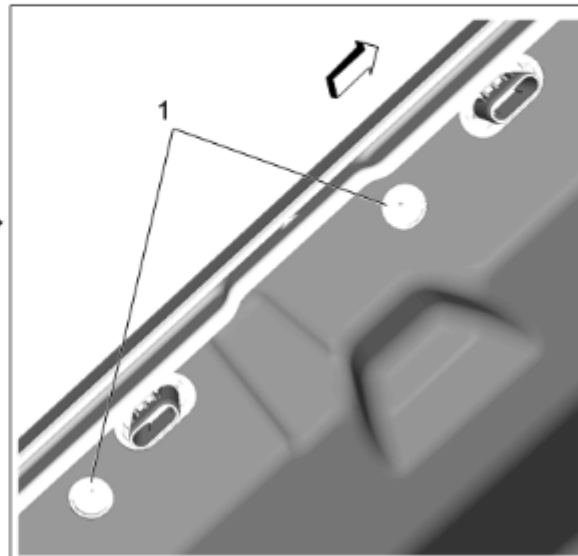
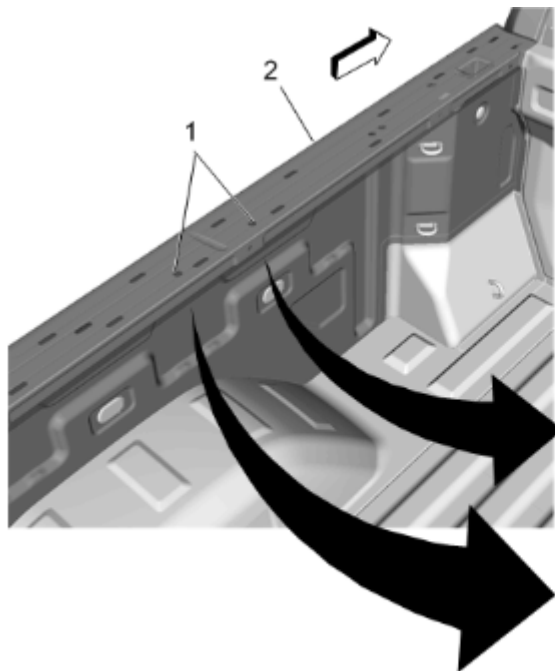

Caution: Always check scale, size and position of holes before drilling. Failing to do so may cause damage to the vehicle, misalignment of components or the inability to install the accessory.

2. Carefully cut holes in the left bed rail molding (2) by drilling 6.4mm pilot holes (from the underside) using the 1 mm pilot locators (1) on the bed rail moldings, seen through the 10.5 mm holes on the underside of the bed rail. Move to the topside of the bed rail and enlarge the holes in the bed rail molding using the 25.4mm hole saw. Proceed carefully and do not drill through the steel box

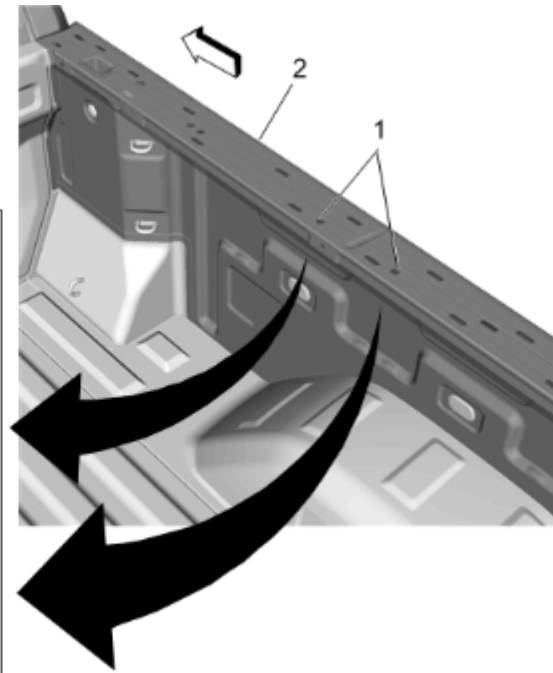
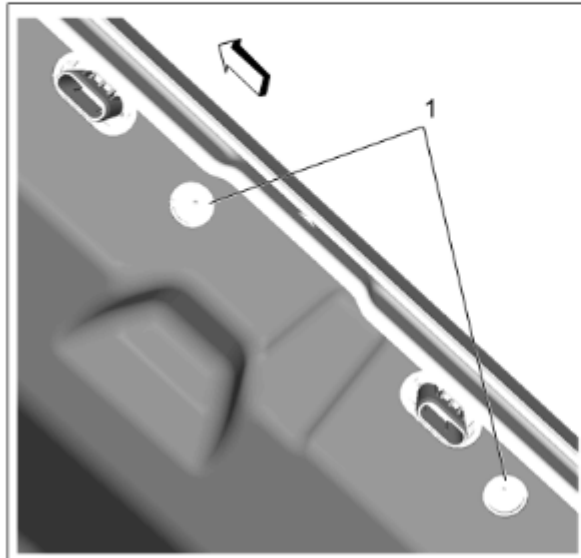

- Carefully cut holes in the right bed rail molding (2) by drilling 6.4mm pilot holes (from the underside) using the 1 mm pilot locators (1) on the bed rail moldings, seen through the 10.5 mm holes on the underside of the bed rail. Move to the topside of the bedrail and enlarge the holes in the bed rail molding using the 25.4mm hole saw. Proceed carefully and do not drill through the steel box below.

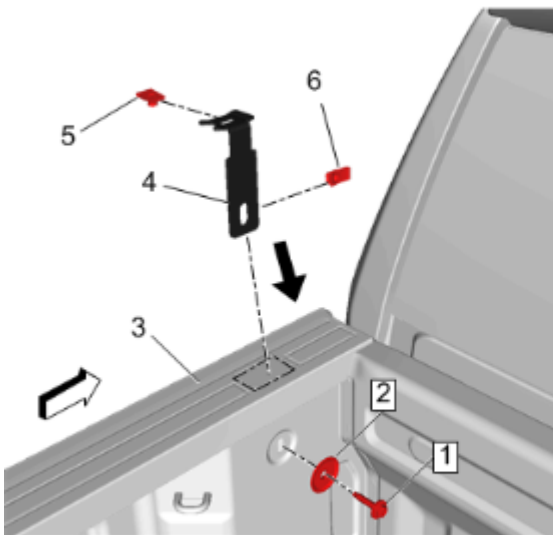

Caution: Use the correct fastener in the correct location. Replacement fasteners must be the correct part number for that application. Fasteners requiring replacement or fasteners requiring the use of thread locking compound or sealant are identified in the service procedure. Do not use paints, lubricants, or corrosion inhibitors on fasteners or fastener joint surfaces unless specified. These coatings affect fastener torque and joint clamping

force and may damage the fastener. Use the correct tightening sequence and specifications when installing fasteners in order to avoid damage to parts and systems.

4. Install J-Nut (6) (Item 9 in kit contents) to Stake Pocket Bracket (4) (Item 11 in kit contents). Install the M8 J-Nut (5) (Item 12 in kit contents) in the Stake Pocket Bracket. Mount the Stake Pocket Bracket to the vehicle box using the M8 mounting bolt (1) (Item 4 in kit contents) and Round Nylon Washer (2) (Item 2 in kit contents). Hand tighten bolt while aligning top surface of stake pocket bracket with the top surface of the bed rail molding (3). Repeat for opposite side.



5. Position foam tape pads (3),(4) & (6) (Items 5, 6, 7, & 8 in kit contents) on the bottom surfaces of the sport bar plates (5).
6. Route wiring (1) through the foam tape (3) at the passenger-side forward cutout, past the mounting bracket.
7. Remove backing and apply the adhesive surface of the foam tape to each mounting plate.

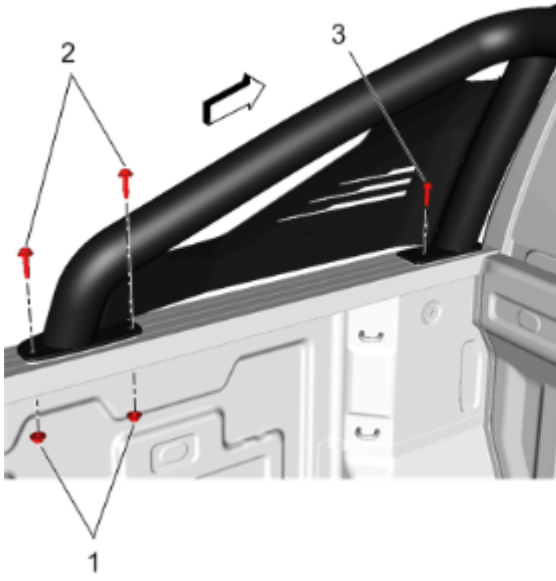

8. Align forward mounting hole in sport bar front mounting plate with mounting hole in the stake pocket bracket. Align the rear mounting plate cylindrical spacer (on bottom) with the holes in the bed cap. Repeat for opposite side.

9. Install the M8 screw (3) (Item 3 in kit contents) into the cage nut (Item 12 in kit contents) in the stake pocket bracket. Repeat for opposite side.

Tighten

Tighten the M8 screws to 9 N.m (7 lb ft).

10. Install the M8 screws (2) (Item 3 in kit contents) into the two holes on the rear mounting plate. Repeat for opposite side.

11. Install the M8 nuts (1) (Item 10 in kit contents) onto the M8 screws (2) from the underside of the bed. Repeat for opposite side.

Tighten

Tighten the M8 screws and nuts to 9 N.m (7 lb ft).

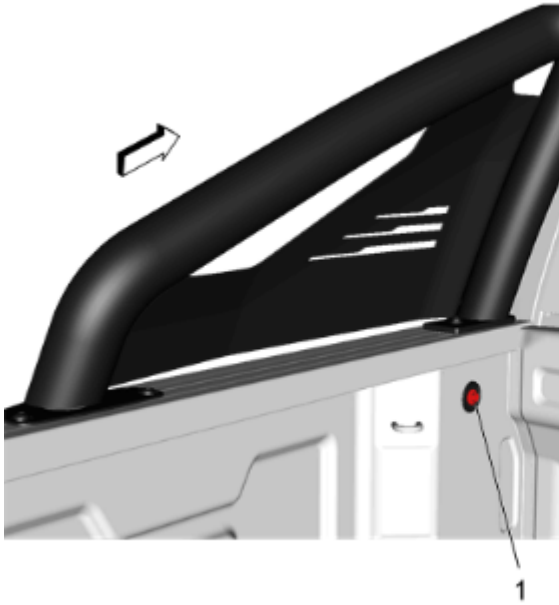

12. Finish tightening the M8 Hex bolt (1) (Item 4 in kit contents) to 22 N m (16 lb ft). Repeat for opposite side.

Sport Bar Harness Installation

Preliminary Procedure

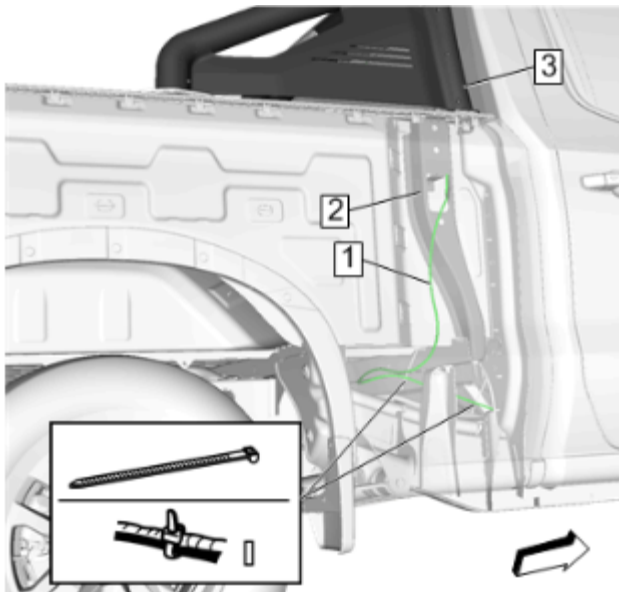

1. The wiring for the Bar comes pre-installed. When the Sport Bar (3) is positioned to the pickup truck bed, the wire harness (1) from the sport bar gets inserted into the front right stake pocket (2), and half way down the stake pocket it comes out and continues down to the ground.
2. Guide wire harness (1) into the passenger side front stake pocket (2) between the inner and outer panels of the truck bed, lower sport bar assembly (3) onto the pickup box.
3. Secure the portion of the harness extending below the truck bed to the Chassis harness.
4. Ensure the routing is snug but NOT tight. Use the enclosed zip ties to secure the harness.

5. Continue Installing the Sport Bar per Installation Instructions.

Underbody / Front Harness Installation

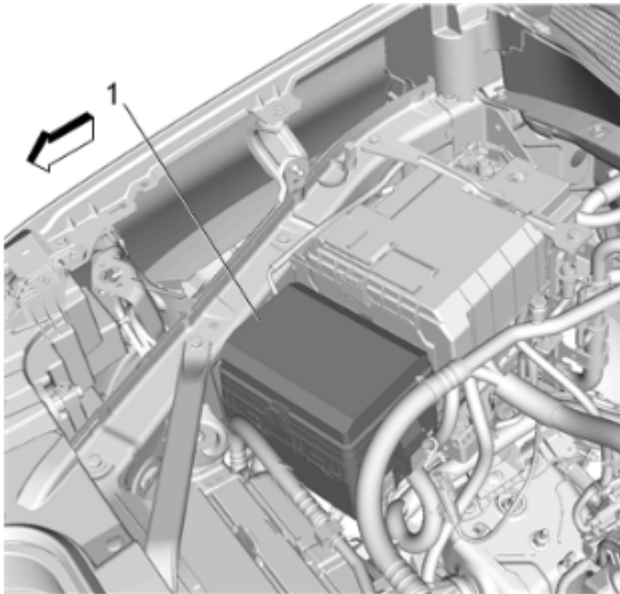

1. The harness routing starts with the 3-way connector mounted to the inboard side of the UEC (1) (Underhood Electrical Center) with terminals pointing rearward.
2. Remove the right front wheel and tire assembly. Refer to [Tire and Wheel Removal and Installation](#) in Vehicle Service Manual.
3. Remove the right front wheel house liner. Refer to [Front Wheelhouse Liner Replacement](#) in Vehicle Service Manual.

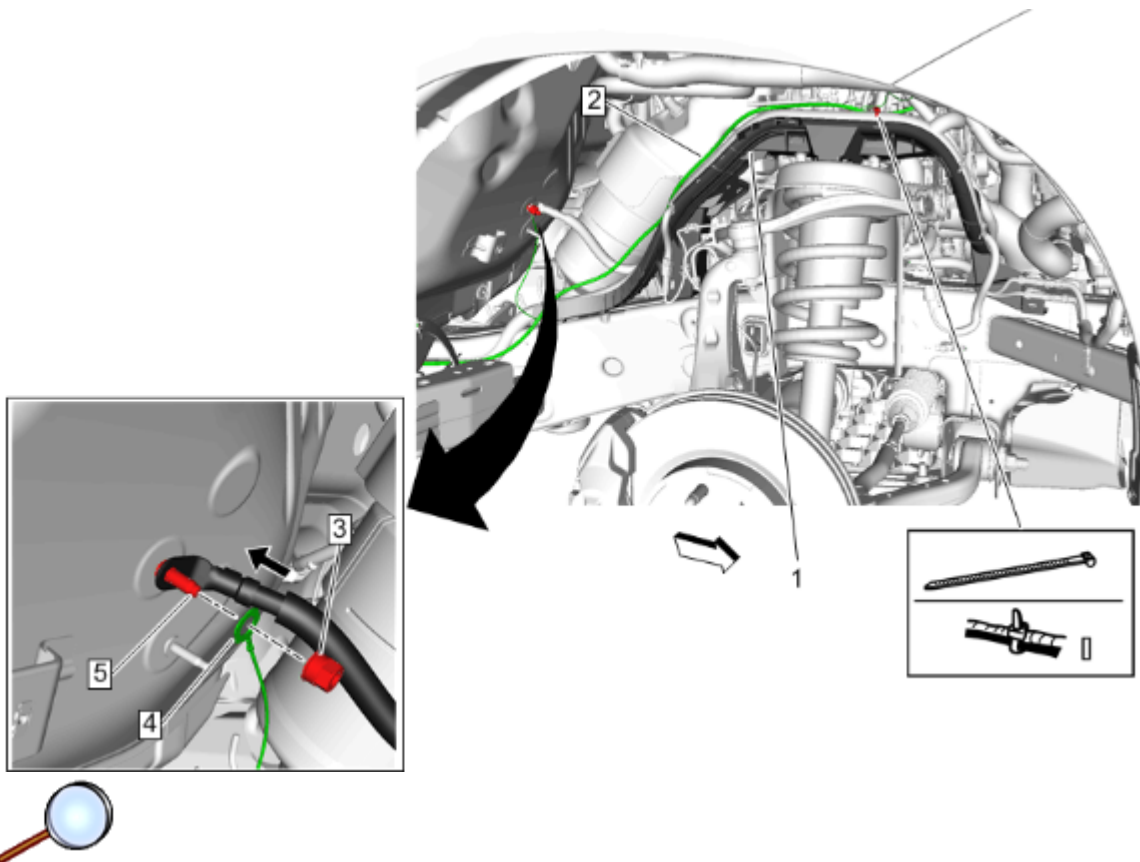

4. On the provided harness locate the Foil Tape, this needs to align with High Temp Protection (1) on the Harness in the Engine Compartment.
5. The end of the harness with the connector and single terminal is routed forward in vehicle of the foil tape. Use an included zip tie to secure the harness to chassis harness at the forward end of the high temp protection on the chassis harness.
6. Remove the existing ground bolt (3), stack the new eyelet (4) to ground stud (5) and replace the ground bolt, tighten the bolt to 23 N.m (17 lb ft).

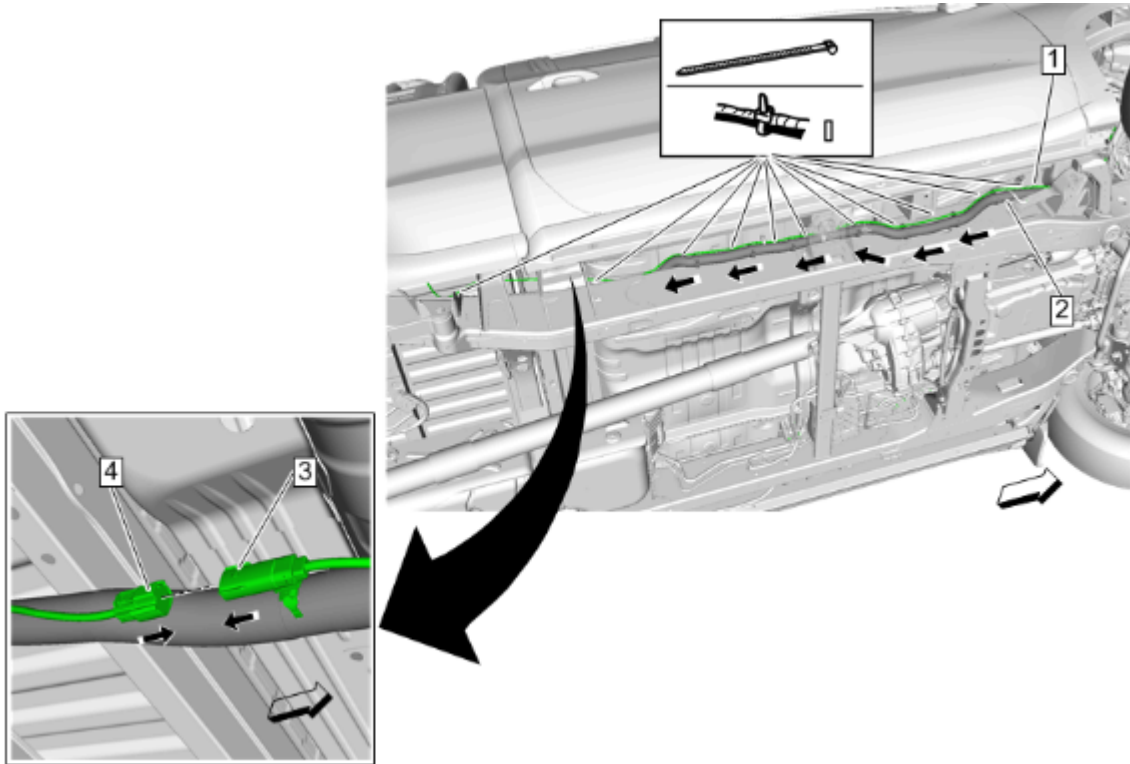

7. Make the connection between the CHMSL (4) and Underbody / Front Harness (3) Use the included Zip Ties every 200 mm to secure the harness (1) to the Chassis harness (2) and to take up any excess length.

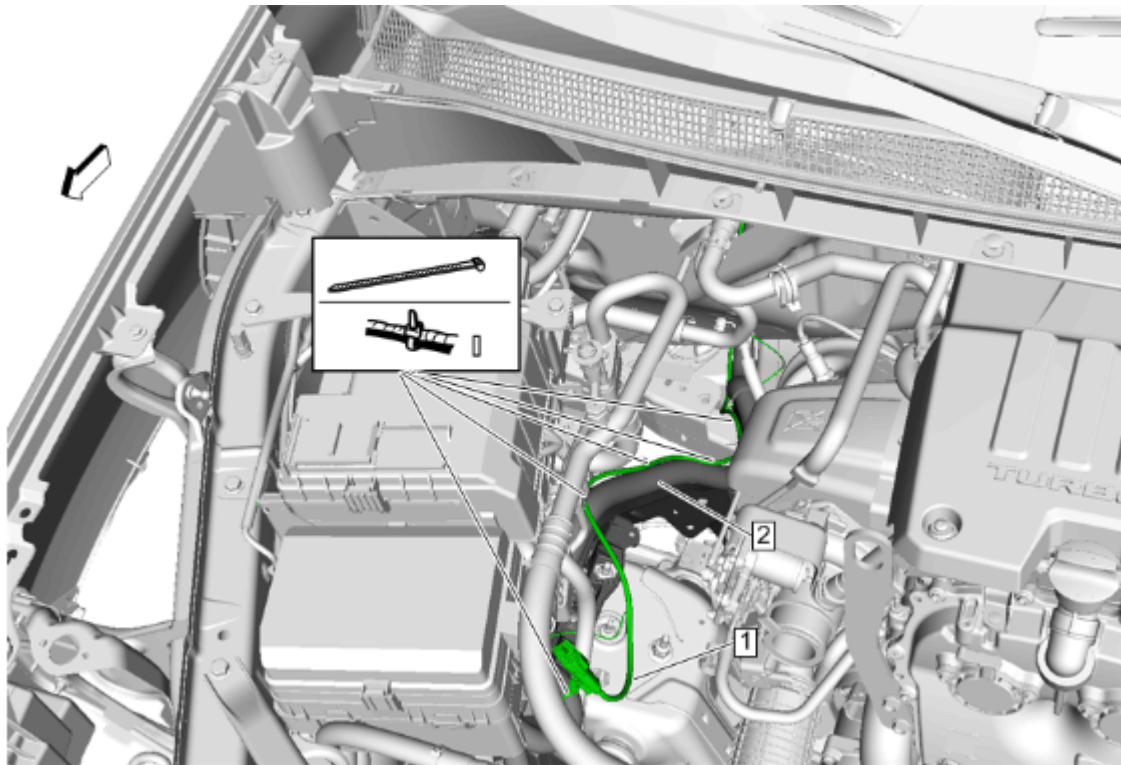

8. Along the Chassis Harness in engine compartment (assure the foil tape on the underbody harness (1) and the Chassis Harness (2) are aligned) secure with included zip ties.

UEC (Underhood Electrical Center)

1. Disconnect the negative battery cable. Refer to [Battery Negative Cable Disconnection and Connection](#) in Vehicle Service Manual.

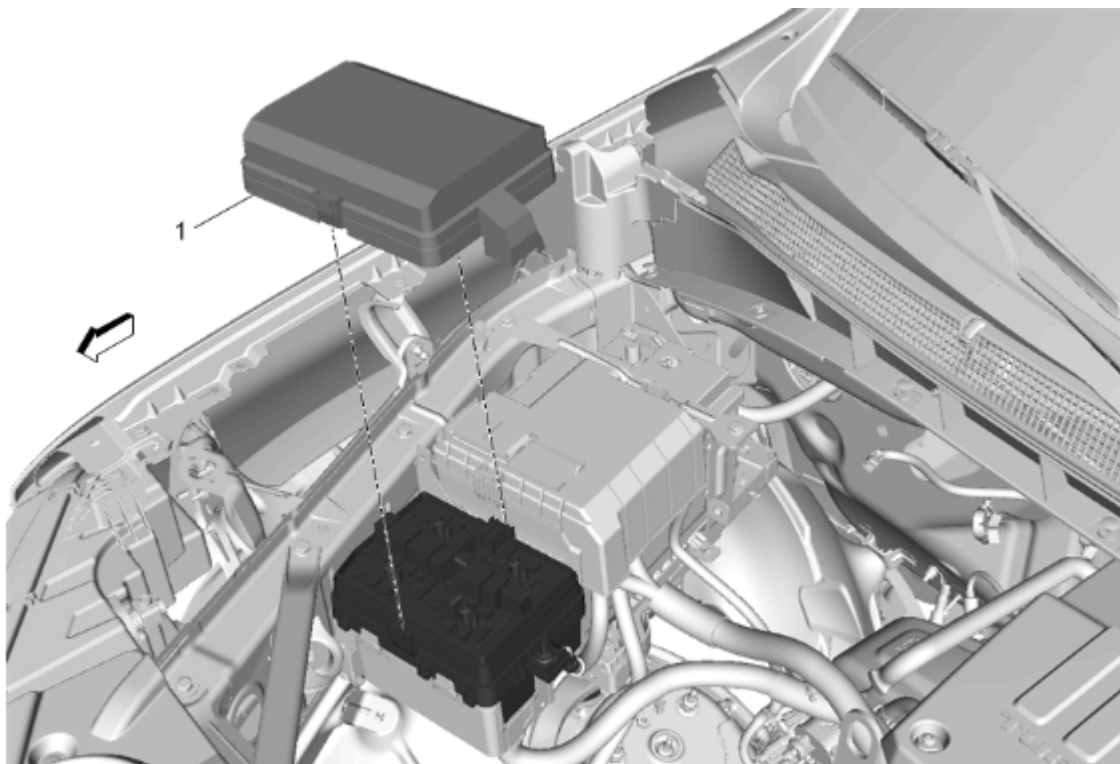



2. Disengage the retaining tabs and remove the UEC cover (1) from the top of the UEC.

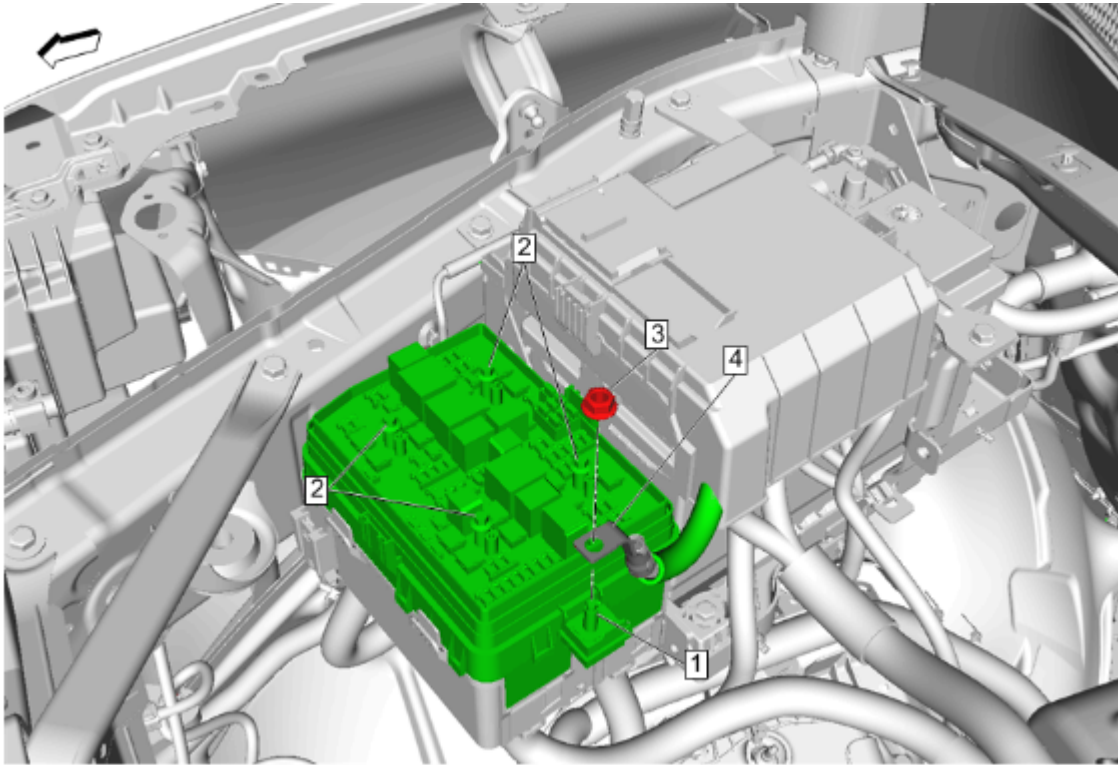

3. Remove the nut (3) and terminal ring (4) from the UEC terminal post (1).

4. Loosen the four bolts (2) on the top of UEC.

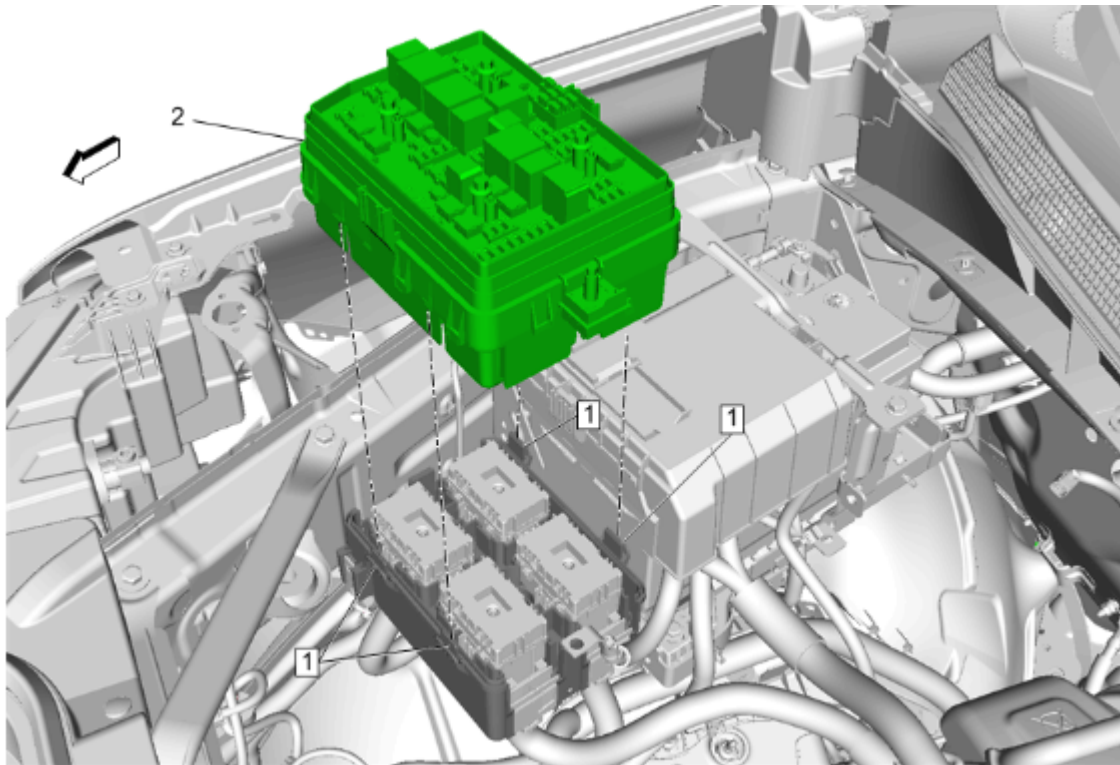

5. Disengage the retaining tabs (1), pull up and remove the UEC (2) from its base.

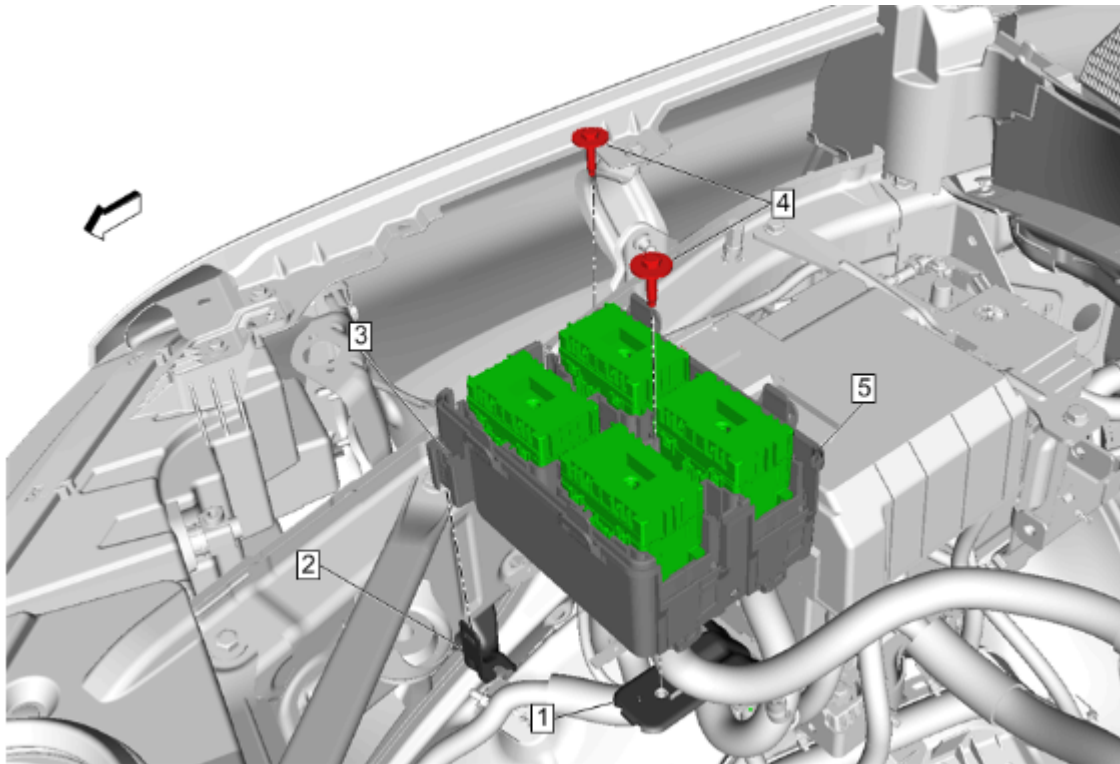

6. Remove the fasteners (4) from the UEC base (5).
7. Disengage retaining tab (3) from side bracket (2).
8. Lift up and remove UEC base from brackets (1) (2).

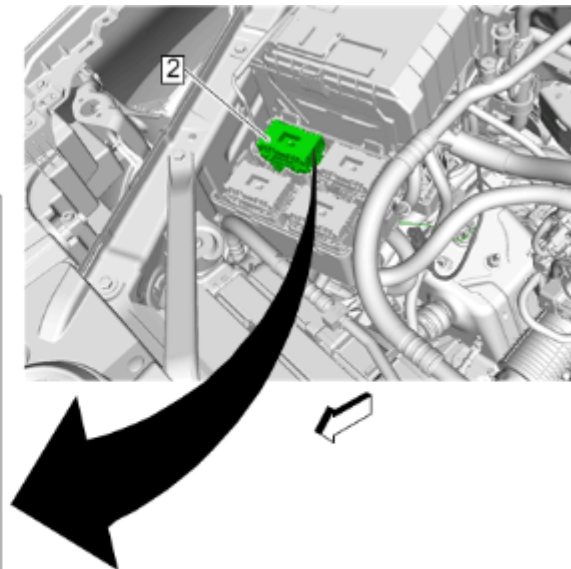
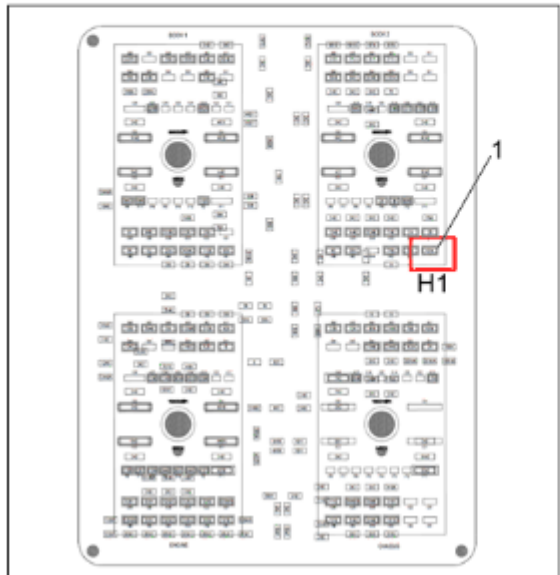

9. Locate body 2 connector (2) in the UEC and remove body 2 connector (2) from clip to access the wire side of connector. Refer to [Delphi Connectors](#) in Vehicle Service Manual.

Note: If terminal is not present in cavity H1, insert the CHMSL wire terminal on the sport bar harness into cavity H1 and proceed to step 13.

10. Locate Cavity H1 (1) on the Body 2 connector (2) in the UEC and remove the terminal from Cavity H1, if present, DO NOT CUT OFF terminal. Remove Terminal per service guidelines. Refer to [Delphi Connectors](#) in Vehicle Service Manual.

11. Use slit in convolute to insert terminated CHMSL wire from underbody harness into Cavity H1 in place of the removed circuit.

12. Cover the terminal that was removed and the un-needed terminal from the accessory harness with vinyl tape and store them out of the way. Proceed to step 14

Note: Do not cut off the terminal that was removed, the vehicle owner may want to return to the original CHMSL.

13. If the vehicle has 4-doors or there was no terminal in Cavity H1, the cab CHMSL must be disabled as follows:

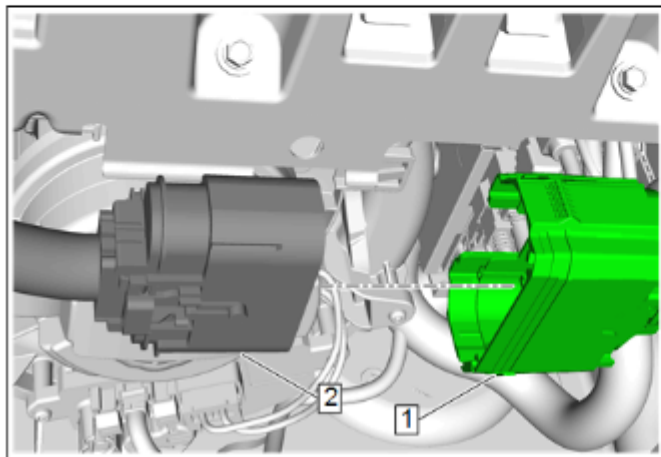

- 13.1. Locate and disconnect the I/P (2) Headliner (1) inline 55-way connector X256 behind the instrument panel compartment.
- 13.2. On the headliner side of the inline connector (1), remove the wire dress cover. Refer to 55 Way Connector at the end of these instructions.

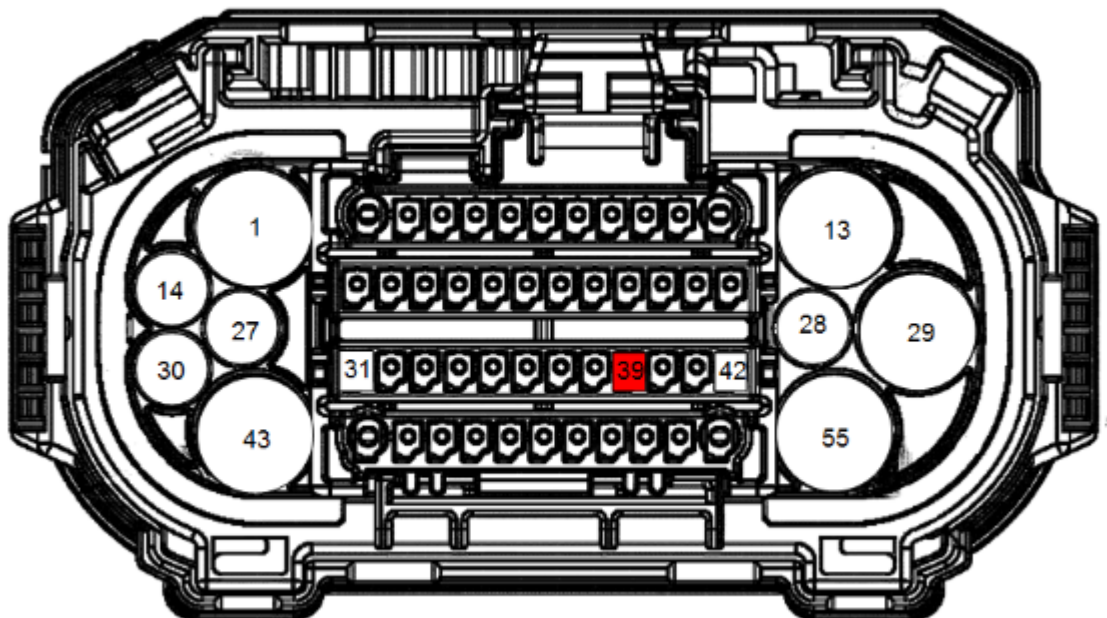

13.3. Identify cavity 39 and remove the terminal from cavity. Refer to 55 Way Connector at the end of these instructions on how to remove terminal.

Note: DO NOT CUT the lead to the TERMINAL.

13.4. Tape the terminal to the wire bundle.

13.5. Reassemble the 55-way connector and reinstall. Refer to 55 Way Connector at the end of these instruction

14. Re-assemble the UEC making sure it is fully seated before securing the fasteners.

15. Connect the negative battery cable. Refer to [Battery Negative Cable Disconnection and Connection](#) in Vehicle Service Manual.

16. Test the CHMSL, operation.

17. Install the right front wheel house liner. Refer to [Front Wheelhouse Liner Replacement](#) in Vehicle Service Manual.

18. Install the right front wheel. Refer to [Tire and Wheel Removal and Installation](#) in Vehicle Service Manual.

55 Way Connector

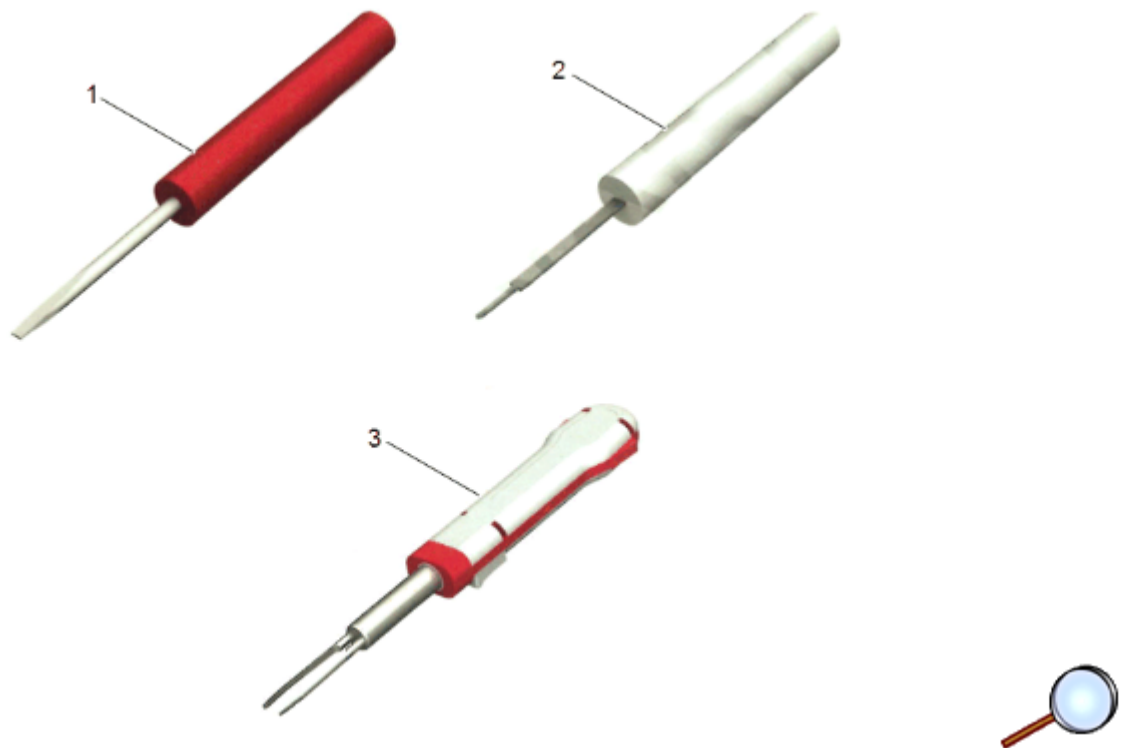

Recommended Tools

Item	Description
1	Pocket Screwdriver
2	Terminal Tool P/N J-38125-215A
3	Terminal Tool P/N J-38125-36

Wire Dress Cover Replacement (Release Slide From Pre-Stage)

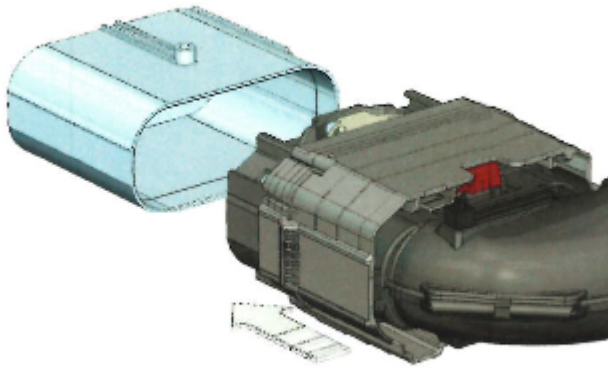

1. Insert connector onto fixture to release the slider.

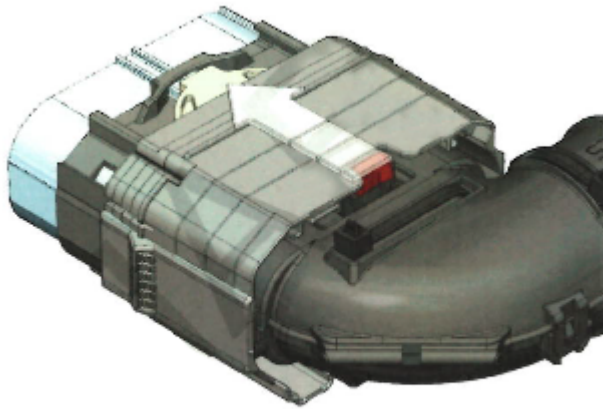

2. Once connector is properly seated, slide the slider forward.

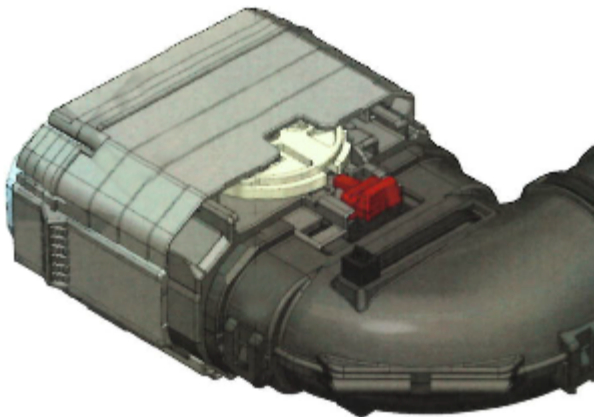

3. Slider is now in full-stage position.

Remove Wire Dress Cover

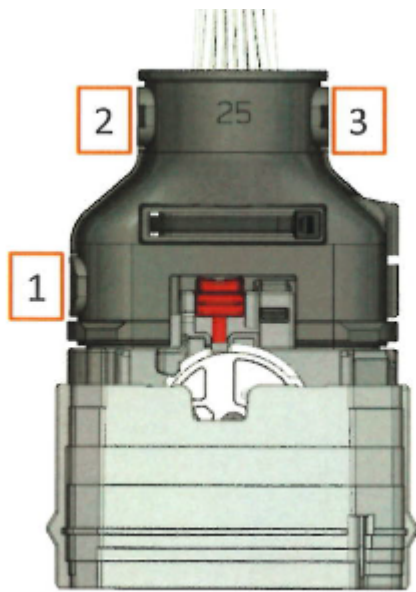

1. Locate the wire dress cover locks.

Note: Numbers indicate the locks release sequence.

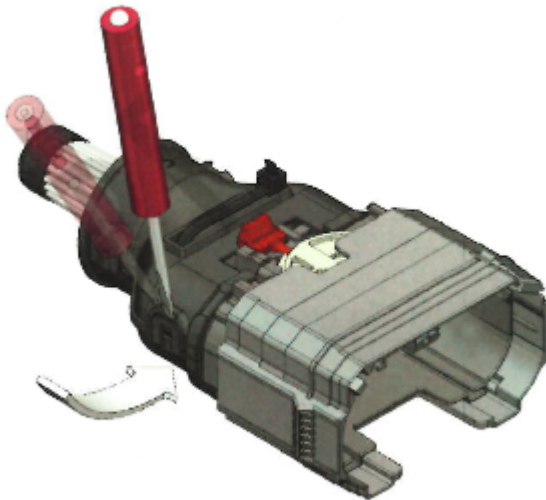

2. Place pocket screwdriver between the rams and locking tab, deflect them with the tool to release them, one at a time, and open the wire dress cover.

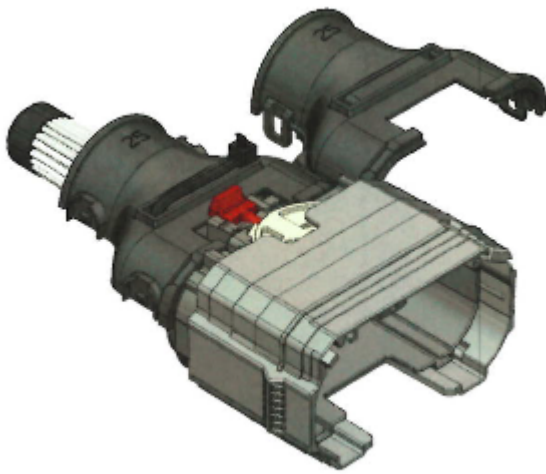

3. Open wire dress cover.

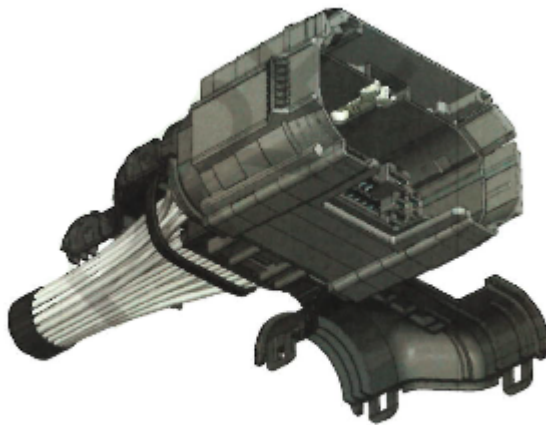

4. Locate and remove the coverings and the wire tie.

Note: Be careful not to damage the cable insulation.



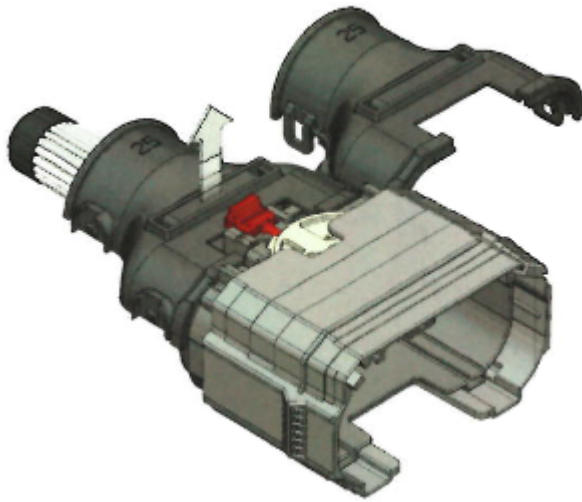

5. Remove wire dress cover from assembly.

Move Slider Back to Pre-Stage

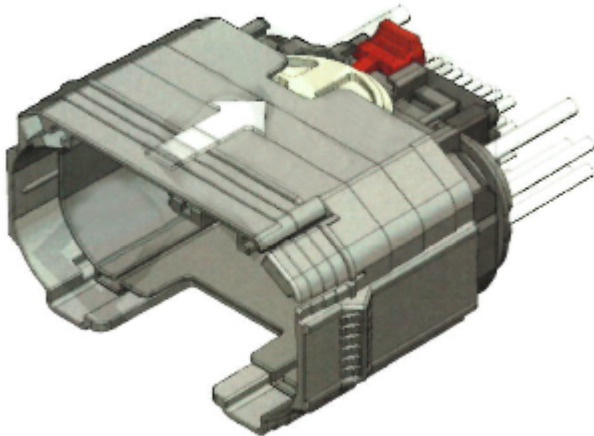

1. At this stage, slider can be pushed backward to place it in Pre-Stage. **OPTIONAL:** This step can also be performed after the terminal removal process.

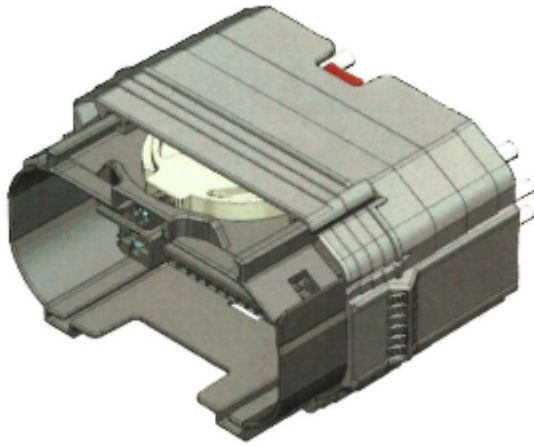

2. Verify audible "click".
3. Slider is now in Pre-Stage position.

Female Terminal Replacement (Move Lock Secondary to Pre-Stage)

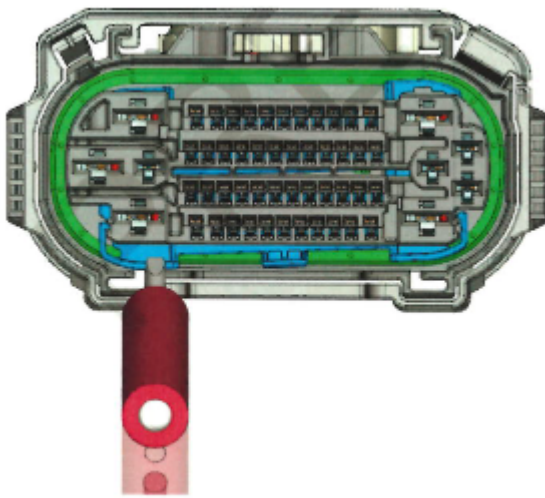

1. Place the tip of P/N pocket screwdriver over the lock secondary rib and push it down.

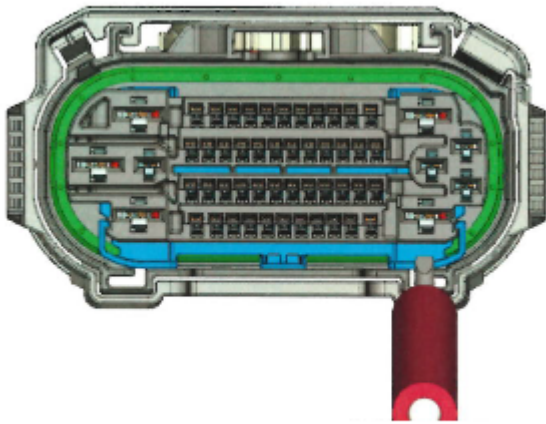

2. Repeat the process with the remaining lock, be careful as not to damage the lock secondary.
3. Lock secondary is now in Pre-Stage position.

Terminal Identification OCS 1.2 / Cavity Plug

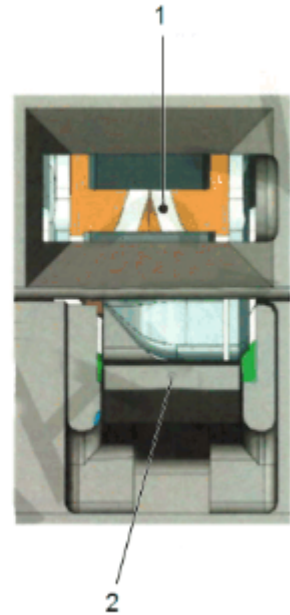
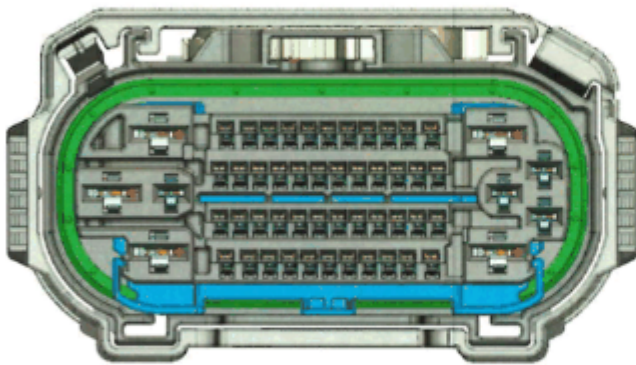

1. Terminal (1).
2. Flex Lock (2).

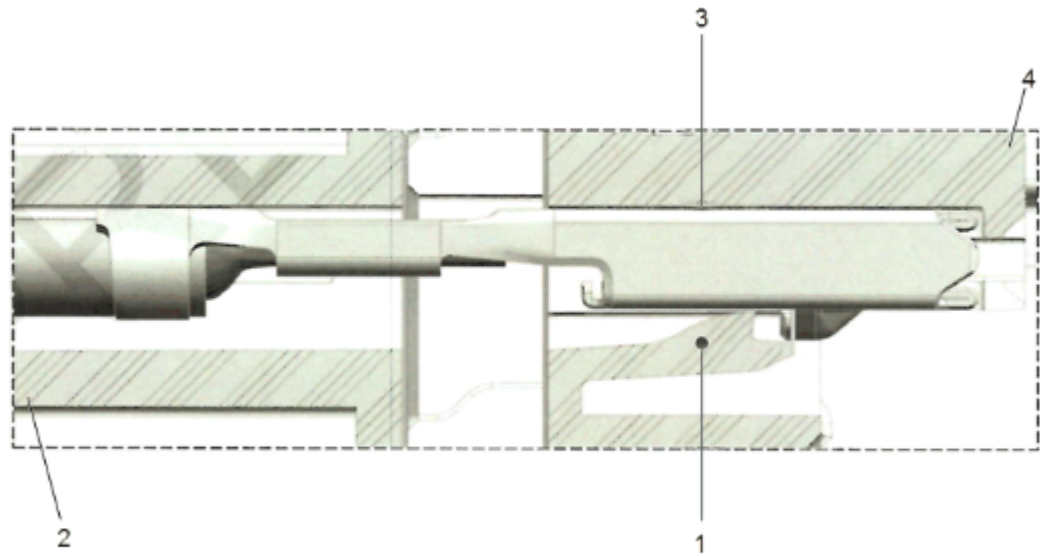

- 3. Flex Lock (1).
- 4. Cable End (2).
- 5. Terminal (3).
- 6. Mating End (4).

Terminal Removal OCS 1.2 / Cavity Plug

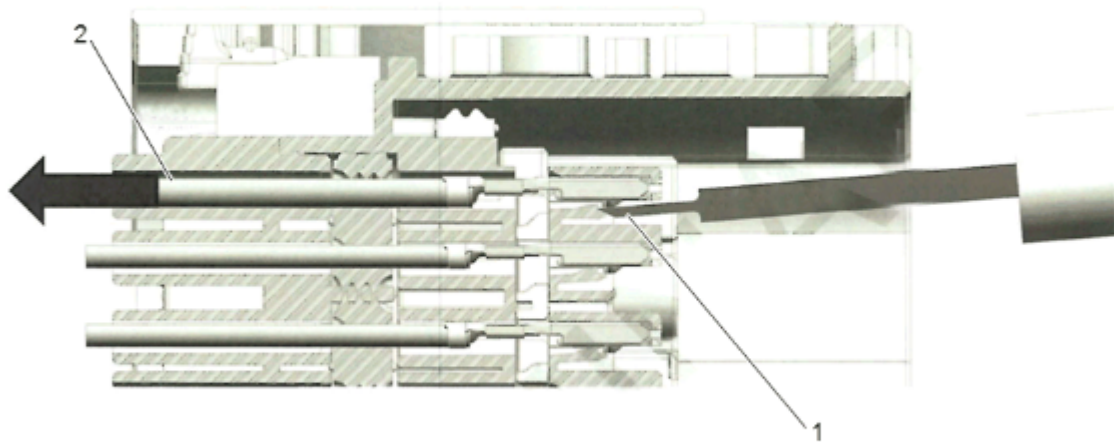



1. Locate the flex lock at the front of the connector. Insert tool (1) P/N J-38125-215A straight into the window.
2. Deflect the flex lock to unseat the terminal / cavity plug and gently pull on the cable or back of plug (2) to remove the terminal / cavity plug from the receptacle

Terminal Identification CTS 2.8 and 6.3

1. Terminal CTS 2.8:

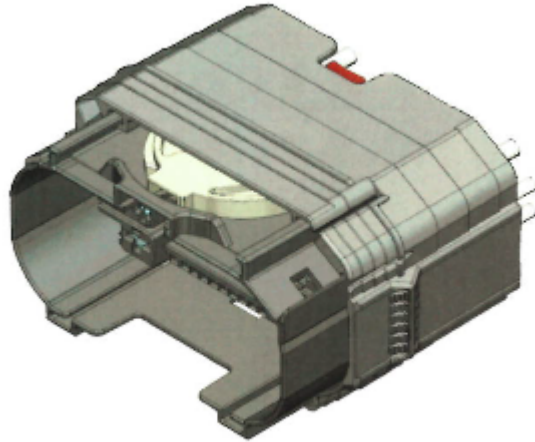

- Removal Windows (1).
- Terminal Tangs (2).

2. Terminal CTS 6.3:

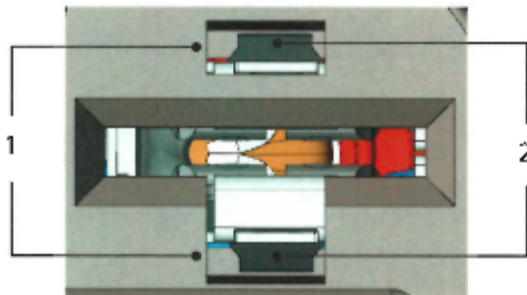

- Removal Windows (1).
- Terminal Tangs (2).

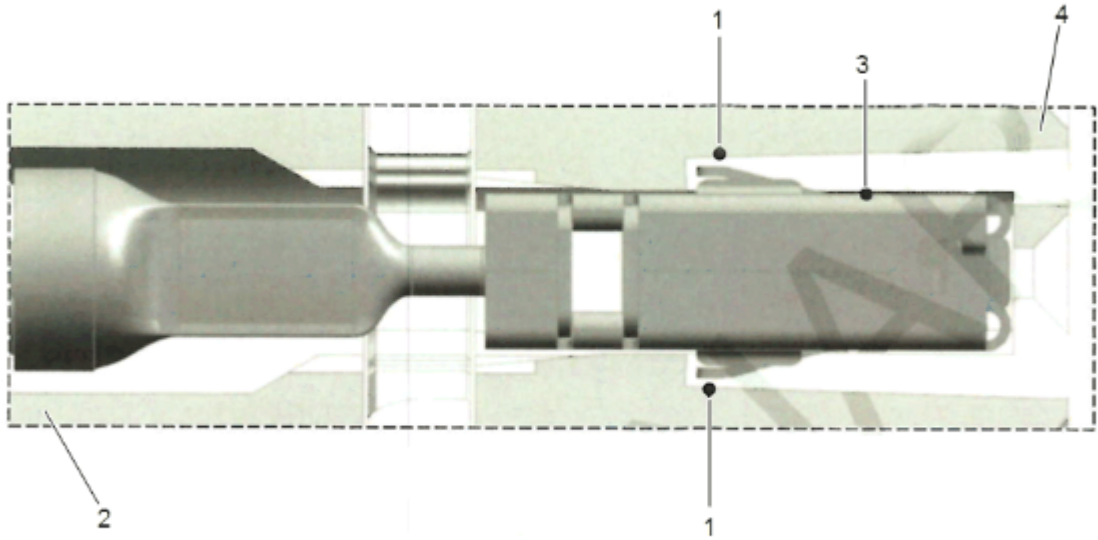

- 3. Terminal Tang (1).
- 4. Cable End (2).
- 5. Terminal (3).
- 6. Mating End (4).

Terminal Removal CTS 2.8 and 6.3

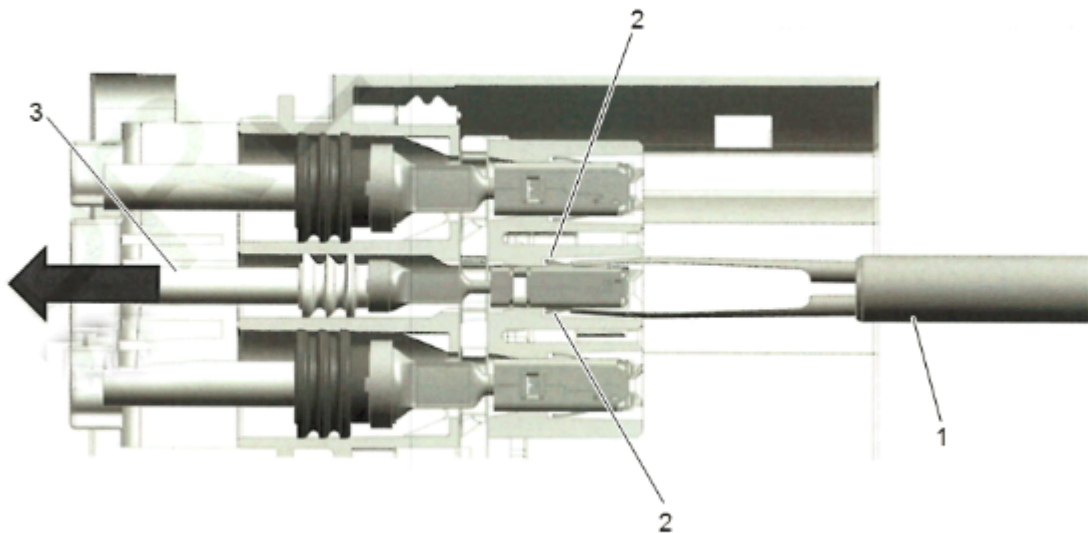



1. Locate terminal tangs (2) at the front of the connector.
2. Insert tool (1) P/N J-38125-36 straight into the removal windows, deflect the terminal tangs to unseat the terminal and gently pull on the cable (3) to remove the terminal from the receptacle.