

ARIA

Flush Floor Vent [Lite] Install Guide

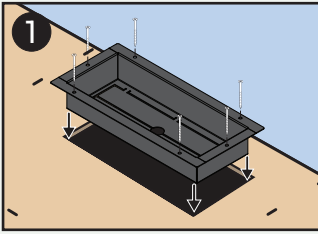

Drop in base on subfloor and fasten with wood screws.

***DO NOT** use provided screws here.

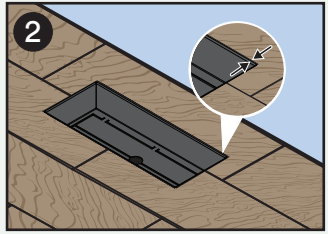

Install surface material on top of **Base** so that it is completely flush.

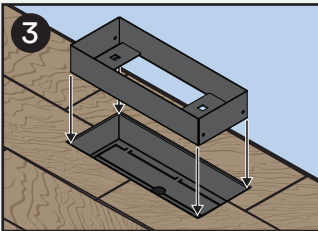

Dry fit **Body** into **Base**.

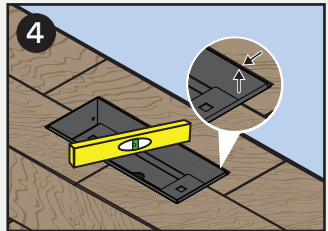

With the resistance from the flange, adjust **Body** up and down until it is flush with the top of surface.

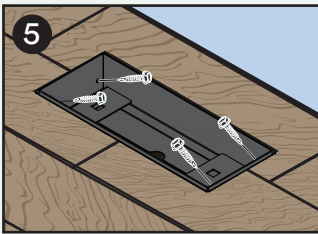

Once adjusted to preferred height, fasten the **Body** to the **Base** using provided screws through the four pilot holes in each corner

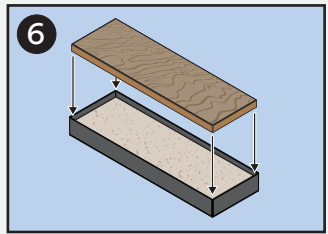

Backfill **Tray** with bonding material and place precut piece of surface material inside **Tray**.

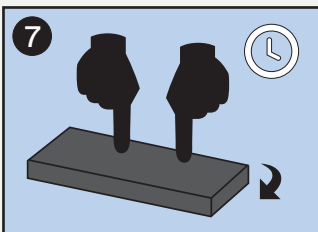

Hold in place and flip **Tray**. Apply even pressure until surface material lies flat with the rim of **Tray**. Leave to cure.

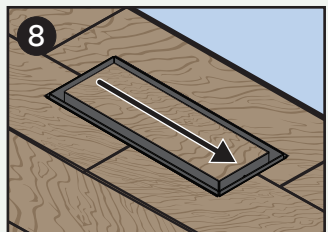

Insert and slide **Tray** in place.
Enjoy!

Control Air Flow

Slide to remove tray and adjust flange open and closed. For optimal air flow, push flanges past 90°.

Additional Support

support@ariavent.com / www.ariavent.com

