

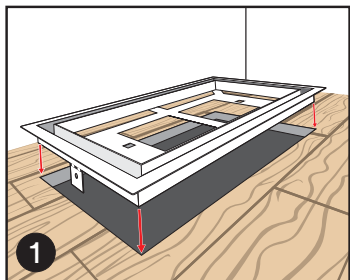

Aria OG - Air Return

Materials Needed

- Pre-cut piece of surface material for tray insert
- Size will vary depending on model
- Bonding material (will vary for flooring materials)
- 2x self tapping screws (optional)



Dry fit Aria Vent body piece in opening.

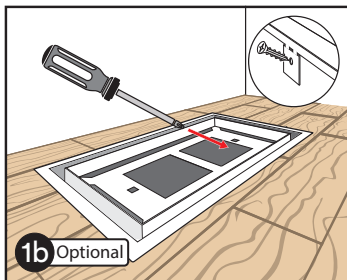

Secure vent with screws.

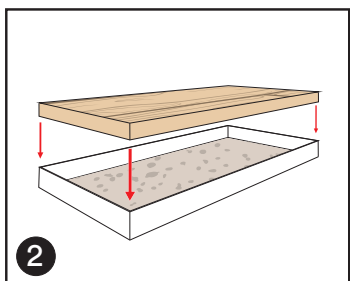

Apply adhesive bonding material in tray. Insert pre-cut flooring material.

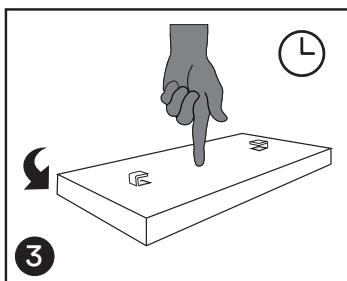

Flip tray and allow bonding material to cure. Ensure flooring material is flush with the rim.

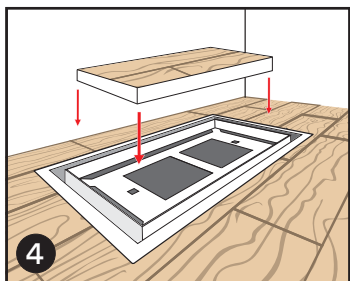

Insert tray into the body.

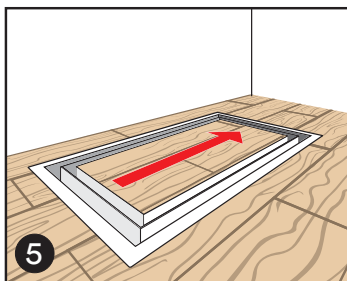

Slide in place. Enjoy!

Additional Support

support@ariavent.com / www.ariavent.com / @ariavent

Patent information

www.ariavent.com/pages/patents