

Step-by-step guide to set
your lighting using the
Garden Lights app.

The steps:

1. Download the app
2. Creating an account
3. Creating a network
4. Adding a product
5. Creating a zone
6. Creating a scene
7. Setting a timer
8. Setting the dark/light sensor

Garden Lights +

12
VOLT



Garden Lights Plus
Techmar

100+
Downloads

PEGI 3 G

Install

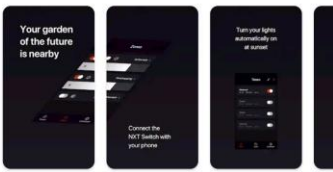

About this app →

Make your Garden Lights 12 volt garden lighting smart with the Plus collection.

Lifestyle

Rate this app

Tell others what you think

Download the app

Visit the [App Store](#) or [Play Store](#) to download the Garden Lights app.

Has the app been installed on your phone? You can start right away!



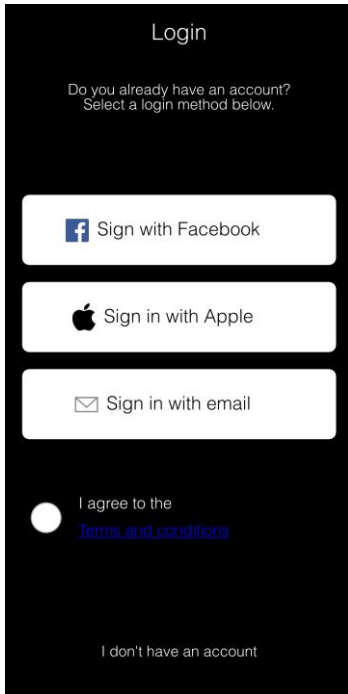

Creating an account

On the start screen you can select how you would like to create an account.

Click on 'I agree to the terms and conditions' and the service you would like to use to create an account.

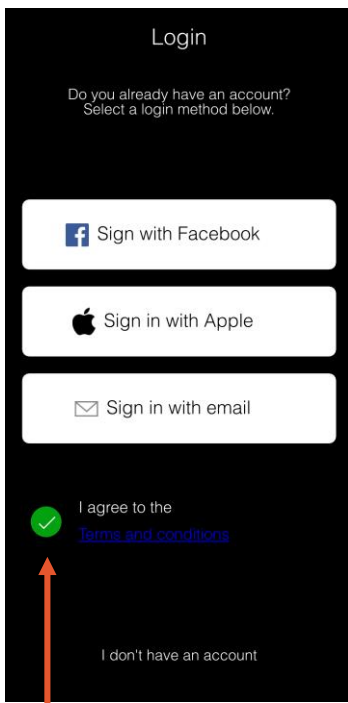

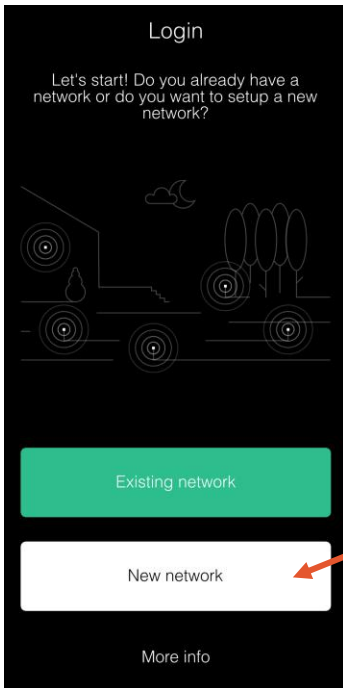

Creating a network

Select 'New network'.
A pop-up concerning location access will appear which has to be accepted for the app to work correctly.

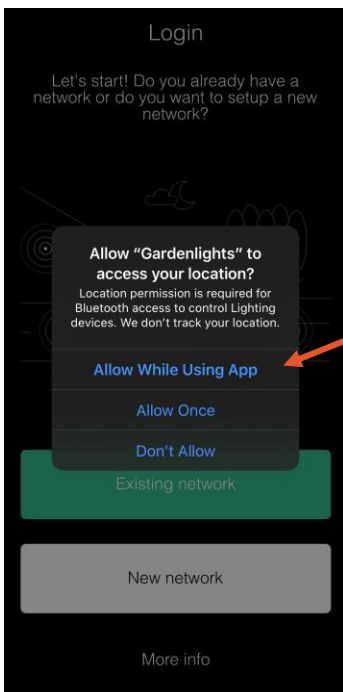

If you accidentally clicked "Don't allow" you can still change this in the settings of your phone.

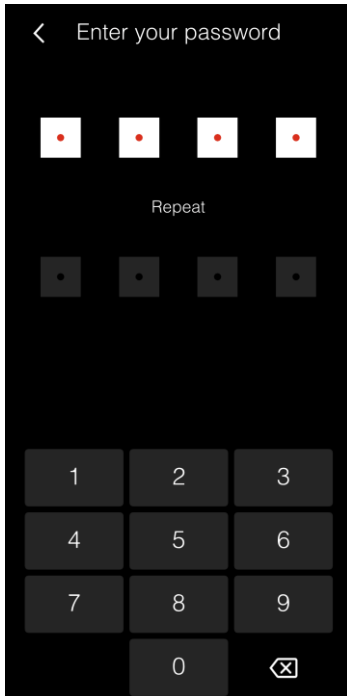

Create a password by submitting the same password twice and click 'connect'.

As soon as you click 'connect' the app will start searching for available devices set to factory settings.

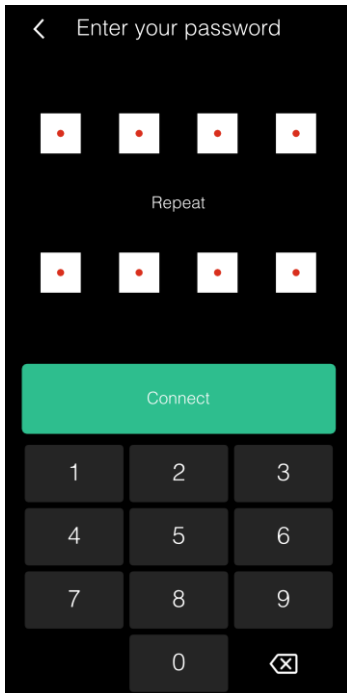

Caution! In order to create a network, the smart products must be connected to a power source by means of a transformer.

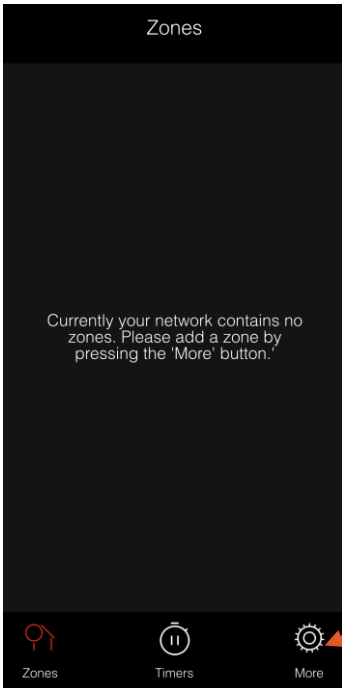

Once the app connects to devices in your garden you will see the start screen of your zones.

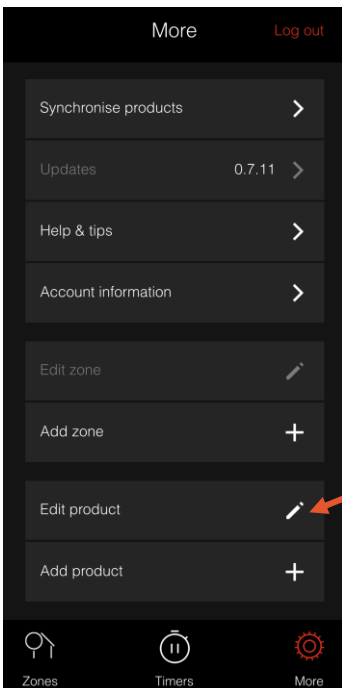

First, click on 'more' and subsequently on "edit product" to assign a name to your smart products.

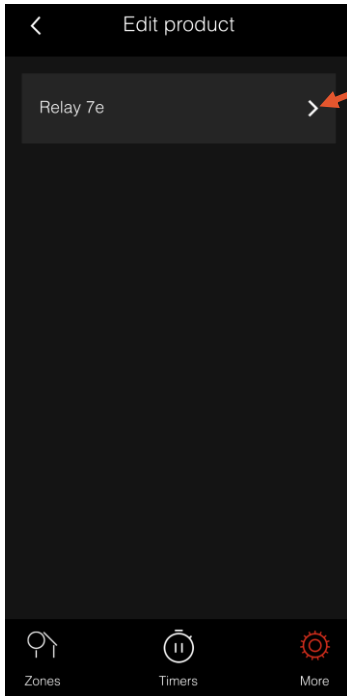

At 'Edit products' you will find all smart products to which the app is connected. In order to name the Switch, click on the arrow to the right of the standard name assigned to the product.

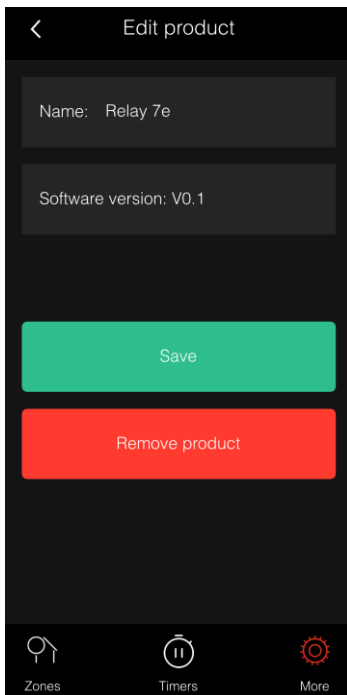

A screen will open that shows you information about the product.

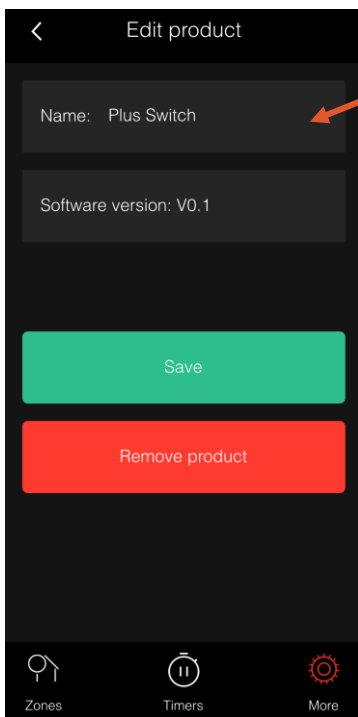

Click on the standard name to change it. Subsequently, select 'save' to save the new name.

**If you have an Android phone you must click enter on your keyboard first before you select 'save'.*

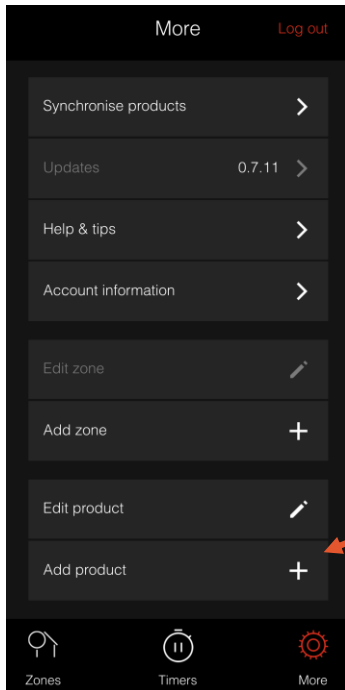

Adding a product

(Or add a product at a later moment.)

Click on 'add product' and subsequently on 'connect'. The app will start searching for available smart products.

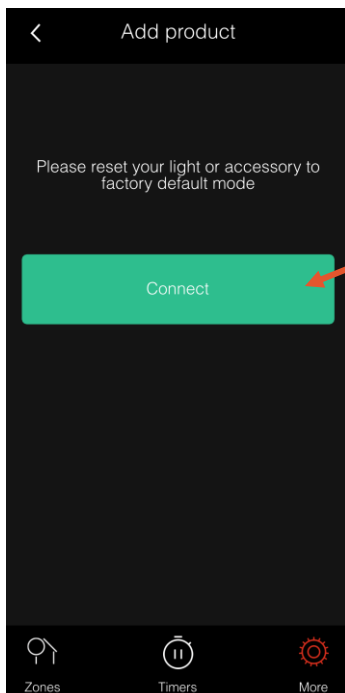

Consult the user manual if your product cannot be found in order to reset the product to factory settings.

Creating a zone

In order to control a product it should be linked to a zone.

You can create a zone by selecting 'Add zone' in the 'more' menu. In the first field, submit the name you want to assign to the zone.

Click on the arrow to the right of 'products' to link products to the zone.

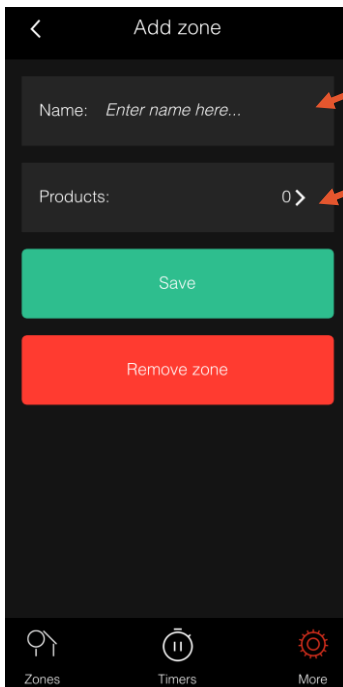
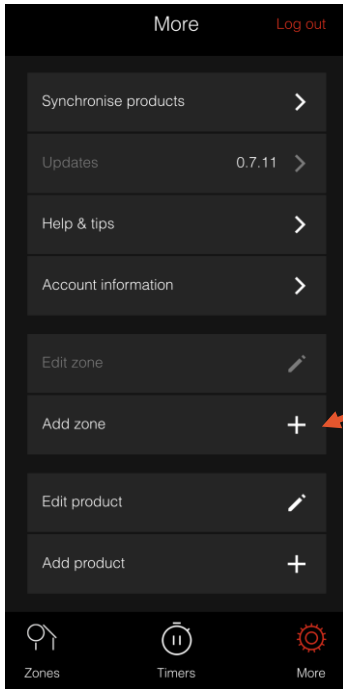

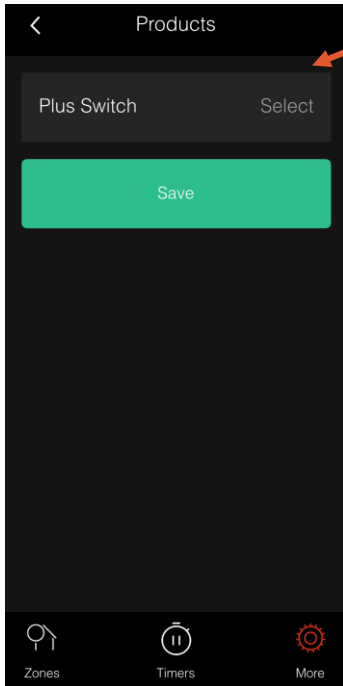

On this new screen you can select the products you want to link to the zone.

Click on 'select' in grey next to the product you want to link.

The text will change to 'selected'. Then click 'save'.

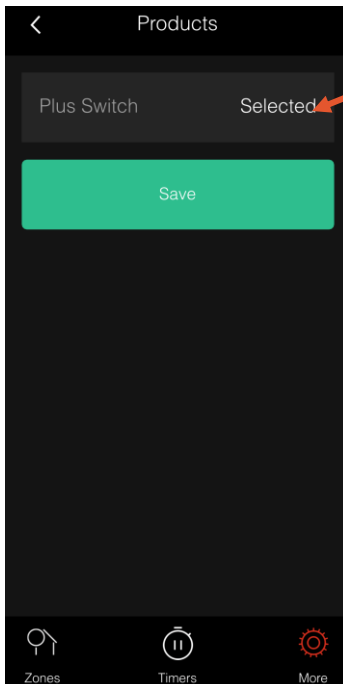

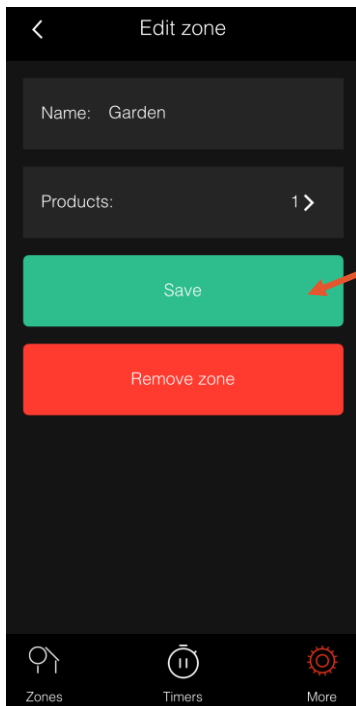

Once you clicked 'save' you will return to the zone. At 'products' you can now view all the products that have been linked to the zone.

Now, click on 'save' again if the correct products have been linked successfully.

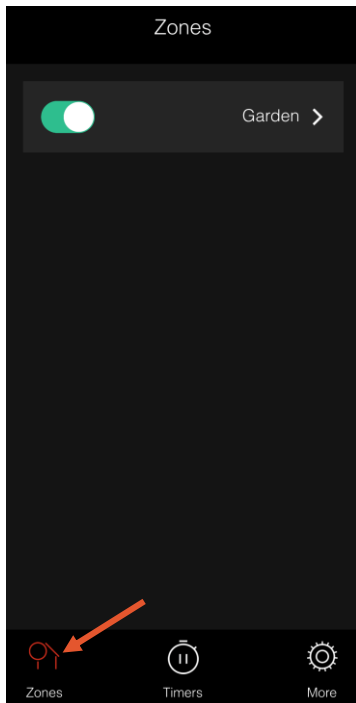

By clicking on 'zones' in the lower left corner of your screen you can see all your zones and turn them on/off.

The zone is turned on when the slide is green. You can turn it off by clicking on the slide, which will then turn grey.

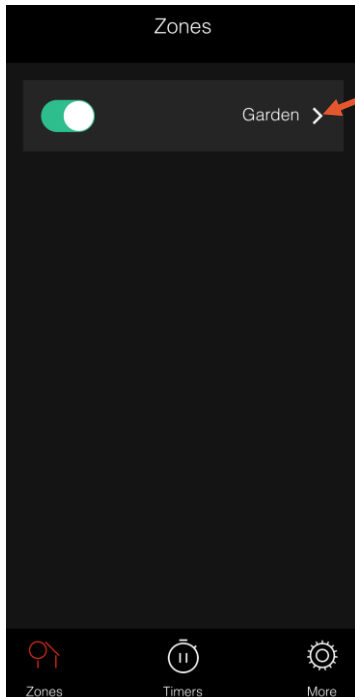

Creating a scene

You can open a zone by clicking on the arrow to the right of the zone.

Here you can create a scene. A scene is required to set a timer.

Turn the lights on by activating the zone and select 'save as scene'.

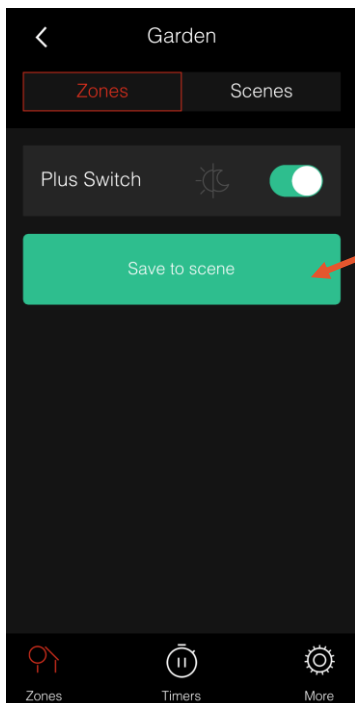

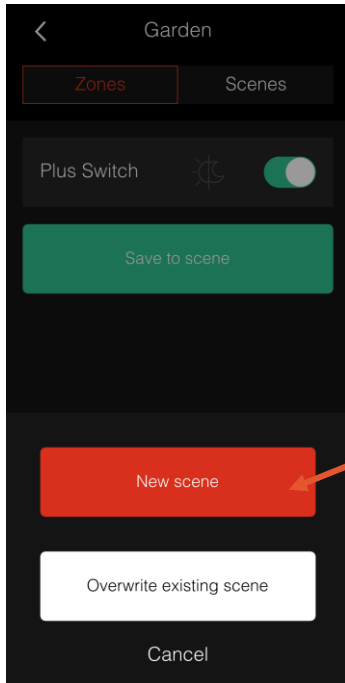

A pop-up will appear asking you to create a new scene or to overwrite an existing one.

Click on 'new scene.' A new screen will open where you can name the scene. After submitting a name, click on 'save'.

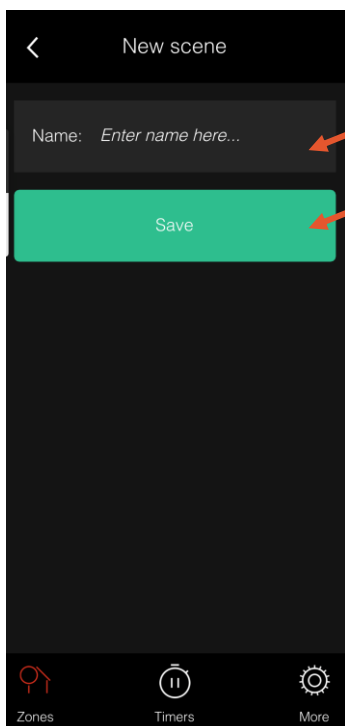

**If you have an Android phone you must first click on enter on the keyboard and then on 'save'.*

Garden Lights +

12
VOLT

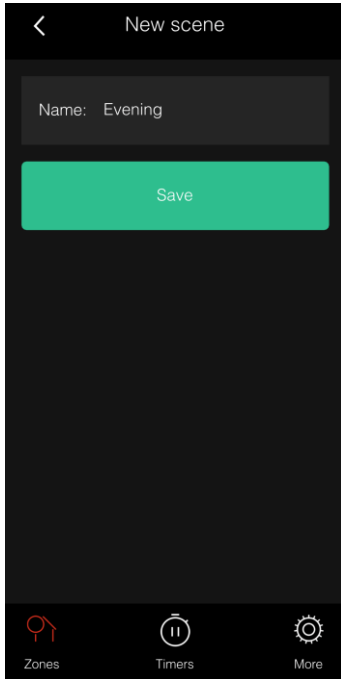

Select the tab 'scenes' to view your saved scene.

The scene can now be used to set a timer.

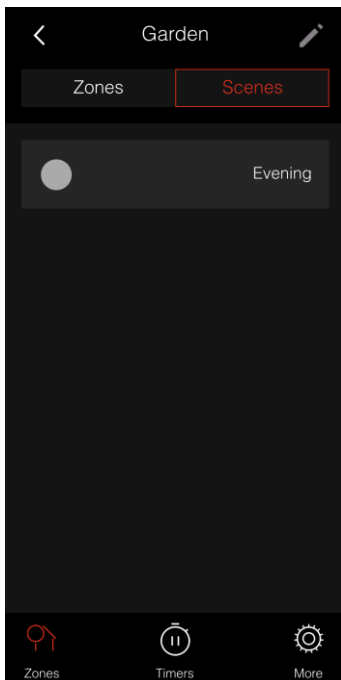

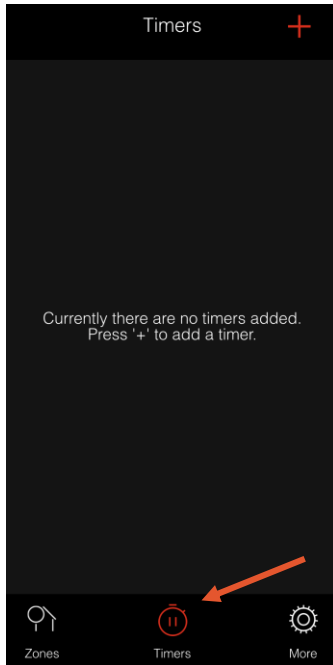

Setting a timer

Click on 'Timers' at the bottom of the screen and then on the plus sign to set a new timer.

A new screen will open where the timer can be set.

Work from top to bottom and click on the arrows to access and adjust a field.

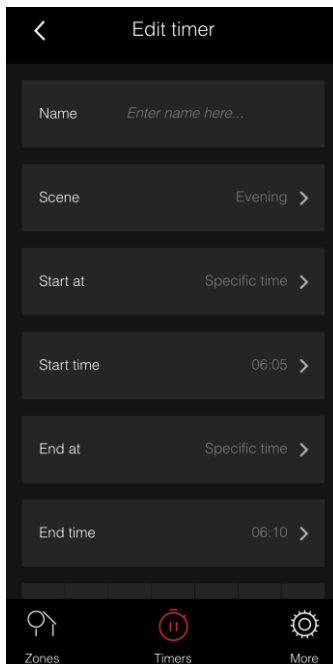

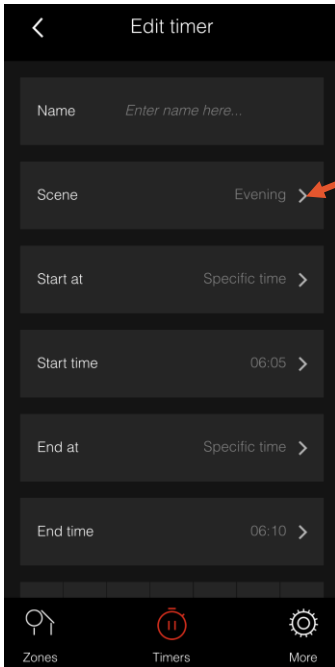

Click on the arrow at 'scene' to select a scene.

A new screen will open where the scene can be selected.

Click on the scene and you will automatically return to the screen where you can set the timer.

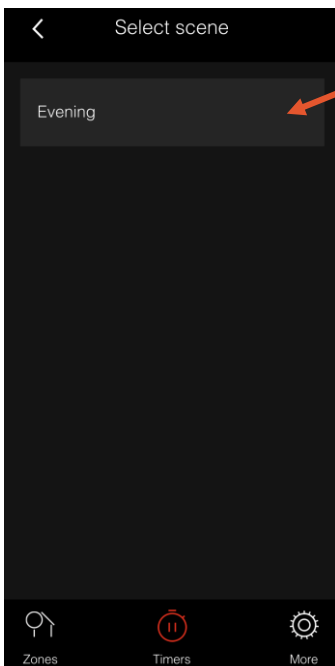

Next to 'scene' you will see the name of the selected scene in grey.

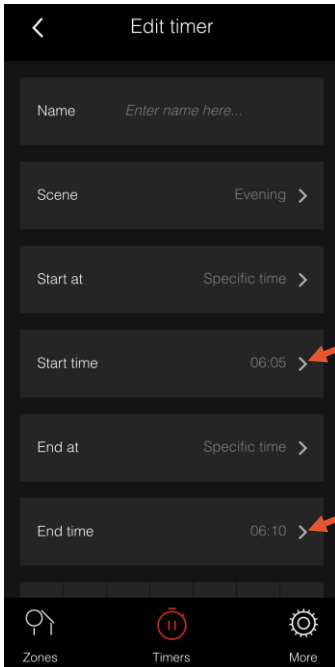

Click on the arrow behind the start time or end time to set at what time the lights should go on and off.

A new screen will open where you can set these time preferences.

Click on 'select' to save the time you entered.

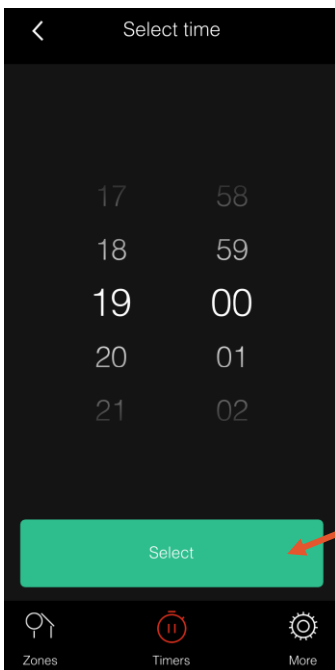

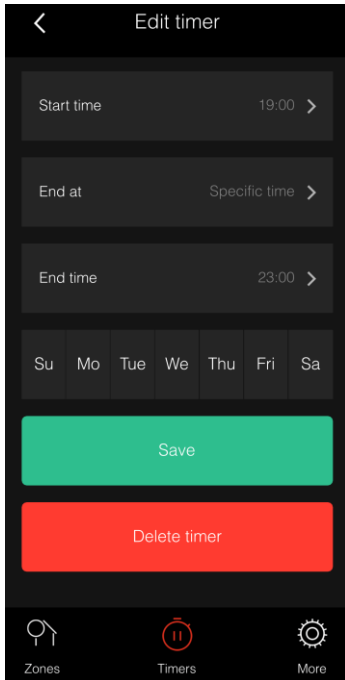

When you scroll down you will see for which days your timer has been set.

You can remove days from this selection by clicking on them. The selected days will then turn dark.

Click on 'save' to save the timer.

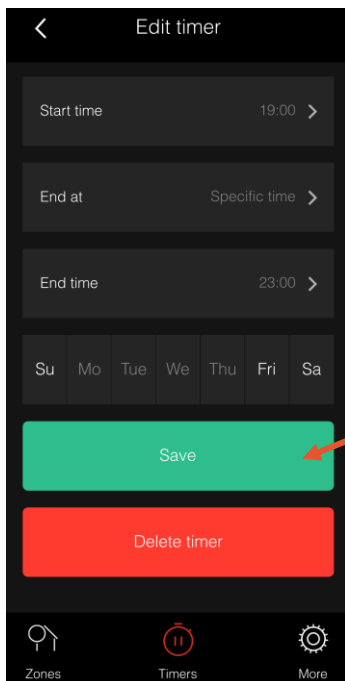

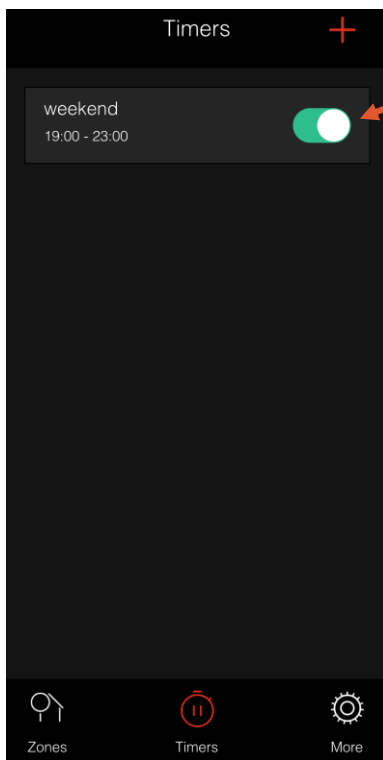

You can now see the timer
in the overview.

Here you can activate or
(temporarily) deactivate it
by clicking on the slide.

Setting the dark/light sensor

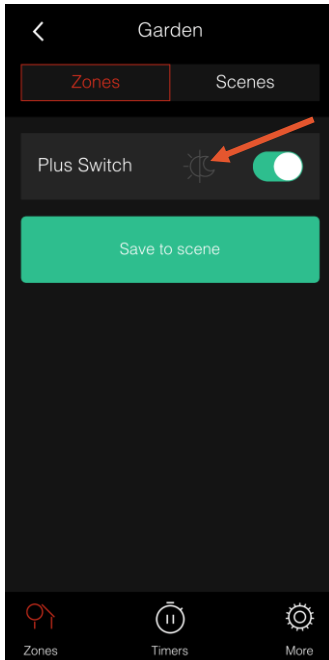

Go to 'zones' in the lower left corner of the screen and open the zone to which the Plus Switch you want to use is connected.

Here you will see an icon of a sun and a moon in dark grey which represents the dark/light sensor.

By clicking on the icon it turns red and the sensor has been activated. When it gets dark or light, the switch now automatically activates or deactivates.

Caution! You cannot activate the sensor and use a set timer at the same time.

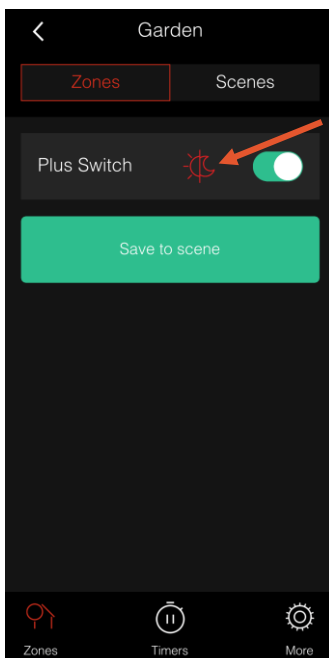



12
VOLT

If you have any questions
please contact us at:

info@techmar.com

+31 884344517