

Read all instructions BEFORE assembly and USE of product.

KEEP INSTRUCTIONS FOR FUTURE USE.

Lea todas las instrucciones ANTES de armar y USAR el producto.

CONSERVE LAS INSTRUCCIONES PARA USO FUTURO.

Lisez toutes les instructions du manuel AVANT l'assemblage ou L'UTILISATION de ce produit.

CONSERVEZ CES INSTRUCTIONS POUR

WARRANTY

DO NOT RETURN YOUR PRODUCT TO THE STORE. PLEASE CONTACT BABY TREND FOR REPLACEMENT PARTS, SERVICE AND REPAIR.

The Baby Trend® warranty covers workmanship defects within the first 180 days of purchase. Any product which has been subjected to misuse, abuse, abnormal use, excessive wear and tear, improper assembly, negligence, environmental exposure, alteration or accident, or has had its serial number altered or removed invalidates all claims against the manufacturer. Any damage to property during installation is the sole responsibility of the end user. The Customer Service Department can be contacted at 1 (800) 328-7363 Monday through Friday between 8:00am and 4:30pm (PST). Return Authorizations are required prior to returning product(s) to Baby Trend®. Warranty only valid in North America.

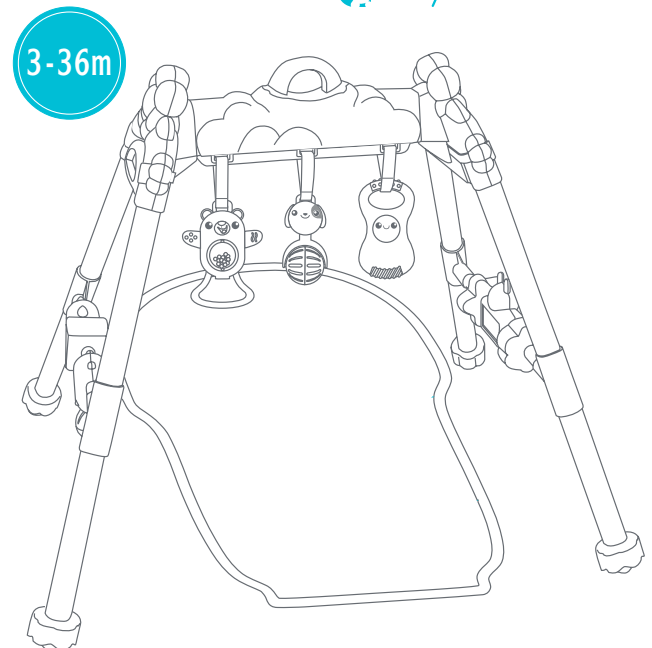

PT03D58A

Jammin' Gym with Play Mat
Instruction Manual
Manual de Instrucciones
Manuel d'instruction

Baby Trend, Inc. 13048 Valley Blvd. Fontana CA 92335
1-800-328-7363 (8:00am ~ 4:30pm PST) www.babytrend.com

WARNING

STRANGULATION HAZARD

Strings can cause STRANGULATION!

- **DO NOT** place items with a string around child's neck, such as hood strings or pacifier cords.
- **DO NOT** suspend strings over product or attach strings to toys. To prevent entanglement injury, never place the Play Gym in a crib or playpen. Never add strings, ties or other products to the Play Gym.

FALL HAZARD!

Babies can FALL from unit resulting in head injuries.

- **NEVER** leave child unattended. Always keep child in view while in product.
- **NEVER** use near stairs, stoves or ovens, heaters, fireplaces, swimming pools, or other dangerous areas. To avoid tip over, place product on a flat, level surface.
- **NEVER** lift this product with your child in it.
- **NEVER** place product on counter tops, tables, or any other elevated surface.
- **ALWAYS** Ensure that all frame parts are completely locked, refer to page 5 for instructions. Check that all pin connections on the Play Gym are secured properly.
- **ALWAYS** make sure the fasteners (ropes, straps, clips, etc.) are securely fastened on the Play Gym.
- **ALWAYS** use parts provided by the manufacturer, never substitute any parts with items not provided by the manufacturer.
- **Keep ALL** packaging out of reach from children.

Do not use the Play Gym if it is damaged or broken.

WARNING

The Play Gym is designed to be used only by infants at least 3 months of age. Discontinue to use the Play Gym when the child reaches 36 months of age.

Discontinue use should any part become damaged. Please contact our customer service at 1-800-328-7363 to order replacement parts or arrange for repairs.

Read all instructions before assembly and use of the Play Gym.

IMPORTANT! To ensure safe operation of your product, please follow these instructions carefully. Please keep these instructions for future reference.

IMPORTANT! Before assembly and each use, inspect this product for damaged hardware, loose joints, missing parts or sharp edges. **NEVER** use if any parts are missing or broken.

IMPORTANT! Adult assembly is required.

MAINTENANCE

Care / Maintenance

- **MACHINE WASHABLE MAT.** Wash the mat separately in cold water on the gentle cycle. Do not use bleach. Tumble dry on low heat.
- The arched bars, hard toys, mirror, bases and frames can be wiped with a clean, damp cloth.
- **DO NOT MACHINE WASH.** The arched bars, toys and plastic parts, use only lukewarm water and mild soap.

Check that you have all the parts for this model
before assembling the Play Gym.

Assembled Parts Diagram Step 6

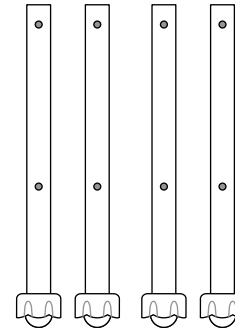

Play Gym Legs (x4)

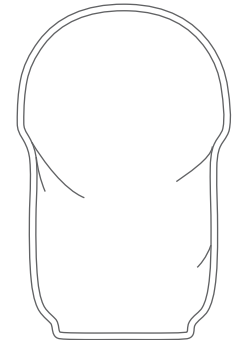

Padded Mat

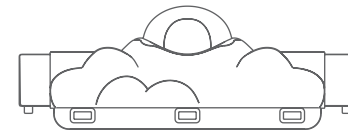

Central Frame

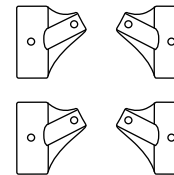

(T) Shape connectors (x4)

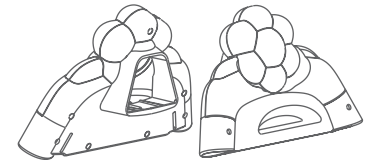

Side frames (x2)

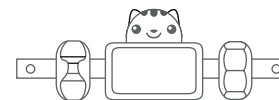

* Assembled
4pc toy and bar #1



* Not - Assembled
4pc toy and bar #2



* Rattle and strap #1



* Rattle and strap #2

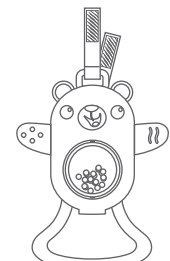

* Rattle and strap #3

* Toys may vary



BABY TREND CUSTOMER SERVICE

The Customer Service Department can be contacted at 1 (800) 328-7363 Monday through Friday between 8:00am and 4:30pm (PST). Return

Authorizations are required prior to returning product(s) to Baby Trend®. Warranty only valid in North America.

TOP FRAME CONNECTION

- 1 • Insert each side frame into the central frame (Fig. 1a).
NOTE: Ensure that they click into position. Slide the lock outward on both sides to secure the side frames (Fig. 1b).

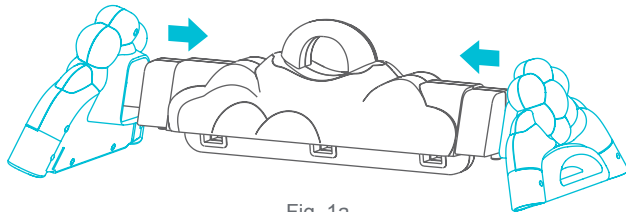

Fig. 1a

- After locking the frames, check that both side frames are secure by gently pulling away from central frame (Fig. 1b).

NOTE: These parts do not separate when lock is correctly engaged.

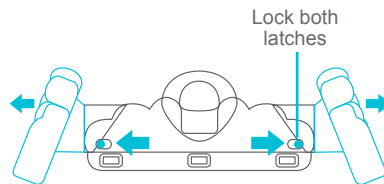

Fig. 1b

BAR AND LEGS

- 2 • Position the (T) shape connectors over the top leg angled as shown in (Fig. 2a). Slide a connector to the second locking pins and secure in place. Continue steps for all other legs until complete. Ensure the small tubes on the connectors point up and all pins click into position.

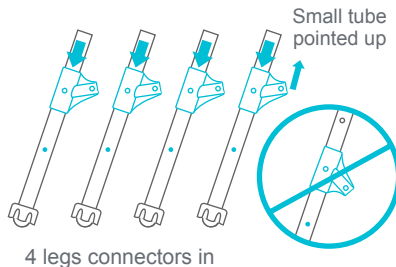

Fig. 2a

- Complete each (T) shape connectors attachment onto each leg and set them as shown in (Fig. 2b). Follow the diagram on (Fig. 2c - Fig.2d) to insert each side toy bar.

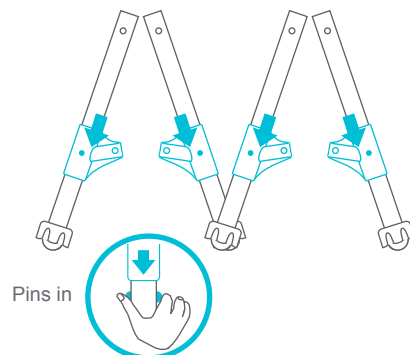

Fig. 2b

- **Not - Assembled Toy Bar:** Pressing the pins, insert the toys into the bar as seen in (Fig. 2c).

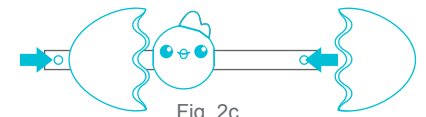
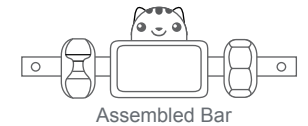

Fig. 2c

- **Assembled Toy Bars:** Pressing the pins, insert the toy bar to the first pair of legs. Repeat for the second toy bar (Fig. 2d).



- Pressing the top pins insert each pair of legs to the side frames attached to each side of the central frame (Fig. 2e).

NOTE: Face the toys outward or inward when completing the frame assembly. All pins must click into position.

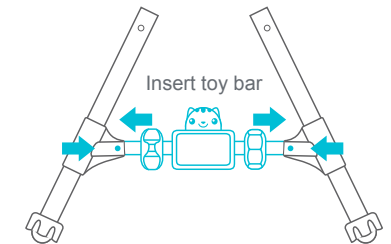

Fig. 2d

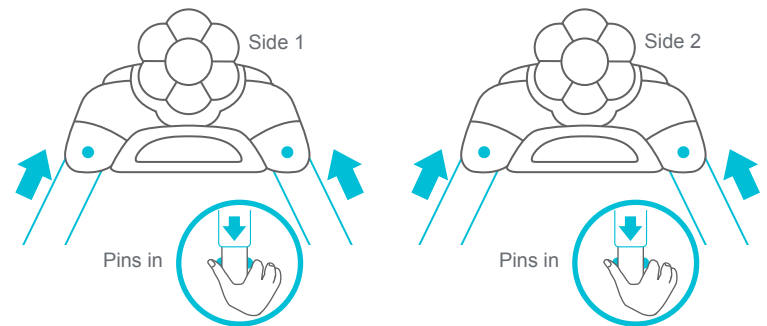

Fig. 2e

ATTACHING THE TOYS

- 3 • Use the straps attached to the toys to thread them through the open slots of the central frame (Fig. 3a).

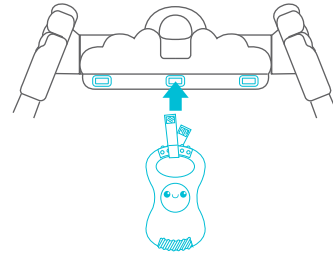

Fig. 3a

- Undo the strap hook and loop for toy threading (Fig. 3b).

- Face the toys to front of the central frame assembly, thread strap and toy through the slot as desired (Fig. 3c).

NOTE: Always use the hook and loop to secure the toy onto the central frame.

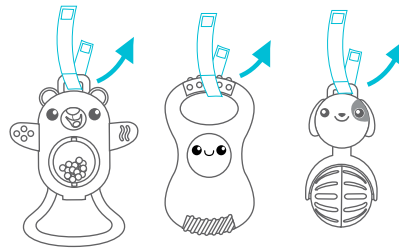

Fig. 3b

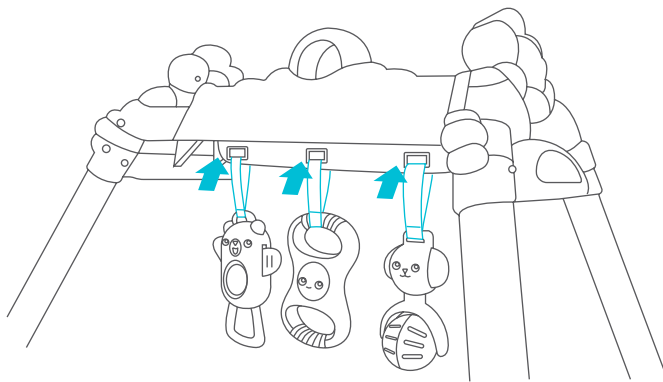

Fig. 3c

- To adjust the rattle toys: undo the hook and loop on the strap (Fig. 3d). Remove the strap with toy rattle from the central frame. Rethread the strap through the slots to reconfigure the toys. (Fig. 3e).

NOTE: Always use the hook and loop to secure the toy onto the central frame.

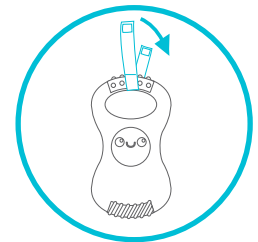

Fig. 3d

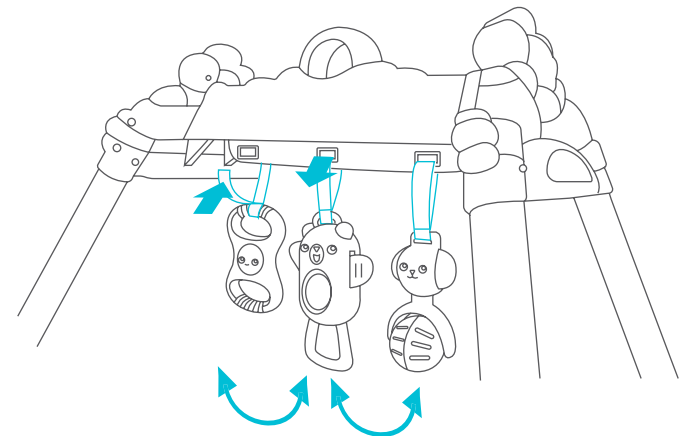

Fig. 3e

ASSEMBLY

PLACE THE PADDED MAT

⚠ WARNING: Never leave child unattended. Always keep child in view while in product. NEVER put child under the mat.

- 4 • Center the padded mat between the frame legs and under the frame assembly (Fig. 4).
NOTE: Padded mat may be used without the frame and toy assembly.

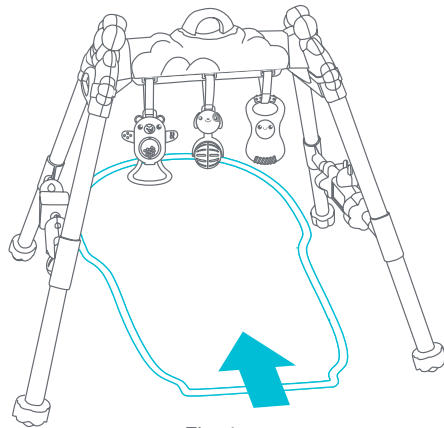

Fig. 4

ASSEMBLED VIEW AND PARTS

- 6 • Use the diagram to see parts and locations. Use the list to identify parts for set up and disassembly.

A. Central Frame
B. Side Frame
C. Leg
D. Connector
E. Toy Rattle / Strap
F. Toy Bar
G. Padded mat

- For assembly or to disassemble assistance see (Page 3) to contact customer service.

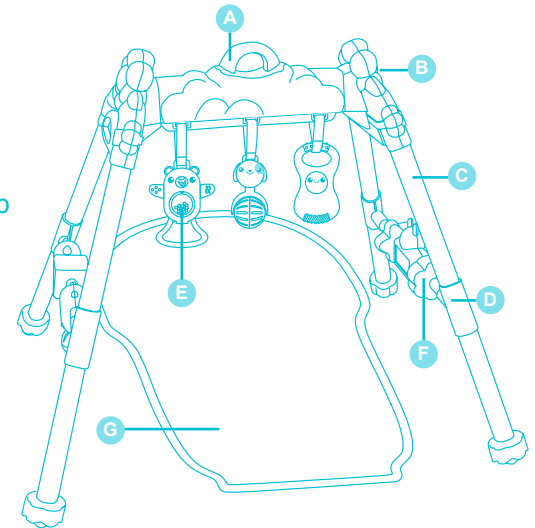

TO DISASSEMBLE

TO DISASSEMBLE FRAME

- 5 • Unlatch the left latch to the right and the right latch to the left. Listen for the latch to disengage. Pull the 2 side frames away from the central frame (Fig. 5a).
• Press in the pins on the side frames to release the each leg with attached toy bar from the framing. Press the pins on each side of the toy bars to release them from the legs.
• (T) shape Connector removal is optional: Press the pins and remove each connector from each leg.

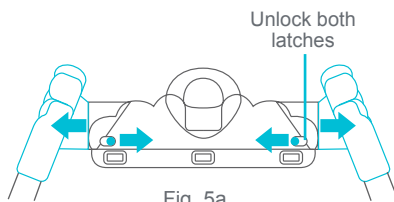

Fig. 5a

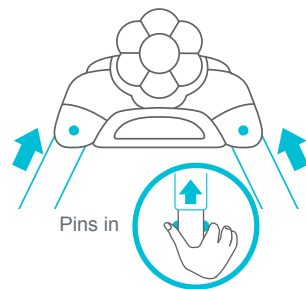

Fig. 5b

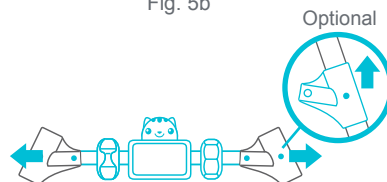

Fig. 5c

ATTACH / REMOVE TOYS

TOY ATTACHMENT STRAP

- 7 • Use hook and loop to attach or remove toys (Fig. 7).

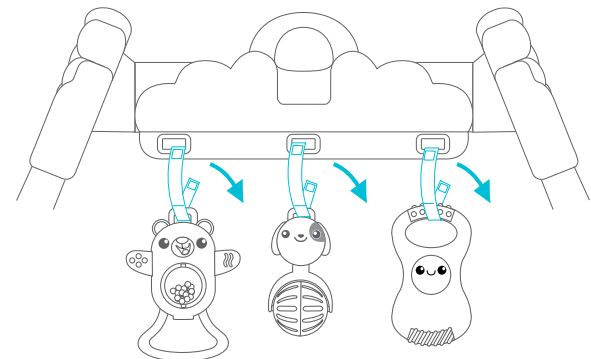

Fig. 7