

## PLEASE ENSURE YOU SWITCH LIGHT ON

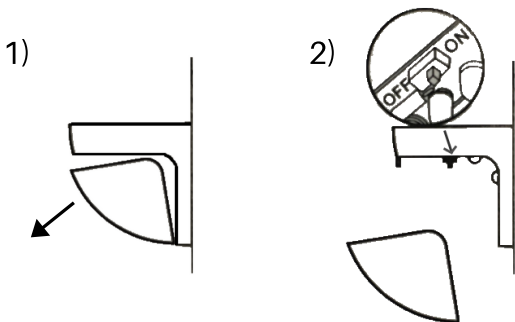

1) Remove/unclip plastic clear casing from light.

Sometimes the plastic is on quite tight, so you may need to be tough with it. The casing is very durable.

2) Click the on/off button to activate the light

This will allow your light to charge and illuminate in darker conditions

3) Place the plastic clear casing back onto the light and mount your light in a position that receives direct sunlight without any shade.

\*Position light in direct sunlight for 8 hours to charge the battery fully. Charging time depends on sunlight intensity.

## How to remove clear plastic cover:

Place your hand over the plastic cover and 'pinch'. The cover should then pry off.

Please note: Sometimes it can be a bit tight, so you may need to be a bit tough with it



The amount of sunlight received will effect the length of time the light illuminates for.

**example:** If light has received 8 hours of direct sunlight, the light will illuminate for longer than receiving 8 hours of dull or secondary light.

This means day-to-day the light may illuminate for different lengths of time.

### **Battery Specification**

Solar Panel: 2V, 0.26W

Battery: 1.2V, 600mAh

AA Ni-MH rechargeable battery

LED: 6PCS

Charge Time: Approx 8 Hours

Working Time: 6-8 Hours after full charge

Waterproof: IP65