

These instructions cover the preparation of doors and installation of **CS FH-Ceiling Mount Single Track**. Read through the notes carefully before beginning as different mounting plate positions and setups may be required for different configurations.

All units with Full-Height detail should be installed completely before the ceiling is fitted. Take care to ensure installed track height suits ceiling installation.

1 Contamination of the top track.

Never drill, nail or screw through the center section of the track. Make sure no dirt, grit or aluminum swarf gets into the track. This could impair the smooth running of the carriages.

2 Prepare the doors.

Drill two holes in the positions marked (V1 or V2).

Screw both mounting plates to the door. Make sure they are placed exactly in the center of the door thickness.

At the bottom of the door leaf, cut a groove to the dimension and tolerance shown. Make it central of the door thickness and absolutely straight.

3 Install the track (drawing X).

Important: The track must be installed level otherwise the door will roll open or closed by itself.

Fix through all the pre-drilled fixing holes provided (drawing X) and never through the center of the track.

The underside of the track should finish 1-2mm (1/16") below the underside of the ceiling before stopping.

Fit J-mold (not supplied) along track where required. Cut ceiling lining in and fix.

Plaster and finish, taking care to keep the inside of the track free of dust and paint splatter by masking the track slot as much as possible.

4 Fix the T-Guide (drawing W).

Fix the T-Guide to the floor so that it is not visible when the door is in the pocket. The front edge of the T-Guide should sit flush with the final casings.

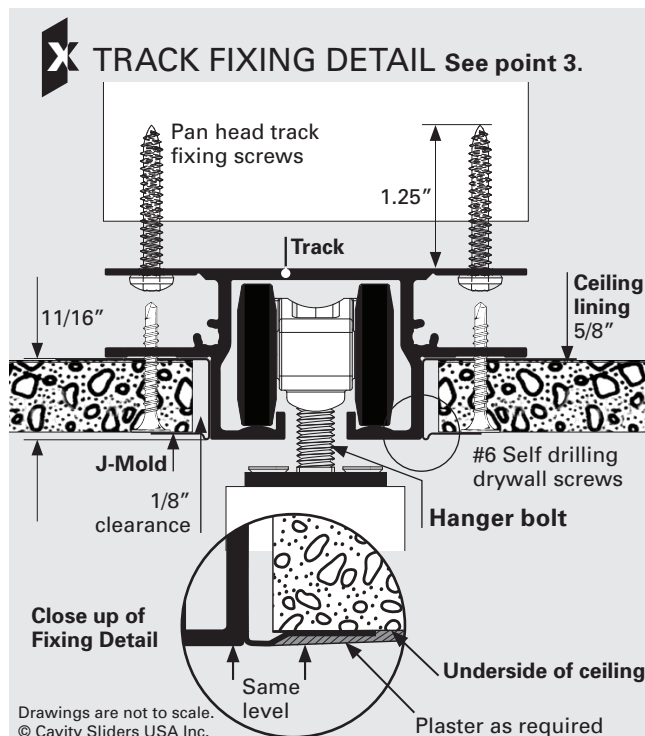
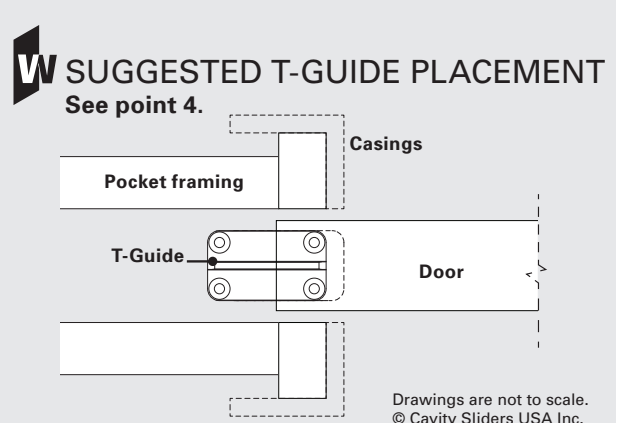
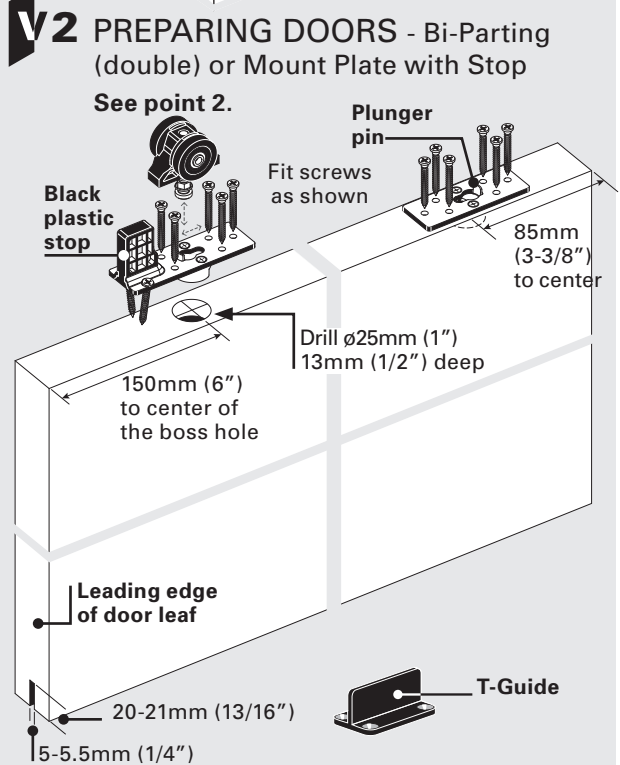
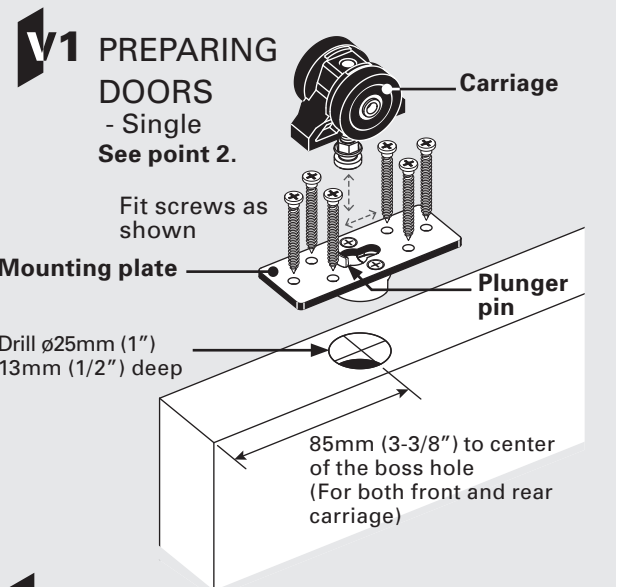

Drawings are not to scale.
© Cavity Sliders USA Inc.

Drawings are not to scale.
© Cavity Sliders USA Inc.

5 Hang the door(s).

Insert the carriages into the track through the notched end, taking care not to damage the wheels on the sharp edge of the track.

Position the carriages in the track approximately where the mounting plates on the door will be located when the door is in the closed position.

Slide the door over the T Guide.

Align the mounting plates with the hanger bolts of the carriages.

Offer the mounting plate up onto the hanger bolt by lifting the door (you may need someone to help you or use a lever at the base of the door). The head of the hanger bolt should mate with the plunger and sink 1/8" before you can slide the bolt across and lock into place. The plunger should pop back up once it is correctly located.

Adjust door(s) for plumb and desired under door clearance (drawing Z).

6 For Double (Bi-Parting) doors (drawing Y).

Slide the track stop into the track (via the carriage removal notch) and loosely tighten so that the track stop is still able to slide.

Use the door to push the track stop to where you want the door to stop. Slide the door away and tighten the track stops using an Allen key.

7 Adjust the door height (drawing Z).

Use the small end of the wrench supplied to rotate the hexagonal nut at the bottom of the carriage hanger shaft.

To **raise** door: Rotate wrench from **left to right**.

To **lower** door: Rotate wrench from **right to left**.

Note: The top of the hanger shaft screws into a self-locking nut. If the hexagonal nut is turned downwards too far, the shaft will become loose from the self-locking nut. If the turning resistance suddenly feels much easier, you have gone too far.

If you raise the door to the maximum height position, the threaded bolt may contact fixing screw heads. If required, remove hanger bolt from wheel and remove 2-3mm (1/16" - 1/8") of thread.

8 Removing the door(s) (drawing Z).

Fit the club end of the adjusting wrench over the hexagonal nut at the bottom of the hanger pin

Use the extended part of the wrench to press down the plunger pin that protrudes up from the mounting plate. Once this plunger is fully depressed, slide the wrench sideways towards the plunger pin.

The whole carriage (including the shaft) will now disengage from the mounting plate.

It is not always easy to slide the wrench sideways. You may need to relieve the door's weight by putting a wedge between door and floor.

Do the same with the other carriages.

Bi-Parting Doors: remove the black plastic stop that is tightly fitted into the mounting plate at the front of each door leaf. Remove this by tapping it out in the direction shown using a hammer and drift (drawing Z).

If you also want to take the carriages out: slide them towards the center of the opening.

Y BI-PARTING (DOUBLE) DOORS See point 6.

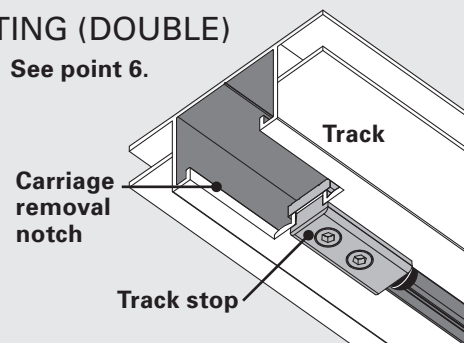

Z ADJUSTING & REMOVING CARRIAGES See points 5, 7, & 8.

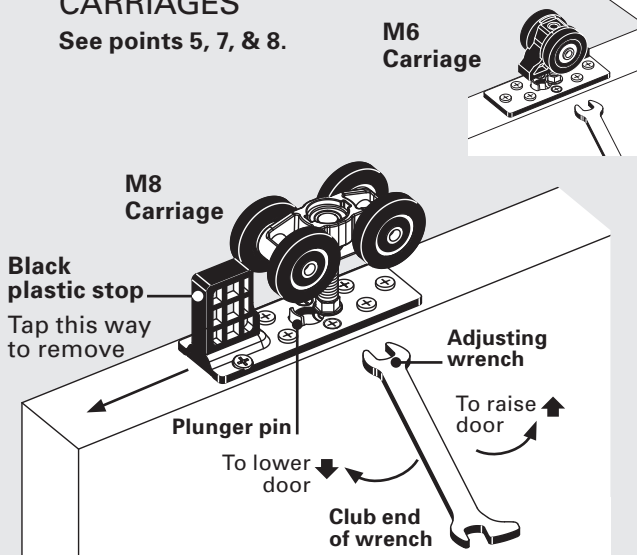

IMPORTANT

Original track slot width must be maintained when lining ceiling. Smooth running may otherwise be affected.

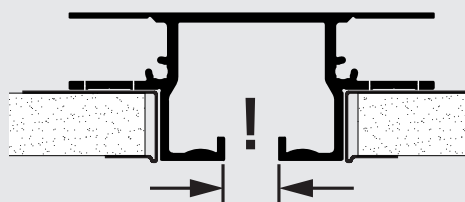

DO NOT PINCH!

Drawings are not to scale.
© Cavity Sliders USA Inc.

9 Painting the track.

If track is to be painted on site to match the ceiling color, we recommend the use of Rust-oleum self etching primer first. Follow the manufacturer's instructions for preparation and application (available for download from our website).

Apply top coat.

Keep this "HowTO" handy.
You may need it later on.

Another quality product from:

CavitySliders

High Quality Sliding Door Hardware