

NOTES CONTINUED:

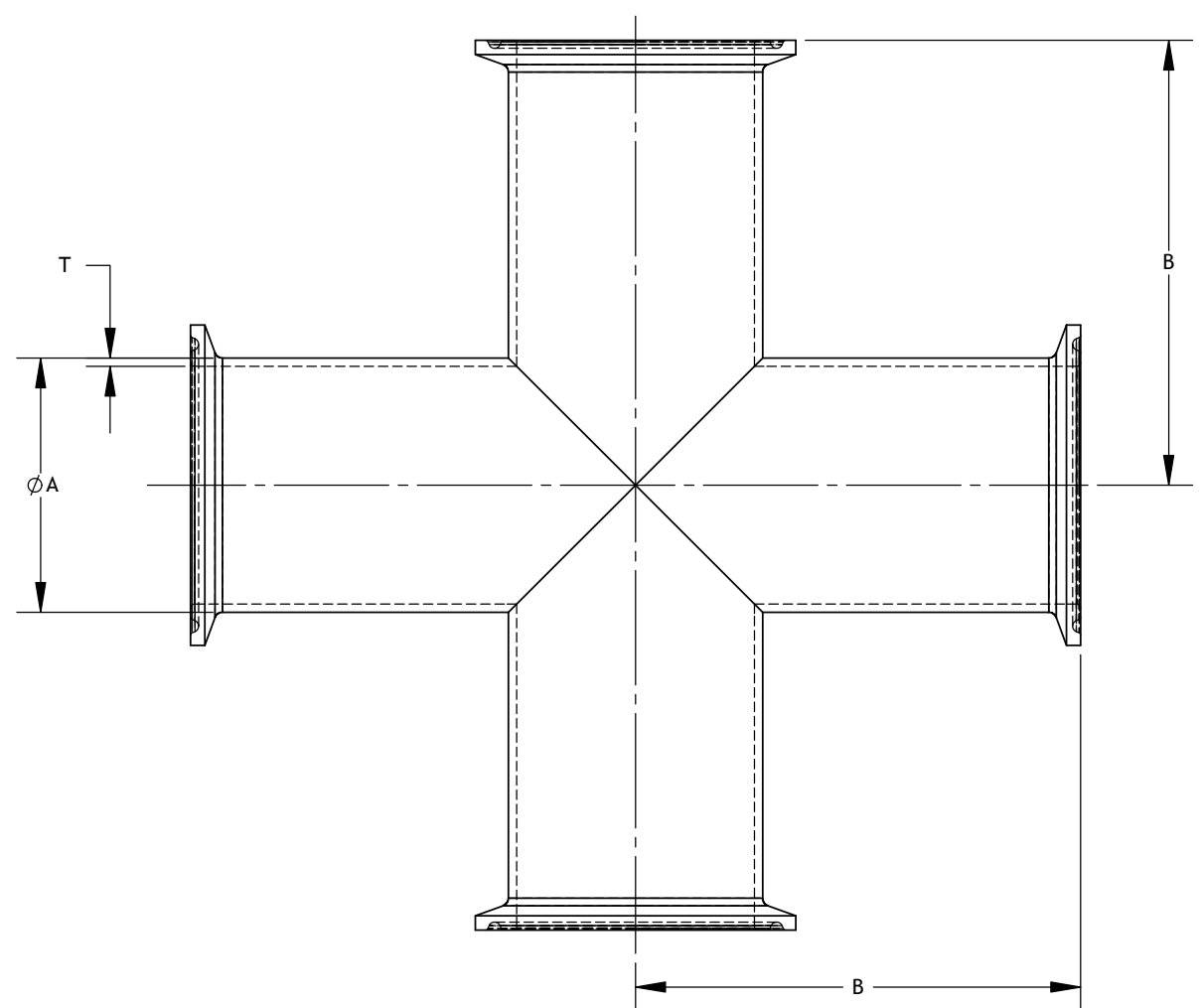

SKU	Part	Material	ØA		B		T	
			Inch	mm	Inch	mm	Inch	mm
B9MP G0100	0710.0914.4010	304	1	25.4	2.37	60.3	0.065	1.651
B9MP G0150	0710.0914.4015	304	1.5	38.1	2.75	70	0.065	1.651
B9MP G0200	0710.0914.4020	304	2	50.8	3.50	88.9	0.065	1.651
B9MP G0250	0710.0914.4025	304	2.5	63.5	3.50	88.9	0.065	1.651
B9MP G0300	0710.0914.4030	304	3	76.2	3.75	95.3	0.065	1.651
B9MP G0400	0710.0914.4040	304	4	101.6	4.50	114.2	0.083	2.108
B9MP R0100	0710.0914.6010	316L	1	25.4	2.37	60.3	0.065	1.651
B9MP R0150	0710.0914.6015	316L	1.5	38.1	2.75	70	0.065	1.651
B9MP R0200	0710.0914.6020	316L	2	50.8	3.50	88.9	0.065	1.651
B9MP R0250	0710.0914.6025	316L	2.5	63.5	3.50	88.9	0.065	1.651
B9MP R0300	0710.0914.6030	316L	3	76.2	3.75	95.3	0.065	1.651
B9MP R0400	0710.0914.6040	316L	4	101.6	4.50	114.2	0.083	2.108

0710_0914-9MP_Short_Clamp_Equal_Cross_3A_Rev_0.2, PART PDM REV: 1.0

PROPRIETARY AND CONFIDENTIAL

THE INFORMATION CONTAINED IN THIS DRAWING IS THE SOLE PROPERTY OF CRAFT KETTLE BREWING EQUIPMENT. ANY REPRODUCTION IN PART OR AS A WHOLE WITHOUT THE WRITTEN PERMISSION OF CRAFT KETTLE BREWING EQUIPMENT IS PROHIBITED.

NOTES AND TOLERANCES: (UNLESS OTHERWISE SPECIFIED)

DIMENSIONS ARE IN MM [INCHES]
TOLERANCES:
.X ±
.XX ±
ANGULAR ± °

1. INTERPRET DRAWING PER ASME Y14.5-1994.
2. REMOVE ALL SHARP EDGES.
3. DO NOT SCALE FROM DRAWING.

MATERIAL: - FINISH: 0.8 µm NEXT ASSY



REV.	DATE	DESCRIPTION	ZONE
-	-	-	-

PART NAME: **CLAMP EQUAL CROSS | 3A (B9MP)**

DESIGNER	D. BROWN	26/09/2019	DWG. NO.	REV.
DRAFTER	D. BROWN	23/09/2019	0710.0914	2.0
CHECKER				
APPROVAL				

SIZE: B SCALE: 2:3 PROJECTION: SHEET: 1 OF 13