

NOTES CONTINUED:

SKU	Part	Material	ØA		B		T	
			Inch	mm	Inch	mm	Inch	mm
B7MP G0100	0710.0713.4010	304	1	25.4	3	66.7	0.065	1.651
B7MP G0150	0710.0713.4015	304	1.5	38.1	2.87	73.0	0.065	1.651
B7MP G0200	0710.0713.4020	304	2	50.8	3.4	85.7	0.065	1.651
B7MP G0250	0710.0713.4025	304	2.5	63.5	3.63	92.1	0.065	1.651
B7MP G0300	0710.0713.4030	304	3	76.2	4	98.4	0.065	1.651
B7MP G0400	0710.0713.4040	304	4	101.6	4.75	120.7	0.083	2.108
B7MP G0600	0710.0713.4060	304	6	152.4	7.1	181.0	0.109	2.769
B7MP R0100	0710.0713.6010	316L	1	25.4	3	66.7	0.065	1.651
B7MP R0150	0710.0713.6015	316L	1.5	38.1	2.87	73.0	0.065	1.651
B7MP R0200	0710.0713.6020	316L	2	50.8	3.4	85.7	0.065	1.651
B7MP R0250	0710.0713.6025	316L	2.5	63.5	3.63	92.1	0.065	1.651
B7MP R0300	0710.0713.6030	316L	3	76.2	4	98.4	0.065	1.651
B7MP R0400	0710.0713.6040	316L	4	101.6	4.75	120.7	0.083	2.108
B7MP R0600	0710.0713.6060	316L	6	152.4	7.1	181.0	0.109	2.769

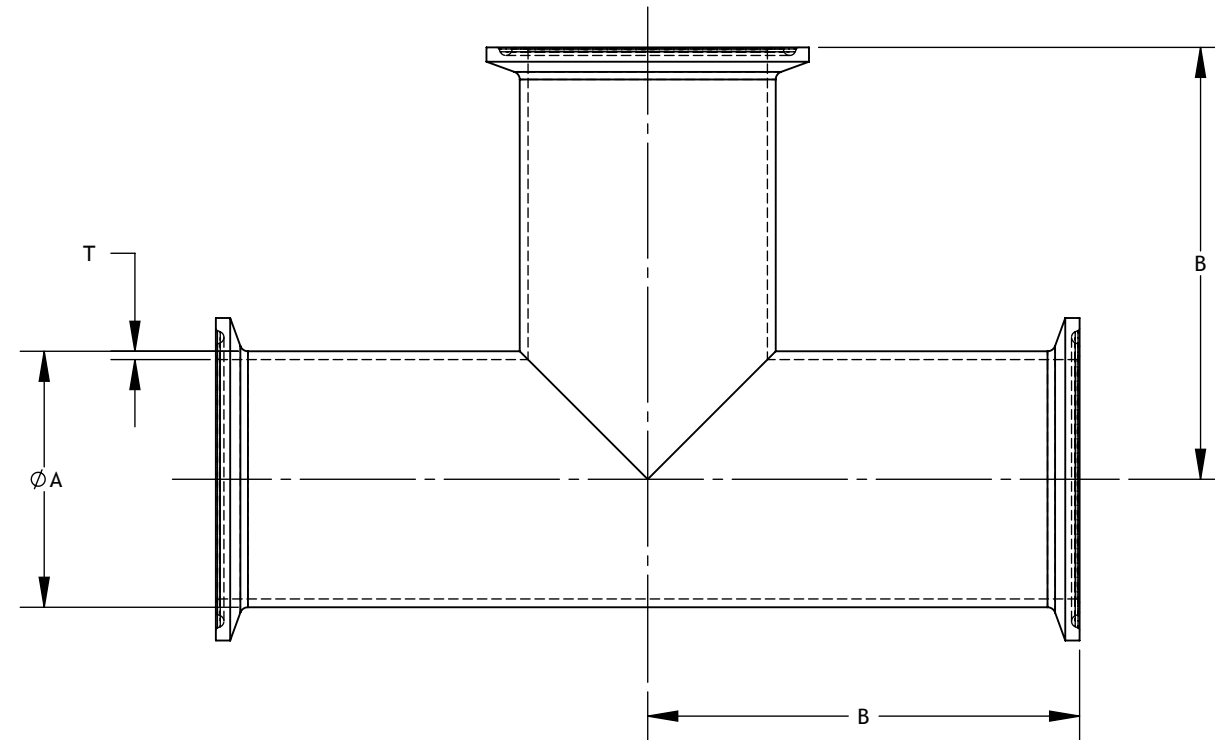

0710_0713-B7MP CLAMP EQUAL TEE, PART PDM REV: 1.0

PROPRIETARY AND CONFIDENTIAL
 THE INFORMATION CONTAINED IN THIS DRAWING IS THE SOLE PROPERTY OF CRAFT KETTLE BREWING EQUIPMENT. ANY REPRODUCTION IN PART OR AS A WHOLE WITHOUT THE WRITTEN PERMISSION OF CRAFT KETTLE BREWING EQUIPMENT IS PROHIBITED.

NOTES AND TOLERANCES: (UNLESS OTHERWISE SPECIFIED)
 DIMENSIONS ARE IN MM [INCHES]
 TOLERANCES:
 .X ±
 .XX ±
 ANGULAR ± °

1. INTERPRET DRAWING PER ASME Y14.5-1994.
 2. REMOVE ALL SHARP EDGES.
 3. DO NOT SCALE FROM DRAWING.

CRAFT KETTLE
 BREWING EQUIPMENT

MATERIAL: - FINISH: 0.8 µm NEXT ASSY

REV.	DATE	DESCRIPTION	ZONE
-	-	-	-

PART NAME: CLAMP EQUAL TEE | 3A (B7MP)

DESIGNER	B. MOORE	08/01/2018	DWG. NO.	0710.0713	REV.	1.0
DRAFTER	B. MOORE	08/02/2018				
CHECKER						
APPROVAL						

SIZE: B SCALE: 2:3 PROJECTION: SHEET: 1 OF 15