

HDMI Matrix

USER MANUAL

ENJOY THE VIVID WORLD

HDMI•UHD

Features:

- Support resolution up to 3840*2160@30Hz
- Supports PCM, Dolby AC3, DTS5.1, DTS7.1 and DSD audio format
- Memorize matrix status after power down, automatically restore previous matrix status after next power on
- Easy to control matrix via IR remote control, panel keypad and PC(via RS232 or LAN port)
- Support smart EDID analyzing, best compatible with most display devices
- Support 4 configurable user preset connections
- Support DVI-D single link sources and displays with the use of HDMI-to-DVI adapters

Model Features	Slim	Pro
TCP/IP Control	No	Yes
LCD display	No	Yes
Rack mount installation	No	Yes
IR extension receiver	No	Yes

Packing List:

- 1 * 4x4 HDMI matrix
- 1 * IR Remote control
- 1 * IR receive cable(Only for 4x4 Pro)
- 2 * Rack-ears(Only for 4x4 Pro)
- 1 * DC 12V power adapter
- 1 * User manual

(4X4 Slim) Panel Description:

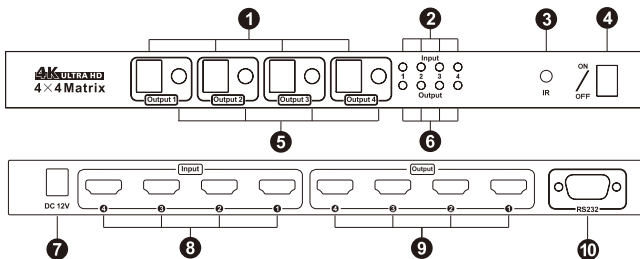

ID	Name	Description
1	LED display	Display current select input source channel number
2	Indicator of input status	LED will be lit if the HDMI input connected to HDMI source device
3	IR receiver	Receive IR remote signal
4	Power switch	Turn on or off matrix power supply
5	Input selection button	Select HDMI input channel
6	HDMI output status	LED will be lit if HDMI output connect to display
7	DC 12V	12V DC power supply
8	HDMI input	Connect to HDMI source devices
9	HDMI output	Connect to HDMI display devices

(4X4 Slim) Panel Description:

ID	Name	Description
10	RS232	Connect with RS232 connector for serial control

(4X4 Slim) Connection Diagram:

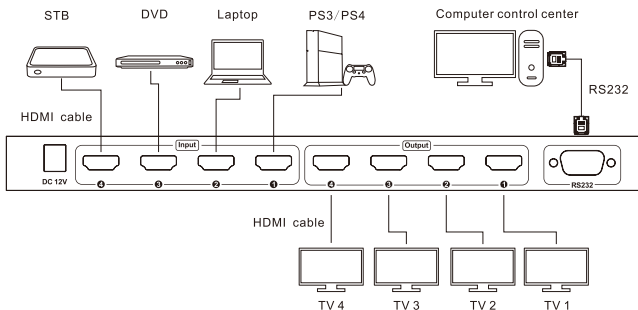

(4X4 Slim) Keypad Use:

Setup all the connections indicated on above connection diagram, then you are able to control matrix with panel keypad. Cyclic press input selection keys under every output LED display, until the LED displays the input port number which just what you expected.

(4X4 Pro) Panel Description:

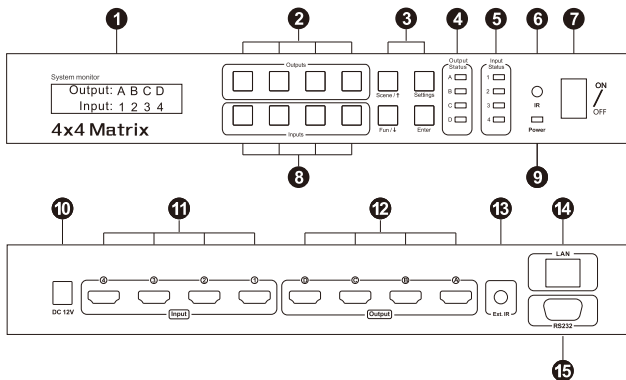

ID	Name	Description
1	16x2 LCD display	Display matrix routing status and system settings
2	Output selection button	Select output port to control
3	Function keys	<p>Scene/↑: Save current routing as user preset and restore user's preset</p> <p>Settings: Change LED time and buzzer status</p> <p>Fun/↓: Fast setting N to N mirrored routing and N to all routing</p> <p>Enter: Enter user's setting</p>
4	Output status	LED indicator of output connection status

(4X4 Pro) Panel Description:

ID	Name	Description
5	Input status	LED indicator of input connection status
6	IR receiver	Receive IR remote signal
7	Power switch	Turn on or off matrix power supply
8	Input selection button	Select input channel
9	Power status	LED indicator of power supply
10	DC 12V	12V DC power supply
11	HDMI input	Connect to HDMI source devices
12	HDMI output	Connect to HDMI display
13	IR extension input	Extended IR receiver cable input
14	Network control port	Connect to local area network, control matrix with TCP/IP commands
15	RS232	Connect to RS232 connector, control matrix with serial commands

(4X4 Pro) Connection Diagram:

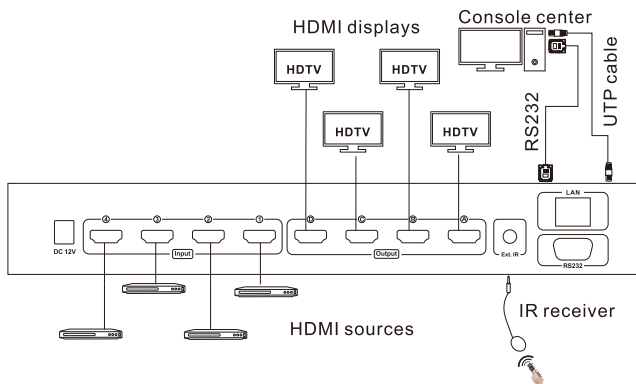

(4X4 Pro) Keypad Use:

1. Selecting sources and outputs by keypad

(1) 1 to 1 switch

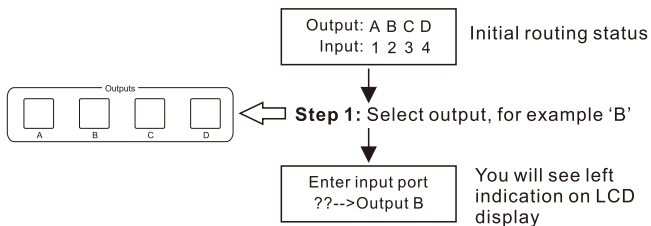

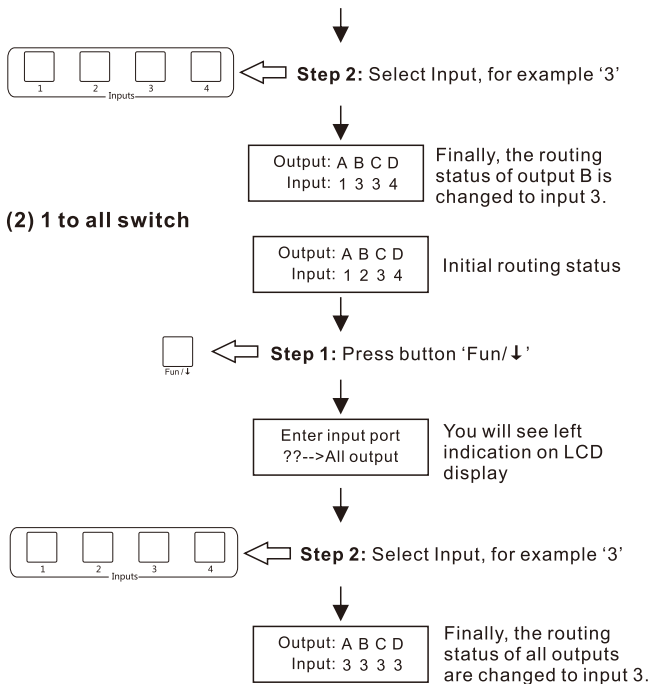

(3) Switch to mirrored connection

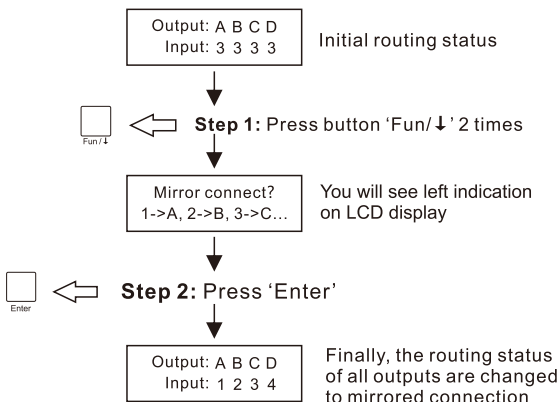

2. Save preset routing status

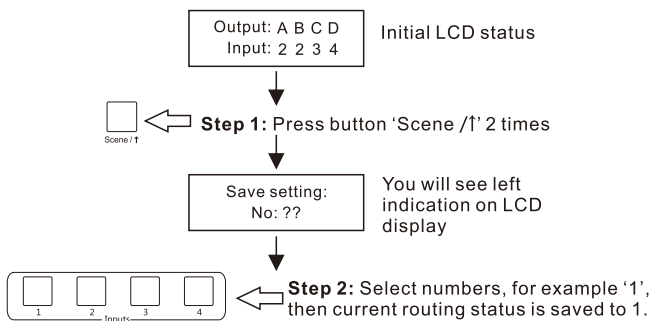

3. Load preset routing status

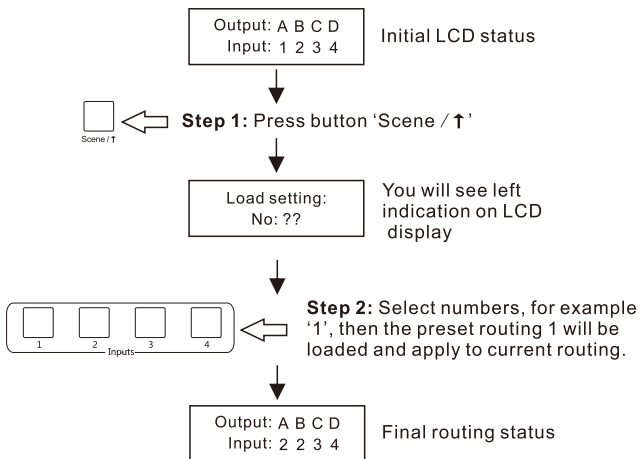

4. Change LED timeout

The LED indicators on front panel, including back light of the LCD display, can be turn off after seconds of inactivity. Below is how to change the settings:

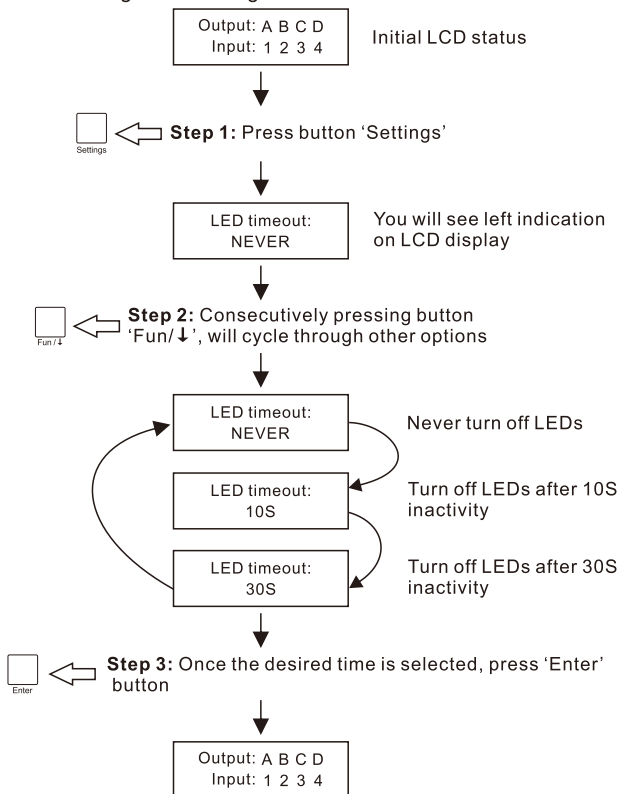

5. Mute/Unmute buzzer

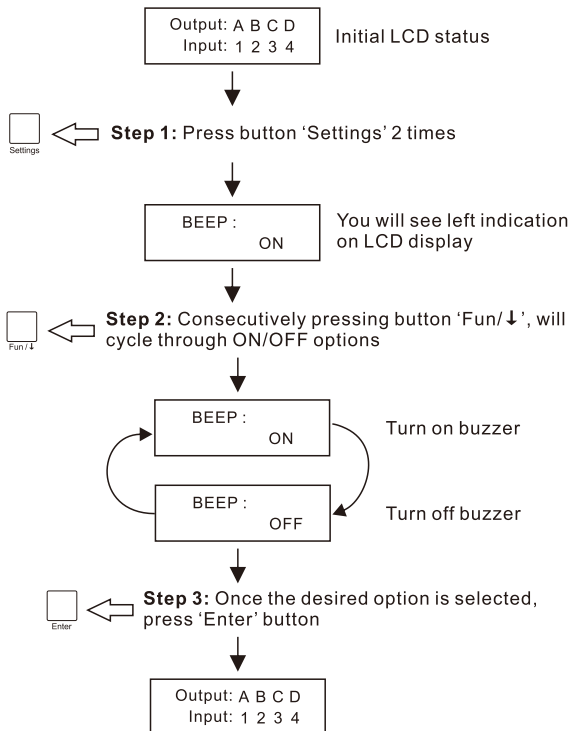

Remote Control:

1. 1 to 1 switch:

Step 1: Press $\boxed{1}$ / $\boxed{2}$ / $\boxed{3}$ / $\boxed{4}$ in output block to select one of the output port you are going to control

Step 2: Press $\boxed{1}$ / $\boxed{2}$ / $\boxed{3}$ / $\boxed{4}$ in input block to select input source which you want to be displayed on selected output

2. Switch to mirrored connection:

Press $\boxed{\text{NTN}}$, then the routing status will be changed to Input 1 - Output A, Input 2 - Output B, Input 3 - Output C, Input 4 - Output D

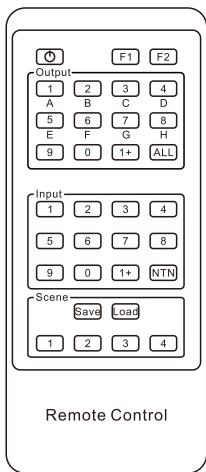

(3) 1 to all switch:

Press $\boxed{\text{ALL}}$, then press $\boxed{1}$ / $\boxed{2}$ / $\boxed{3}$ / $\boxed{4}$ in input block to select input source which you want to be displayed on all output

(4) Preset routing for scenes:

Press $\boxed{\text{Save}}$, then press $\boxed{1}$ / $\boxed{2}$ / $\boxed{3}$ / $\boxed{4}$ in scene block, save current routing status to user preset memory 1/2/3/4.

Press $\boxed{\text{Load}}$, then press $\boxed{1}$ / $\boxed{2}$ / $\boxed{3}$ / $\boxed{4}$ in scene block, load routing status from user preset memory 1/2/3/4 and apply to current routing.

- Note:**
1. For the safety request by some express company, the remote control is not equipped battery by default. Please install the button battery CR2025 before using it.
 2. Unspecified buttons at above are non-functional.

Warranty Information:

We warrant this product as free of defects in material and workmanship for a period of one (1) year from the date of shipment.

If during the period of warranty this product proves defective under normal use, we will repair or replace this product, provided that this product has not been subjected to mechanical, electrical, or other abuse or modifications. If it fails under conditions other than those covered will be repaired at the current price of parts and labor in effect at the time of repair. Such repairs are warranted for six (6) months from the day of reshipment to the buyer.