

BIG COUNTRY

DRIVEN BY ADVENTURE

ROOF RACK

Fitment Instructions

FJ Cruiser



IMPORTANT!

All bolts must only be tightened when the roof rack is positioned on the vehicle's roof.

WHATS IN THE BOX

Additional mounts are available upon request.

1 x Roof Rack

6 x Block Top Plates

6 x Cruiser Brackets

2 x 42 mm "Short" Feet

4 x 75mm "Long" Feet

Fasteners

MOUNTING DIAGRAM

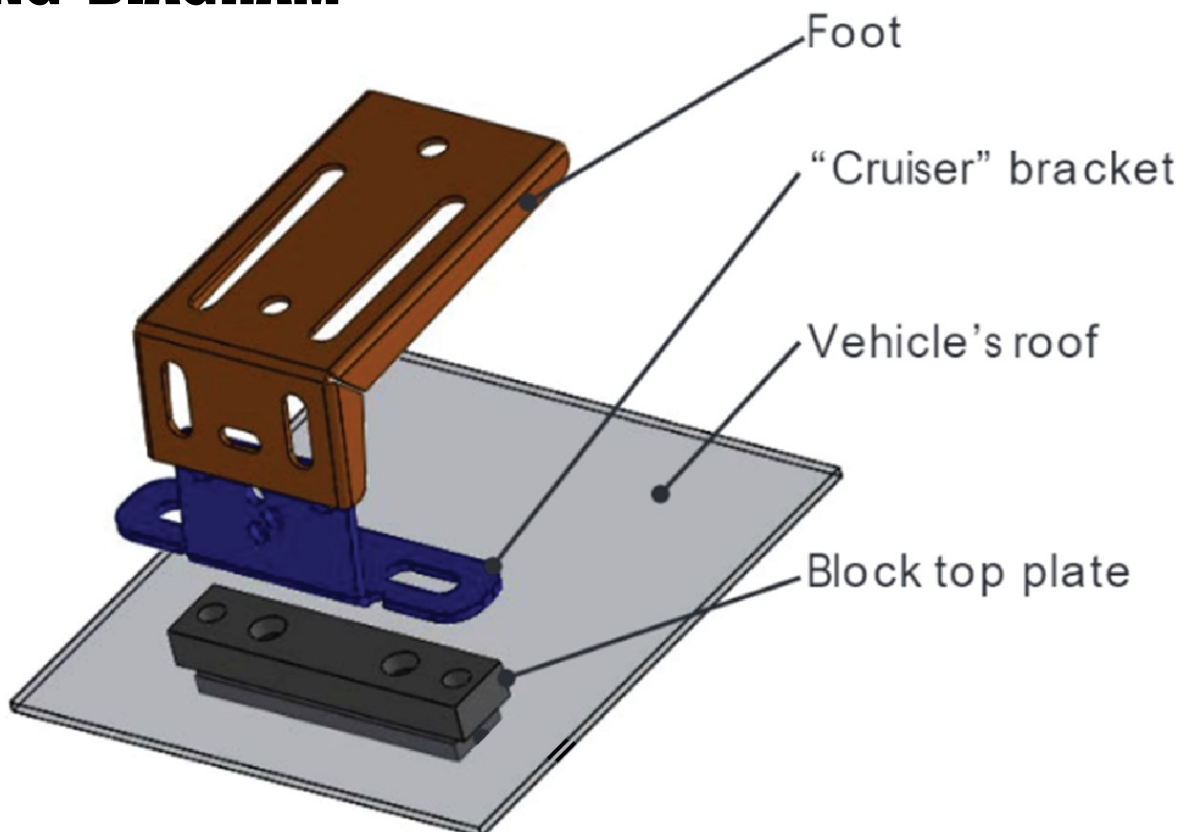

Step 1

Unpack the Roof Rack from its packaging and turn upside down.

Take note:

The centre cross member is closer to the front of the roof rack. It is important to orient the roof rack correctly to ensure the feet line up with the existing mounting points on the vehicle.

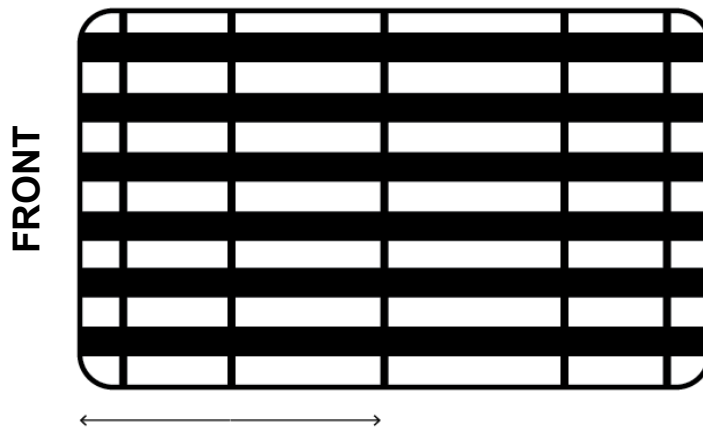

Step 2

Secure the two shorter feet to the centre cross member and the four longer feet to the front and back cross members of the roof rack using the supplied M8 bolts.



Step 3

Attach the cruiser brackets onto the feet. Leave both (the feet and cruiser brackets) loosely fastened.



Step 4

Remove the plastic covers on the roof join to expose the mounting points on the roof. Clean the area with Isopropyl Alcohol. We recommend the use of silicone around the holes to help prevent water ingress.

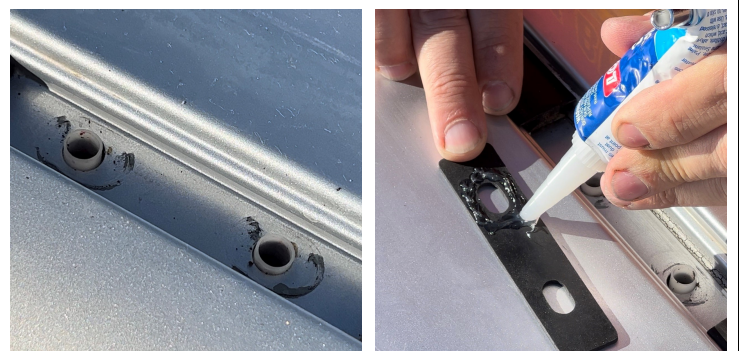

Step 5

Fasten all six block plates into place using the provided countersunk cap screws. Ensure that the rubber plate is placed between the Block Plate and the roof of the vehicle.

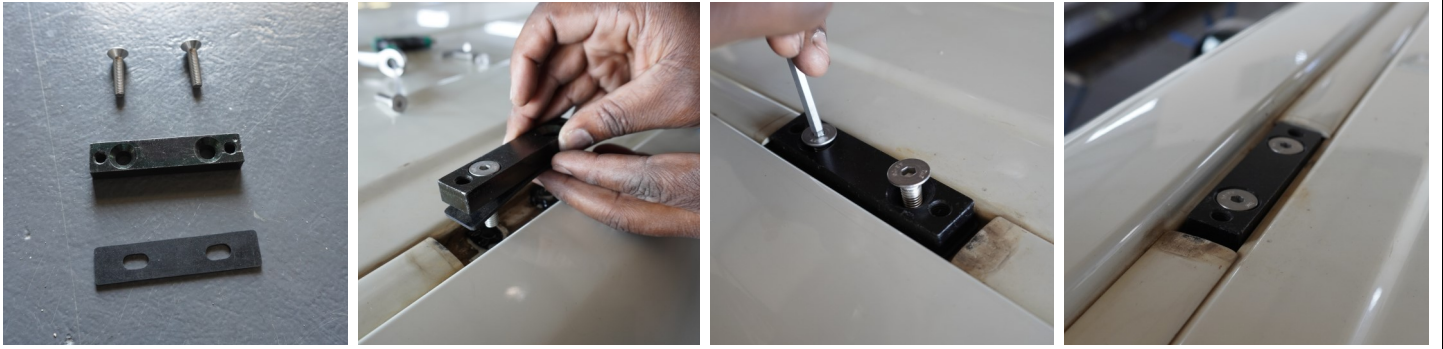

Step 6

Measure the distance between the two front blocks, from centre to centre. Use this measurement to shift the two front feet the same distance apart from each other on the roof rack. Ensure that the feet are also equidistant from the centre of the roof rack, then repeat for the two middle feet and the two back feet respectively. This will ensure that the roof rack is straight and central on the roof of the vehicle.

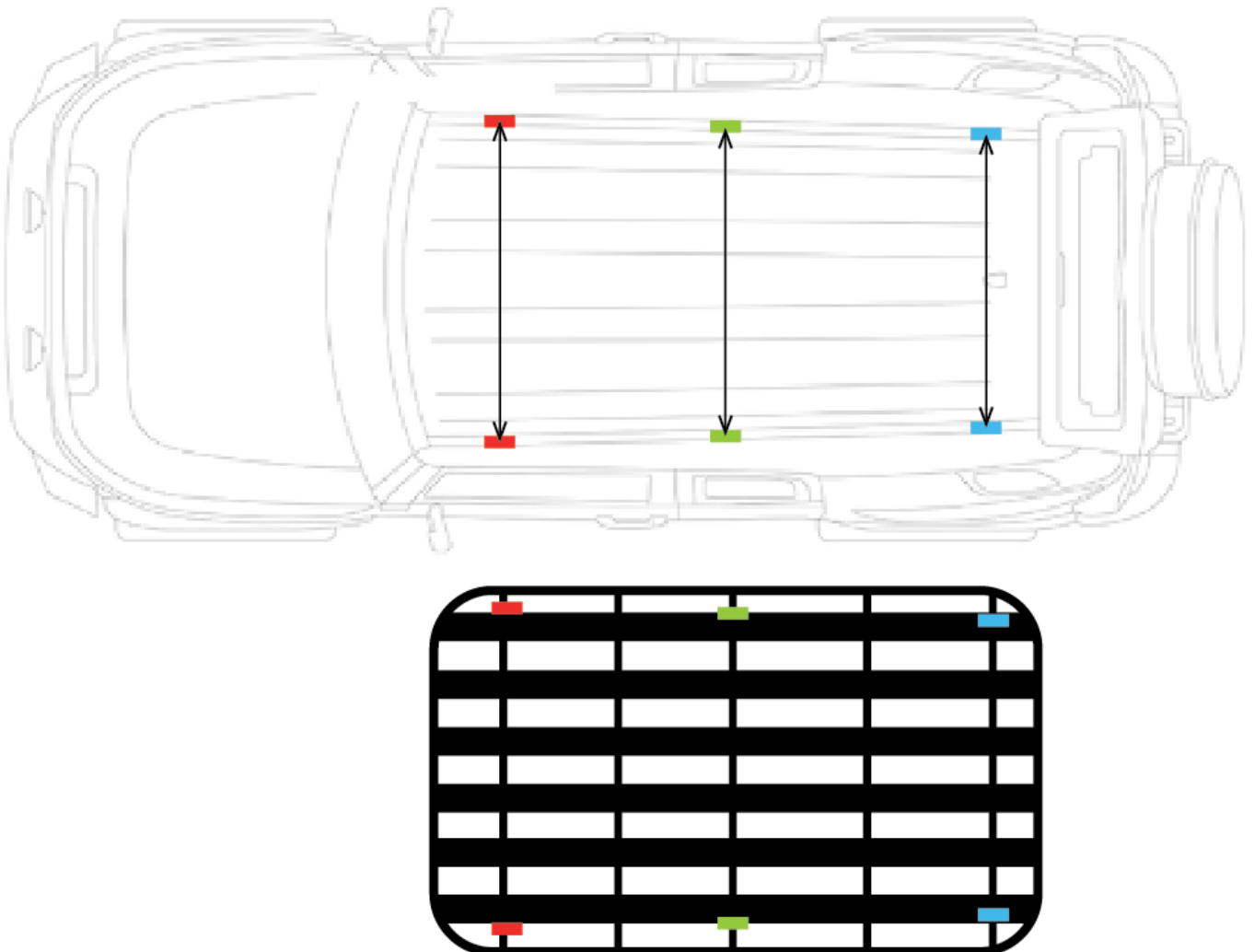

Step 7

We recommend a minimum of two people work together for this step. Carefully lift the roof rack onto the vehicle ensuring that each cruiser bracket meets with the corresponding block plate.



Step 8

Use the provided cap screws to fasten the cruiser brackets to the block plates.



Step 9

Check that the roof rack is level on the roof. Once you are happy with the overall orientation of the roof rack, fasten all remaining bolts and nuts tightly. Finally, cover the exposed fasteners with the provided black plastic hex caps.



Contact Us



067 374 6875



www.bigcountry.co.za



011 795 9700



[bigcountry4x4sa](#)



admin@bigcountry.co.za



[bigcountry4x4sa](#)