

# Harmony Building Material Group Inc.

www.ebhusa.com

## INSTALLATION GUIDE

Model No.: LPH103A

### CLASS FABRICATION

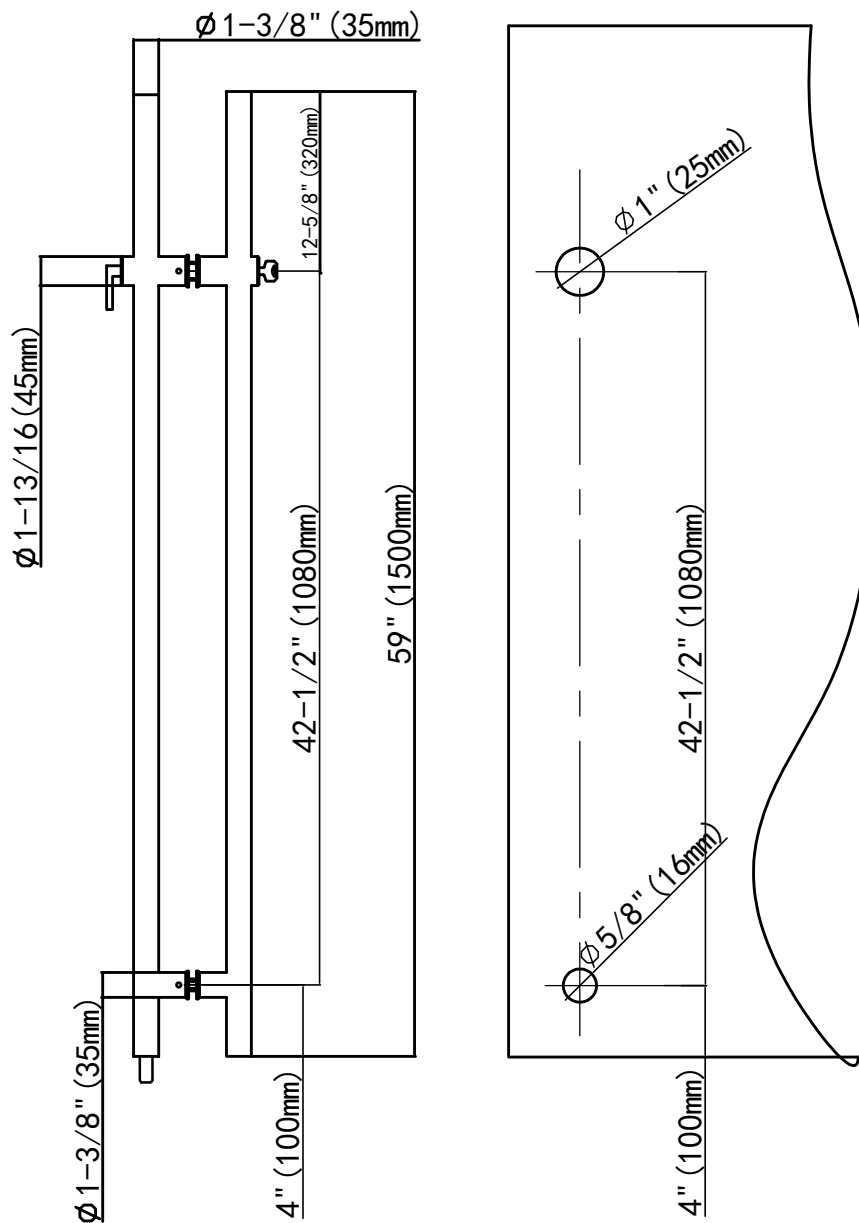

## INSTALLATION GUIDE

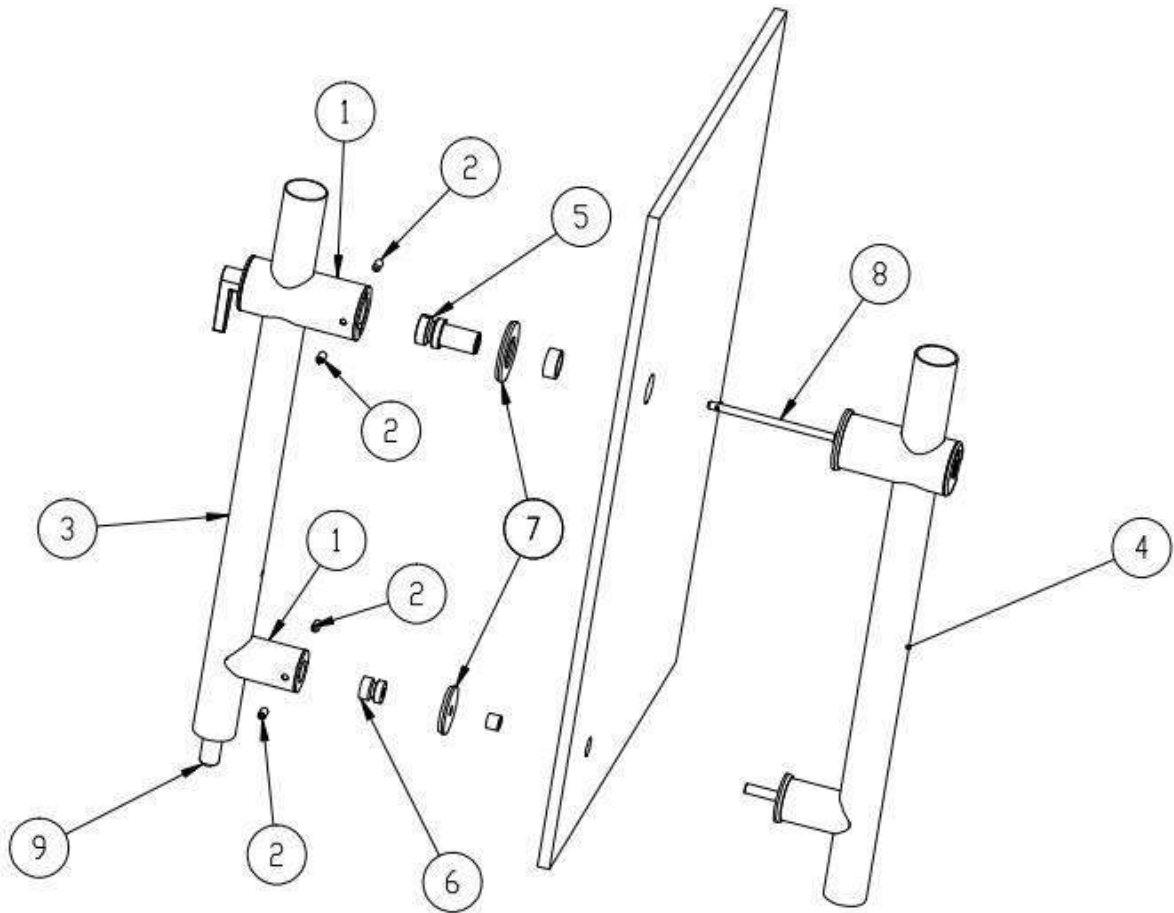

### Please see the drawing how to set up the handle lock:

- 1、 Please use the Allen key loose the ① and ② allen screw in the ③ part handle lock. Take out ② sides of the handle lock ③ and ④
- 2、 Screw out the ⑤ and ⑥ connector screw and the gasket from the ④ part handle lock.
- 3、 Put the ④ part handle lock on the glass, keep the aix ⑧'s pin on the top. Put back the the ⑤ and ⑥ connector. Now the gasket on the ④ part handle lock and screw in ④ part handle lock already set up on the glass.
- 4、 Put back the ③ part handle lock together with the ④ part handle lock. And then use the Allen key screw the ① and ② allen screw in the ③ part handle lock. Until the handle lock set up tire on the glass.
- 5、 Close the door and turn out the lock pin, the position of the pin touch the floor, is the dust poof position.

### Attention:

Don't let the key on the handle lock, when you are setting up the handle lock.