

3rd Gen Multi Dash Cam, 2 to 4 Cams with 10" LCD Heavy Duty for Truckers USER MANUAL

SAFE DRIVING



Hi-3520D Chipset,4-CH/8-CH Real-time Recording

Support USB Back Up & Mouse Control

10.1INCH HD 1024*800 IPS Screen

GPS Functions

Support max 2*512GB SD Card

High-End Metal Monitor Shell Design

1xUSB For Mouse & Back Up, 1xUSB for Media



ITEMS NO.	NAME	DESCRIPTION
1	Monitor Screen	1024*600 HD IPC Screen, 10.1 Inch
2	Back Monitor Shell	Metal Materials, Better heating reduction
3	SD Card Slot	2*SD Card Slot
4	USB Port	Used for Mouse, Video back up and Local Upgrade
5	USB Port	For MP5 Function
6	HDD Candy	Insert Max 2TB HDD/SSID into MDVR
8	GPS Antena Port	Wire with GPS Antena
10	Bracket	Installation Bracket
11	Tale Cable	Wire with Extend cable for 4-CH/8-CH AHD Video Input and 4-CH I/O input

CONTENT

1. SPECS
2. WIRE DRAWING
3. REMOTE CONTROL
4. MONITOR BUTTON
5. MENU INTRODUCTION
6. ADDITIONAL NOTES
7. BACK UP INTRODUCTION

SPECS

MONITOR SPECIFICATION

Chipset	Hi3520D V300
Screen Size	10.1INCH
Screen ratio	16:9
Black Light Luminance	LED,500cd/m2
Resolution	1024*600
Operation Langue	Chinese/English/Spanish etc
Viewing Angle	Hor: L(70) R(70); Ver: UP(50) DOWN(70)
Image reversion	UP/Down and Left/Right
Power requirement	12 / 24V DC , Range 11-32V DC
Power consumption	< 8W
Shockproof level	10G

DVR FEATURES

System	Chipset	HI3520D V300
	Language	Chinese/English
	System	Linux
	Interface	Visual GUI,Support Mouse
Record	Video Standard	PAL/NTSC
	Video Input	4-CH AHD Input
	Resolution	1080P/720P
	Image Quality	4 levels adjustable
	Record Mode	Boot Record

Audio	Audio Input	1-CH Audio input
	Audio recording	Audio & Video synchronized recording
	Audio Compression	G.711u
Playback	Video Search	Recent 3 days/1 week/2 weeks etc,search by time
	4-CH Playback	Support
	Fast /Back Forward	Support 2x/4x/8x Fast/Back forward Playback
Interface	SD Card Slot	Support Max 512GB SD Card
	USB Port	Support Mouse/USB Backup
	I/O Input	4-CH I/O Alarm input
Others	Reverse Line	Support
	Voltage	DC8-36V
	Working Temperature	-30℃ to +70℃
	Humidity	20% to 80%
	Dimension	150mm*88mm
	Weight	0.78Kg

WIRE DRAWING

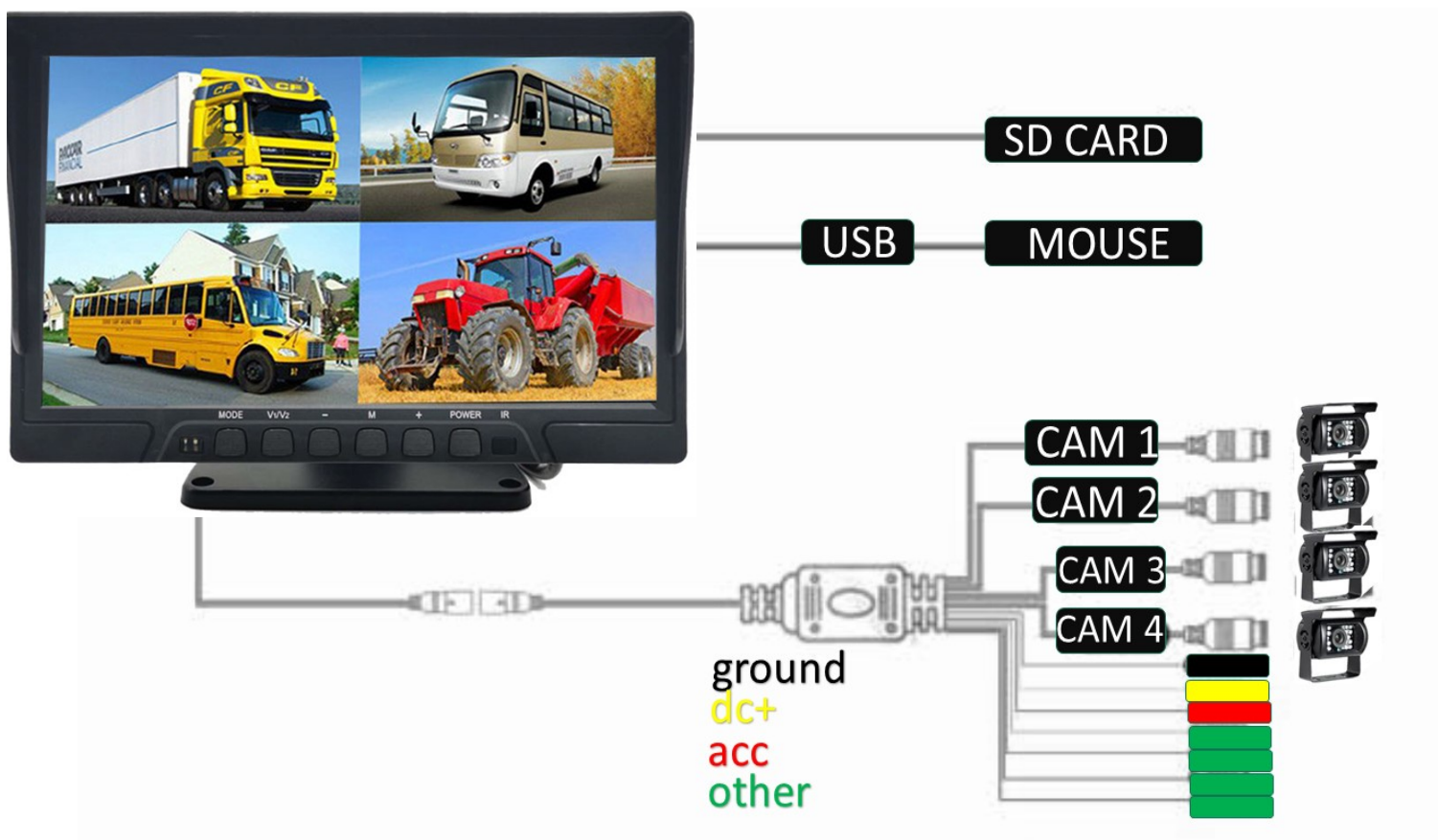

Powering Unit

Black Wire to a ground source

Tie dc+ wire and acc wire together and connect to a power source

REMOTE CONTROL

ON/OFF Monitor Button

Login Menu Button

Function-02: Input Number to Setup time

Function-01: Switch channels
1=CH1,2=CH2,3=CH3.....

Login Info Menu

Return/Canel/Exit Button

"OK" Confirm button

LEFT/RIGHT/UP/DOWN button

Stop, Pause/Play, Fast backward, Fast Forward Buttons

Login Playback Menu



MONITOR BUTTON

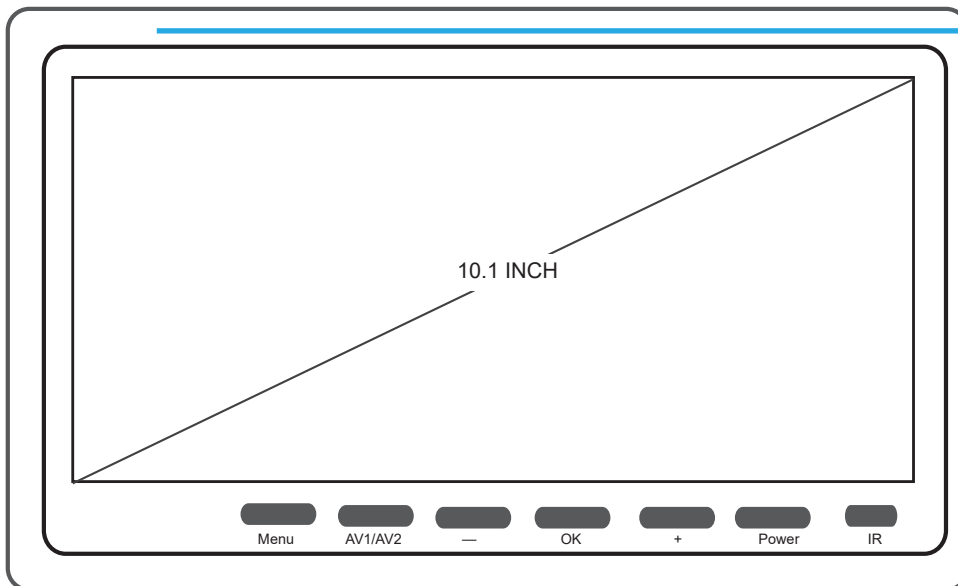

BUTTON DECRPTION

	Login/Logout Menu
	Menu
	Switch AV1/AV2 Video Input Turn Over Main Menu Page
	Go up in the sub menu Reduce Number Value setup
	Confirm Button Left/Right Move
	Go Down in the sub menu Add Number Value Setup like time setup
	Press for a time, Shutt Off the Screen Press for Long time, Shut Down Monitor
	IR Led light for Remote control

MENU-01: Login Monitor=> Main Menu



MENU-02: Select / Check "Record" To Playback/Backup the recorded videos

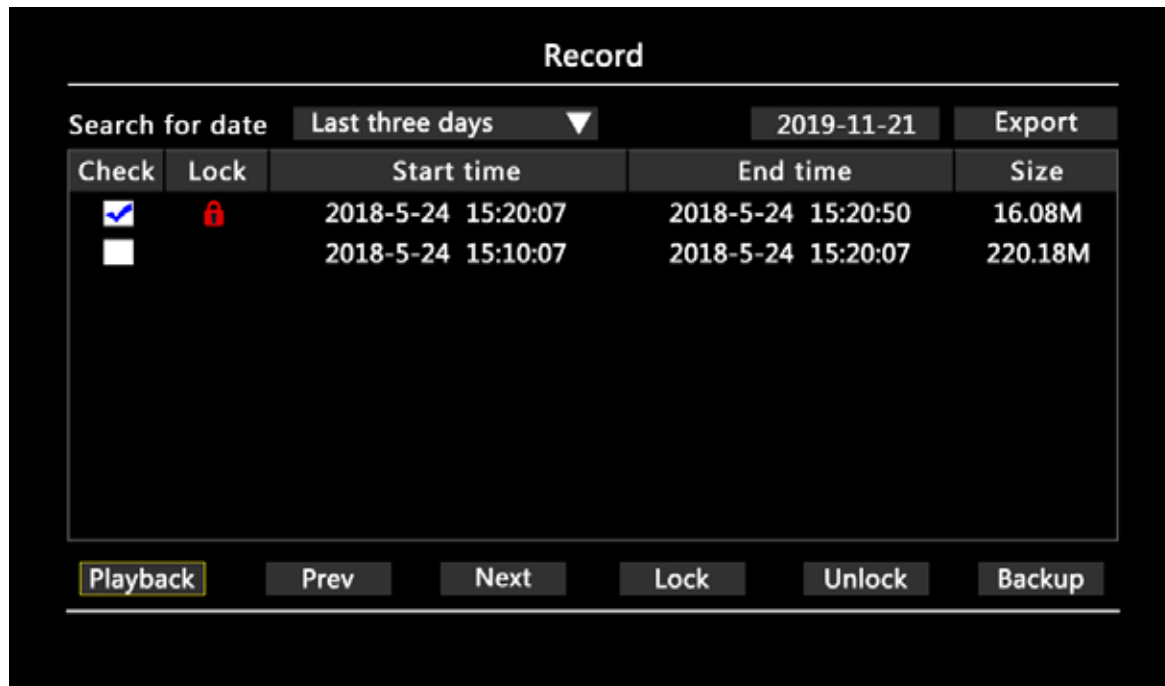

DESCRIPTION:

“Search for date”: Last three days,last 1 week, last 2 weeks,last 1 month or ALL to search out recorded videos

“Export”: Choose one day, like 2019-11-21,to back up the whole day video by USB Port

“Playback”:Playback the recorded video(Support Fast/back Forward,Stop etc Operation)

“Lock”: Check recorded videos=>Click “Lock” which will show red lock,the lock videos will not be overwrite.

“Unlock”: Unlock Locked Videos

“Backup”: Backup the checked videos

MENU-03: Select "General Setting" Setup date time,date format,Video format etc

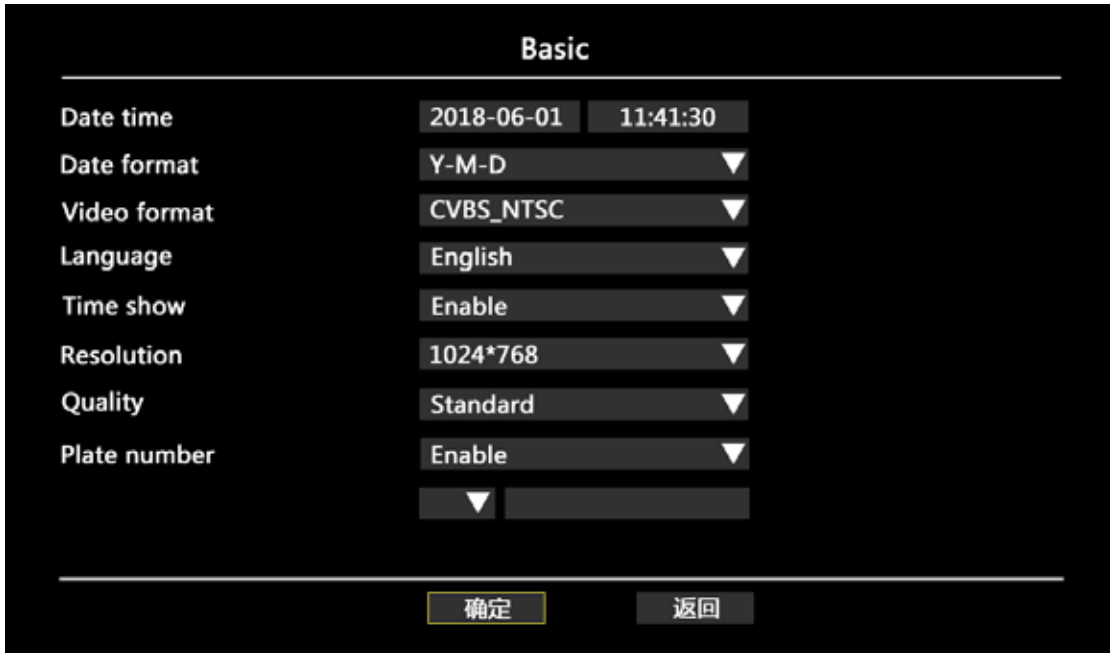

DESCRIPTION:

"Video Format": PAL/NTSC Optional

"Time show": Enable/Disable watermark the time into the recorded videos

"Resolution": Video record resolution

"Quality": Normal,Standard,Clear ,Clearest 4 Classes adjustable.

"Plate Number": Enable to OSD plate number info into the recorded videos

MENU-04: Select "Control Setting" To setup date time,date format,Video format etc



DESCRIPTION:

A. Always Output: After booting, Keep showing videos on Monitor

"Video Output": B. Trigger Output: After booting, Only alarm trigger to show videos on Monitor

C. Smart Output: After booting, Showing video on monitor, Will auto shut off without any operation in 15s

"Display switching": After Alarm trigger Off, Video showing time

"Auto sequence": The video image auto sequence time

"Record For Park": Delay off time setup after engine off to keep recording. While voltage is lower DC10.5V, Montior will auto shut down totally.

"Audio Recording": Diable/Enable to record audio with video

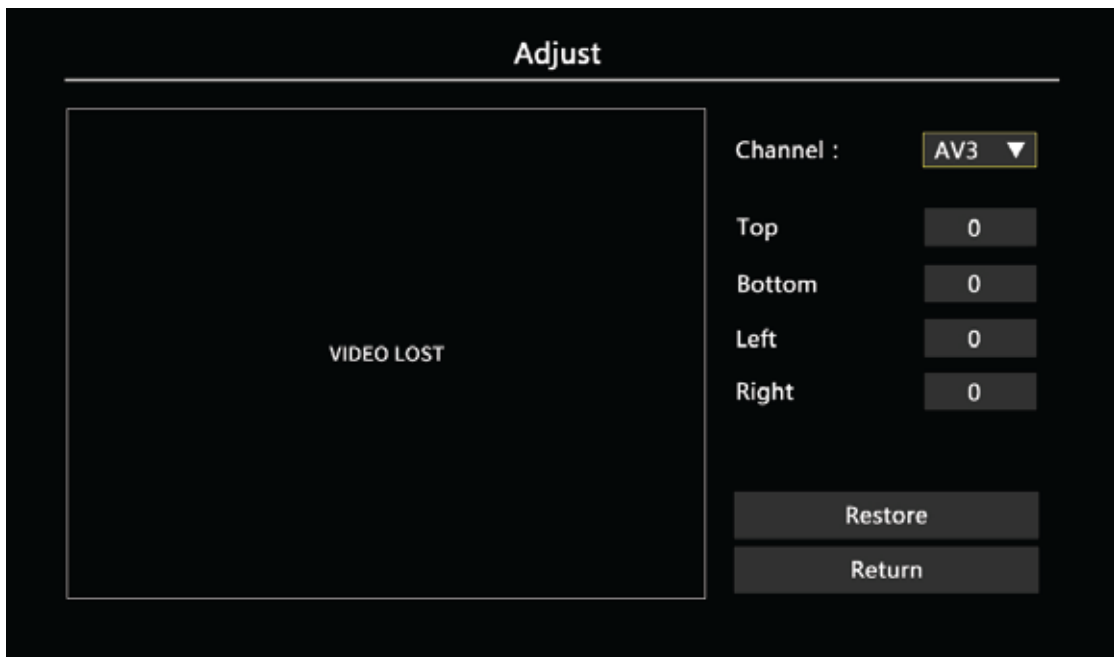

SUB-03: Color config Setup GUI



SUB-04: Mirror config Setup GUI

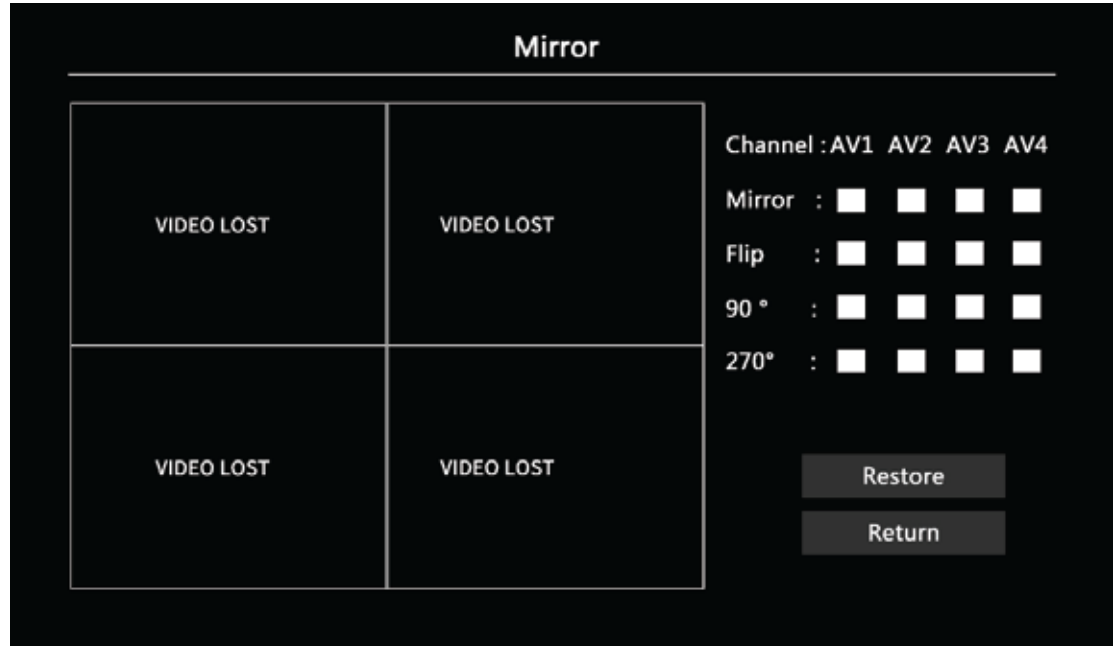

MENU-06: Select“System Setting” To format SD Card,upgrade etc function

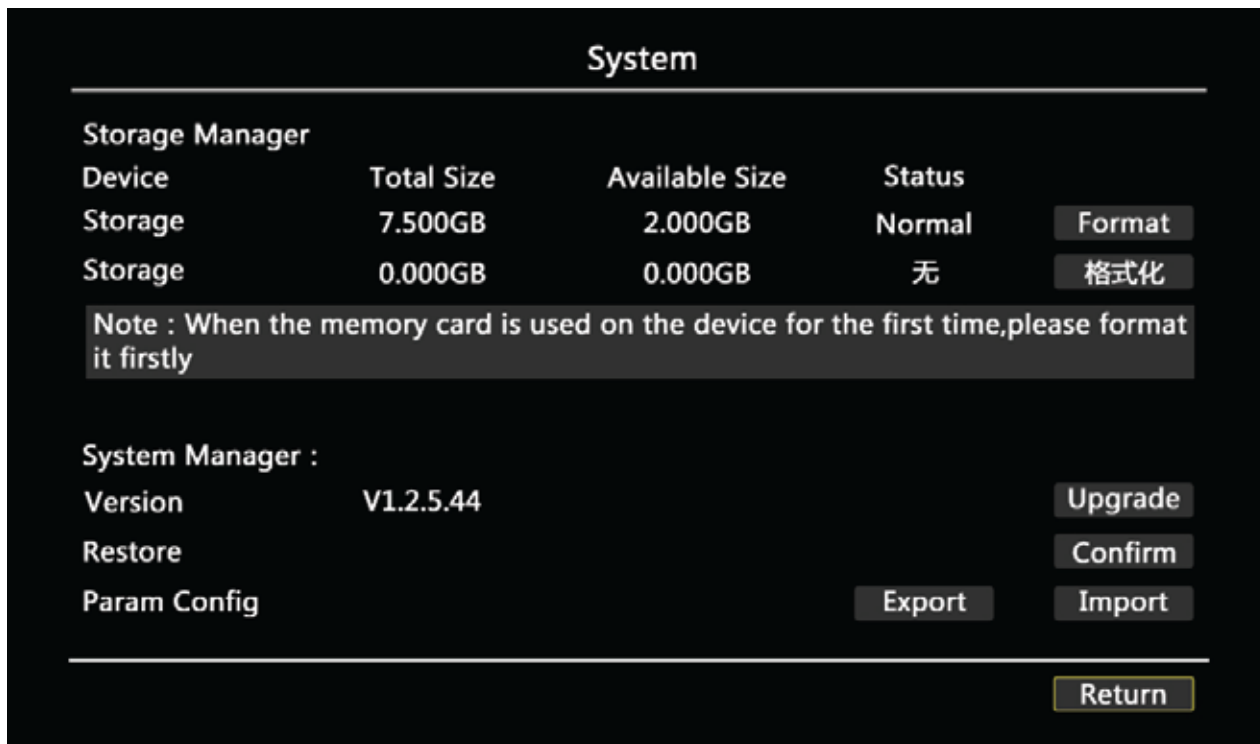

DESCRIPTION:

“Format”: Must Format SD Card when using for the 1st time or when inserting a new SD card

“Upgrade”: When available upgrades are available, Record Monitor upgrade via USB Port

“Restore”: Click “Confirm” to default factory setup

“Param config”: A. Export: Export Record Monitor parameters by USB Port

B. Import: Import the parameters into Record Monitor by USB Port

ADDITIONAL NOTES

1.Format SD Card:

Re:Must format SD Card in the System Setting when powering on for the 1st time or when inserting new SD Card

2.Car Battery protection

Re:DVR can detect Car battery via ACC Port and while car battery voltage is lower DC10.5V,the DVR will auto shut down to protect the car battery

3.Format U-Disk on Computer to back up:

Re:Format thumb drive on computer before inserting thumb drive in to monitor when exporting videos using a thumb drive

4.I/O Trigger for Reversing,Turing etc Operation

Re:When connect I/O Sensor wires, ex: turning trigger, alarm trigger, etc, relative video channels will be full screen. When alarm trigger wires are not being used, videos will be viewed in normal video mode.

USB BACKUP

STEP-01: Insert USB thumb drive Into Computer=> Format By Fat32

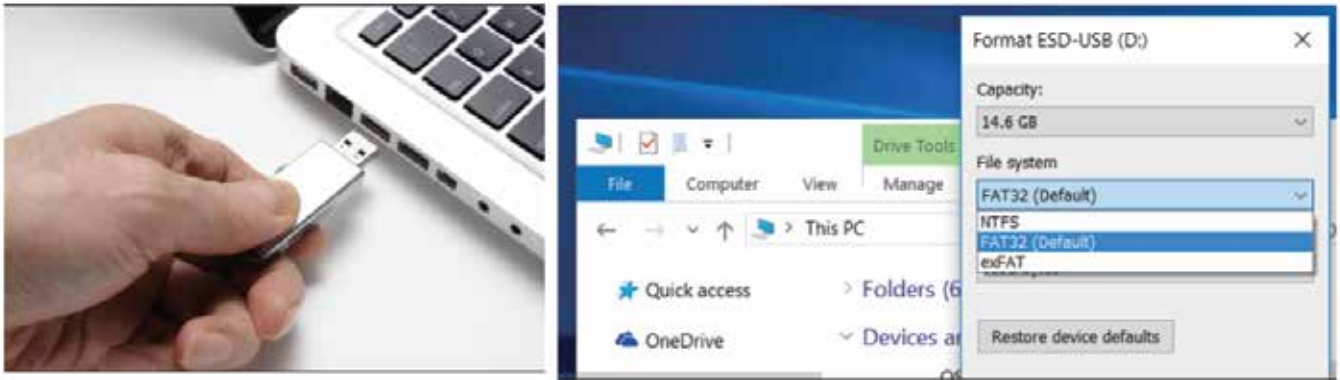

STEP-02: After Format=>Insert into USB Port Of Monitor => Setup a detail date=> Click "Export" to back up whole day recorded videos or Search Out videos list=>"Check"=> Click" Backup" button to back up the recorded videos

Check Videos list that you want

The screenshot shows a 'Record' interface with a table of recordings. A 'Search for date' dropdown is set to 'Last three days'. The date '2019-11-21' is selected in a date picker. An 'Export' button is next to it. The table has columns for 'Check', 'Lock', 'Start time', 'End time', and 'Size'. Two rows of recordings are shown, with the first row's 'Check' box checked. At the bottom, there are buttons for 'Playback', 'Prev', 'Next', 'Lock', 'Unlock', and 'Backup'.

Check	Lock	Start time	End time	Size
<input checked="" type="checkbox"/>		2018-5-24 15:20:07	2018-5-24 15:20:50	16.08M
<input type="checkbox"/>		2018-5-24 15:10:07	2018-5-24 15:20:07	220.18M

Choose the day of recording. ex: 2019-11-21

After the date setup, Click 'export' to Export that day of video recordings

Select Backup button to back up checked videos