



# COBRA RUNNING BOARD

PART #: TAC-FWB-005

**FITS:** 2020-Up Ford Explorer



60-120 min



Cutting Not Required



Drilling Not Required

## Torque & Tools

Fastener Size	Tightening Torque (ft-lbs)	Wrench Required		Allen Wrench Included	
			<input checked="" type="checkbox"/> 10mm <input checked="" type="checkbox"/> 13mm <input checked="" type="checkbox"/> 16mm <input type="checkbox"/> 18mm		<input type="checkbox"/> 4mm
<input checked="" type="checkbox"/> 6mm	<input checked="" type="checkbox"/> 7-8.5				<input type="checkbox"/> 5mm
<input checked="" type="checkbox"/> 8mm	<input checked="" type="checkbox"/> 18-20				<input type="checkbox"/> 6mm
<input checked="" type="checkbox"/> 10mm	<input checked="" type="checkbox"/> 35-40				<input type="checkbox"/> 8mm
<input type="checkbox"/> 12mm	<input type="checkbox"/> 60-70				

### BEFORE INSTALLATION

REMOVE CONTENTS FROM BOX. VERIFY ALL PARTS ARE PRESENT. READ INSTRUCTIONS CAREFULLY BEFORE STARTING INSTALLATION. ASSISTANCE IS RECOMMENDED.

### Part List

Front

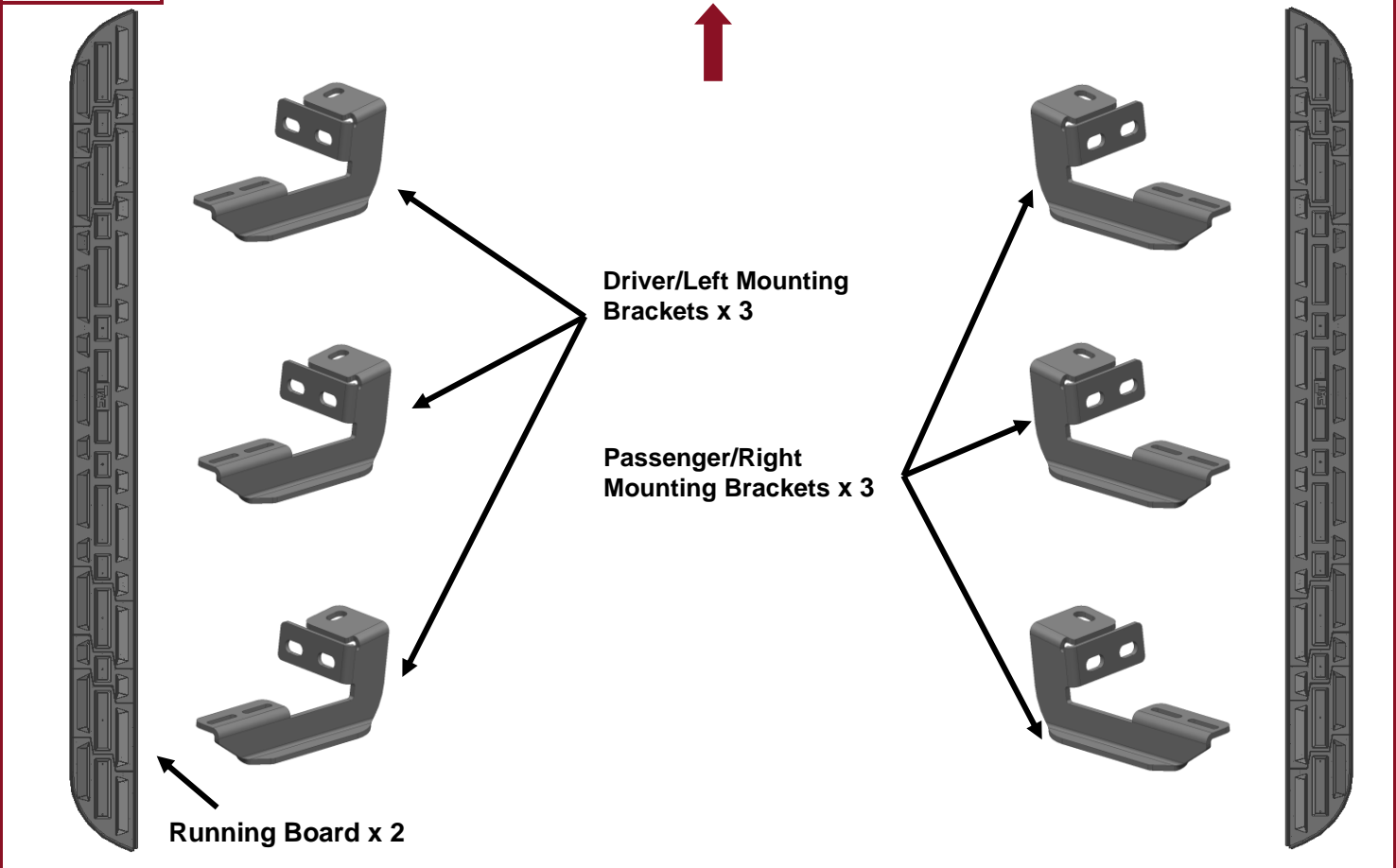



10mm x 30mm  
Hex Bolts



10mm Flat  
Washers



10mm Lock  
Washers

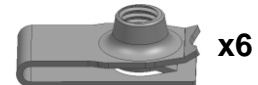

10mm Clip  
Nuts



8mm x 25mm  
Hex Bolts



8mm Flat  
Washers



8mm Lock  
Washers



8mm Hex  
Nuts



6mm T- Bolts



6mm Flat  
Washers



6mm Lock  
Washers



6mm Hex  
Nuts

**PLEASE NOTE THAT THE FOLLOWING PICTURES ARE BASED ON THE PASSENGER SIDE INSTALLATION**

## STEP 1

Starting from under the front Passenger/Right side, temporarily remove the plastic side panel. Move to the floor panel, locate the square holes and (2) round holes in the pinch weld, **(Fig 1)**. Select (1) 10mm Clip Nut. Attach the Clip Nut into the square hole in the floor panel, **(Fig 2)**.

**FIG 1**

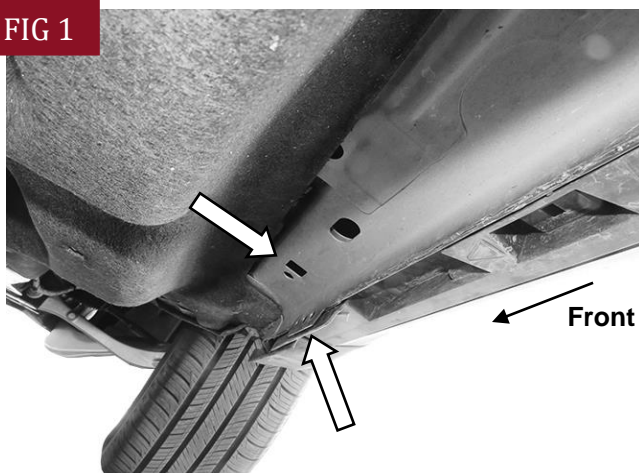

**(Fig 1) Passenger/Right front mounting location**

**FIG 2**

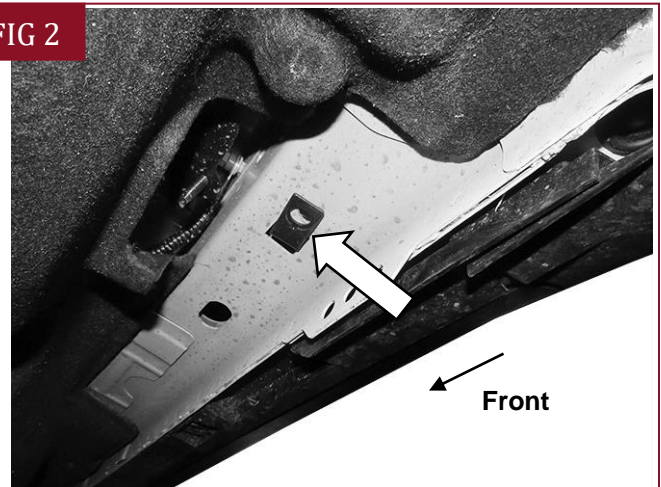

**(Fig 2) Attach (1) 10mm Clip Nut into the mounting location**

## STEP 2

Select (1) Passenger/Right Mounting Bracket. Attach the Bracket to the 10mm Clip Nut with (1) 10mm Hex Bolt, (1) 10mm Lock Washer and (1) 10mm Flat Washer, **(Figs 3 & 5)**. Do not tighten hardware.

FIG 3

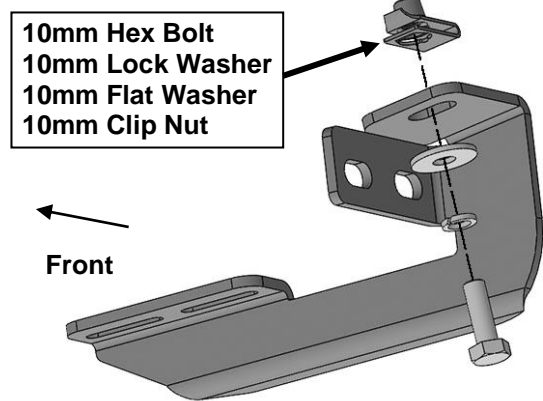

(Fig 3) Attach (1) Passenger/Right Mounting Bracket to the Clip Nut

FIG 5



(Fig 5) Passenger/Right Mounting Bracket attached

## STEP 3

Attach the Mounting Bracket to the pinch weld with (2) 8mm Hex Bolts, (4) 8mm Flat Washers, (2) 8mm Lock Washers and (2) 8mm Hex Bolts, (Figs 4 & 5). Do not tighten hardware.

FIG 4

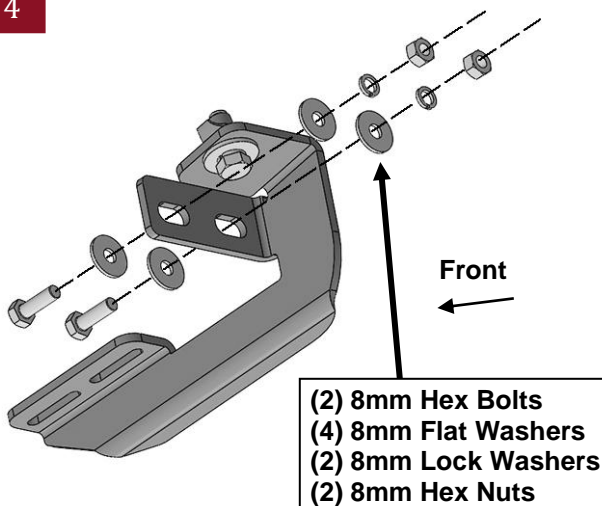

(Fig 4) Attach the Passenger/Right Mounting Bracket to the pinch weld

## STEP 4

Move along the body to the center mounting location, (Fig 6). Repeat **Steps 1—3** to attach the Mounting Bracket to the center location. Do not tighten hardware.

FIG 6

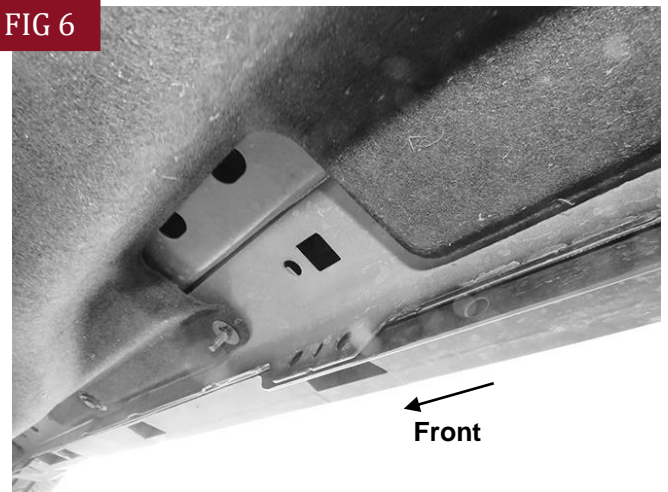

(Fig 6) Passenger/Right Center mounting location

## STEP 5

Move to the rear mounting location, **(Fig 7)**. Repeat **Steps 1—3** to attach the remaining (1) Passenger/Right Mounting Bracket. Do not tighten hardware. Reattach the plastic side panel.

FIG 7



**(Fig 7) Passenger/Right rear mounting location**

## STEP 6

Select the Passenger/Right Running Board. Insert (6) 6mm T-Bolts into the channels in the bottom of the Running Board, (3) per channel, **(Fig 8)**. Place the Running Board on the Brackets. Line up the T-Bolts with the Mounting Brackets. Attach the Running Board to the Brackets with (6) 6mm Flat Washers, (6) 6mm Lock Washers and (6) 6mm Hex Nuts, **(Fig 9)**. Do not tighten hardware.

FIG 8

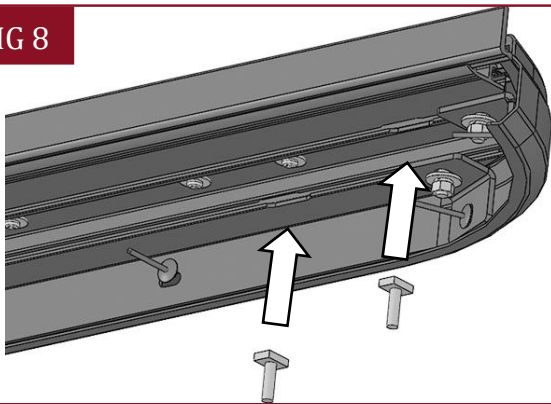

**(Fig 8) Insert (6) T-Bolts into the bottom of the Running Board, (3) per channel**

FIG 9

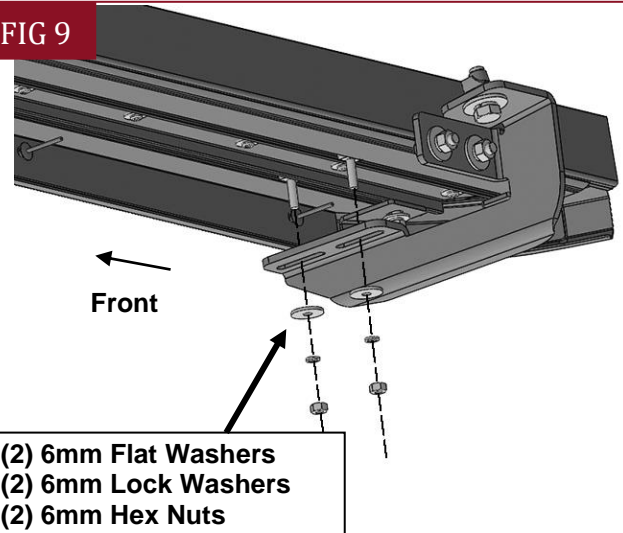

**(Fig 9) Attach the Passenger/Right Running Board to the Mounting Brackets**

## STEP 7

Level and adjust the Running Board and fully tighten all hardware.

## STEP 8

Repeat **Steps 1—7** to install the Driver/Left Running Board.

## STEP 9

Do periodic inspections to the installation to make sure that all hardware is secure and tight.

### Attention

To protect your investment, do not use any type of polish or wax that may contain abrasives that could damage the finish.

Mild soap may be used also to clean the Running Boards.