



COBRA RUNNING BOARD

PART #: TAC-CWB-002

FITS: 2018-Up Chevy Traverse
2018-Up Buick Enclave



60-120 min



Cutting Not Required



Drilling May Required

Torque & Tools

Fastener Size	Tightening Torque (ft-lbs)	Wrench Required		Allen Wrench Included	
■ 6mm	■ 7-8.5				
■ 8mm	■ 18-20	■ 13mm	<input type="checkbox"/> 5mm		
■ 10mm	■ 35-40	■ 16mm	<input type="checkbox"/> 6mm		
<input type="checkbox"/> 12mm	<input type="checkbox"/> 60-70	<input type="checkbox"/> 18mm	<input type="checkbox"/> 8mm		

BEFORE INSTALLATION

REMOVE CONTENTS FROM BOX. VERIFY ALL PARTS ARE PRESENT. READ INSTRUCTIONS CAREFULLY BEFORE STARTING INSTALLATION. ASSISTANCE IS RECOMMENDED.

Part List

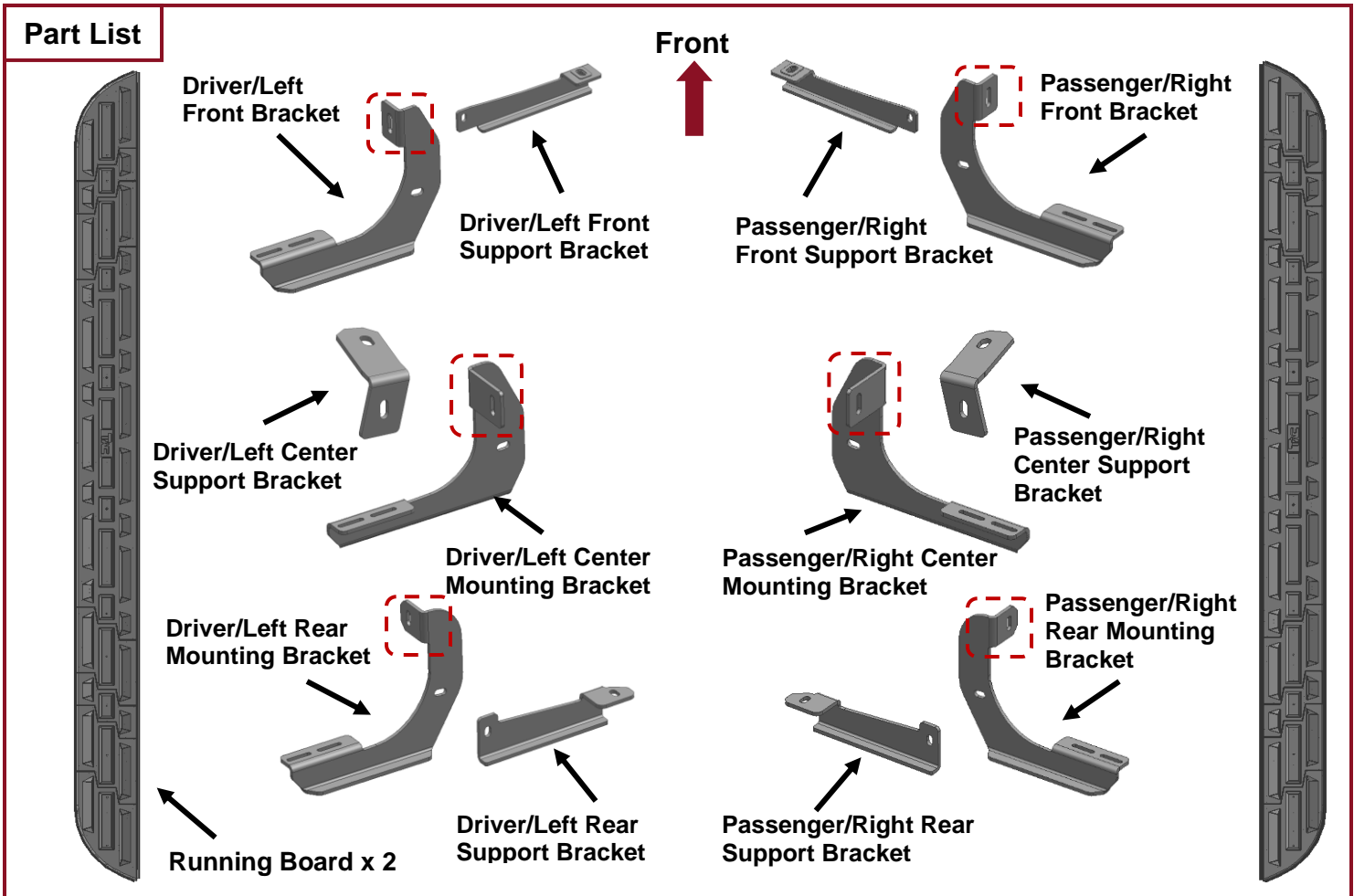

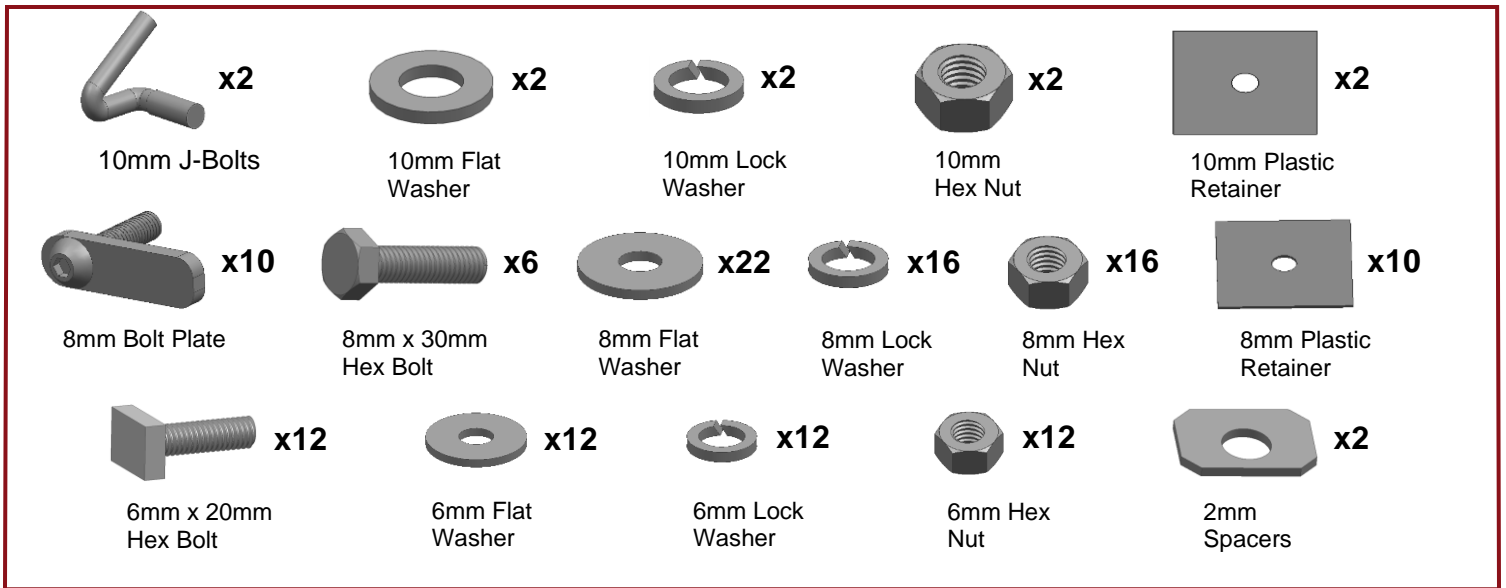

PLEASE NOTE THAT THE FOLLOWING PICTURES ARE BASED ON THE PASSENGER SIDE INSTALLATION

STEP 1

Start installation on the Passenger/Right side of the vehicle. Locate the front mounting location, **(Fig 1)**. Remove the rubber plug from the inner body panel.

FIG 1

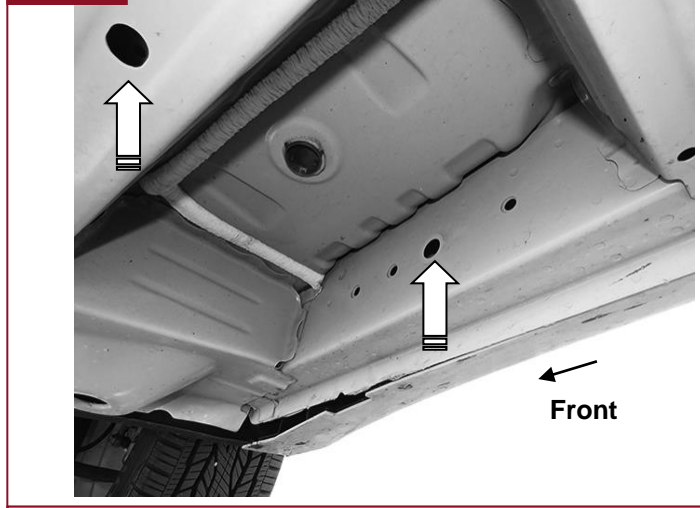

(Fig 1) Passenger/Right front mounting location

STEP 2

Select (1) 8mm Bolt Plate. Thread (1) 8mm Plastic Retainer onto the Bolt Plate, **(Fig 2)**. **NOTE: The Plastic Retainer is designed to help hold the Bolt Plate in place and to prevent the Bolt Plate from falling into the body panel.** Insert the Bolt Plate into the body panel mounting hole on the front mounting location.

FIG 2

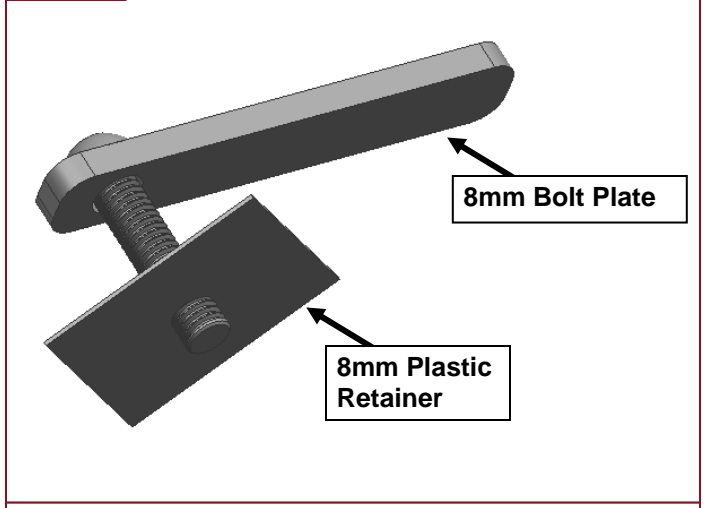

(Fig 2) Thread (1) 8mm Plastic Retainer onto the Bolt Plate, Insert the Bolt Plate into the body panel mounting hole

STEP 3

Select the Passenger/Right Front Mounting Bracket. **NOTE: The mounting brackets are similar but are unique, refer to (Fig 3) to determine the difference.** Attach the bracket to the Bolt Plate with (1) 8mm Flat Washer, (1) 8mm Lock Washer and (1) 8mm Hex Nut, (Figs 4 & 5). Do not tighten hardware.

FIG 3

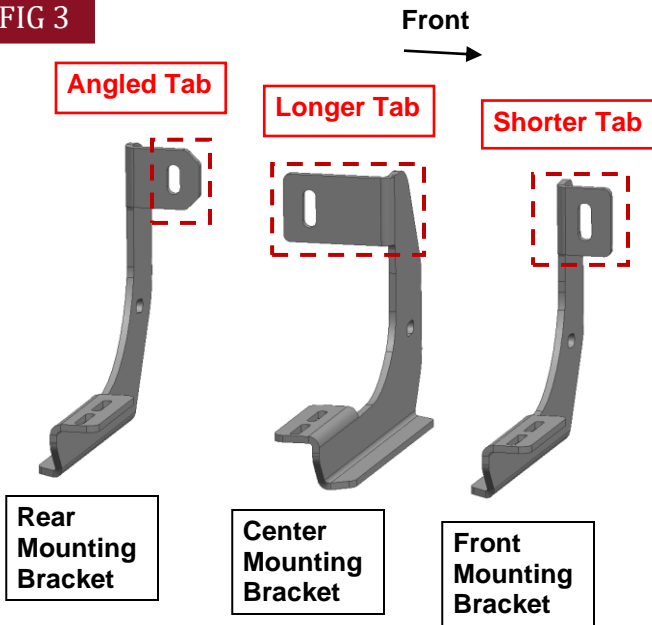

(Fig 3) Mounting Brackets are unique

FIG 4

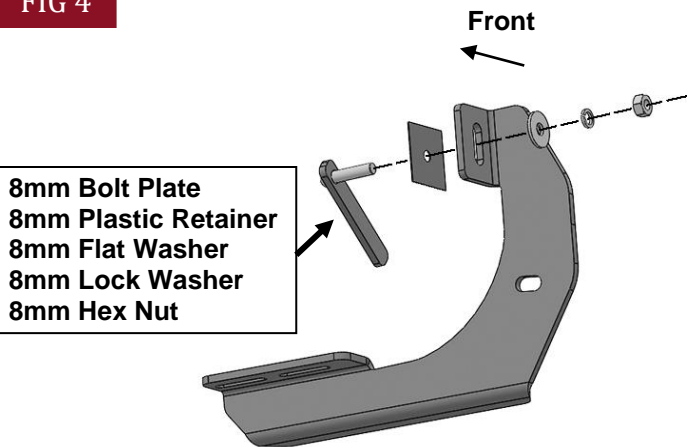

(Fig 4) Attach Passenger/Right Front Mounting Bracket to Bolt Plate in body panel

FIG 5

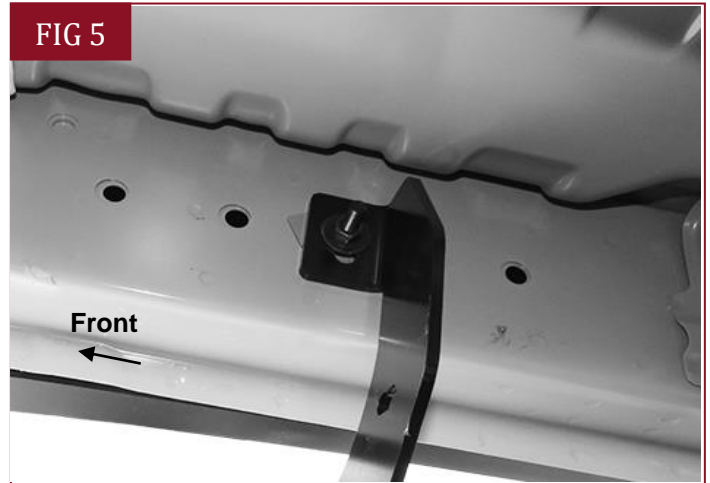

(Fig 5) Passenger/Right Front Mounting Bracket attached to inner body panel

STEP 4

Select (1) 8mm Bolt Plate. Thread (1) 8mm Plastic Retainer onto the Bolt Plate. Insert the Bolt Plate into the hole in the bottom of the frame, (Fig 1). Select the Passenger/Right Front Support Bracket. Attach the inner bent end of the Support Bracket to the Bolt Plate with (1) 8mm Flat Washer, (1) 8mm Lock Washer and (1) 8mm Hex Nut, (Fig 6)

FIG 6

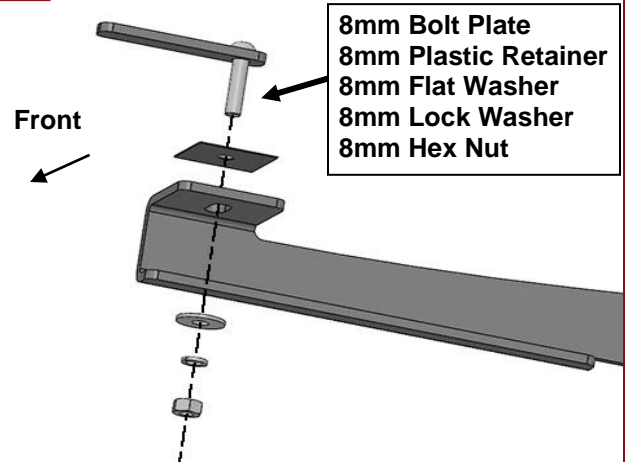

(Fig 6) Attach inner end of Passenger/Right Front Support Bracket to Bolt Plate in frame

STEP 5

Attach the flat outer end of the Support Bracket to the front of the Mounting Bracket with (1) 8mm x 30mm Hex Bolt, (2) 8mm Flat Washers, (1) 8mm Lock Washer and (1) 8mm Hex Nut, (Figs 7 & 8). Do not tighten hardware.

FIG 7

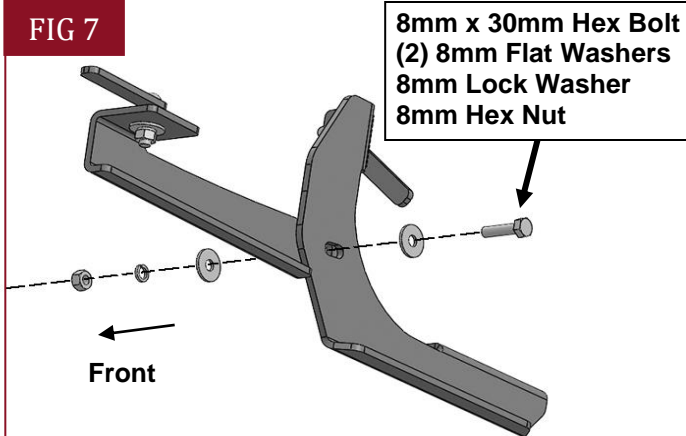

(Fig 7) Attach Passenger/Right Front Support Bracket to Mounting Bracket

FIG 8

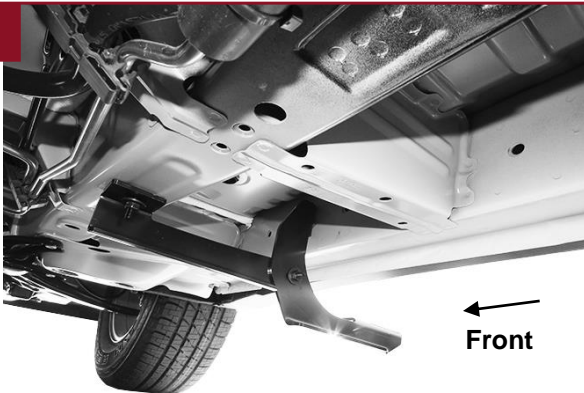

(Fig 8) Passenger/Right Front Brackets attached

STEP 6

Move along the body panel to the center mounting location, (Fig 9). Remove the rubber plug from the inner body panel. Insert (1) 8mm Bolt Plate with Plastic Retainer into the hole in the body panel. Select the Passenger/Right Center Mounting Bracket. Repeat Steps 2 & 3 to attach the Bracket to the Bolt Plate, (Figs 10 & 11). Do not tighten hardware.

FIG 9

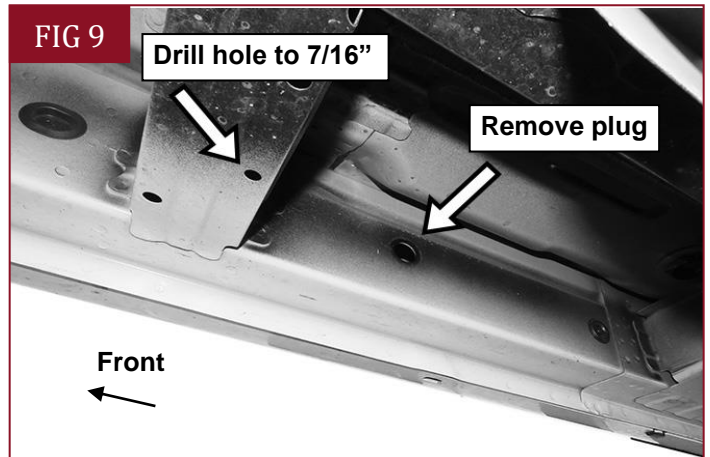

(Fig 9) Passenger/Right center mounting location. If necessary, drill out small hole to 7/16" to fit J-Bolt

FIG 10

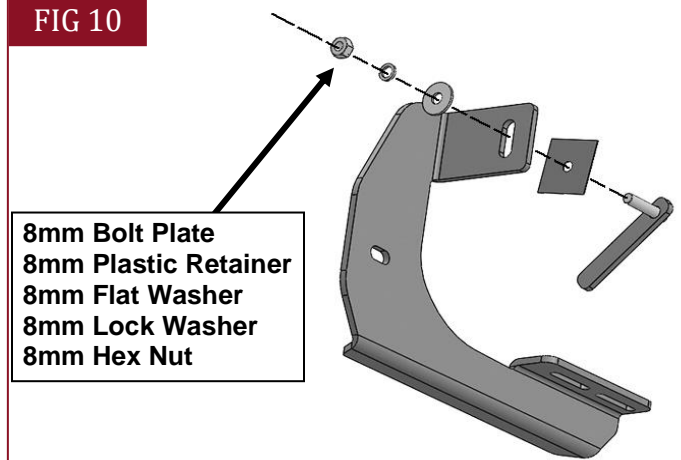

(Fig 10) Attach Passenger/Right Center Mounting Bracket to Bolt Plate in body panel

FIG 11



(Fig 11) Insert 10mm J-Bolt into the hole in bottom

STEP 7

Select the Passenger/Right Center Support Bracket. Hold the Bracket up in position to determine correct mounting location. Insert (1) 10mm J-Bolt, if necessary, use a 7/16" drill bit (not included) to open up the small hole in the bottom of the body panel reinforcement, **(Fig 9)**. Select (1) 10mm Plastic Retainer. Thread the Plastic Retainer onto the J-Bolt to hold it in place.

STEP 8

Attach the Passenger/Right Center Support Bracket to the J-Bolt with (1) 2mm Spacer, (1) 10mm Flat Washer, (1) 10mm Lock Washer and (1) 10mm Hex Nut, **(Figs 12 & 13)**. Attach the Support Bracket to the front of the Center Mounting Bracket with (1) 8mm x 30mm Hex Bolt, (2) 8mm Flat Washers, (1) 8mm Lock Washer and (1) 8mm Hex Nut, **(Figs 12 & 13)**. Do not tighten hardware.

FIG 12

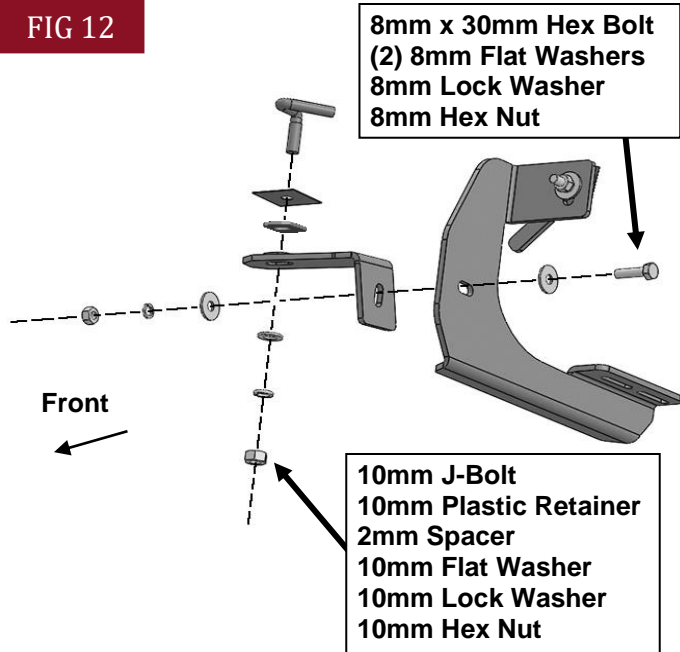

(Fig 12) Attach Passenger/Right Center Support Bracket to Mounting Bracket and J-Bolt

FIG 13



(Fig 13) Passenger/Right Center Mounting Bracket and Support Bracket attached

STEP 9

Move to the rear mounting location, **(Fig 14)**. Remove the plug from the inner body panel. Select the Passenger/Right Rear Mounting Bracket. Repeat **Steps 2 & 3** to attach the Bracket to the Bolt Plate in the body panel, **(Fig 15)**.

FIG 14



(Fig 14) Remove plug from Passenger/Right rear mounting location

FIG 15

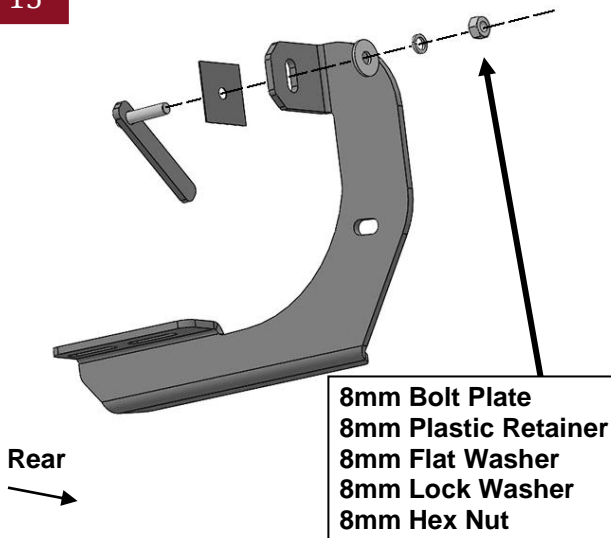

(Fig 15) Attach Passenger/Right Rear Mounting Bracket to Bolt Plate in body panel

FIG 17

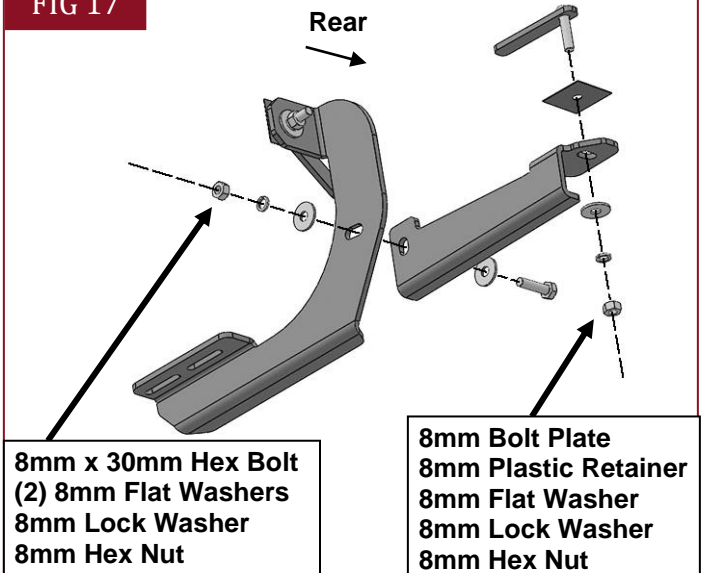

(Fig 17) Attach Passenger/Right Rear Support Bracket to bolt plate in frame and Mounting Bracket

STEP 10

Select (1) 8mm Bolt Plate. Select the Passenger/Right Rear Support Bracket. Repeat **Steps 4 & 5** to attach the Support Bracket to the frame and the Mounting Bracket, **(Figs 16 & 17)**. Do not tighten hardware.

FIG 16



(Fig 16) Insert 8mm Bolt Plate into frame

STEP 11

Select (1) Running Board. Insert (6) T-Bolts into the channels in the bottom of the Running Board, (3) per channel, **(Fig 18)**. Place the Running Board onto the Mounting Brackets and line up the T-Bolts. Attach the Running Board to the Mounting Brackets with (6) 6mm Flat Washers, (6) 6mm Lock Washers and (6) 6mm Hex Nuts, **(Fig 19)**. Do not tighten hardware.

FIG 18

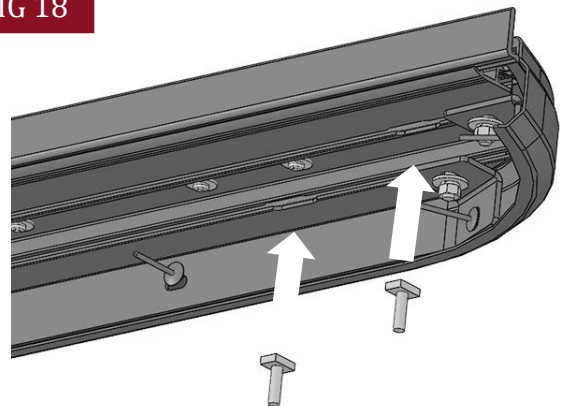

(Fig 18) Insert (6) T-Bolts into the bottom of the Running Board, (3) per channel

FIG 19

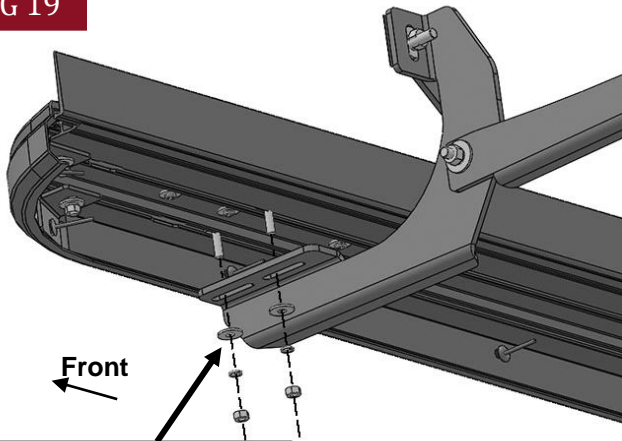

- (2) 6mm Flat Washers
- (2) 6mm Lock Washers
- (2) 6mm Hex Nuts

(Fig 19) Attached the Running Board to the Brackets

STEP 12

Level and adjust the Running Board and fully tighten all hardware.

STEP 13

Repeat **Steps 1—12** to install the Driver/Left Running Board.

STEP 14

Do periodic inspections to the installation to make sure that all hardware is secure and tight.

Attention

To protect your investment, do not use any type of polish or wax that may contain abrasives that could damage the finish.

Mild soap may be used also to clean the Running Boards.