



TALON

WARRANTY & TECHNICAL INFORMATION



INDEX

1. INTRODUCTION
2. WARRANTY
3. CLEANING & MAINTENANCE
4. HUB DIAGRAMS
 - 4A. 12x100 Front
 - 4B. 12x142 Rear
 - 4C. 15x110 Front
 - 4D. 12x148 Rear
5. RATCHET SYSTEM
6. WHEELBUILDING SPECS



INTRODUCTION

Congratulations on your new Berd TALON hubs!

By joining the growing number of cyclists switching to Berd spokes & wheels, you're showing a commitment to performance, cutting edge tech, and the spirit of cycling as a whole.

Our mission has always been to push the boundaries of what can be done with bicycle wheels, and the TALON hubs are the natural evolution of that. TALON hubs have been specifically engineered to offer competitive weight, easy installation & maintenance, and excellent long term dependability.

Berd spokes are handmade in the US by dedicated cyclists and engineers alike.



WARRANTY

In the event of material or manufacturing defects, Berd TALON hubs will be repaired or replaced at the discretion of Berd within the warranty period of 24 months.

The following provisions apply:

The 24-month warranty period begins on the date of purchase. The original sales receipt must be presented to make a claim, and the warranty is valid for the original purchaser only.

The warranty applies to products with damage resulting from material or manufacturing defects. Wearing parts such as bearings, gaskets, seals, springs, & freehub ratchets are excluded from the warranty.

The warranty assumes that the product has been used properly, and the maximum system weight has not been exceeded (if applicable).

The warranty assumes that all information about assembly, handling, and maintenance in the operating instructions has been observed. The product must not have been abused, modified, intentionally altered, or used in combination with incompatible parts or tools.

If you make a claim under warranty, the damaged product(s) become the property of Berd LLC when it is sent to us.

Berd LLC is not liable, to the extent permitted by law, in particular for indirect or consequential damage. Further claims relating to product liability and personal injury are reserved.

The place of jurisdiction is the USA. United States law shall apply.

Berd spokes are protected by US Patents 10,150,332 B2, 10,661,598 B2, and patents pending.



CLEANING & MAINTENANCE

GREASE

All moving parts, O-rings, seals & threads require grease before assembly. The ratchet mechanism requires specific Berd freehub grease (#HUBSP001) to be used for optimal performance. Greasing the freehub mechanism & inspecting the bearings & hub is recommended every 3,000km (1,800mi) or as needed for optimal performance and durability.

CLEANING

For cleaning internal hub components, Berd recommends using a solvent based degreaser. For cleaning the outer hub shell and external hub parts, please clean with a soft cloth and a mild detergent or soap & water.

INTERNAL COMPONENTS

Freehub bodies and ratchet components are able to be replaced by hand. Bearings and other internal components must be serviced by a professional using bearing press and extraction tools that are designed for these purposes. Berd is not responsible for any damage, cosmetic or mechanical, incurred from the improper use of tools.



HUB DIAGRAM

12x100 FRONT



HUB DIAGRAM

12x142 REAR

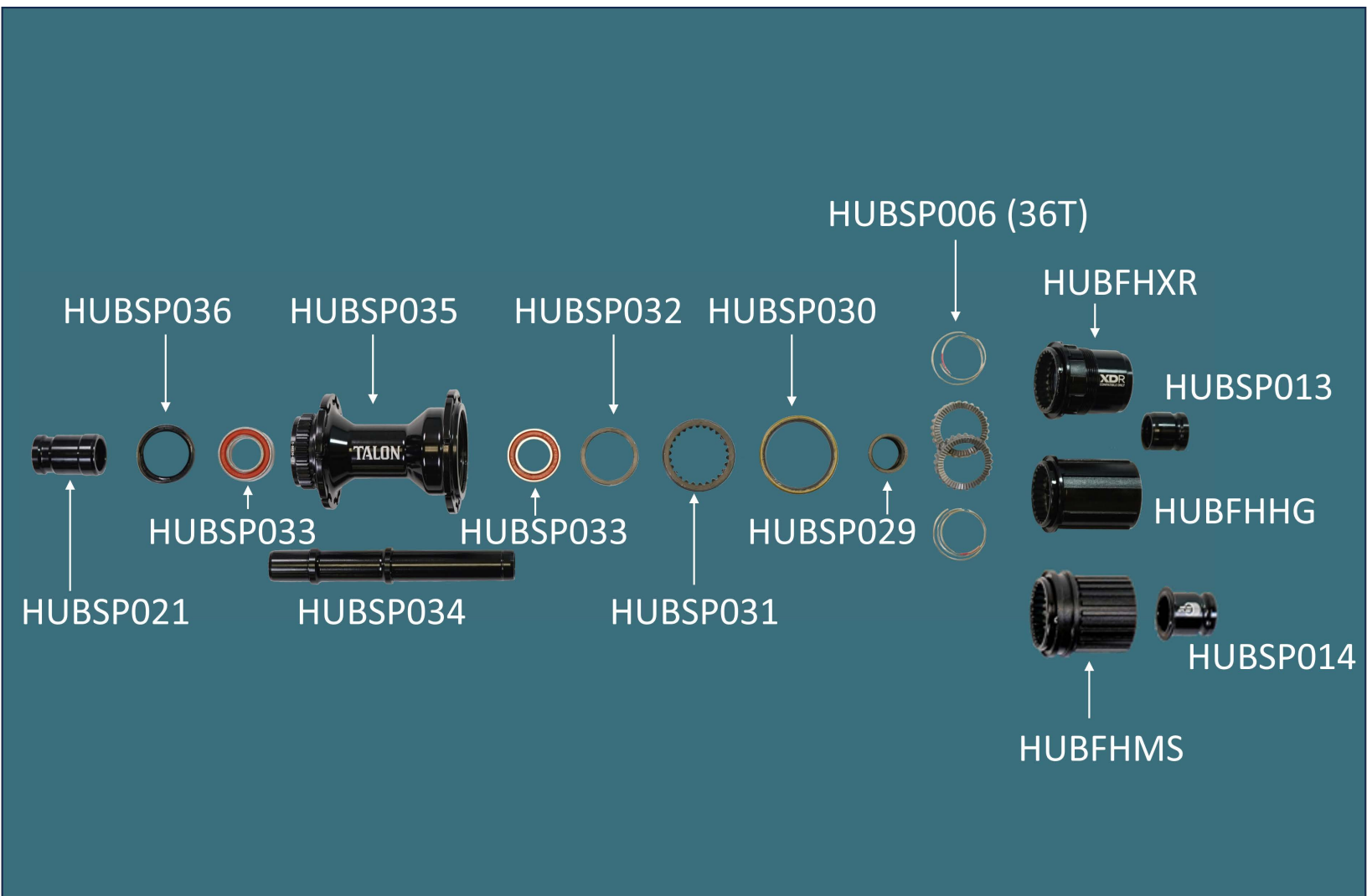

HUB DIAGRAM

15x110 FRONT



HUB DIAGRAM

12x148 REAR

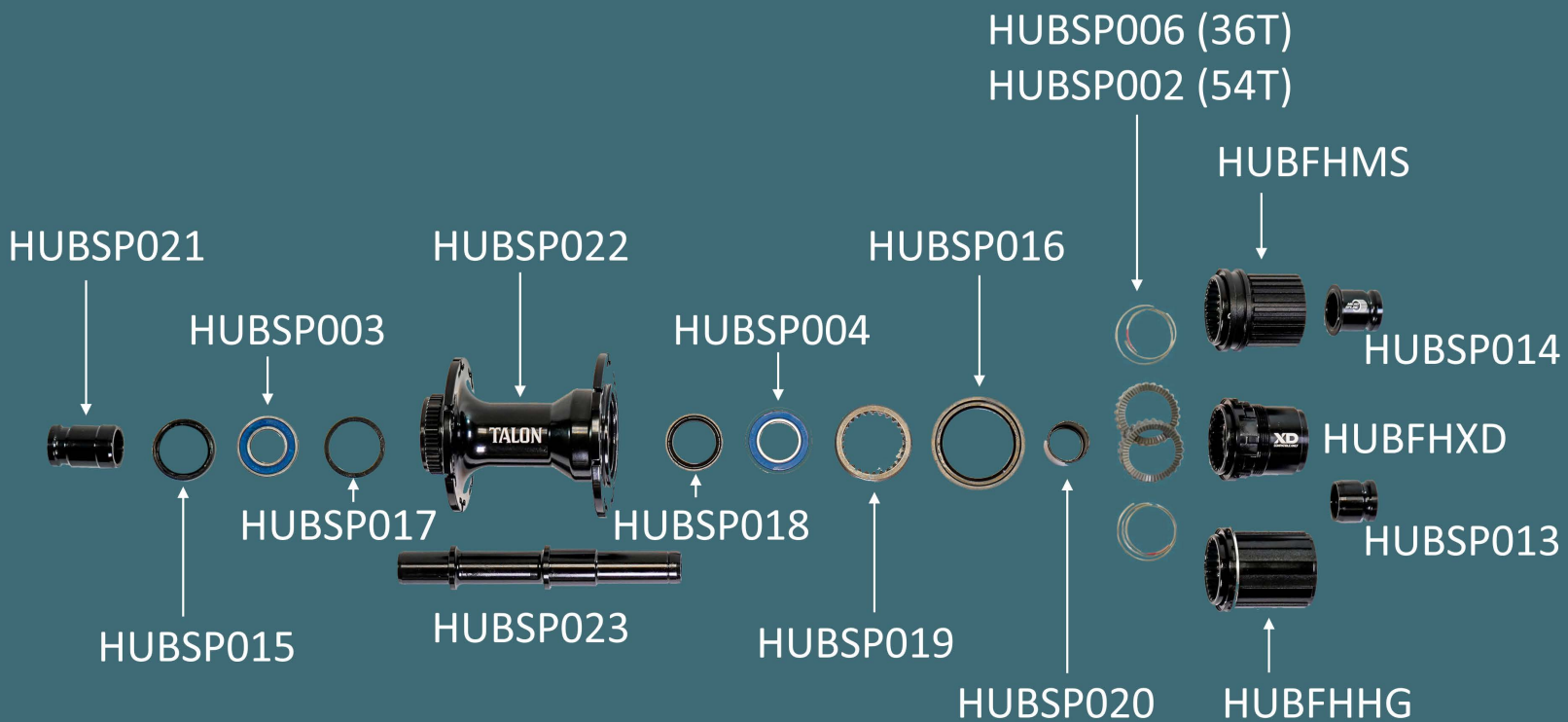

RATCHET SPECIFICATIONS

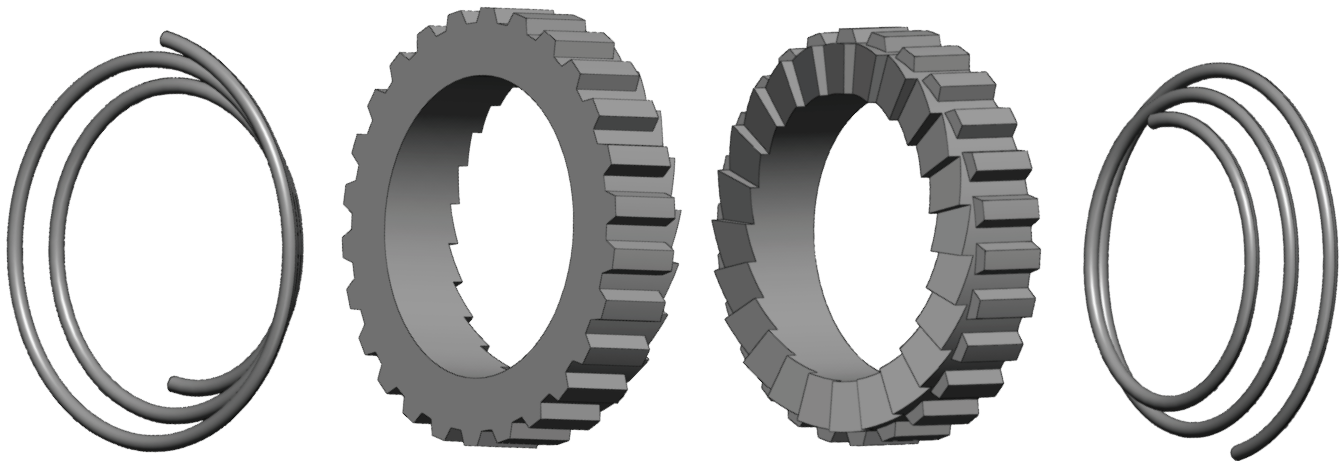

**36T RATCHET
ENGAGEMENT DEGREES 10°**

**54T RATCHET
ENGAGEMENT DEGREES 6.66°**

**RECOMMENDED
GREASE BERD FREEHUB GREASE**

Installation Notes: Ensure that the star ratchet and any contact points inside the hub are thoroughly greased. Do not use tools to install or remove ratchet mechanisms. Always ensure that the ratchet rings are securely seated in the hub, the springs are the correct orientation, and the hub endcaps are fully installed before riding.



Wheel Building Specifications

12x100 Front	PITCH CIRCLE	44	left	44	right
	CNTR-FLANGE:	24	left	36	right
12x142 Rear	PITCH CIRCLE	46	left	50	right
	CNTR-FLANGE:	41	left	22	right
15x110 Front	PITCH CIRCLE	44	left	44	right
	CNTR-FLANGE:	28	left	40	right
12x148 Rear	PITCH CIRCLE	60	left	64	right
	CNTR-FLANGE:	36	left	21	right

