

Hold the tool in the palm of your hand.

Fit two fingers through the holes and compress the spring with the heel of your palm before fitting on a spoke.

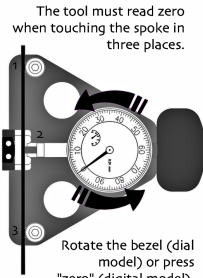

The tool must read zero when touching the spoke in three places.

Rotate the bezel (dial model) or press "zero" (digital model). After zeroing, you can release the spring and see the reading. Use the conversion chart to see the tension.

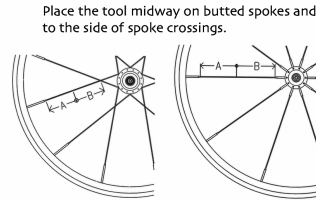

Place the tool midway on butted spokes and to the side of spoke crossings.

Place the tool the same way on each spoke to ensure consistent readings.

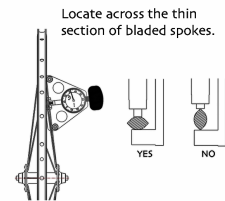

Locate across the thin section of bladed spokes.

For any further questions, please contact www.wheelfanatyk.com.

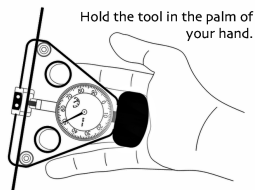

Hold the tool in the palm of your hand.

Fit two fingers through the holes and compress the spring with the heel of your palm before fitting on a spoke.

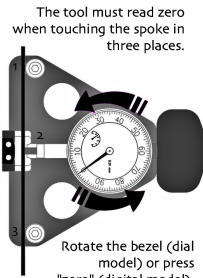

The tool must read zero when touching the spoke in three places.

Rotate the bezel (dial model) or press "zero" (digital model). After zeroing, you can release the spring and see the reading. Use the conversion chart to see the tension.

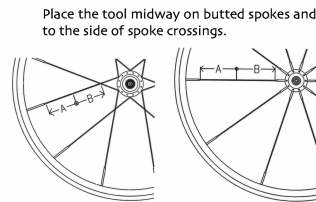

Place the tool midway on butted spokes and to the side of spoke crossings.

Place the tool the same way on each spoke to ensure consistent readings.

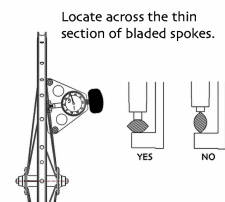

Locate across the thin section of bladed spokes.

For any further questions, please contact www.wheelfanatyk.com.