

# ***LEUPOLD***

## **TRACER LENS REMOVAL AND INSTALLATION**

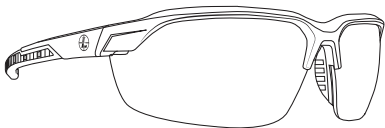

**⚠ WARNING:** THE REMOVAL AND INSTALLATION INSTRUCTIONS MUST BE FOLLOWED IN ORDER TO AVOID INJURY TO PERSONS AND DAMAGE TO A LENS. NEVER USE OR WEAR ANY LENS INSTALLED IMPROPERLY OR DAMAGED IN ANY WAY. SUCH USE OR WEAR MAY CAUSE SERIOUS INJURY.

## LENS REMOVAL

*Note: The lens must be removed in this order to avoid damage.*

1. Grip the frame and lens as shown.

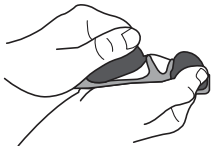

2. Flex the nose bridge away from the inside corner of the lens. Gently pull the lens away.

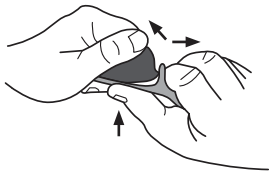

3. Remove the lens.

## LENS INSTALLATION

*Note: The lens must be installed in this order to avoid damage.*

1. Grip the frame and lens as shown. Insert the outer edge of the lens into the outer corner of the frame.

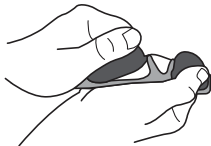

2. Align the inside corner of the lens with the nose bridge and insert into frame. The lens will snap into place.



3. Carefully wiggle the lens to ensure it is secure.

***LEUPOLD***

WWW.LEUPOLD.COM

In no event shall Leupold & Stevens, Inc. be liable for any direct, indirect, incidental, special, consequential, punitive damages, or injuries to persons or property whatsoever that arises out of, relates to, or is connected with any misuse or improper installation or removal of a Tracer lens.

ARTWORK # 179919B