



MURPHY DOOR®

Hidden Panel Murphy Door Kit



[murphydoor.com](https://www.murphydoor.com) | 888.458.5911

PLEASE READ INSTRUCTIONS FULLY BEFORE YOU BEGIN ASSEMBLY

Tools Needed

- Drill with Phillips head drive
- 1/8" Hex Wrench
- Adjustable Wrench or 3/8" Wrench
- 2x Clamps
- 1/2" Countersink Bit
- 3/8" Countersink Bit
- 36" Level
- Mallet/Hammer
- Door Shims



Emtek Edge Pull

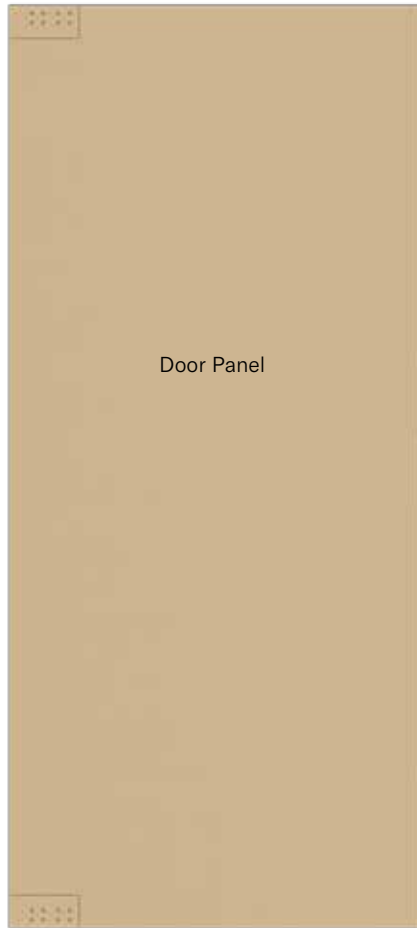

Door Panel

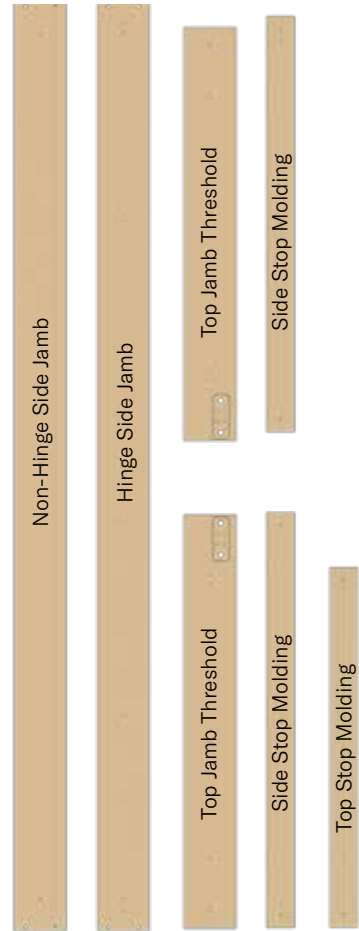

Non-Hinge Side Jamb

Hinge Side Jamb

Top Jamb Threshold

Side Stop Molding

Top Jamb Threshold

Side Stop Molding

Top Stop Molding



Top Hinge Door Plate



Top Removable Hinge Pin Housing



Top Hinge Bearing Plate



Removable Top Hinge Pin



Hinge Pin Removal Tool



Bottom Hinge Door Plate



Bottom Adjustable Hinge Pin Housing



Bottom Hinge Bearing Plate



Adjustable Bottom Hinge Pin



4mm Hex Wrench



Magnetic Catch



Magnetic Catch Strike



1/4"-20 x 3/8" Set Screw



3" Lag Screw



Confirmat Screw



8-32 x 1/2" Black Flat Head Screw



6.3mm x 18mm Euro Screw



#8 x 5/8" Wood Screw



5mm Spring Pin



#8 x 1-1/4" Wood Screw

PLEASE READ INSTRUCTIONS FULLY BEFORE YOU BEGIN ASSEMBLY

Before you start

- **If you have the maglock kit for your door, read those instructions FIRST**
- Verify that you have all parts prior to starting the installation or hiring a contractor.
- Test your pin to make sure it works properly. - Hold the pin while pushing the center button. The two ball bearings should retract slightly. If the ball bearings do not retract spray with dry lube. Engage the center button several times. Recheck to see if pin is working properly.
- **DO NOT use if pin isn't working properly.**

Finishing

- This kit is to get you started in building your own hidden panel door in a larger decorative or accent wall. Finishing carpentry and cabinetry are skilled professions. Murphy Door CAN NOT assist with the customization and finishing process.
- **CUT FILES NOT INCLUDED Murphy Door makes NO CLAIM to the ease of designing and finishing your own hidden panel door.**
- Make sure your door works properly before you finish the wall.
- When installing your decorative facing, start at the hinge edge of the door and work out. Test the movement and clearances of the door along the way.

Installation tips

Framing

- Rough opening should be framed with 2" x 4" or 2" x 6" studs.
- If using metal studs, replace the included 3" screws with (8) 3" self-tapping screws.
- Make sure your studs are parallel - measure top, middle, and bottom of the jamb (RO) and square by putting a square in all four corners. If they are not, your Murphy Door will not function properly and may appear bowed.

Threshold

- For best results install the door on a level surface. DO NOT install the bottom threshold over carpeting. Carpet will affect levelling and prevents proper function of the door.
- If you must shim the threshold, it is best to have a shim that is the width of the threshold and runs the entire length of space needed to shim.

Jamb

- DO NOT over or under tighten jamb. When installing the jamb you need to make sure it is shimmed properly. It should be level and square with the threshold and header. If the jamb is not square it may cause your door to function improperly or appear to sag.

FRAMING HOLE PLACEMENT

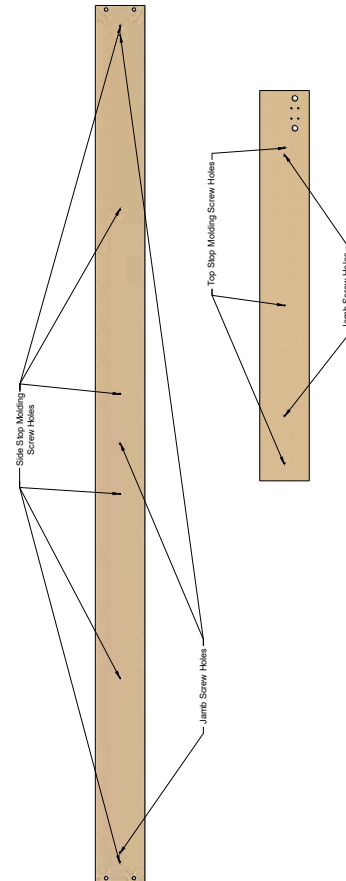

HINGE CONFIGURATION

LEFT HAND

Panel Door Top Hinge Assembly



4x 8-32 x 1/2" Black Flat Head Screws

LEFT HAND

Panel Door Bottom Hinge Assembly Part 1



4x 8-32 x 1/2" Black Flat Head Screws

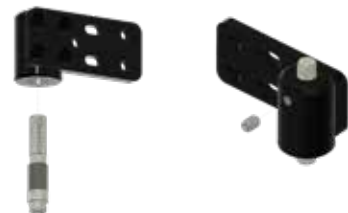

RIGHT HAND

Panel Door Top Hinge Assembly



4x 8-32 x 1/2" Black Flat Head Screws

RIGHT HAND

Panel Door Bottom Hinge Assembly Part 1



4x 8-32 x 1/2" Black Flat Head Screws



PLEASE READ INSTRUCTIONS FULLY BEFORE YOU BEGIN ASSEMBLY

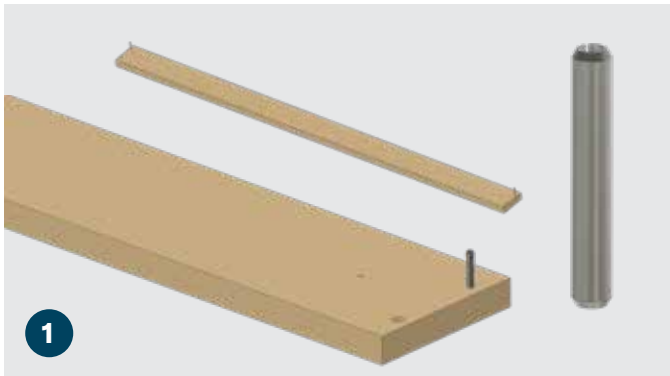

1
Identify your hinge side jamb and non-hinge side jambs.
On your hinge side jamb, insert 5mm spring pins into smaller hole on each end of the board, use a hammer or mallet to set the spring pin in place.



2
Align the hinge side jamb with the top jamb and threshold. The spring pin will align with the side hole closest to the two hinge pin holes. Tap the two pieces together with a mallet.
Secure both top jamb/threshold pieces to the hinge side jamb using a confirmat screw.
Secure the non-hinge side jamb to the top jamb/threshold with two confirmat screws.



3
OUT-SWING INSTALLATIONS ONLY:
For in-swing installations skip to step 8.
Using a 1/2" countersink bit, countersink the 6 stop molding holes in the non-hinge side jamb and the 3 stop molding holes in the top jamb from the outside of the jamb assembly.



4
OUT-SWING INSTALLATIONS ONLY:
Partially insert 6 #8 x 1-1/4" wood screws into the holes you just countersunk, so that just the tip of the screw is protruding.

Refer back to page 2 for the correct hole locations.

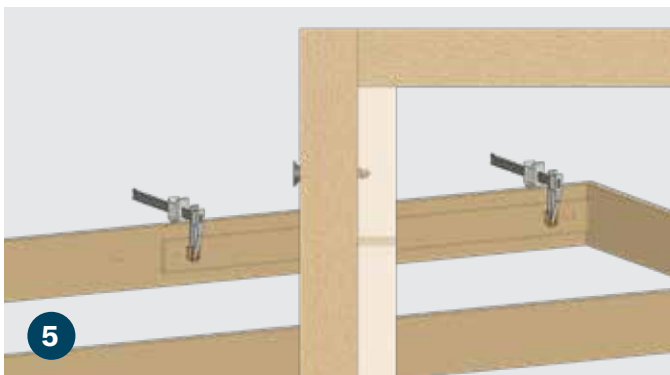

5
OUT-SWING INSTALLATIONS ONLY:
Align the stop side molding so that the partially drilled holes in the stop molding are aligned with the tips of the screws.
Pay close attention here as the jamb screw holes that will be used to secure the jamb in the rough opening need to align with their corresponding holes in the stop molding.
Clamp each end of the stop molding and fully tighten the end screws.
Clamp the center and fully tighten the center screw.

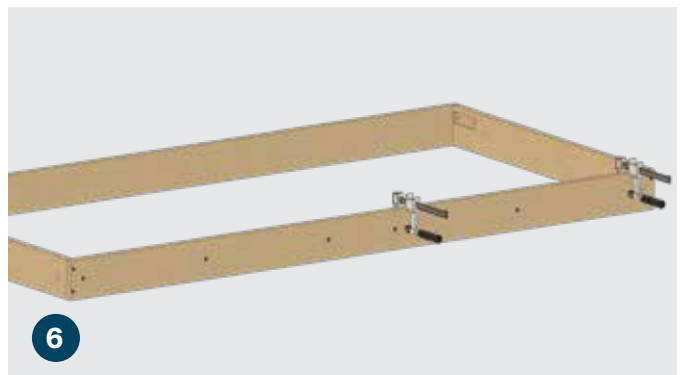

6
OUT-SWING INSTALLATIONS ONLY:
Repeat on the other piece of side stop molding.
Pay close attention here as the jamb screw holes that will be used to secure the jamb in the rough opening need to align with their corresponding holes in the stop molding.

PLEASE READ INSTRUCTIONS FULLY BEFORE YOU BEGIN ASSEMBLY

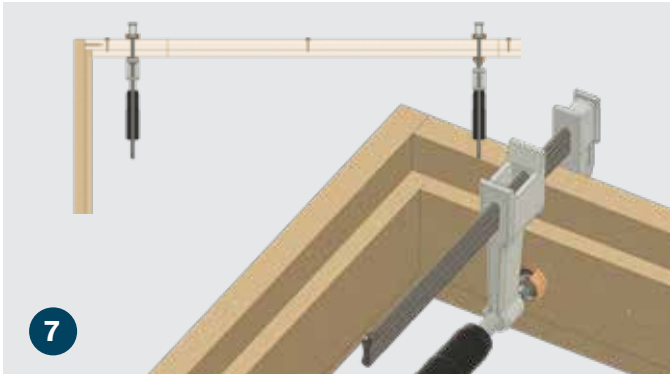

OUT-SWING INSTALLATIONS ONLY:

Repeat on the top stop jamb.

Pay close attention here as the jamb screw holes that will be used to secure the jamb in the rough opening need to align with their corresponding holes in the stop molding.

Ensure that the corner of the stop molding is properly aligned before securing.

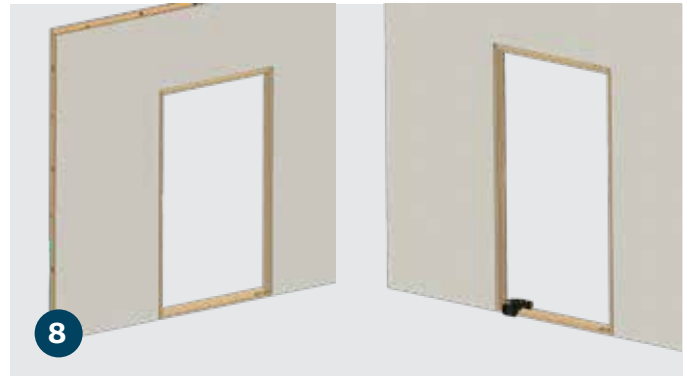

Tilt the jamb into the rough opening. The hinge pockets sit closest to the front edge of the jamb.

Using a 3/8" countersink bit, countersink the jamb screw hole.



Make sure the threshold and jamb sides are level and plumb. Use shims as needed. These should be placed at the jamb screw holes for best results.

Additional shims maybe needed along the hinge side jamb in line with the top and bottom jamb to stabilize it as the lag screws are secured.

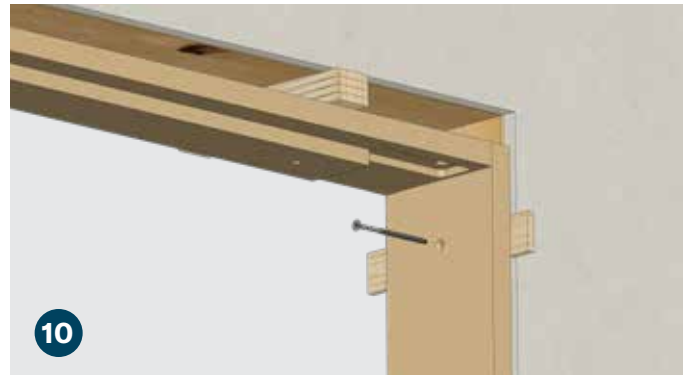

Secure the jamb using the 3" lag screws provided.



There are 3 lag screws in each side jamb and 2 in the top jamb.



OUT-SWING:

Attach the top jamb hinge plate using the #8 x 5/8" wood screws so that the bearing is facing towards the inside of the jamb.

PLEASE READ INSTRUCTIONS FULLY BEFORE YOU BEGIN ASSEMBLY

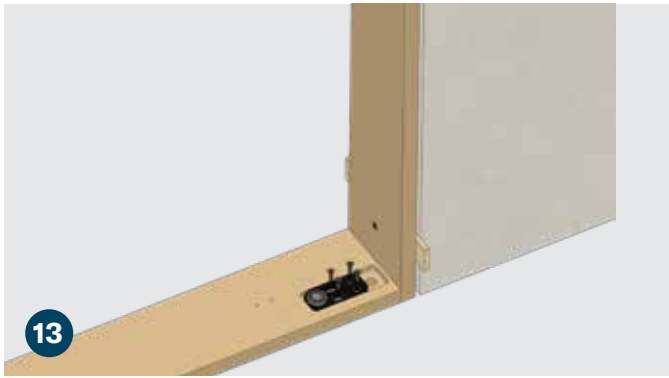

13

OUT-SWING:

Attach the bottom jamb hinge plate using the #8 x 5/8" wood screws so that the bearing is facing towards the inside of the jamb.



14

OUT-SWING:

Orient the top hinge plate with the pivot point towards the outer edge of the door.

Using the 18mm euro screws, attach the top door hinge plate at the inner-most pre-drilled holes at the top of the door.

For hinge plate configuration please see the Panel Door Hinge Kit Configuration Guide.



15

OUT-SWING:

Orient the bottom hinge plate with the pivot point towards the outer edge of the door.

Using the 18mm euro screws, attach the bottom door hinge plate at the inner-most pre-drilled holes at the bottom of the door.

For Hinge plate configuration please see the Panel Door Hinge Kit Configuration Guide.

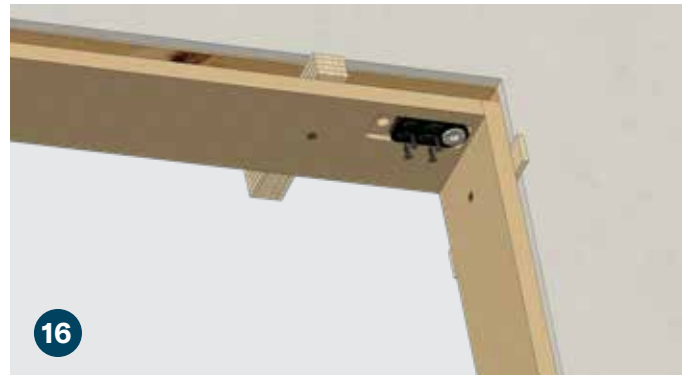

16

IN-SWING:

Attach the top jamb hinge plate using the #8 x 5/8" wood screws so that the bearing is facing towards the outside of the jamb.

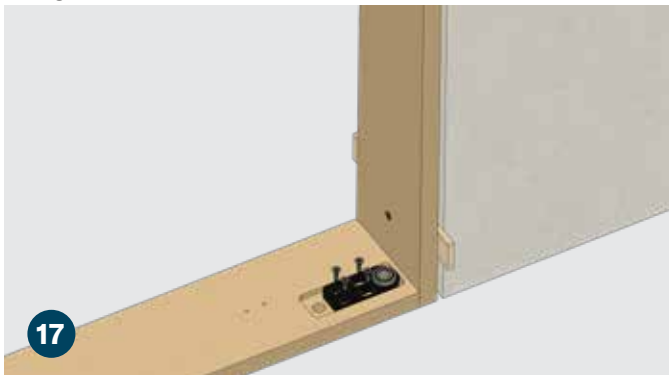

17

IN-SWING:

Attach the bottom jamb hinge plate using the #8 x 5/8" wood screws so that the bearing is facing towards the outside of the jamb.



18

IN-SWING:

Orient the top hinge plate with the pivot point towards the outer edge of the door.

Using the 18mm euro screws, attach the top door hinge plate at the outer-most pre-drilled holes at the top of the door.

For hinge plate configuration please see the Panel Door Hinge Kit Configuration Guide

PLEASE READ INSTRUCTIONS FULLY BEFORE YOU BEGIN ASSEMBLY



19

IN-SWING:

Orient the bottom hinge plate with the pivot point towards the outer edge of the door.

Using the 18mm euro screws, attach the bottom door hinge plate at the inner-most pre-drilled holes at the bottom of the door.

For hinge plate configuration please see the Panel Door Hinge Kit Configuration Guide.



20

ALL SWINGS

Loosen the set screw and retract the bottom hinge pin as far as it will go into the housing. A small amount of the hinge pin will still be protruding.

You will retighten the set screw after the door is installed.

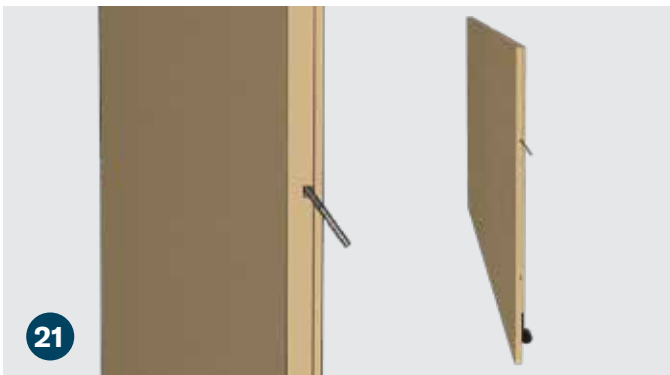

21

Before installation, inspect the door for a curve or bow. If the door is bowed this can be corrected using the internal straightening hardware which can be accessed through a small opening on the top or bottom of the door.

To do so, lay the door on its hinge side edge and look down the length of the door.

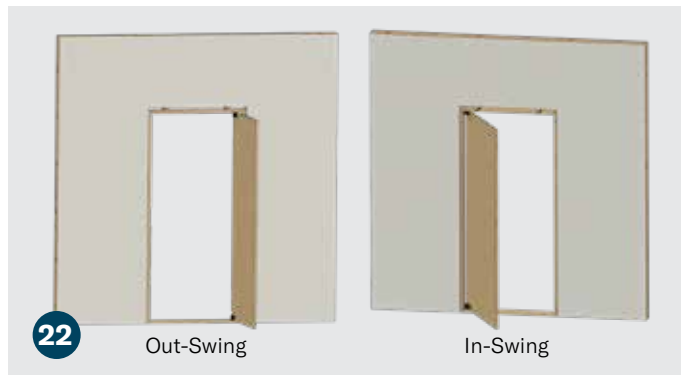

22

Out-Swing

In-Swing

If the ends of the door are bowing towards the front (left side of the image) use the included 4mm hex wrench, insert it into the small opening at the top or bottom of the door, and rotate clockwise until the door is straight up to 4 full rotations. If the door is bowed towards the back, rotate counter-clockwise. Doors wider than 32" will have 2 sets of this hardware.

With the door oriented into the open position set it in the jamb.

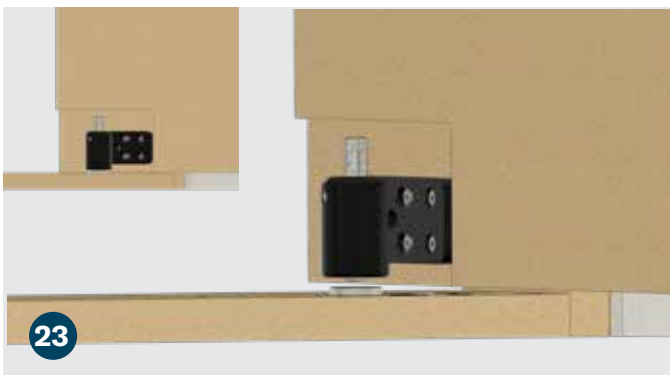

23

(Show on an out-swing door)

Align the bottom hinge pin with the bearing and set it in place.

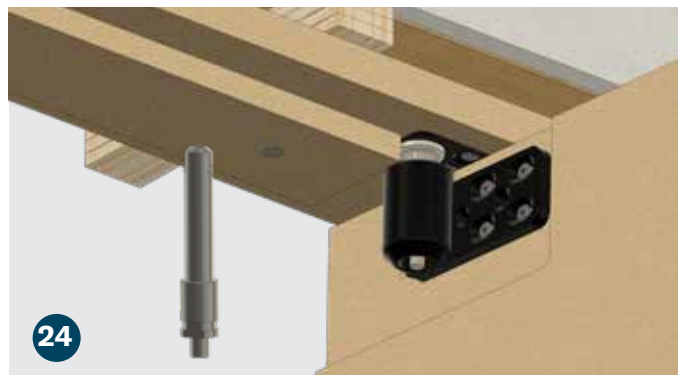

24

(Show on an out-swing door)

Depress the button on the top hinge pin to retract the balls and insert into the top hinge pin housing and bearing in the top jamb hinge plate.

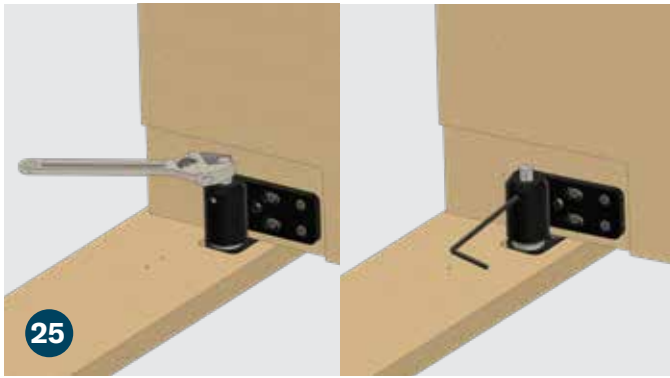

(Show on an out-swing door)

Using a 3/8" wrench or adjustable wrench, tighten the bottom hinge pin down. This will lift the door and allow you to set the spacing between the top and bottom of the door and the jamb. Once you have the top and bottom spacing where you want it, tighten the set screw against the hinge pin. This is most effective if it can align with one of the flat surfaces used to adjust the hinge pin height.



(Shown on an out-swing door)

Level the door in the jamb by slightly loosening the screws in the top jamb and tilting the door until it is square in the jamb. Once the door is square and level within the jamb, secure the top by tightening the 18mm euro screws and locking the hinge in place with a #8 x 5/8" wood screw in the center hole.

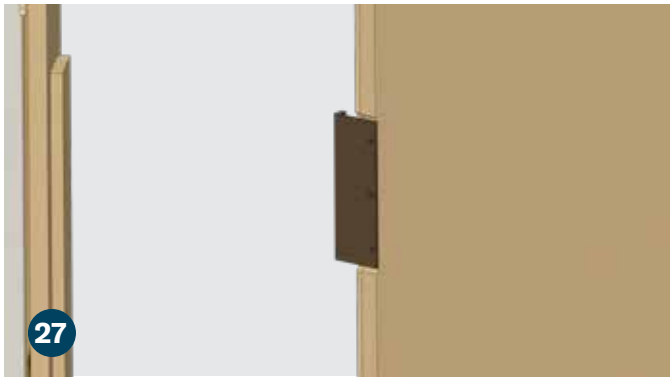

(Show on an out-swing door)

Attach the interior pull handle to the recessed surface on the side of the door. Make sure the front edge of the handle is flush with the front of the door. If you have a mag lock on your door, the armature will replace this handle.

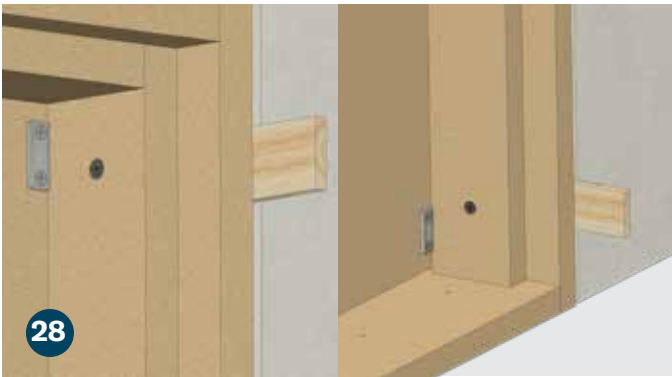

OUT-SWING MAGNETIC CATCH:

Mount the top magnetic strike about 7/8" down from the top of the door, and so that it just clears the stop molding when the door closes. Mount the bottom magnetic strike about 1/2" up from the bottom of the door, and so that it just clears the stop molding when the door closes.



OUT-SWING MAGNETIC CATCH:

Mount the top and bottom magnetic catches so that they align with the strikes, and make contact with the strikes when the door is closed. This will put the front of the catch approximately 1/8" back from the front of the jamb.



IN-SWING:

On inswing applications, the strike will need to be attached directly to the facing material you are using on your wall. The strikes should be placed about 1/2" from the edge of the door, and about 1/2" from the top/bottom of the door. The catches will be installed on the jamb so that they align with the strike, and they allow the door to close fully. This will put the front of the catch approximately 1/8" back from the front of the jamb.



Before you start

- Identify the non-hinge side jamb with the pocket for the electro-magnet. The side with the pocket will be the INSIDE face of the jamb. The front edge of the jamb will be the edge that measures ~2" from the pocket. If this side jamb is installed wrong the door will not completely close.

Finishing

- All Mag-Lock components should be removed or masked before any finishing or painting is done.
- **The wiring diagrams for your mag lock kit are available at <https://murphydoor.com/pages/instruction-manuals>**
- Make sure your door works properly before you finish the wall.

Installation tips

Wiring

- Plan out your wiring before you finish the door and wall. This will help conceal the wiring.

Jamb

- Center the mounting plate for the electromagnet in the pocket as best you can.
- Avoid pinching the wires for the electromagnet.
- DO NOT over or under tighten jamb. When installing the jamb you need to make sure it is shimmed properly. It should be level and square with the threshold and header. If the jamb is not square it may cause your door to function improperly or appear to sag.



MURPHY DOOR®

Mag-Lock Installation - Hidden Panel Murphy Door Kit

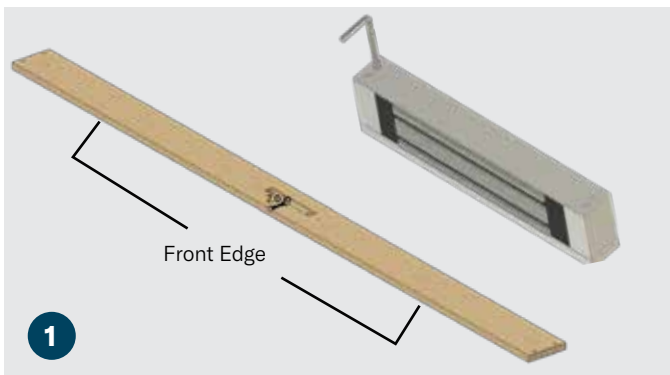

Identify your non-hinge side jamb and locate the electromagnet pocket. Determine the front edge of the side jamb, it will be about 2" from the edge of the pocket. The back edge will be about 1-9/16".

Remove the mounting plate from the electromagnet by using the included 3mm hex wrench to loosen the internal screws. These are accessible through the small hole at each end along the side of the magnet housing.

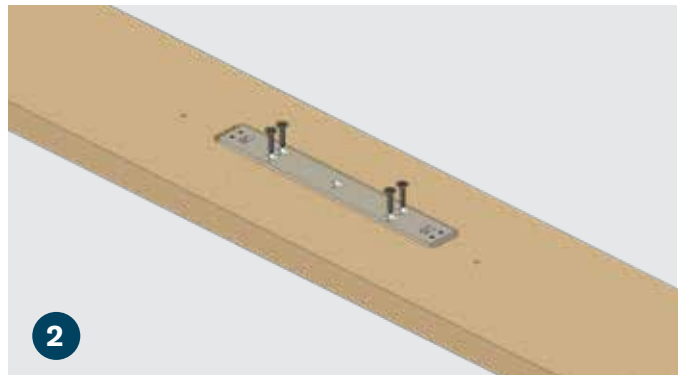

Center the mounting plate in the pocket and attach using 4 of the included wood screws.

The center screw hole in the plate will be used to secure the jamb to the rough opening using a 3" lag screw.

PLEASE READ INSTRUCTIONS FULLY BEFORE YOU BEGIN ASSEMBLY

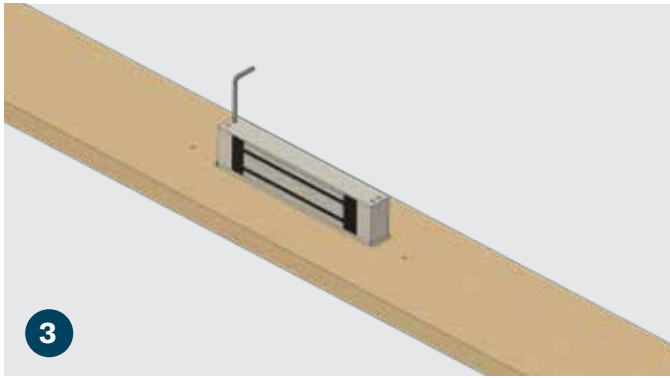

3
Re-attach the electromagnet to the mounting plate the same way you removed it. Make sure the 3 magnetic bars are facing the front edge of the side jamb.



4
Locate the armature and place it face down on a hard surface so that the two 4mm holes are facing up.
Using needle nose pliers, hold the roll pin in place over the holes and set them in place using a hammer.

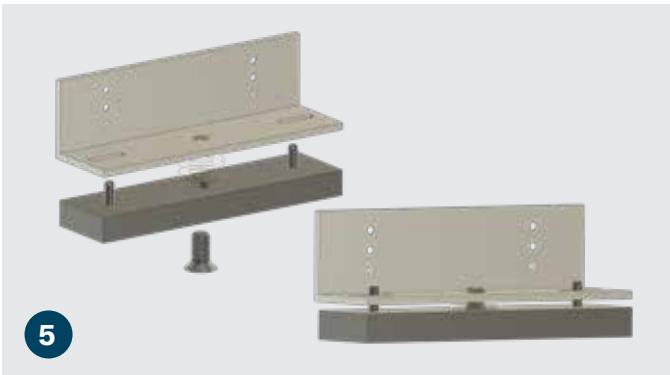

5
Align the 8mm flat head screw, the armature, 2 silicone washers, and the mounting bracket with the threaded hole through the center and assemble them as shown in the diagram above.

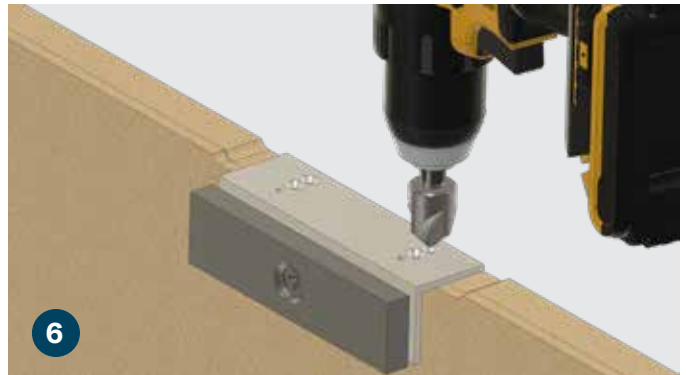

6
Using a countersink bit, counter sink the 4 holes furthest from the armature on the outside of the "L" bracket as shown in the image to the right.



7
Align the "L" bracket so that it is centered in the routed section along the side of the door, the armature overhangs the back side of the door (the side with the hinge mounting points), and the front edge of the "L" bracket is flush with the front of the door.

Using a 3/16" drill bit, pilot drill the 4 holes that you countersank in the last step.

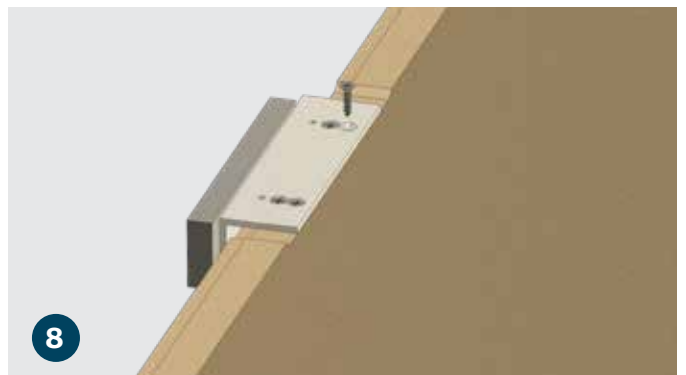

8
Secure the "L" bracket using the 4 of the wood screws included with the mag-lock kit.

You can now proceed with the installation of your Hidden Panel Door.