

 Quality pavement board produced in 45 mm silver anodized alu snap-frames with mitred corners. APET anti-reflex front panels. Mounted with black rubber to protect the poster from water. Springs are made of steel and the feet are powder coated (RAL 9006).

 Qualitets Strassenständer mit 45 mm Alu Klapp-Rahmen und Ecken auf Gehrung. Polyester-lackiertem Stahlfüße (RAL 9006) und Stahlfedern. Mit entspiegelte APET Frontplatten. Mit schwarzem Gummi monteret zum Schutz gegen Wasser.

 Kvalitetsprodukt med 45 mm alu snap-frames og geringshjørner. Polyesterlakerede stålben (RAL 9006). Monteret med stål fjedre. Antirefleks APET frontplader. Skumliste monteret mod indtrængning af vand.



**Watersafe
and wind
stable**

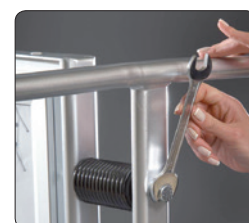
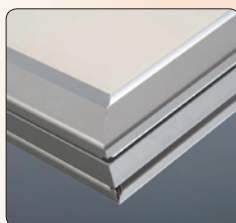
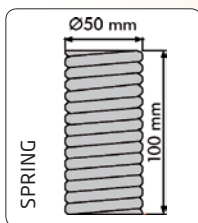
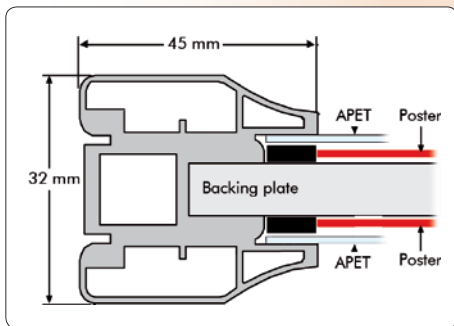
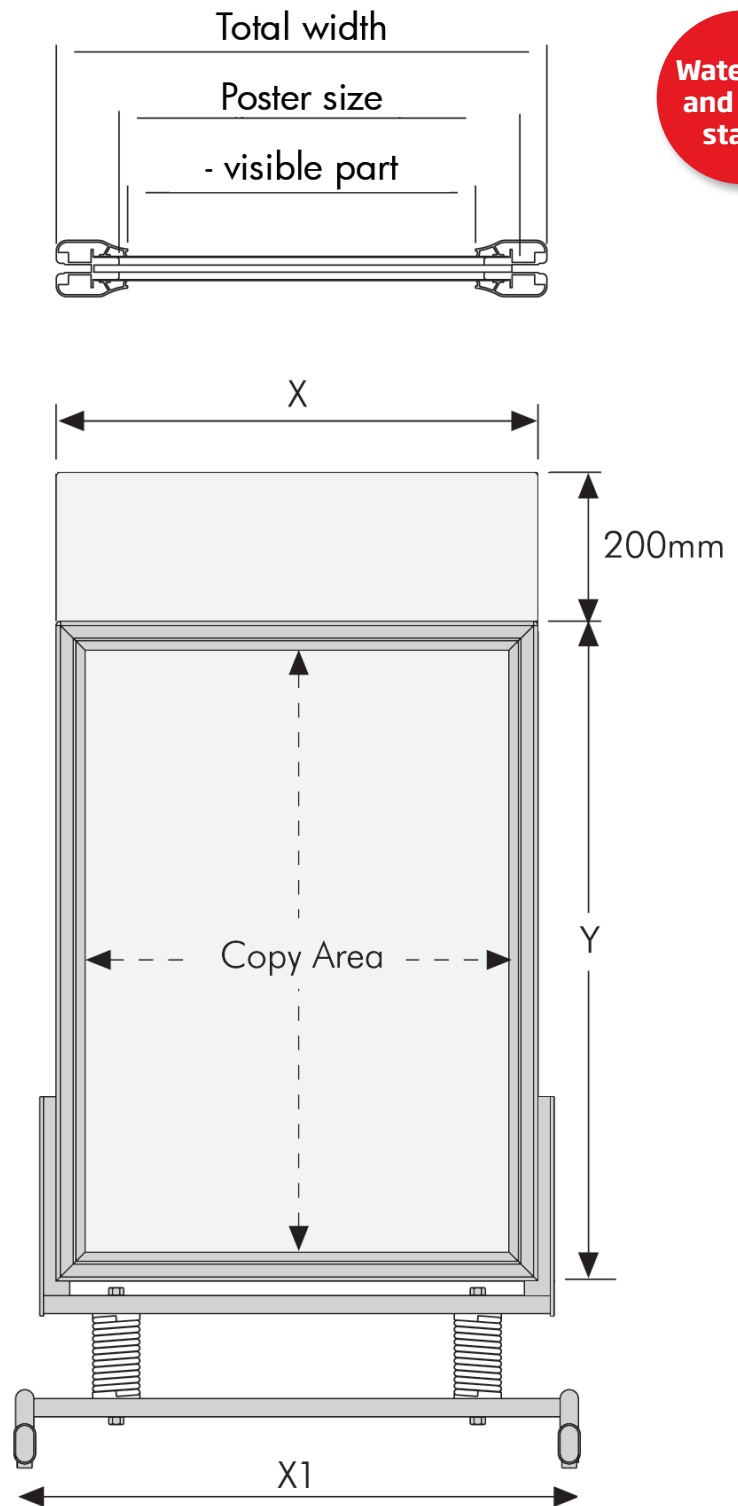

Model	Art.no.	Poster size	Visible part	Colour	Total W x H	Package size and weight	Pallet size and quantity
125	4657	50 x 70 cm	48,2 x 68,2 cm	Alu/Silver	61,2 x 101 x 90 cm	65 x 110 x 12 cm 12,0 kg	80 x 120 x 220 cm 20 pcs.
-	4655	59,4 x 84,1 cm A1	57,6 x 82,3 cm	-	70,6 x 115 x 105 cm	80 x 120 x 12 cm 16,0 kg	80 x 120 x 220 cm 18 pcs.
-	4658	70 x 100 cm	68,2 x 98,2 cm	-	88 x 131 x 124 cm	85 x 130 x 12 cm 21,0 kg	80 x 120 x 220 cm 18 pcs.
-	4656	84,1 x 119 cm A0	82,3 x 117,1 cm	-	95,3 x 150 x 140 cm	100 x 150 x 12 cm 25,0 kg	100 x 120 x 220 cm 15 pcs.
-	4659	100 x 140 cm	98,2 x 138,2 cm	-	111,2 x 171 x 160 cm	120 x 170 x 12 cm 34,0 kg	120 x 120 x 220 cm 15 pcs.



- GB** Connect the pieces as shown in the picture.
- DE** Die Schraube durch die Scheibe und das Röhrchen wie abgebildet durchstecken.
- DK** Saml delene som vist på billedet.



- GB** Attach the legs on springs by screw unit.
- DE** Die Schrauben sind durch die Bohrungen am Fussteil durchzustechen und an die Verzahnung unter der Feder befestigen.
- DK** Sæt skruerne igennem de forbo-
rede huller i foden.



- GB** Fix the base, frame and the springs by tightening the screws with wrench.
- DE** Mit Hilfe eines Maulschlüssels die Schrauben festziehen.
- DK** Skru foden, rammen og fjederne sammen med en skruenøgle.



- GB** Open all profiles.
- DE** Alle Profile aufklappen.
- DK** Åben profilerne

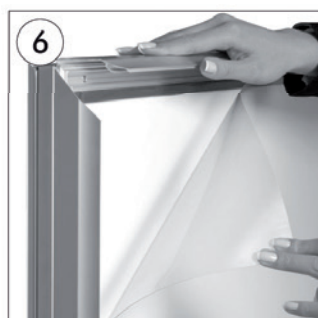

- GB** Take-off the front panel.
- DE** Frontscheibe abheben.
- DK** Løft frontpladen



- GB** Place the poster under the front panel.
- DE** Poster unter Frontscheibe einlegen.
- DK** Læg plakaten ind under frontpladen.



- GB** Close the profiles.
- DE** Die Seitenprofile zuklappen.
- DK** Luk profilerne.

**Watersafe
and wind
stable**

