

BIONIC ARM™ Product manual

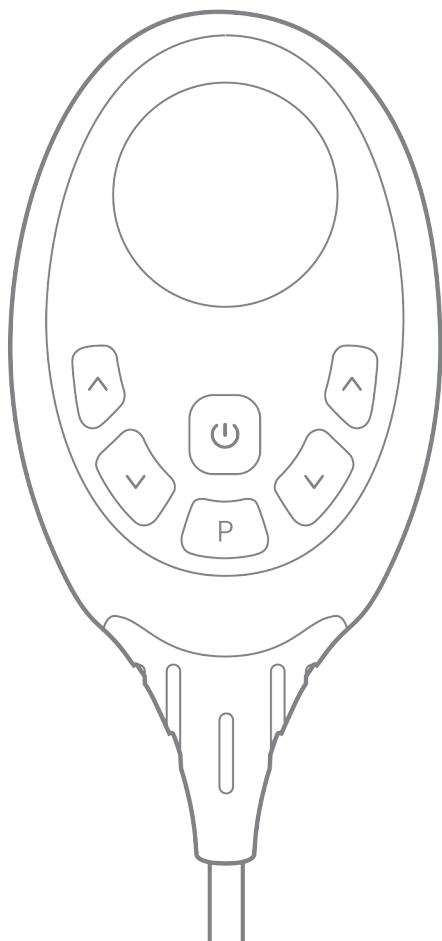

When you see this mark, please read the manual carefully or contact customer service to ask for help.





This product can match the next garments



Waist belt



Arm belt



Shaping short



Big leg belt

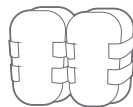

Controller display key description

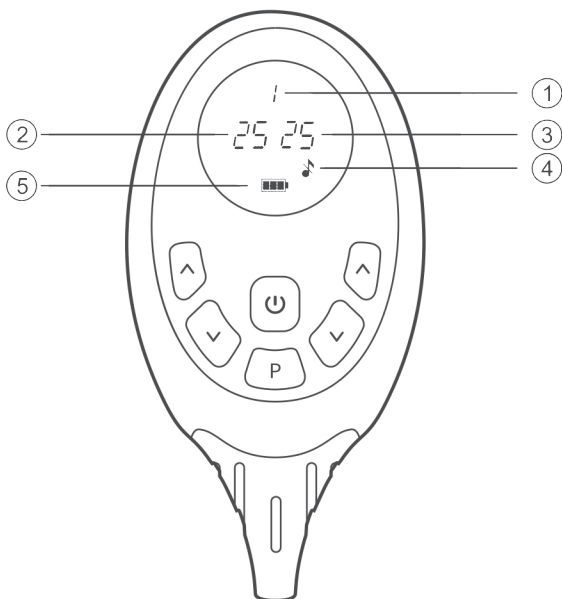

Controller use instruction

Note: The controller button can be used normally when the adhesive patch is pasted, the equipment is worn and the controller is connected.
The switch of the single controller cannot be operated

- ① Sport mode display ② Left Intensity display ③ Right intensity display
④ silent ⑤ Battery power capacity display



Turn on/off button, long press 3 seconds then can turn on /off device



Mode button, When you turn on the device, then can choose the mode



Intensity button, Choose the mode then increase the intensity level, Two sides can add intensity separately



The decrease of intensity is opposite of increase intensity button, and decrease the intensity separately

Product user procedure

1

Controller charging about 30 min

Connect the snap end of the charging line to the controller, plug in the socket for about 30 minutes, and the screen battery icon in the controller scrolls to indicate that the charging is normal (if the controller is powered, it can be used directly. Check the method, press and hold the power key of the controller to prompt the exclamation mark, it can be used directly by connecting the intelligent plastic belt)

Note: Because of the connector difference between Mainland and Oversea, Product match standard USB cable

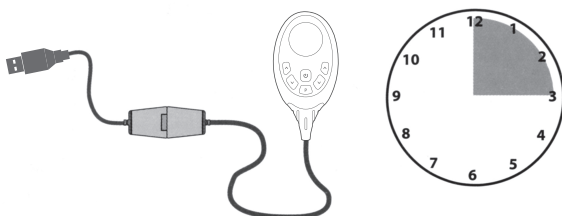

2

Charger separate from controller

After charging, unplug the charger and press both sides of the controller interface to separate the charging line from the controller

Note: Because of the adapter plug difference between mainland and overseas, Product connector has HDMI and SATA two connector hole

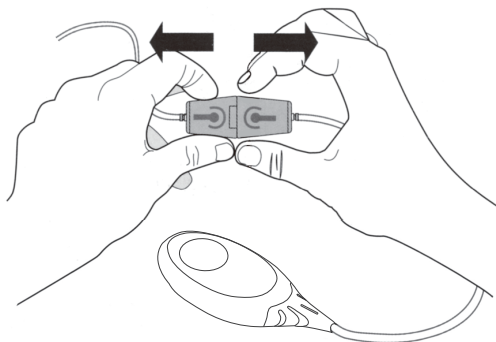

Intelligent fiber arm band

3

Stick the gel patch, take the intelligent molding belt.

Take out the gel patch, tear off the protective film of the gel patch, paste the gel patch in the white area, make sure that the patch completely covers the metal nail, the mesh is facing inside, the black side is facing outwardly, the plastic film on both sides is torn off, and it is kept well. Paste back the surface protection patch after the exercise

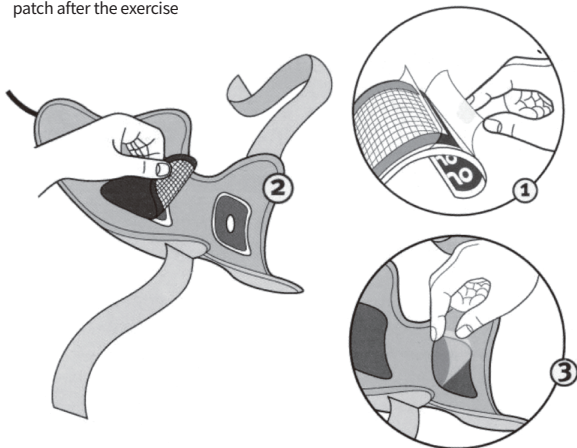

Stick two ties on one side of the fiber arm belt, point the elbow to the symbol of internal measurement of the fiber arm belt, and tie and tighten the fiber arm belt

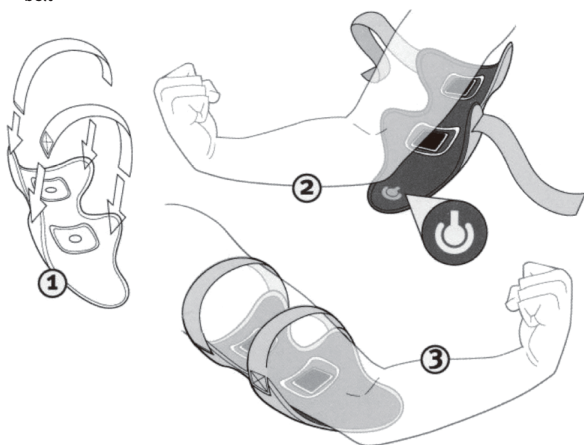

Smart slimming suit

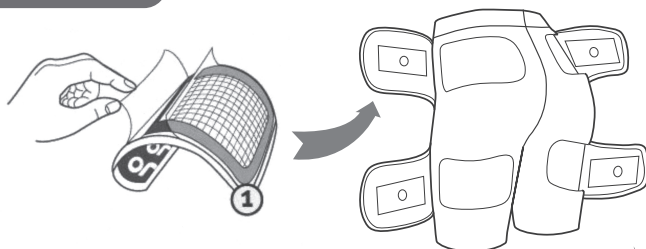

- ① Remove the gel patch and tear off the protective film on the mesh surface.
- ② Paste the gel patches in the white area to ensure that the patches are completely covered with metal buttons. Make sure that the metal studs are covered when the patch is finished

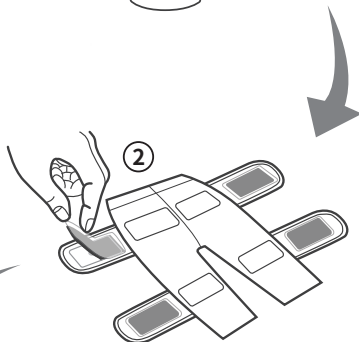

- ③ After wearing, tear off the protective film on the black side, stick it back to the corresponding position, keep the protective film, stick back the patch after the exercise, prevent dust on the surface and protect the patch

The smart molded pants are worn over the buttocks, so that the gel patches are pasted into the skin.



③

Waist belt

Remove the gel patch and tear off the protective film on the surface of the patch grid
Paste the gel patch in the white line area to ensure that the patch is completely covered with metal buttons.

The grid faces in, the black faces out

Tear off the plastic film on both sides, and keep it well. When the exercise is over, stick back the protective patch

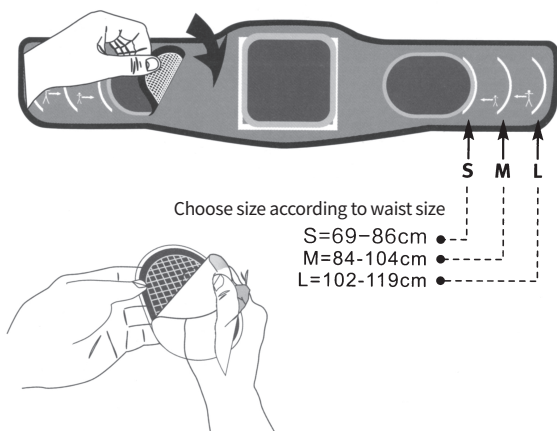

Tie the belt around the waist. Glue the gel to the skin and place the middle part of the navel in the middle. Pay attention to the lack of too tight and cause discomfort.

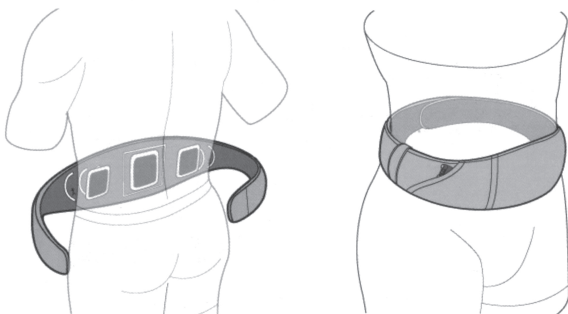

Intelligent thin leg belt

Remove gel patch

Tear off the protective film on the grid side of the patch

Paste the gel patch in the white line area to ensure that the patch is completely covered with 2 metal pins.

The grid faces in, the black faces out, and the plastic films on both sides are torn off

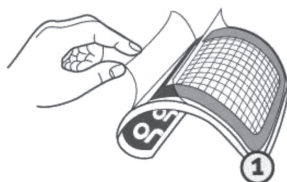
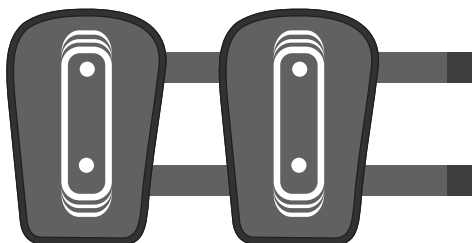

See the figure below after the patch is pasted

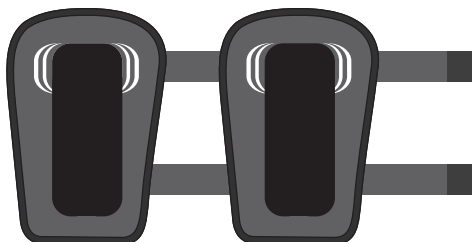

Bring the intelligent thin leg in the middle of the thigh

The patch is positioned in front of or behind the thigh

Glue the gel onto the skin.

Fasten the thin leg belt. Be careful not to tie it too tightly to cause discomfort

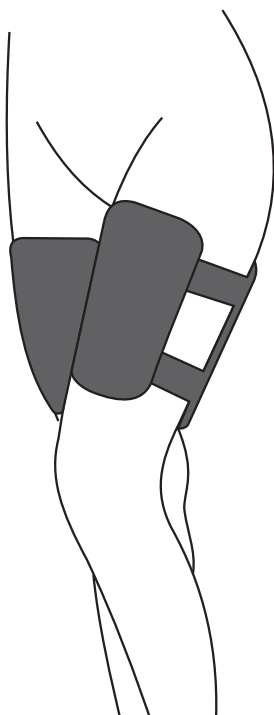

4

Connect controller and intelligent plastic belt

Align the charged controller interface with the molding belt interface and connect the molding belt

Note: Because of the adapter plug difference between mainland and overseas, Product connector has HDMI and SATA two connector hole

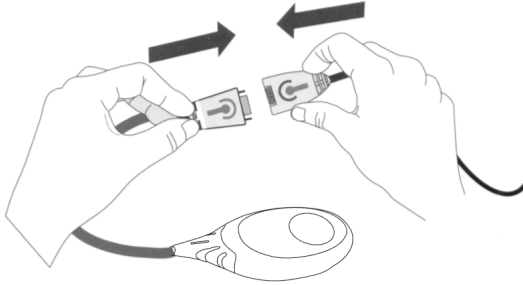

5

Boot use

Press and hold the controller switch for 2 seconds to start the machine, and then press the select mode (it is recommended to start from mode 1, and then set the intensity of the mode by pressing the increase or decrease key)



Press and hold the power on key for 2 seconds to switch on and off

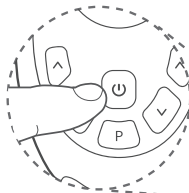

Press the increase keys on the left and right sides alternately, and try to increase the intensity to a comfortable level

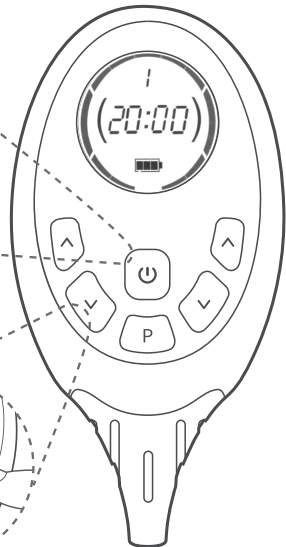
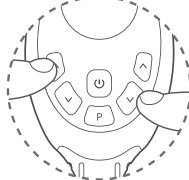

6

Shutdown the machine

Press and hold the controller for 2 seconds to shut down, remove the molding tape, stick the protective film of the patch back to the patch, and save the intelligent molding tape

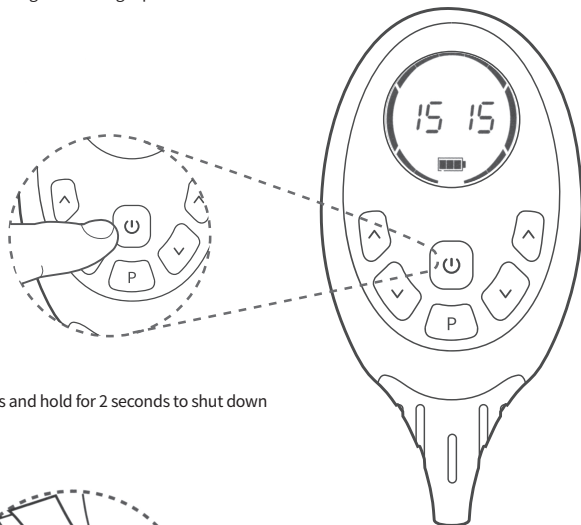

Press and hold for 2 seconds to shut down



The plastic film is pasted back to the patch to protect the patch. After the exercise, the patch can be kept on the intelligent plastic belt without taking it off

Recommendations for use

- It is recommended to use each mode step by step and comprehensively
Intelligent fiber arm band can be used once a day in modes 1-3
Intelligent leg and hip lifting belt can be used in two modes of mode 1-4 every day
Intelligent thin belly belt can be used in two modes 1-10 every day
- Each mode of simulated exercise is different. Comprehensive use of each exercise mode can help you to exercise comprehensively, and gradually increase your strength according to your bearing capacity during use
- It can be used 1-2 times a day for 30-60 minutes. It is recommended to use it separately to make the skin and muscles feel better at rest. It should be used for 5-6 days a week. Do not over exercise, so as to avoid body strain and affect the later exercise effect
- It is recommended to increase the intensity during exercise. You will feel stronger contraction of muscle movement. Keep the muscle tight during micro electric pulse stimulation. Do not relax, but reduce the intensity if you feel uncomfortable

Notes

- When the human body is implanted with electronic medical auxiliary equipment (such as cardiac pacemaker), it is forbidden to use
- Epilepsy patients, malignant tumor patients, patients with severe mental trauma are forbidden to use
- No use for patients who have recently been exposed to surgery
- Do not use when operating dangerous machines
- Pregnant women are not sure whether there is any impact, please do not use
- Use temporarily when the skin is abnormal (such as trauma, redness, scratches, etc.), and use again after the skin recovers
- Do not use if you are allergic, have abnormal skin perception or have any obstacle

Common problem

1、 There's a patch position that doesn't feel obvious

Yes, it's normal, because there are positive and negative poles in the micro pulse electric impulse, and the positive pole is on both sides, so the feeling is obvious. The negative pole is in the middle, and the feeling is weak. In the process of using, the micro pulse flows from the positive pole to the negative pole to form a cycle, so as to bring muscle group movement, which is the working mode of the product

2、 Can the product be used by more than one person

It is not recommended to use the product by more than one person, because it has an impact on the use of the rubber pad. For hygiene reasons, the rubber pad is only used by one person, or it is recommended to replace the rubber pad with a new one

3、 Products can be used multiple times a day

It is recommended to use in the same Part 1-2 times a day. It is not recommended to use it multiple times a day. The skin needs to breathe. Long time use may affect the skin's rest, and this may cause muscle fatigue or affect the effect, because the skin cannot be relaxed and recovered in time

4、 Can I use this product if my skin is abnormal

In case of abnormal skin conditions, such as red spots, dark sores, scars, skin scratches, etc It can't be used regardless of the degree. Because the skin is abnormal, it may cause the micro electricity to directly stimulate the muscles without filtering through the rubber pad, which may cause uncomfortable irritation. It is recommended that when using the product, the rubber pad and the skin contact should avoid the abnormal place, or use the product after the skin recovers

5、 Can I fix a program after using all modes of the product once

It is not recommended to use only one procedure for fixation, because there is only one muscle stimulation feeling. Compared with comprehensive, all-round and multi angle exercise, the effect will be reduced. In addition, after consolidation exercise, it is more necessary to use muscles comprehensively to maintain perfect posture. It is recommended to use all circulation procedures, and continuously increase intensity exercise under acceptable conditions

6、 The product is irritating and uncomfortable

First, turn off the controller, re fix the home molding belt, and determine whether the position of the gel patch is placed correctly to ensure that the gel patches are completely

covered with metal nails. At the same time, it should be close to the skin , Recheck the skin for abnormalities Or Check the gel patch with impurities or breakage. After shutting down the controller, try dropping a few drops of water on the gel patch on the black surface, which will aggravate the comfort of muscle stimulation

7、 My skin is red after exercise. Is there any problem?

It's normal for the skin to turn red after exercise, Part of the redness is due to the increased blood flow under the skin, It will fade after a period of time, It may also be the indentation caused by the too tight molding belt, which makes the skin red. After the molding belt is removed, it will soon fade away, If there is too much reddening skin, it may be that the training is too high intensity, which may increase the skin's sensitivity and reddening. Try to exercise with a lower intensity for a few days. If the problem still exists, you should stop using the belt to contact customer service immediately

8、 Can pregnant women use it, what about the special period of female month blood?

It is not recommended to use thin abdominal belt during the period of female month blood Pregnant women cannot use this series of products

9、 Does the product cause muscle soreness?

Just like all sports, exercise with load will cause muscle ache, and it may also cause muscle ache after using shaping belt. This is normal, and it will disappear in one or two days, otherwise, it will not cause muscle ache without overload exercise

10、 When do I change the adhesive gel pad?

- When the gel patch becomes dry and thin, the strength is obviously not as good as before. It is recommended to replace it.
- When the gel patch is curled or the surface is damaged, it is recommended to replace it.
- It is recommended to replace the gel when it is obviously dirty or sticky with impurities.
- When gelatin patches are damaged by heat melting, it is recommended to replace them.
- When the loss of gel patch is serious, the control device will increase alarm.

Product maintenance

Controller maintenance

- Do not touch the controller without permission
- Do not overcharge to avoid damage to battery life
- Keep away from the fire source to avoid danger caused by explosion of built-in battery
- Do not expose the controller Do not wash the controller
- Please keep the controller in a cool and dry place after use

Plastic belt maintenance

- Do not cut the Molding belt
- If the plastic belt sticks sweat, It can be dried naturally or with a blower
- Do not wash the plastic belt with water to avoid damage to the circuit
- Please store the controller in a cool and dry place after use

Gel patch maintenance

- Keep skin clean when using
- Avoid sticking the gel patch to the dirt, and put it back to the protective film after use.
- Please do not pull the gel patch. Avoid gel edge curling and abrasion.
- Do not stick the gel patches together so as to prevent the adhesion from being dismantled and damaged.
- Do not wash sunburn gel patches to avoid damage
- The gel patch is a consumerable piece. When damaged, the performance is weakened or can not be used, replace it.
- Please keep the controller in a cool and dry place after use

Aftersale service

In order to protect the right of customer , offer good service. Our company formulates after-sales service system in strict accordance with national laws and regulations

1. After consumers purchase our products and enjoy after-sales service, they should completely fill in the contents of the card

2. Deadline of service. Our products will be used normally within 7 days from the date of sale. In case of failure, consumers can choose to refund, return, repair and other services. After consumers purchase our products, if there is non-human failure in the product controller within one year, they can be repaired free of charge. For consumers who do not meet the free replacement or free warranty service, our company provides technical services, but the replacement parts of the products are produced The cost of materials and freight shall be borned by the consumer

3. The starting date of warranty shall be the date of logistics receipt after purchase of order

4. Under one of the following circumstances, Aftersale service is not available

1) All damages caused by human factors and abnormal working conditions, failure and damage caused by non-compliance with the instructions

2) In order to dismantle, repair and refit the product without permission with the consent of the company's customer personnel

3) Damage caused by poor transportation after purchasing our products

4) Due to other force majeure (fire, flood, earthquake, lightning)

5) Fold, wear, tear and infection caused by normal use

6) Products which do not belong to our company

7) Cannot offer valid vouchers, shopping cards, etc

5. The gel tablets sold in this product are consumables, so they are not within the scope of warranty.

6.Product replacement warranty procedure

In case of any failure in using our products, the customer shall contact our company for maintenance with the transaction record.

Customer Service Phone: 516-653-0666

Email: Sales.IgiaNY@gmail.com.

Individual results may vary. This product has not been evaluated by the FDA.

The product color or appearance may vary.

WWW.IGIA.COM



**Scan more
products**

DISCLAIMER NOTICES

In the process of the preparation of this manual, we have sought to make the content correct and complete. However, there is no guarantee that there are no errors or omissions in the manual.

We reserve the right to change specifications of the products mentioned in this manual at any time without prior declaration. No part of this manual shall be reproduced, transmitted, transcribed or stored in a searchable system or translated into any other languages without the written authorization of our company. The company is not responsible for the loss caused by non-standard or wrong operation.

WARRANTY CLAUSES

Damage caused by failure to follow the instructions, human factors, force majeure, etc. is not covered by warranty. Maintenance cost will be charged for product out of warranty. You can register for your free warranty on www.IGIA.com.

PRECAUTIONS FOR USE

- 1. Safety not determined for use during pregnancy: DO NOT USE.**
- 2. Persons with heart problems or persons using a heart pacemaker or with a cardiac condition: DO NOT USE.**
- 3. Persons with suspected or diagnosed epilepsy: DO NOT USE.**
- 4. After childbirth and with breastfeeding: DO NOT USE.**
- 5. Epilepsy: DO NOT USE.**
- 6. Don't place it near to your heart area.**
- 7. must be kept out of reach of children.**