

## 1064/1035 nm Polarization Insensitive Ultra High Power Isolator

Model #: UHPI

Description: 1064 nm Polarization Insensitive Ultra High Power Isolator

Application: Fiber amplifier, fiber laser.

Specifications:

Parameter	Unit	Specifications		
Central Wavelength	nm	1064		1035
Typ. Peak Isolation	dB	26	30	30
Min. Isolation ( $\lambda_c$ , 23°C, all polarization states)	dB	23	25	25
Typ. Insertion Loss ( $\lambda_c$ , 23°C)	dB	1.1	1.3	1.5
Max. Insertion Loss ( $\lambda_c$ , 23°C)	dB	1.3	1.6	1.7
Min. Return Loss (input / output)	dB	50/50	45/45	
Max. Polarization Dependent Loss (23 °C)	dB	0.15	0.25	
Max. Optical Power (CW)	W	10	20 or 30	20
Max. Peak Power for ns Pulses	kW	10		
Max. Tensile Load	N	5		
Dimension	mm	32 (W) x 28 (H) x 60 (L)	38 (W) x 37 (H) x 90 (L)	
Fiber Type		HI 1060 Fiber	Nuferm FUD-3485 SM – GSF-10-125 fiber (*0.08)	

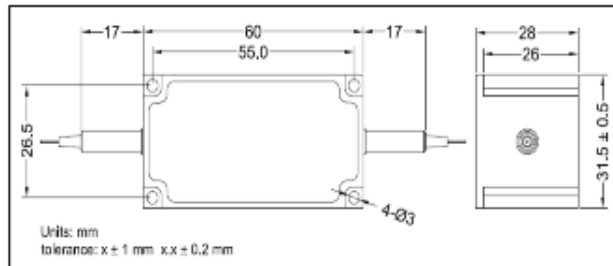

**Type A**

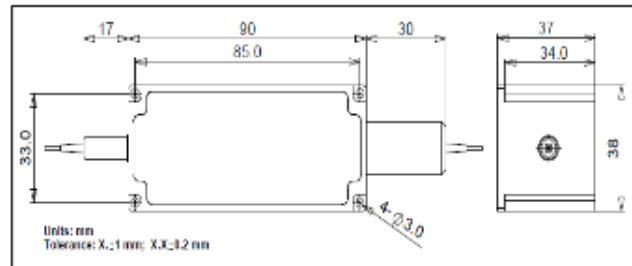

**Type B**

### Ordering Information:

**UHPI-AA-BB-C-D-E-F**

AA: wavelength	BB: power handling	C: connector type	D: fiber jacket	E: fiber length	F: power type
06 - 1064 nm	03: 3 W	N – none	B - 250 $\mu$ m Panda fiber	1 – 1.0 m	P - Pulsed
03 – 1035 nm	10: 10 W		L - 900 $\mu$ m loss tube	X - other	C - CW
XX - Other	20 – 20 W		X - other		
	30 – 30 W				
	XX: other				