

Gain Flattening Filter for EDFA

Model #: GFF

Description: Gain Flattening Filter

Application: Fiber amplifier, fiber laser

Specifications:

Parameter	Unit	Specifications
Wavelength Range	nm	As filter spec
Max. Peak Insertion Loss	dB	0.6
Typ. Peak Insertion Loss	dB	0.4
Peak to Peak in Error Function	nm	0.5
Max. Wavelength Thermal Drift	nm/°C	0.002
Max. Polarization Dependent Loss	dB	0.1
Max. Polarization Mode Dispersion	ps	0.1
Min. Return Loss	dB	50
Max. Optical Power (CW)	mW	300
Operating Temperature	°C	-5 to +70
Storage Temperature	°C	-40 to + 85
Dimension	mm	5.5 (D) x 35 (L)
Fiber Type		SMF-28 fiber

Note: each connector may contribute an extra 0.3 dB IL, 5 dB lower RL. All of the above values are tested at room temperature @ 23°C unless otherwise specified.

Package Dimensions

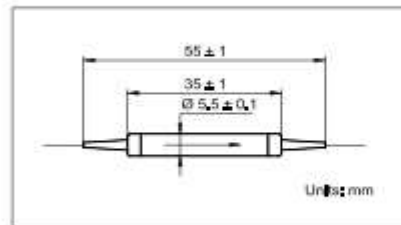

Standard Package

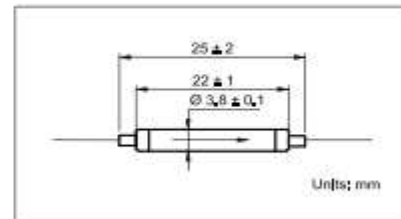

Mini Package

Ordering Information:

GFF-AAAA-B-C-D-E-F

AAAA: wavelength	B: connector type	C: fiber jacket	D: fiber length	E: package type	F: package type
2865 – 1528 ~ 1565	1 - FC/UPC	B - 250µm bare fiber	1 – 1.0 m	1 – standard package	1 – standard package
7010 – 1570 ~ 1610	2 - FC/APC	L - 900 µm loss tube	X - other	2 – mini package	2 – mini package
XXXX - specify	3 - SC/UPC	X - other			
	4 - SC/APC				
	N - none				
	X - other				