

# Garden Storage Box - Green/Brown

User Instructions - Please keep for future reference

ArtVer#2



Imported by:  
KCT Direct  
Glebe Farm, Old London Road  
Copdock  
Ipswich, Suffolk  
IP8 3JN  
United Kingdom

## PARTS LIST

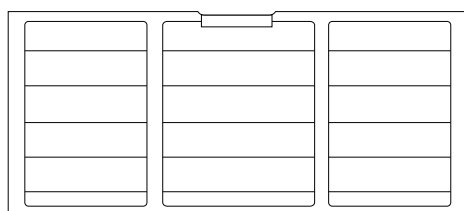

Front Panel

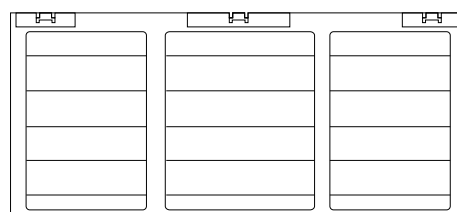

Back Panel

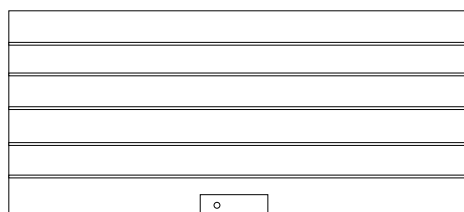

Lid

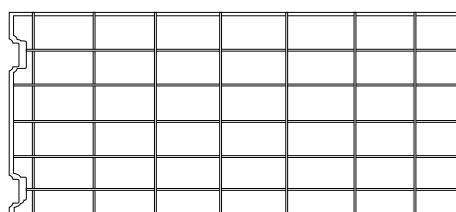

Bottom Panel

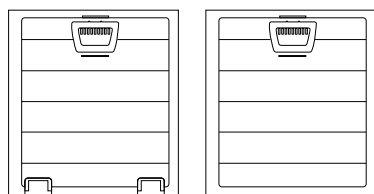

Left Side  
&  
Right Side



x 3 PCs



x 2 PCs



x 2 PCs

## IMPORTANT

Do not assemble if parts are missing or do not fit correctly.

Make sure the unit is fully assembled and sturdy once assembly is complete.

Ensure storage box is placed on dry footings and is kept away from surface water

# Garden Storage Box - Green/Brown

User Instructions - Please keep for future reference

ArtVer#2

## ASSEMBLE AT ROOM TEMPERATURE

### Step 1

Check you have all parts and nothing has been damaged during transit. Please contact [sales@kctdirect.co.uk](mailto:sales@kctdirect.co.uk) if you have any issues before you begin to assemble the item

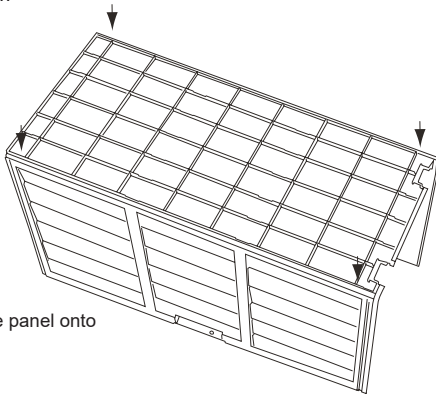

Apply pressure to fix base panel onto the front and back walls

### Step 2

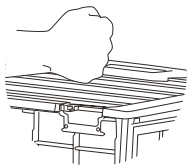

### Step 3

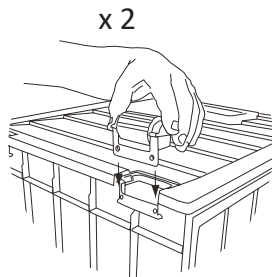

x 2

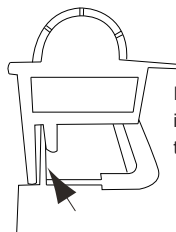
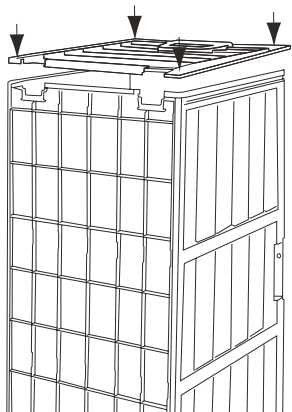

Insert the bottom edge into the groove of the wheel frames.

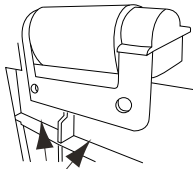

Click the two holes on the frame exactly with the plugs of the bottom panel.

### Step 4

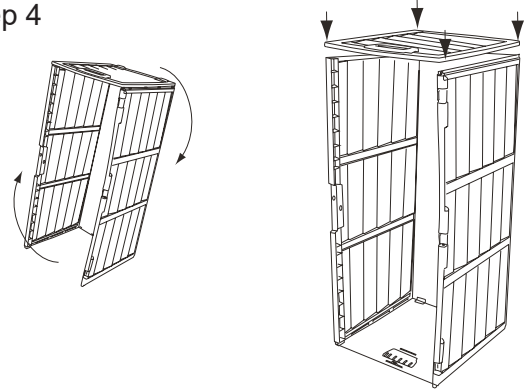

### Step 5

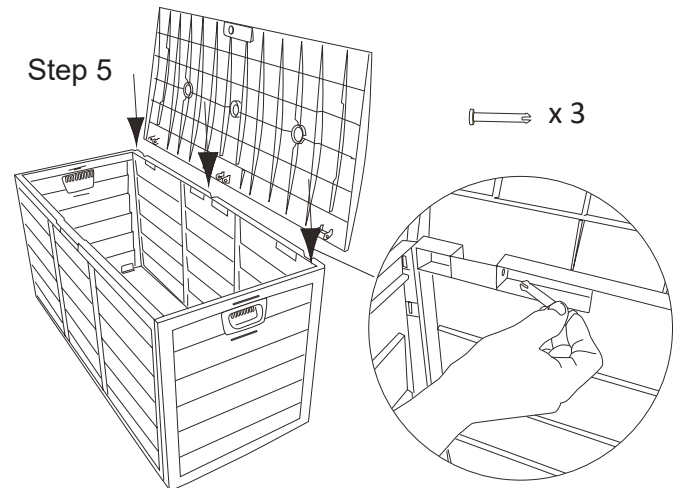

x 3

### Step 6

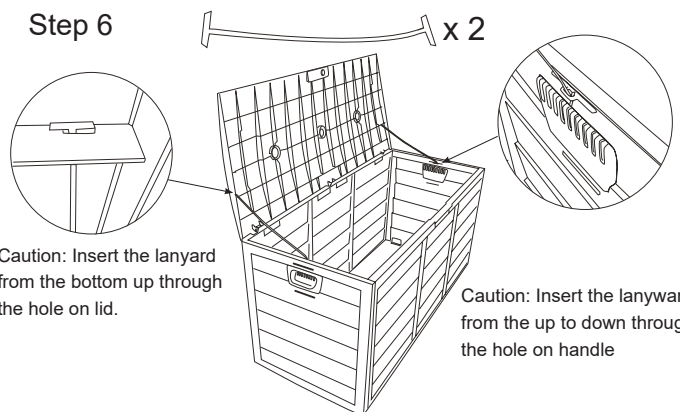

x 2

Caution: Insert the lanyard from the bottom up through the hole on lid.

Caution: Insert the lanyard from the up to down through the hole on handle

### Step 7

Ensure the Item is placed in a location with dry footing and unlikely be exposed to standing water

## IMPORTANT

Do not assemble if parts are missing or do not fit correctly.

Make sure the unit is fully assembled and sturdy once assembly is complete.

Ensure storage box is place on dry footings and is kept away from surface water