

Once the earbuds are comfortably in place, shape the memory earhook so it hugs your ear. Slide the cable cinch up the cord to the base of your head (not too tightly). This will limit cable movement and help keep your earphones in place.

Cable Replacement

Detaching The Cables

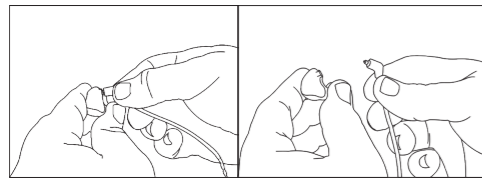

Hold
the earphone and cable firmly
with each hand

Remove
the cable by holding the MMCX connector and
pulling at a straight angle from the socket (Do not
pull by holding the wires)

Tips To Help Your BASN Earphones Last Longer

1. Avoid shock damage/strong impacts to the earphones, as this can affect their performance.
2. Don't expose them to extreme temperatures.
3. Don't immerse the earphones in any liquids as this can temporarily or permanently damage the earphones.
4. Wipe them down after each use to remove perspiration.
5. Occasionally clean the earphones and cables with a soft dry cloth to remove any foreign material. This is especially important after vigorous exercise (especially drumming!).
6. Never pull the cables themselves when detaching them from the earphones. This can affect the cables' performance.
7. Always store the earphones in the hard carrying case when not in use.

Please Note:

Never insert BASN Earphones if your ear is wet or sweaty. Always dry ears beforehand. Moisture in the output nozzle can cause temporary performance problems.

If water or perspiration does find its way into the output nozzle and it stops working, allow BASN Earphones time to dry completely (6-24 hours). Once dry, they should function properly. Extended exposure to moisture or submersion in liquids of any kind could result in permanent damage and isn't covered by the warranty.

BASN Earphones In-Ear Monitors Warranty

BASN warrants the external shell of the product, and the internal components to be free of defects in material or workmanship for a period of twelve (12) months from the date of original purchase. The carrying case, cleaning tool, any adapters and other included accessories are covered for ninety (90) days. Ear tips are not covered by the warranty.

This warranty is available only to the original purchaser. If your product is found to be defective during the warranty period, BASN will either have the product repaired or replace the product with a new or factory reconditioned or substantially equivalent model. This limited warranty does not apply to loss, theft, or any defects attributable to damage beyond the reasonable control of BASN including damage caused by abuse, misuse, misapplication or modifications performed by anyone other than BASN.

Repair/Replacement Warranty

This Limited Warranty shall apply to any repair, replacement part or replacement product for the remainder of the original warranty period or for ninety (90) days, whichever period of time is greater. Any parts or product replaced under warranty will become the property of BASN. Replacement cables, carrying case, cleaning tool, any adapters and other included accessories are covered for ninety (90) days.

Limitation of Liability

BASN disclaims any and all implied warranties, warranties of merchantability and fitness for a particular purpose to the maximum extent permissible by law. BASN shall not be liable for any special, incidental or consequential damages caused by the use, misuse, or inability to use this product. If purchased under a government contract, those contract terms supersede terms stated herein. In some locations, implied warranties cannot be limited. Under certain conditions, these limitations or exclusions may therefore not apply to you. This warranty replaces all other warranties for this product.



BASN

basnaudio.com

We greatly value your satisfaction at BASN.

If you have any questions, please contact us

Email: support@basnaudio.com

Designed by BASN in California

BASN
In Ear Monitor Headphones

OWNER'S MANUAL

Thank you for purchasing a pair of BASN in ear monitor headphones!

Please read the following instructions to set yourself up for years of listening pleasure.

Ear Tips

Each BASN Earphones may include several kinds of the following universal fit ear tips:

1. Round silicone ear tips (the most durable)
2. Maximum attenuation double-layer or triple-layer silicone ear tips (the best noise reduction)
3. Foam ear tips (the most comfortable)

It's important to find the right size ear tip, as you want the best seal possible to block out subwoofer information — plus, you want them to be comfortable enough to wear for long periods of time.

Note: We recommend changing the memory foam ear tips when they get dirty (they may naturally collect dust, dried skin, body oil, ear wax, or other foreign materials). To prevent this and extend the life of the memory foam ear tips, please wipe them down with a clean tissue or dry cloth after every use.

If you're using the silicone ear tips, remove them from the earphones every now and then and wash them in warm soapy water. Make sure they're completely dry before reinstalling them on the earphones.

How to Connect the Cables

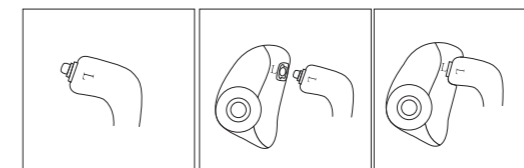

We've color coded the cables so the right one has a red mark and the left one has a blue mark.

Connect the cable with the red mark to the earphone that says "R" (near the connection point).

Then connect the cable with the blue mark to the earphone that says "L".

Insertion Instructions

Before inserting your earbuds, turn down the volume on your sound source and drape the cord down in front. The earpieces are marked with "R" (right ear) and "L" (left ear).

If you're using the memory foam ear tips, compress the foam between your fingers (Pic 1). Insert the ear tips into your ear canal before the foam expands (Pic 2). Hold the earphone in place for a moment to allow the foam to expand to the shape of your ear canal (Pic 3).

If you have trouble inserting the ear tip, reach over your head with your opposite hand and gently pull up and back on the top of your ear. This helps to straighten your ear canal and make it easier to insert the ear tip.

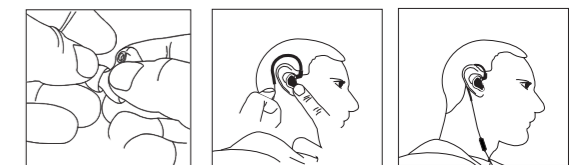

Identify the mark (R) for right ear and (L) for left ear

Insert the earpiece into your ear canal, with cord facing up and earphone nose downward ear canal

Hold earpieces into position and make memory earhook to the shape of your ear