

Tanaro Cavity System

Formulating
character and
distinction.

☎ 1300 754 337

🖱 www.criterionindustries.com.au

 **Criterion**





Tanaro

The Tanaro cavity unit delivers a premium solution in a variety of commercial and residential spaces.

Engineered to deliver a flush finish between the track and the ceiling, the Tanaro design creates smooth continuous flow from room to room. A square-set finish around the perimeter of the frame provides a seamless finish to ensure your design is uninterrupted.

The Tanaro aluminium track system can carry up to 180kg doors and is customisable and readily available to order. The Tanaro System is available in a variety of design options, including flush head detail, pelmet detail and overtaking doors.

Designed to conceal the stems of roller assembly and the overtaking doors, the pelmet head detail allows for flexibility within the door width. Double and triple overtaking doors offer maximum customisation.

The Tanaro range achieves solid acoustic reduction through the use of seals and panels to the cavity structure. It represents an ideal option for separating larger spaces.

Why Choose Tanaro?

- + Manufactured to suit 38mm Timber doors
- + Manufactured to suit 44mm Aluminium doors
- + Holds up to 180kg door capacity
- + Engineered roller system
- + Wide range of design options

Roller Options:

- + Standard Roller

Optional Extras

Rebated Closing Cap:

- + 118mm Rebated Closing Cap 3000mm
13mm Plaster / 92mm Stud / 13mm Plaster



Tanaro Cavity

Meerkin & Apel

BI-PARTING CORNER TANARO CAVITY UNIT -
MEERKIN & APEL, MELBOURNE

TANARO ELEVATIONS - TIMBER DOORS

PELMET DETAIL

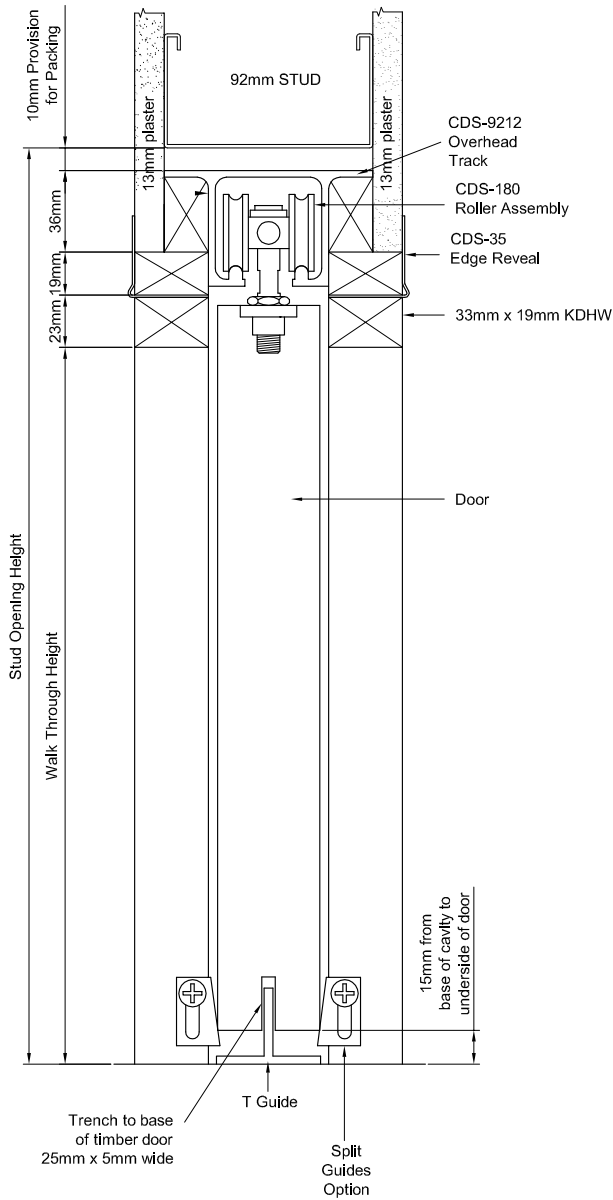

FLUSH HEAD DETAIL

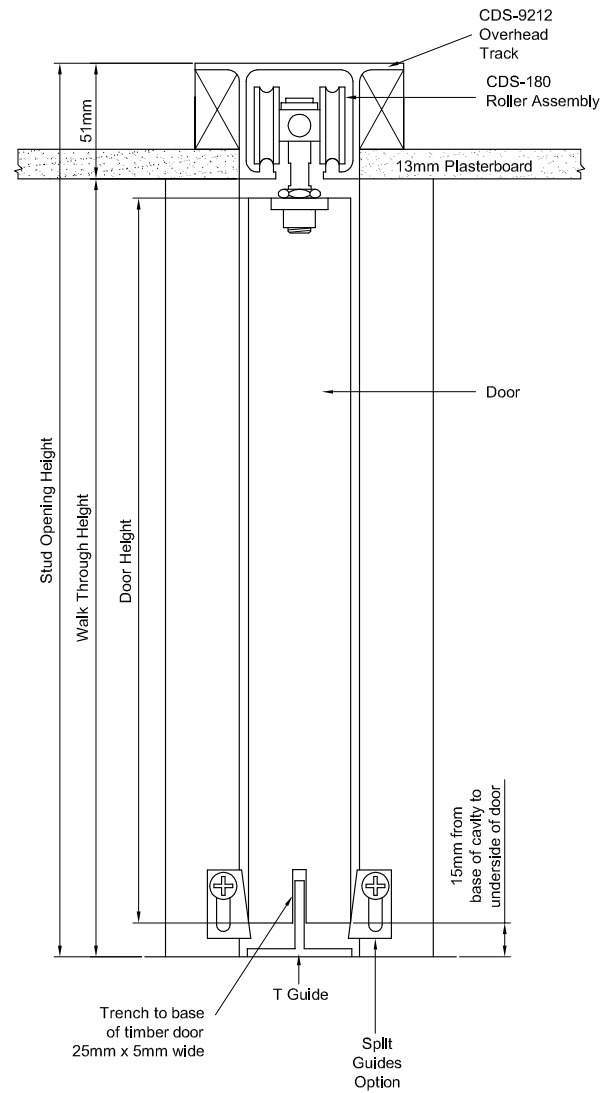

TANARO ELEVATIONS - ALUMINIUM DOORS

PELMET DETAIL

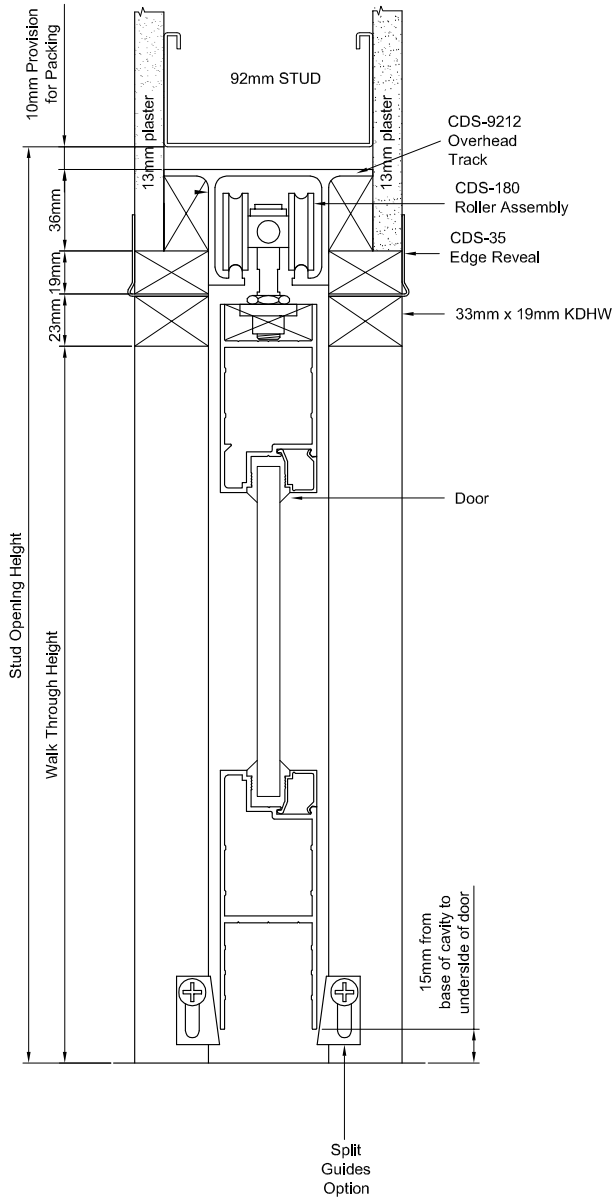

FLUSH HEAD DETAIL

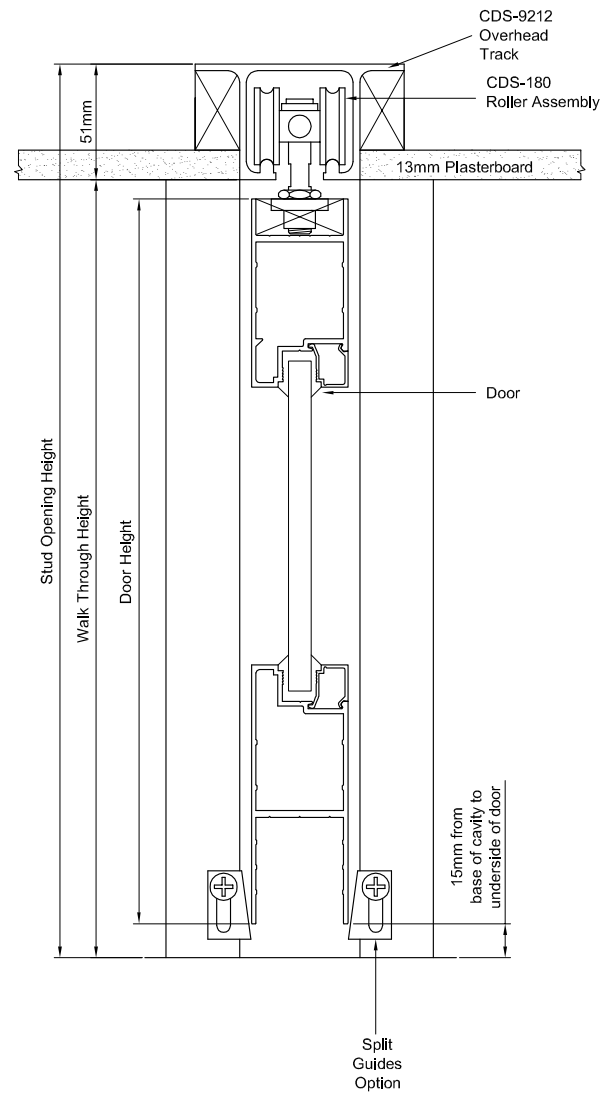

TANARO PLAN VIEWS

SINGLE DOOR

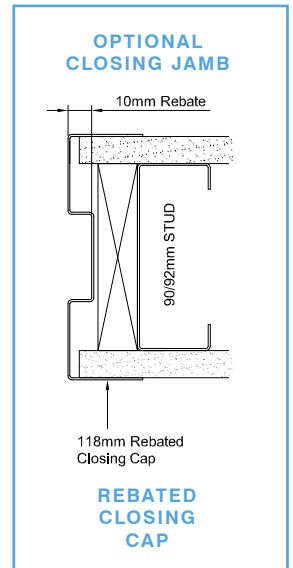
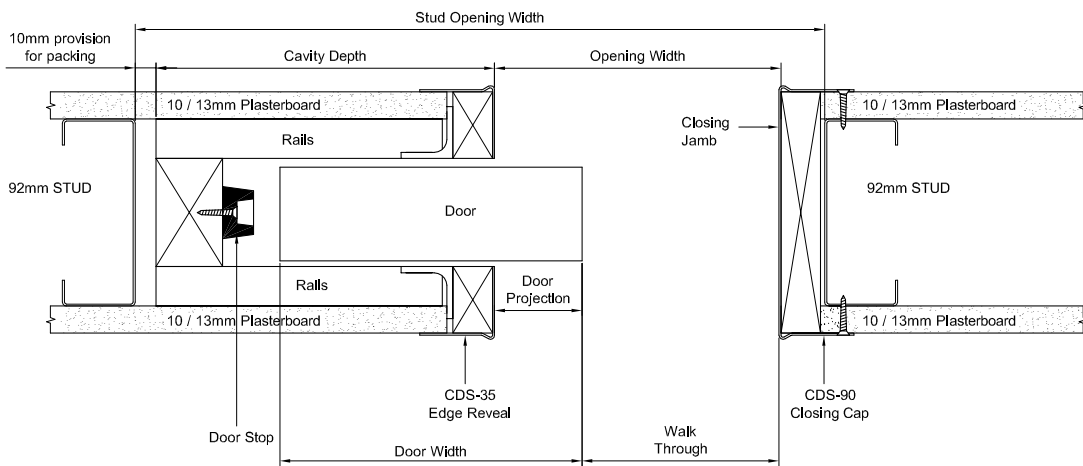

BI-PARTING DOOR

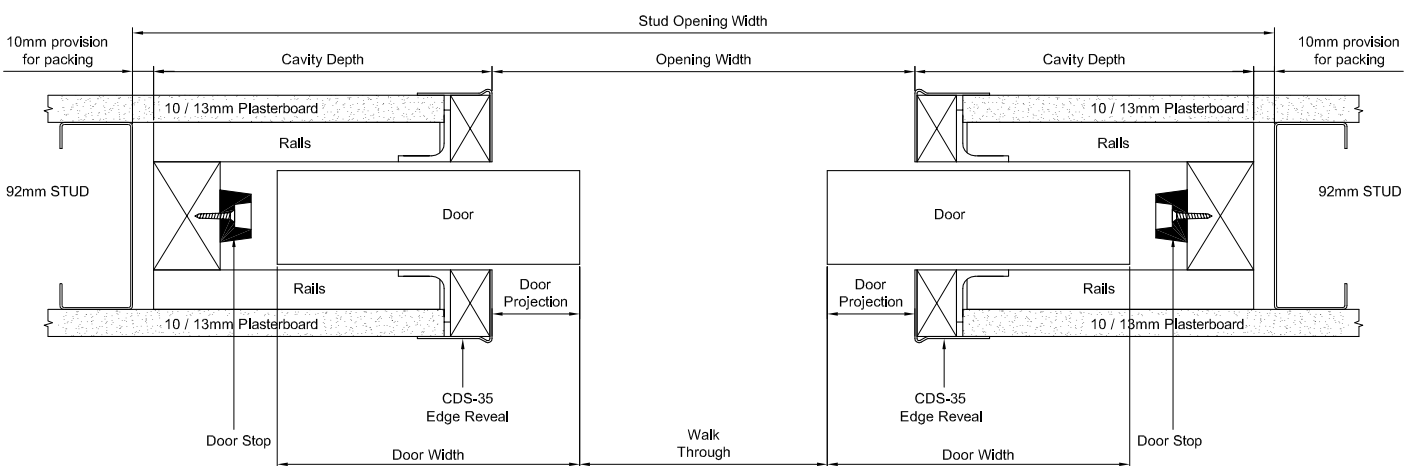

TANARO FORMULAS

SINGLE DOOR

PELMET DETAIL	FORMULA
Door Sizes	Door Height = Walk Through Height
	Door Width = 30mm + Door Projection + Walk Through Width*
Stud Openings	Stud Height = Door Height + 86mm
	Stud Width = (Door Width x 2) - Door Projection + 40mm

FLUSH HEAD DETAIL	FORMULA
Door Sizes	Door Height = Walk Through Height - 30mm
	Door Width = 30mm + Door Projection + Walk Through Width*
Stud Openings	Stud Height = Door Height + 100mm
	Stud Width = (Door Width x 2) - Door Projection + 40mm

*Add 10mm when using Rebated Closing Jamb (771830).

BI-PARTING DOOR

PELMET DETAIL	FORMULA
Door Sizes	Door Height = Walk Through Height
	Door Width = (60mm + (Door Projection x 2) + Walk Through Width) / 2
Stud Openings	Stud Height = Door Height + 86mm
	Stud Width = ((Door Width x 2) - Door Projection + 20mm) x 2

FLUSH HEAD DETAIL	FORMULA
Door Sizes	Door Height = Walk Through Height - 30mm
	Door Width = (60mm + (Door Projection x 2) + Walk Through Width) / 2
Stud Openings	Stud Height = Door Height + 100mm
	Stud Width = ((Door Width x 2) - Door Projection + 20mm) x 2



Formulating character and distinction.

Looking to discover more?

Contact us to book your
free demonstration:

☎ **1300 754 337**

🖱 **www.criterionindustries.com.au**



VIC

23 Scanlon Drive
Epping, VIC, 3076
T: 03 9355 0700

sales@criterionindustries.com.au

NSW

95 Victoria Street
Smithfield, NSW, 2164
T: 02 9355 0700

sales.nsw@criterionindustries.com.au

WA

58 Tacoma Circuit
Canning Vale WA 6155
T: 08 9355 0700

sales.wa@criterionindustries.com.au

QLD

22 Holt Street
Eagle Farm QLD 4009
T: 07 3193 8990

sales.qld@criterionindustries.com.au