

Caspian Cavity System

Formulating
character and
distinction.

www.criterionindustries.com.au





Caspian Cavity

Introducing The Caspian by Criterion Industries – an innovative cavity sliding system that redefines the art of interior design. Meticulously crafted with style in mind, the Caspian sets a new standard for contemporary, versatile space-saving solutions.

Elevate your interior spaces with The Caspian Cavity Sliding System, experience unmatched versatility, refinement, and performance, transforming your living or working spaces into a retreat of modern elegance. Discover a new dimension of design possibilities with The Caspian – where form meets function in perfect harmony.

WHY CHOOSE CASPIAN?

- + Suits doors up to 40mm thick.
- + Oversized doors up to 3000mm x 2400mm.
- + Door weight capacity up to 180kg.
- + Soft close and low clearance options available.
- + Squareset options with either bulkhead or full height flush finish.

ROLLER OPTIONS

- + Standard Roller - 180kg
- + Low Clearance Roller - 180kg
- + Soft Close Standard Roller - 40kg or 80kg or 120kg
- + Soft Close Low Clearance Roller - 40kg or 80kg or 120kg

OPTIONAL EXTRAS

- Edge-Reveal:** + 35mm Reveal Angle 3000mm
- Rebated Closing Cap:** + 118mm Rebated Closing Cap 3000mm
13mm Plaster / 92mm Stud / 13mm Plaster
- Steel Closing Cap:** + 112mm Closing Cap 3000mm
10mm Plaster / 92mm Stud / 10mm Plaster
- + 118mm Closing Cap 3000mm
13mm Plaster / 92mm Stud / 13mm Plaster



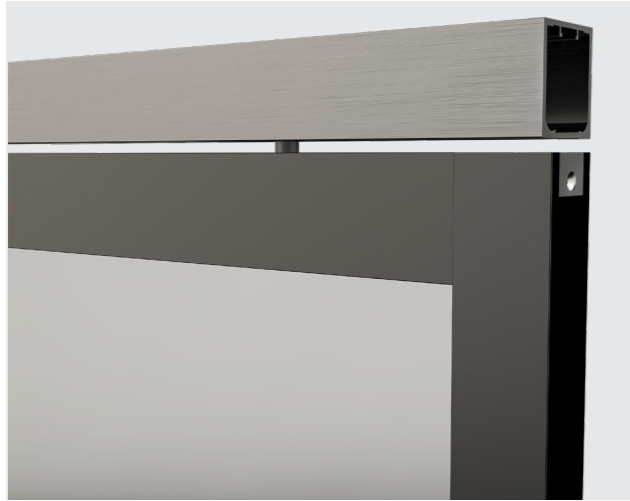

Low Clearance

The low clearance roller allows a tiny 4mm clearance between the top of the door and the sliding track.

Soft Close

The soft-close roller mechanism offers gentle door close and release.



Flush Head Detail

Designed to deliver a flush finish between the track and the ceiling, the flush head detail creates a smooth continuous flow from room to room.

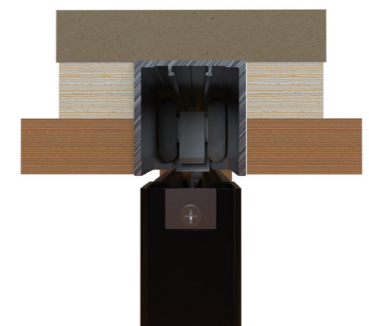

Bulk Head Detail

A square set finish around the sliding track where the door opening is lower than the ceiling height, providing a seamless and minimalistic finish.

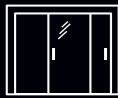

CASPIAN ELEVATIONS - TIMBER DOORS

PELMET DETAIL

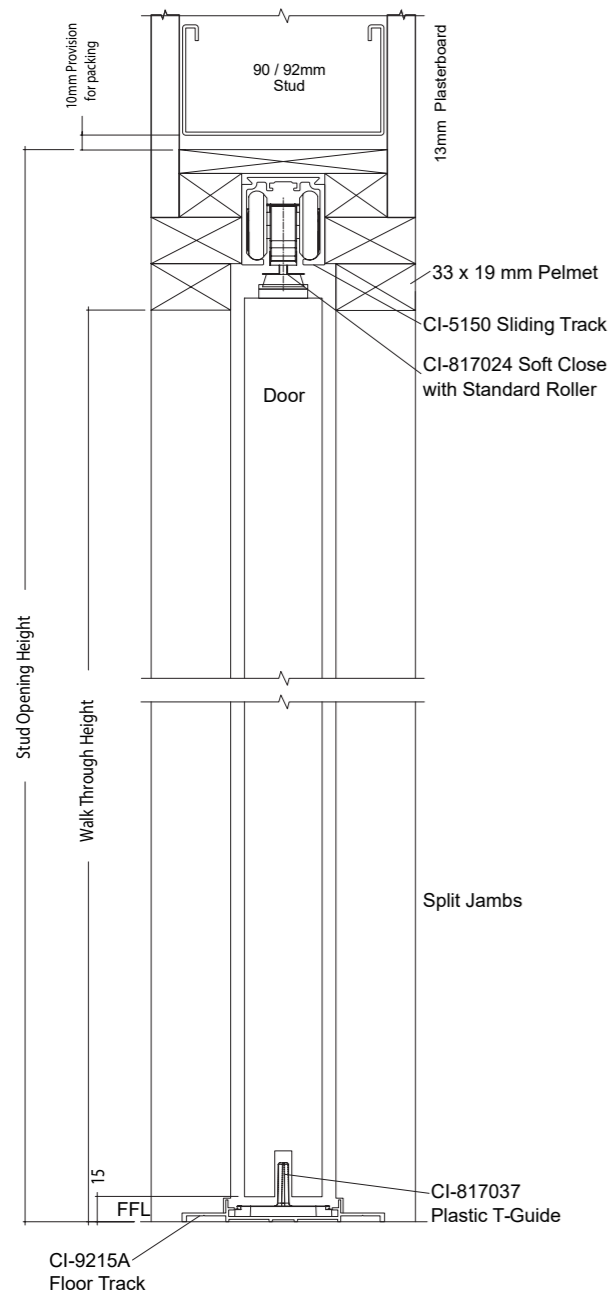

BULKHEAD DETAIL

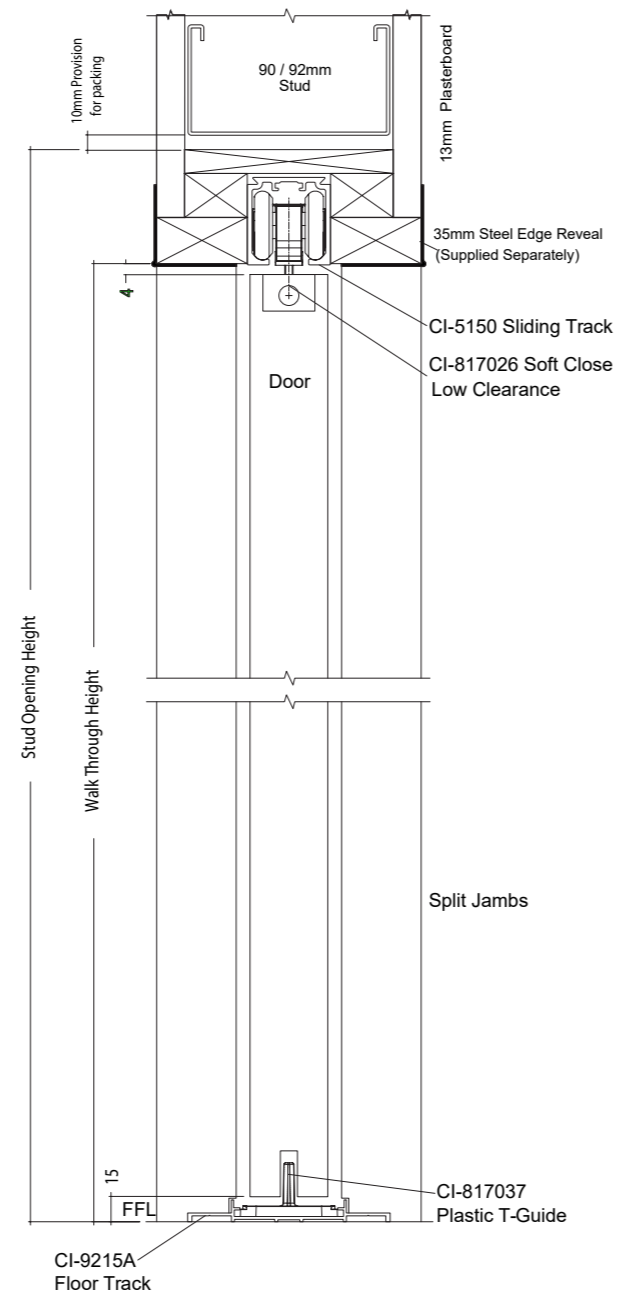

FLUSH HEAD DETAIL - 10MM PLASTER

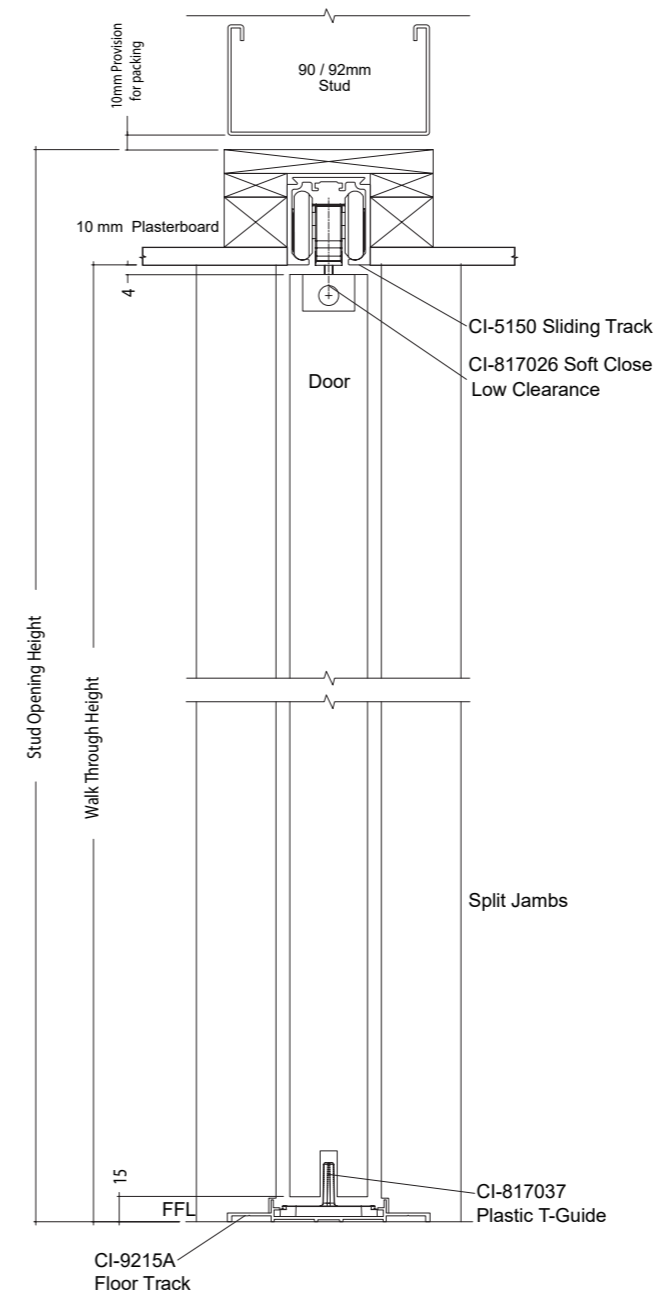

FLUSH HEAD DETAIL - 13MM PLASTER

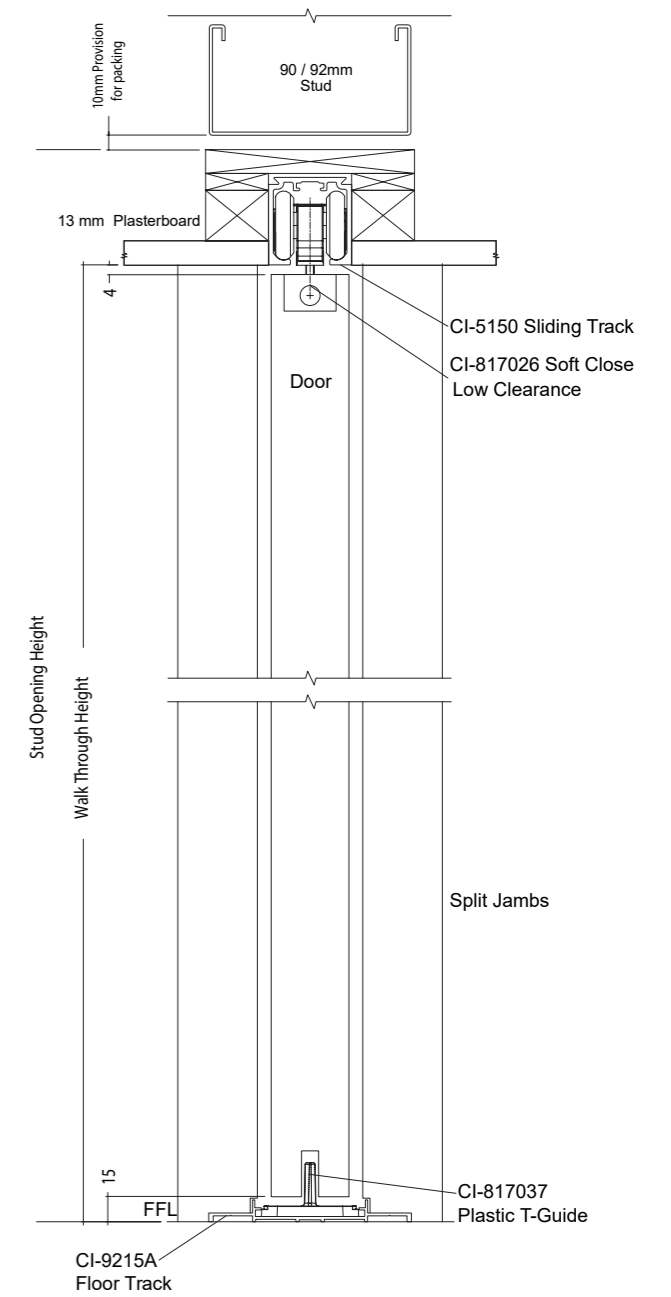

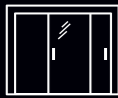

CASPIAN ELEVATIONS - ALUMINIUM DOORS

PELMET DETAIL

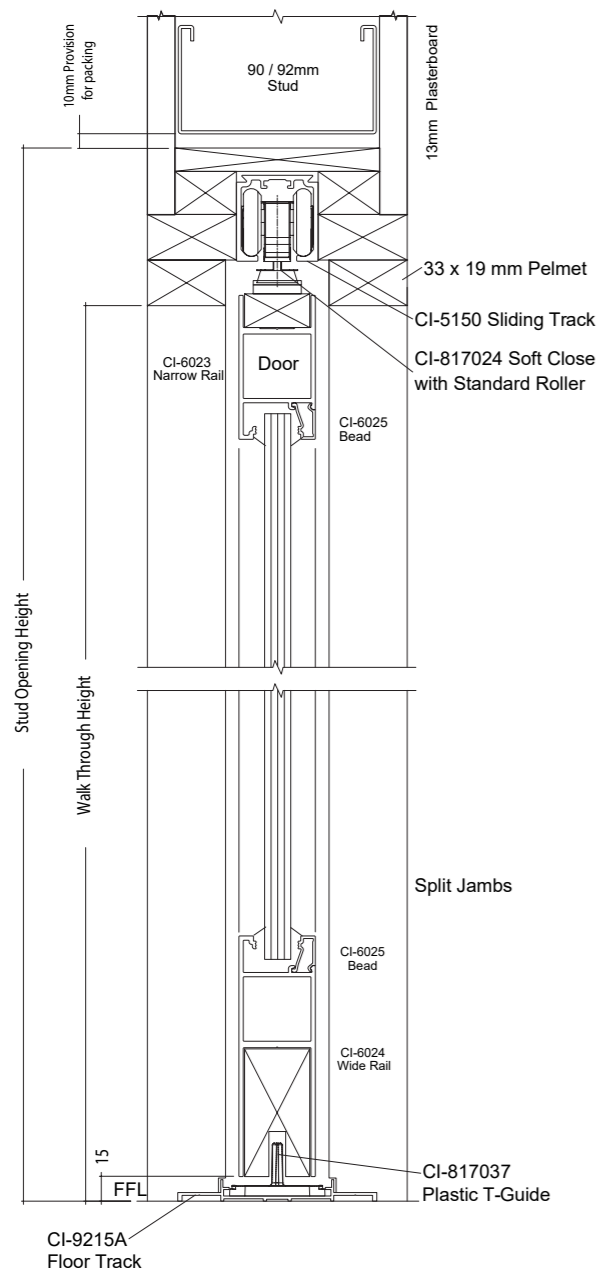

BULKHEAD DETAIL

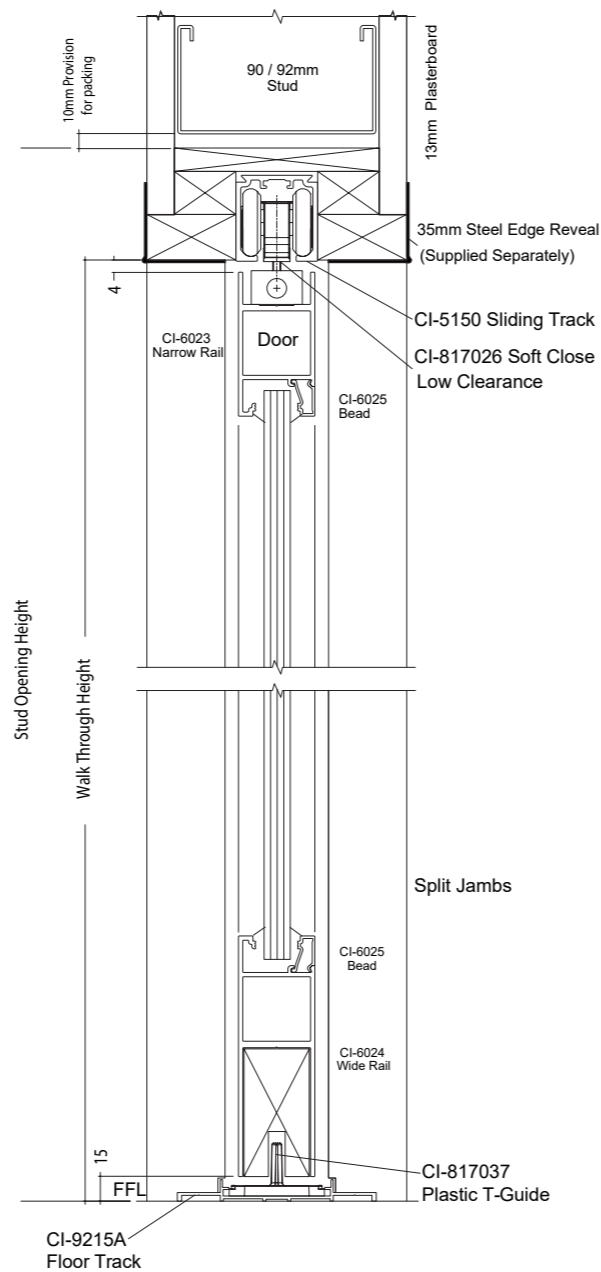

FLUSH HEAD DETAIL - 10MM PLASTER

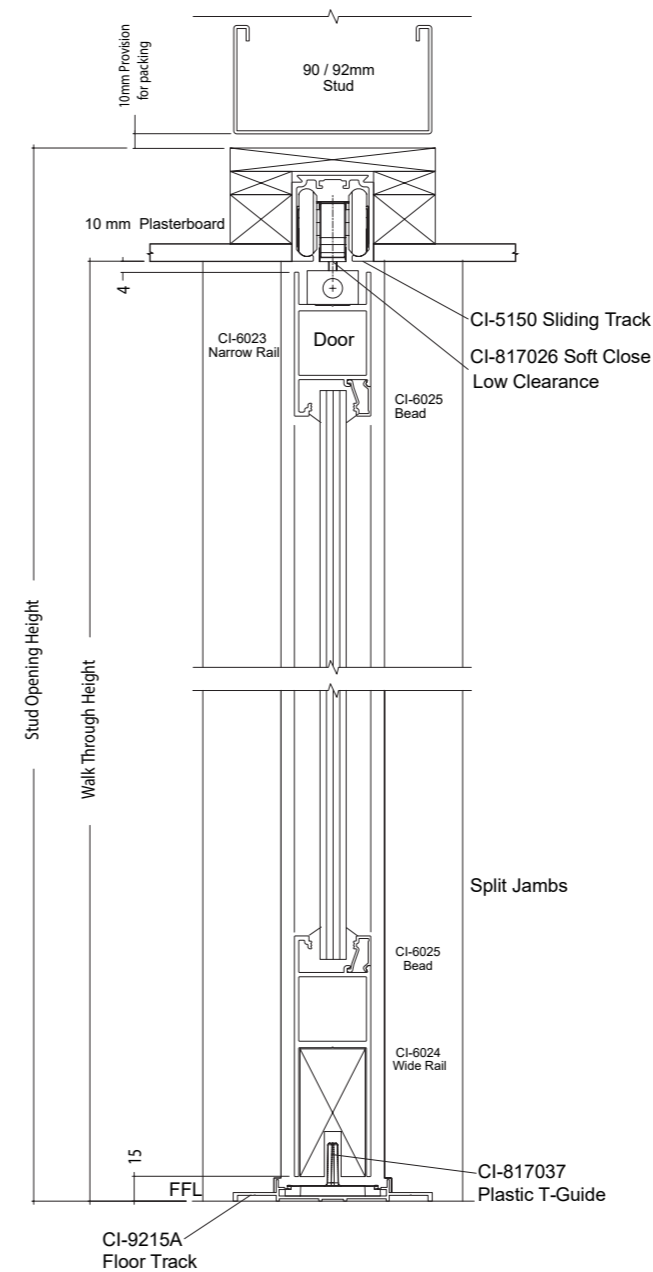

FLUSH HEAD DETAIL - 13MM PLASTER

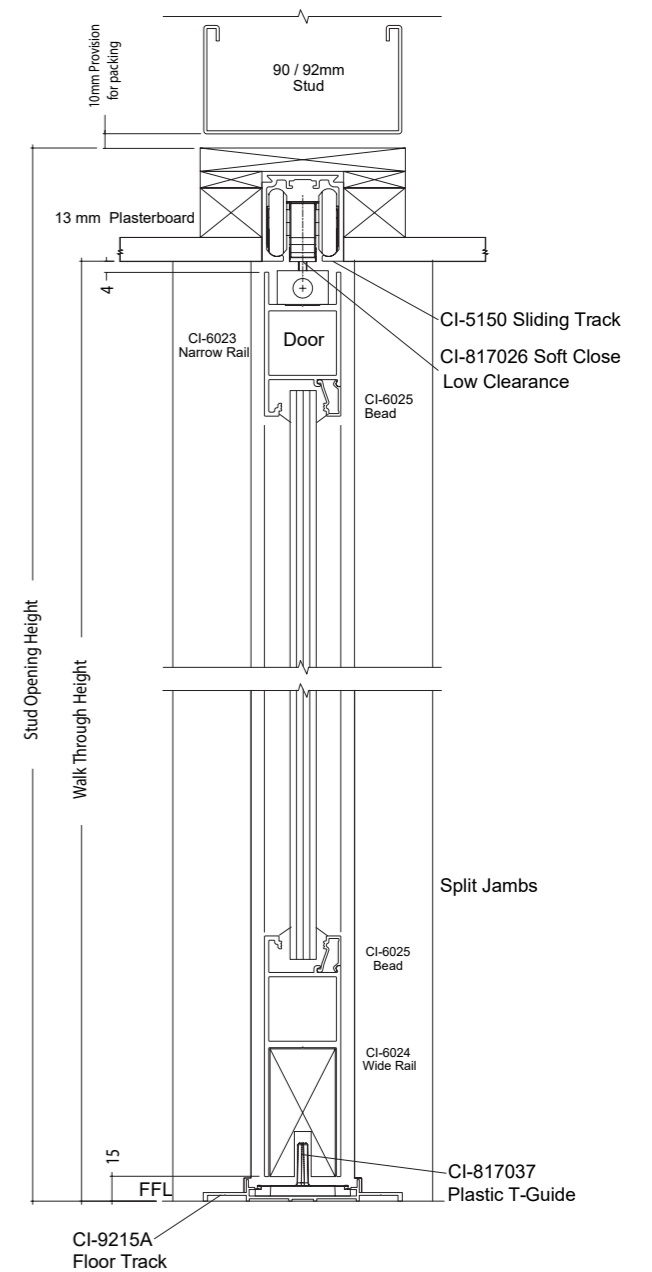

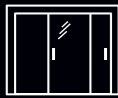

CASPIAN PLAN VIEWS

BIPARTING DOOR WITH TIMBER ARCHITRAVES

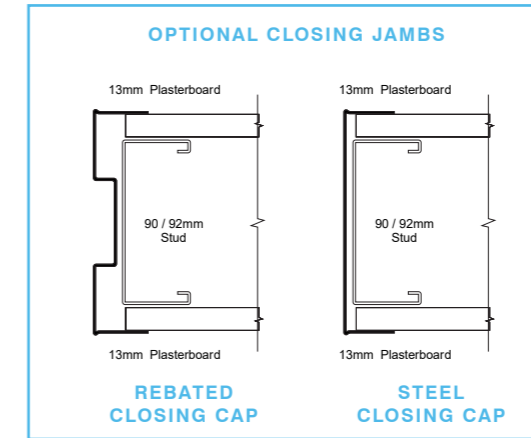
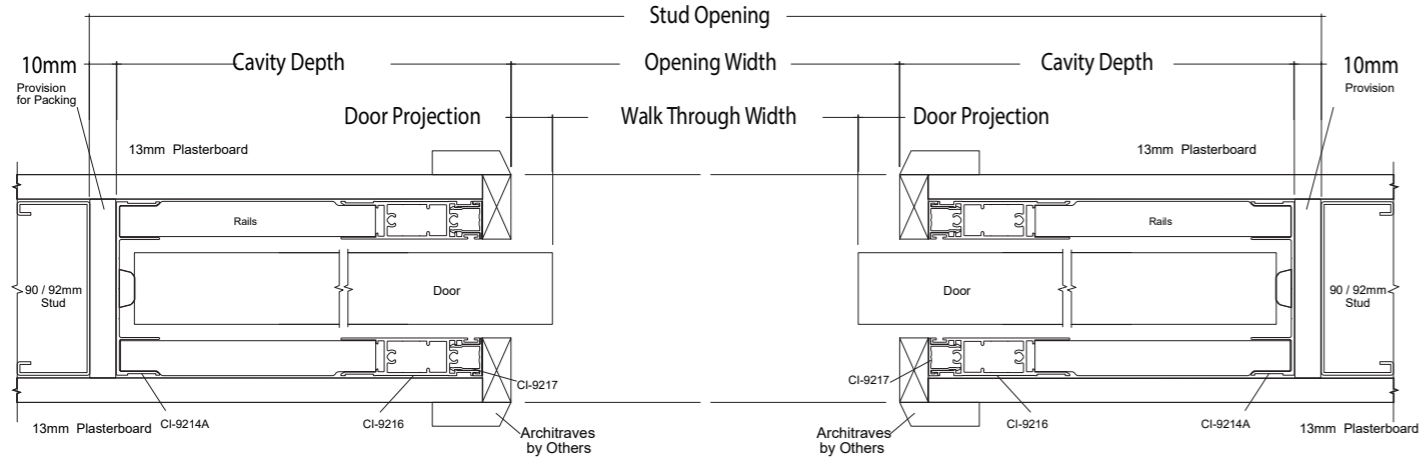

* Timber is optional

BI-PARTING DOOR WITH STEEL EDGE REVEALS

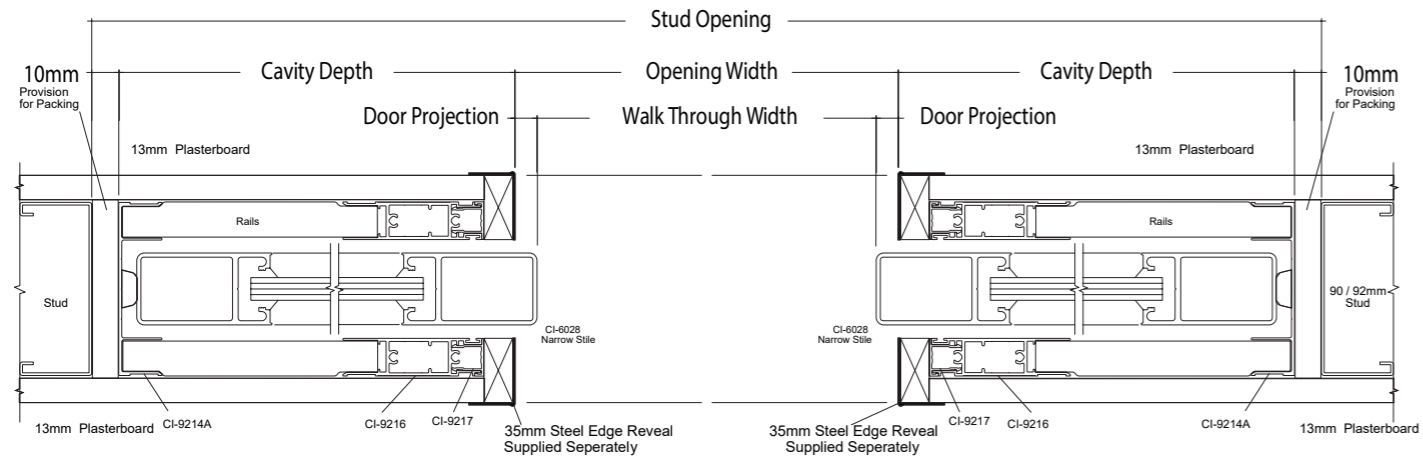

SINGLE DOOR WITH STEEL EDGE REVEALS

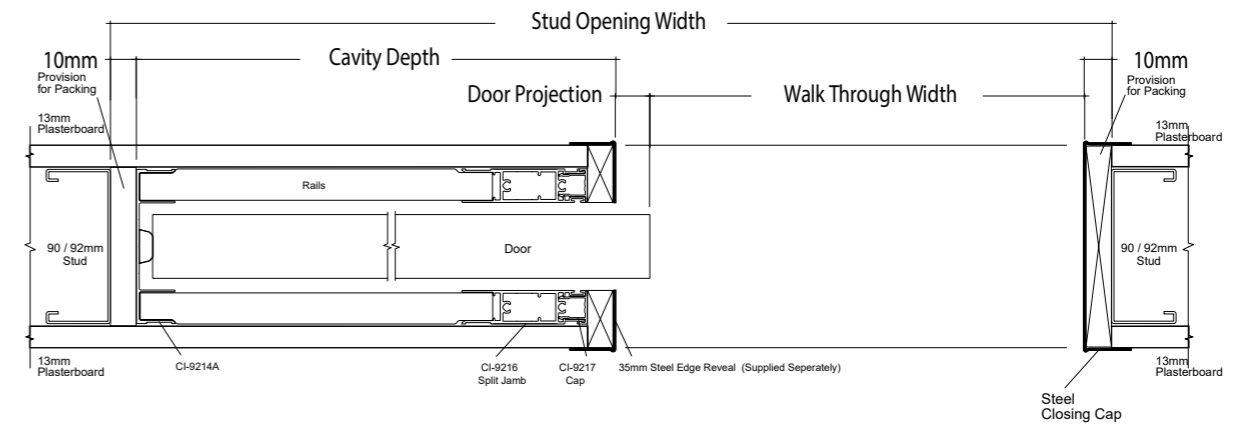

SINGLE DOOR WITH TILE

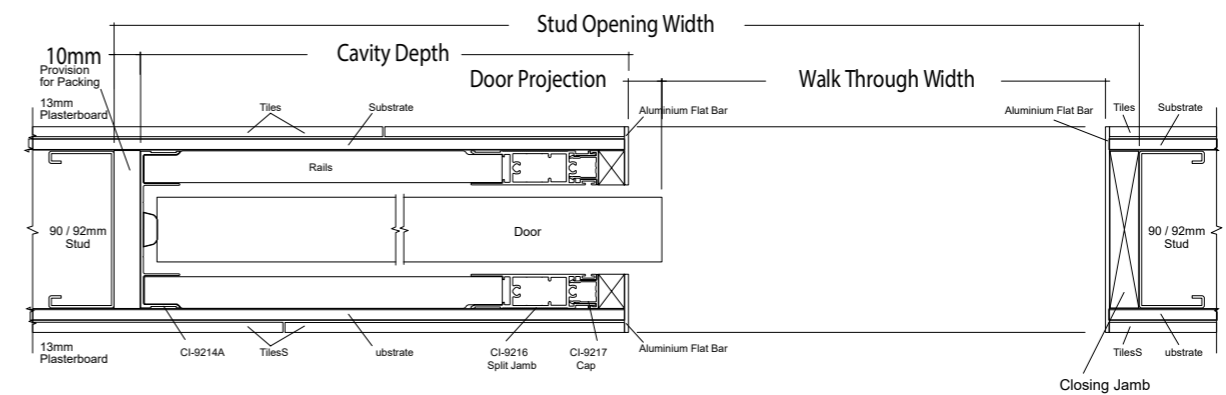

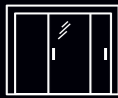

CASPIAN PLAN VIEWS

SINGLE DOOR WITH TIMBER ARCHITRAVES

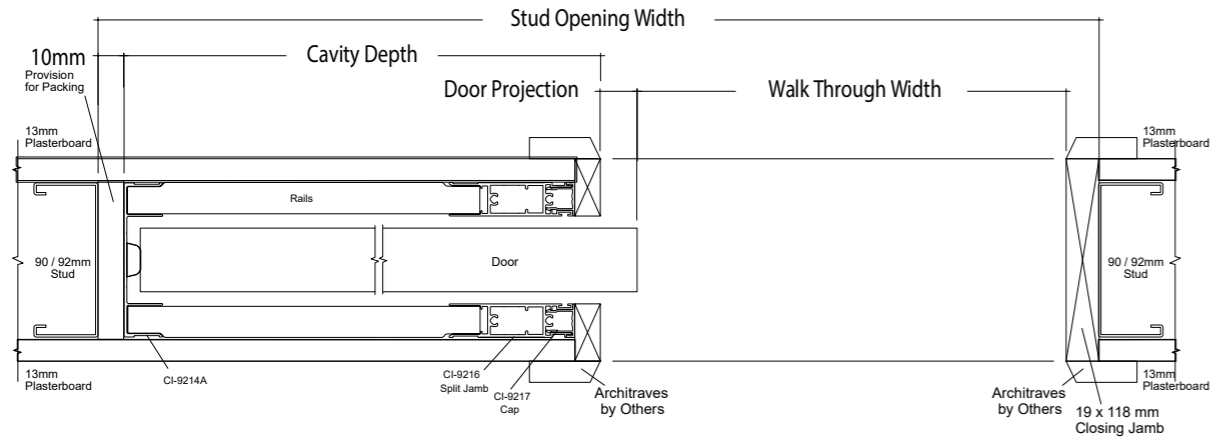

ALUMINIUM DOOR WITH STEEL EDGE REVEALS

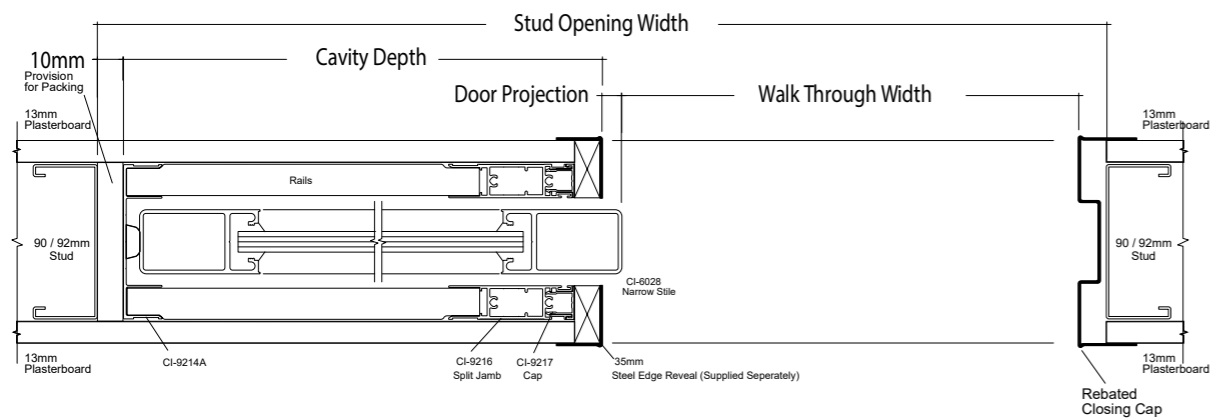

CASPIAN FORMULAS

SINGLE DOOR

PELMET DETAIL	FORMULA
Door Sizes	Door Height = Walk Through Height - 10mm
	Door Width = 30mm + Door Projection + Walk Through Width*
Stud Openings	Stud Height = Door Height + 97mm
	Stud Width = (Door Width x 2) - Door Projection + 30mm
BULKHEAD DETAIL	FORMULA
Door Sizes	Door Height = Walk Through - 19mm
	Door Width = 30mm + Door Projection + Walk Through Width*
Stud Openings	Stud Height = Door Height + 87mm
	Stud Width = (Door Width x 2) - Door Projection + 30mm
FLUSH HEAD DETAIL	FORMULA
Door Sizes	Door Height = Walk Through Height - 19mm
	Door Width = 30mm + Door Projection + Walk Through Width*
Stud Openings	Stud Height = Door Height + 87mm
	Stud Width = (Door Width x 2) - Door Projection + 30mm

* Add 10mm when using Rebated Closing Jamb (771830).

BI-PARTING DOOR

PELMET DETAIL	FORMULA
Door Sizes	Door Height = Walk Through Height - 10mm
	Door Width = (60mm + (Door Projection x 2) + Walk Through Width) / 2
Stud Openings	Stud Height = Door Height + 97mm
	Stud Width = ((Door Width x 2) - Door Projection + 30mm) x 2
BULKHEAD DETAIL	FORMULA
Door Sizes	Door Height = Walk Through - 19mm
	Door Width = (60mm + (Door Projection x 2) + Walk Through Width) / 2
Stud Openings	Stud Height = Door Height + 87mm
	Stud Width = ((Door Width x 2) - Door Projection + 30mm) x 2
FLUSH HEAD DETAIL	FORMULA
Door Sizes	Door Height = Walk Through Height - 19mm
	Door Width = (60mm + (Door Projection x 2) + Walk Through Width) / 2
Stud Openings	Stud Height = Door Height + 87mm
	Stud Width = ((Door Width x 2) - Door Projection + 30mm) x 2



Formulating character and distinction.

Looking to discover more?

Contact us to book your
free demonstration:

www.criterionindustries.com.au



VIC

23 Scanlon Drive
Epping, VIC, 3076
T: 03 9355 0700

sales@criterionindustries.com.au

NSW

29 Killo Crescent
Glendenning, NSW, 2761
T: 02 9355 0700

sales.nsw@criterionindustries.com.au

WA

58 Tacoma Circuit
Canning Vale WA 6155
T: 08 9355 0700

sales.wa@criterionindustries.com.au

QLD

22 Holt Street
Eagle Farm QLD 4009
T: 07 3193 8990

sales.qld@criterionindustries.com.au