

# Acacia Cavity System

Formulating  
character and  
distinction.

 1300 754 337

 [www.criterionindustries.com.au](http://www.criterionindustries.com.au)

 **Criterion**





# Acacia

Acacia is a quality timber and aluminium cavity door unit system offering both style and value within residential and commercial spaces.

Ideally suited for doors that are smaller and of lighter weight, the wheel carriage facilitates a smooth slide action and incorporates a quick-release hanger system.

Acacia cavity tracks can hold a load capacity of up to 80kg. This offer is made-to-order and is available in a single or bi-parting double unit with a maximum door thickness of 44mm.

Acacia is a reliable, high performance cavity door unit system that provides a quality cost-effective solution for any setting.

## Why Choose Acacia?

- + Quick release roller campaigns
- + Door thickness 32mm – 44mm
- + Weight capacity up to 80kg





Acacia Cavity

ACACIA CAVITY - COMMERCIAL

# ACACIA ELEVATIONS

## PELMET DETAIL

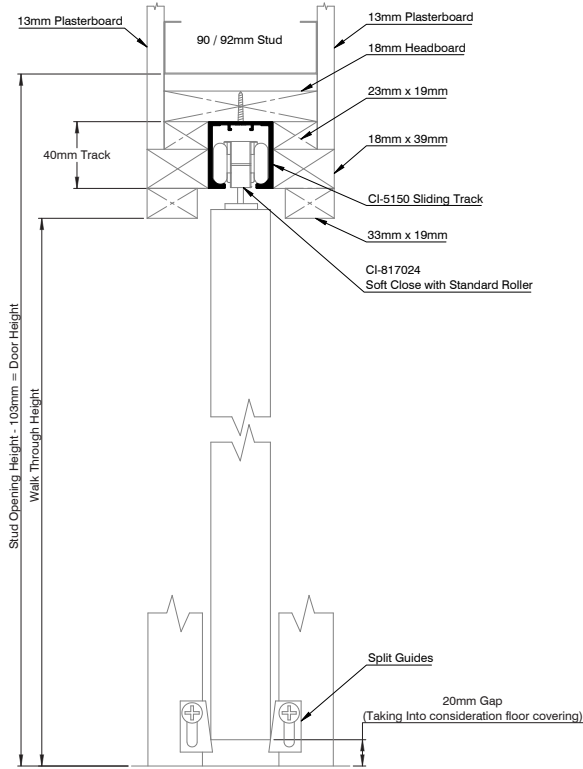

## FLUSH HEAD DETAIL

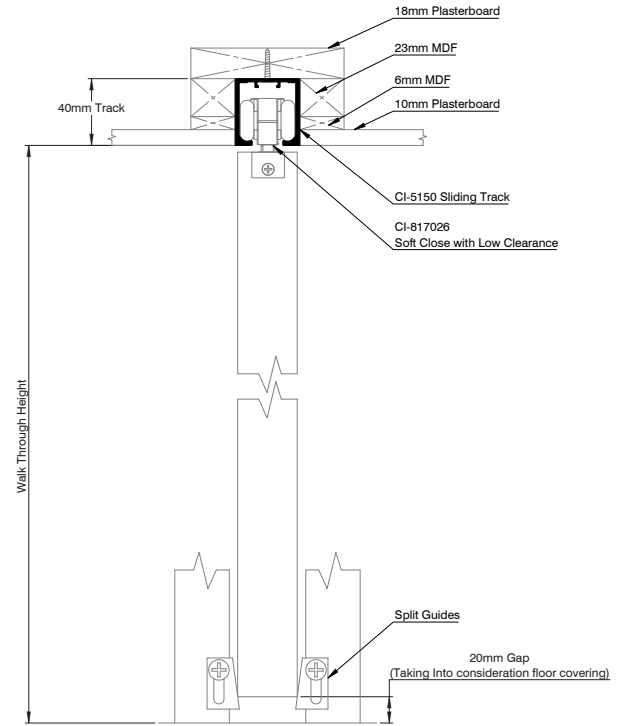

## BULK HEAD DETAIL

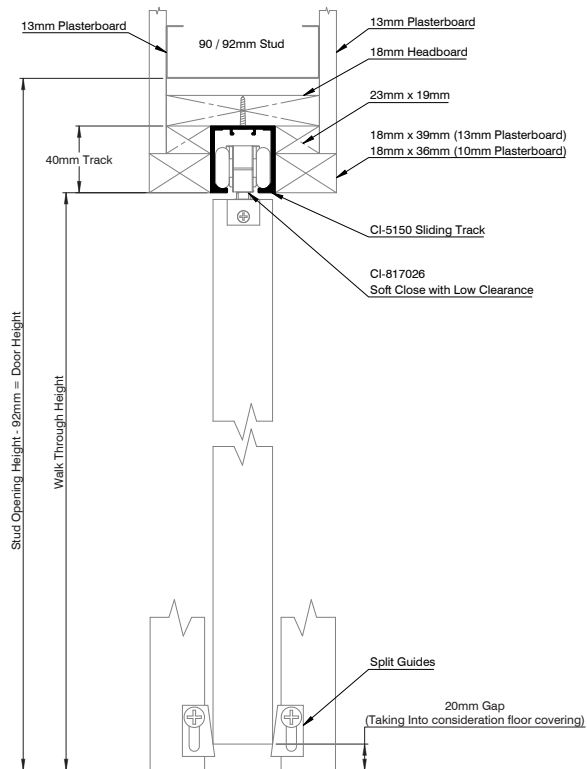

# ACACIA PLAN VIEWS

## SINGLE DOOR

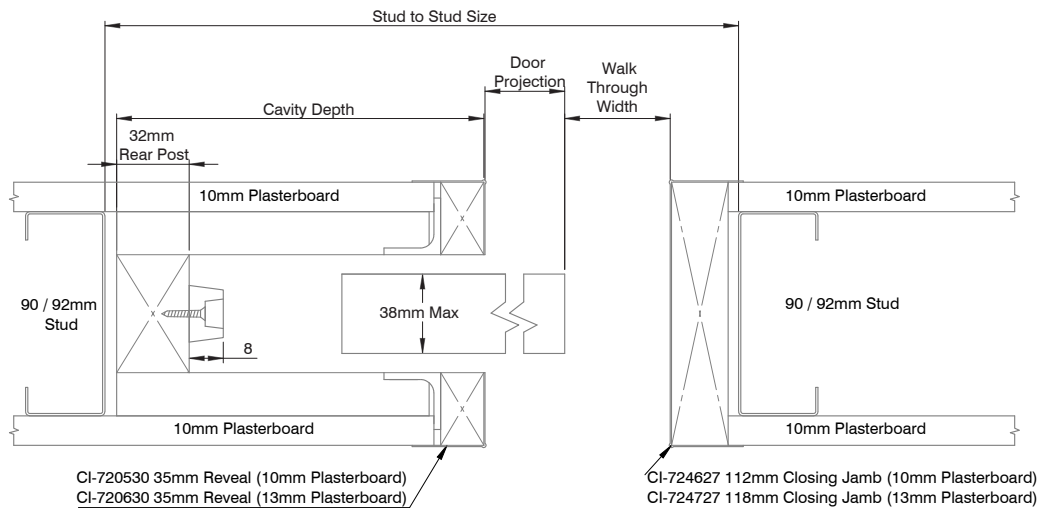

\*Optional  
 CI-771825 112mm Rebated Closing Cap (10mm Plasterboard)  
 CI-771827 118mm Rebated Closing Cap (13mm Plasterboard)

## BI-PARTING DOOR

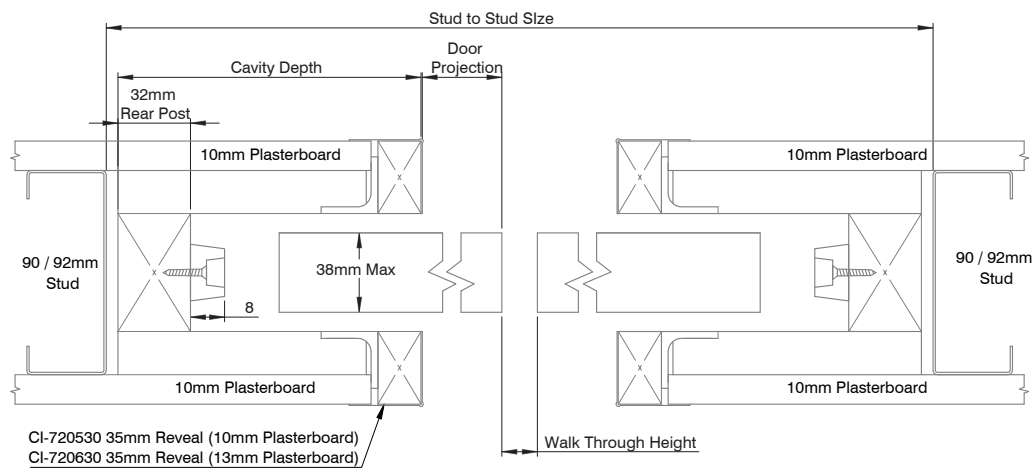

# ACACIA FORMULAS

---

---

## FORMULA

---

<b>Height (Flush Head Detail)</b>	Door Height = Walk Through Opening Height - 24mm Overall Opening Height = Door Height + 92mm
<b>Height (Pelmet/Bulk Head Detail)</b>	Door Height = Walk Through Opening Height - 16mm Door Height = Overall Opening Height + 103mm
<b>Width (Flush Head &amp; Pelmet Detail)</b>	Door Width = Opening Width + 30mm Stud Opening Width = (Door Width x 2) - Door Projection + 40mm
<b>Nil Door Projection</b>	Stud Opening Width = Door Width x 2 + 40mm
<b>40mm Door Projection</b>	Stud Opening Width = Door Width x 2
<b>100mm Door Projection</b>	Stud Opening Width = Door Width x 2 - 60mm
<b>155mm Door Projection</b>	Stud Opening Width = Door Width x 2 - 115mm

---

## DOOR ROLLERS

DESCRIPTION	UNIT	CODE
Arctic Standard Roller Pack with quick fix plates (Incl. Rollers, Track stops, Spanner and screws)	Each	817020
Arctic Low Clearance Roller Pack (Incl. Rollers, Track stops, Spanner and screws)	Each	817022
Arctic 80kg Soft Close Standard Plate, Roller Pack (Incl. Rollers, Track stops, Spanner and screws)	Each	817024
Arctic 40kg Soft Close Standard Plate, Roller Pack (Incl. Rollers, Track stops, Spanner and screws)	Each	817025
Arctic 80kg Soft Close Low Clearance, Roller Pack (Incl. Rollers, Track stops, Spanner and screws)	Each	817026
Arctic 40kg Soft Close Low Clearance, Roller Pack (Incl. Rollers, Track stops, Spanner and screws)	Each	817027

## DOOR GUIDES

DESCRIPTION	UNIT	CODE
Plastic T-Guide	Each	817035
CDS-0464 Door Roller Guide (Floor Mounted)	Each	817022



# Formulating character and distinction.

Looking to discover more?

Contact us to book your  
free demonstration:

 **1300 754 337**

 **[www.criterionindustries.com.au](http://www.criterionindustries.com.au)**



## **VIC**

23 Scanlon Drive  
Epping, VIC, 3076  
T: 03 9355 0700

[sales@criterionindustries.com.au](mailto:sales@criterionindustries.com.au)

## **NSW**

95 Victoria Street  
Smithfield, NSW, 2164  
T: 02 9355 0700

[sales.nsw@criterionindustries.com.au](mailto:sales.nsw@criterionindustries.com.au)

## **WA**

58 Tacoma Circuit  
Canning Vale WA 6155  
T: 08 9355 0700

[sales.wa@criterionindustries.com.au](mailto:sales.wa@criterionindustries.com.au)

## **QLD**

22 Holt Street  
Eagle Farm QLD 4009  
T: 07 3193 8990

[sales.qld@criterionindustries.com.au](mailto:sales.qld@criterionindustries.com.au)