

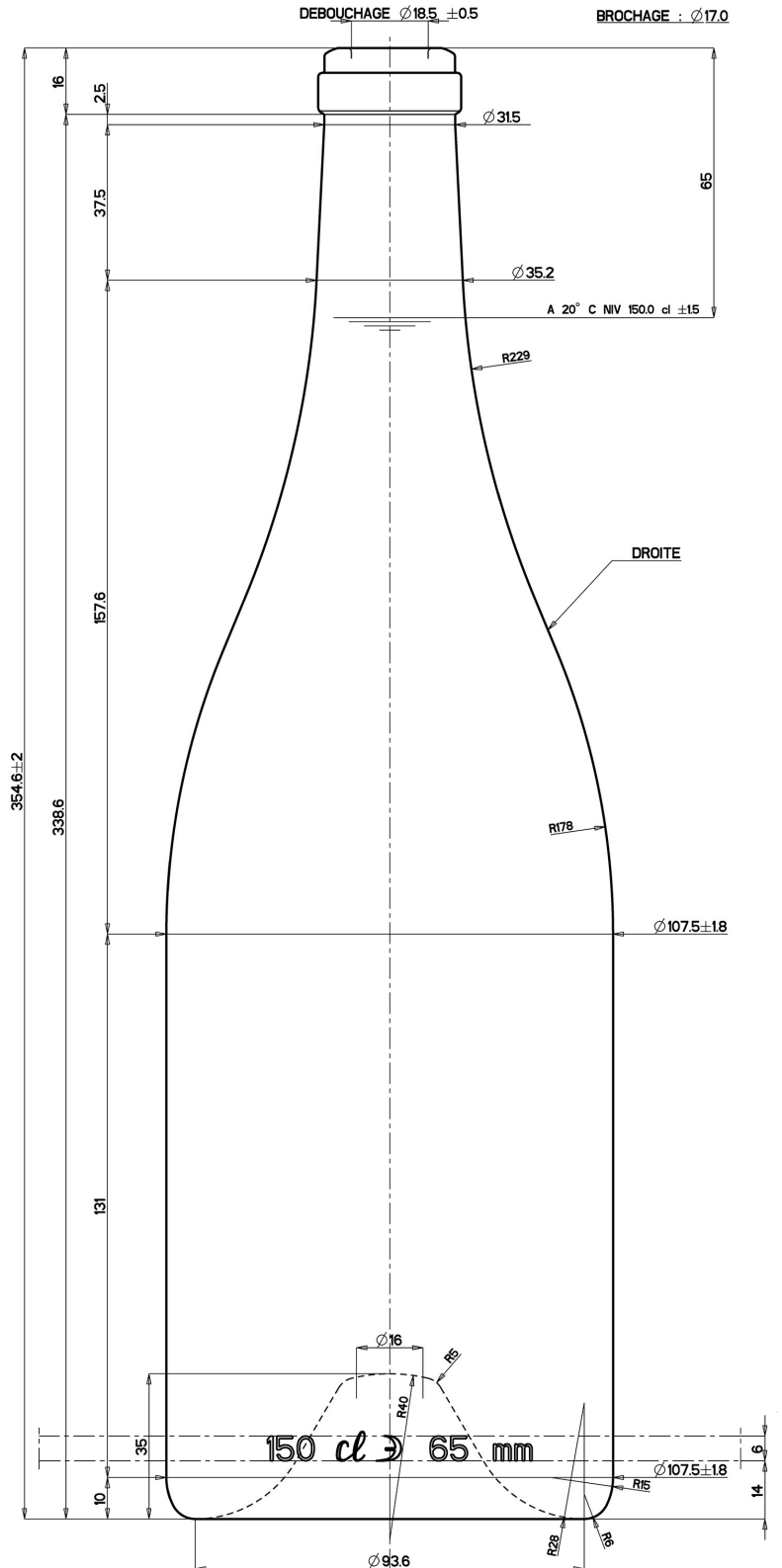

**PIONEER  
PACKAGING**

Seattle • Portland

# MAG BOURGOGNE CARREE AG

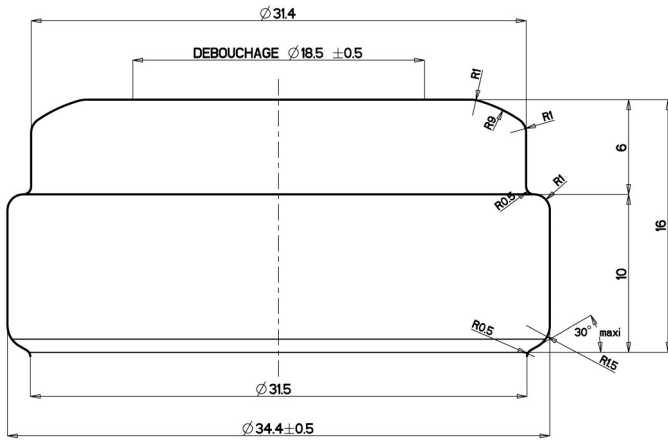

Capacity	1500ml
Overflow	152.2ml
Weight	1130g
Height	354.6 ± 2mm
Body Ø	107.5 ± 1.8mm
Finish Ø	34.4mm
Bore Ø	18.5 ± 0.5mm
Pallet Quantity	60 cases