

For Use On:  
 Permobil Chairman 2k  
 Permobil Chairman 2S  
 Permobil C400  
 Permobil C500

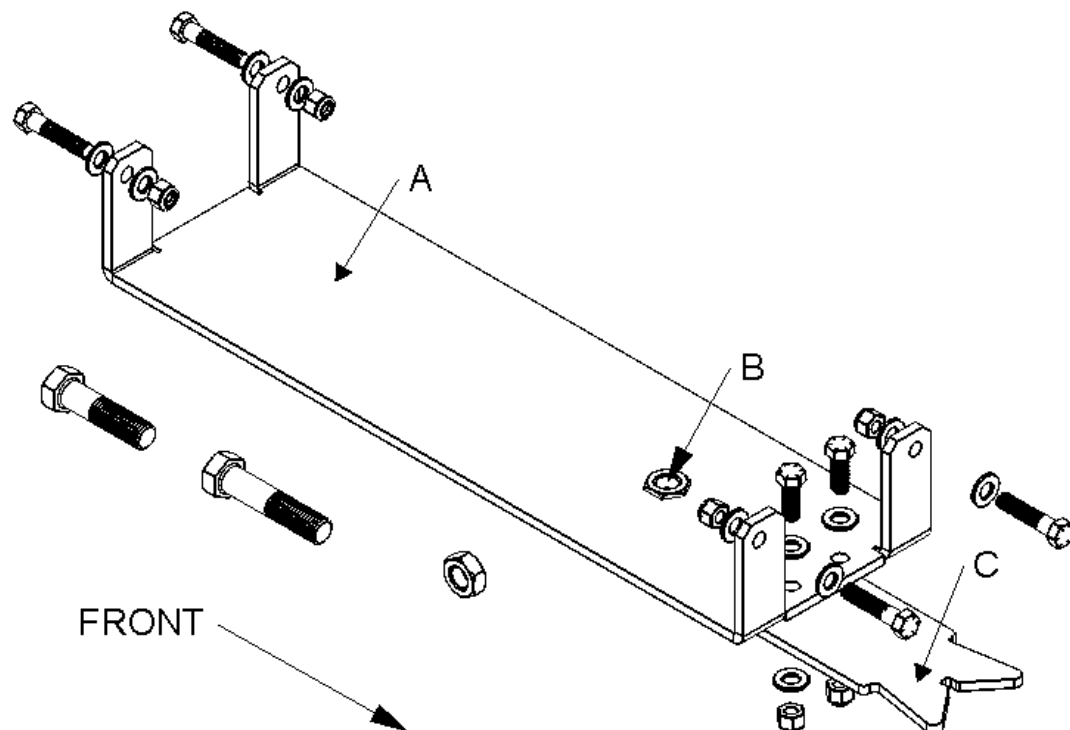

**Position bracket (A) onto frame.** Leave  $\frac{1}{2}$ " of clearance between the top side of the bracket (A) and the bottom side of the wheelchair. The welded nut (B) should be positioned closer to the front, between the front wheels.

**Install bracket onto frame.** With bracket in position, mark the  $\frac{3}{8}$ " holes on the front and rear of wheelchair. In order to drill into the battery tray, it will be necessary to remove batteries according to the manufacturer's instructions. Ensure that no wiring or mechanisms will be damaged prior to drilling. Once drilled, attach bracket using supplied  $\frac{3}{8}$ " hardware.

**Attach stabilizer V-Guide (C) for driving applications.** With  $\frac{5}{8}$ " bolt threaded into welded nut (B), guide wheelchair into QLK-100 base installed on floor. With stabilizer base installed onto floor, determine the appropriate distance for V-Guide and mark holes to be drilled. Once holes have been drilled, attach the V-Guide (C) to the main bracket (A) using the supplied  $\frac{3}{8}$ " hardware.

**Make Final Adjustments.** With user in wheelchair, adjust proper bolt height. For driving applications, measure appropriate height for stabilizer arm and base. Stabilizer base assembly is shown in diagram to the right. Once adjustments are made, fasten docking bolt tightly and use thread-lock. Replace all wheelchair components according to manufacturer's instructions.

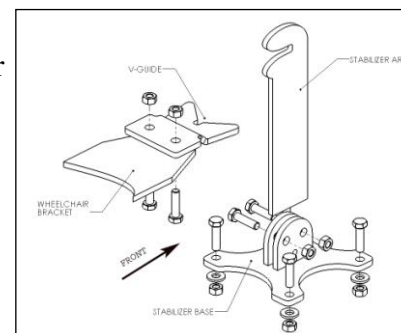

## Hardware Checklist:

- ☐  $\frac{5}{8}$ -11 Hex Jam Nut (Q04C6512-1) x 1
- ☐  $\frac{5}{8}$ -11x3" Grade 8 Bolt (Q04C6509-2) x 1
- ☐  $\frac{5}{8}$ -11x2-1/2" Grade 8 Bolt (Q04C6509-1) x 1
- ↑  $\frac{3}{8}$ "-16x1" Hex Bolt (Q5-6509-BK-1) x 2
- ↑  $\frac{3}{8}$ "-16x1-3/4" Hex Bolt (Q5-6509-BK-9) x 4
- ↑  $\frac{3}{8}$ " Lock Nut (Q5-6512-D) x 6
- ↑  $\frac{3}{8}$ " Flat Washer (Q5-6512-D) x 8



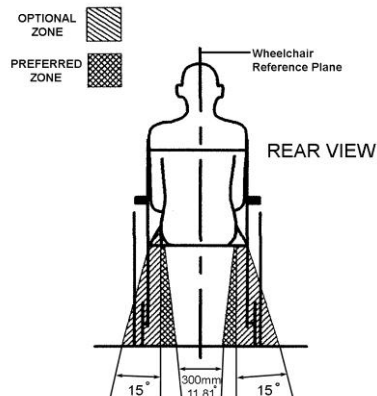
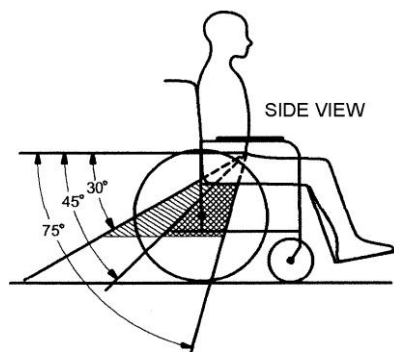
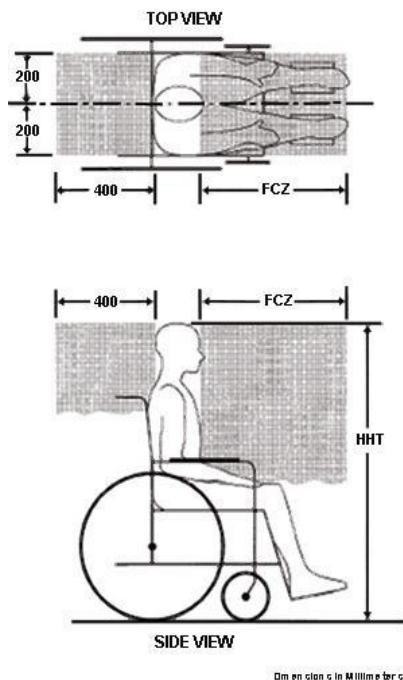

## WARNINGS & GUIDELINES

- Bracket must be installed by authorized dealer.
- Only Q'Straint provided components should be used with this assembly including hardware and wheelchair interface bracket.
- The QLK Bracket is designed and tested to secure the wheelchair base only. Q'Straint does not guarantee the strength or securement of the seating system.
- Do not attempt to repair, adjust, or modify any component(s) of the QLK-100 system or bracket without consulting a Q'Straint representative.
- Clients are required to have the QLK-100 system maintained and inspected at least once annually in accordance with the QLK Preventative Maintenance Checklist.
- All clients in driver's application must not attempt to drive the vehicle without first consulting with a CDRS for proper fit and ability to operate all controls proficiently
- A lap (pelvic) and shoulder belt must always be used. Pelvic restraint anchor points should be positioned to achieve belt angles between 30° and 75°, in order to fit low across the pelvis and reduce possible loading of the abdomen (see diagram). Height of shoulder belt should be at or above shoulder height of user with belt webbing fitting near the midpoint of the occupant's shoulders, so as to minimize downward loads to the spine.
- Belt webbing should be protected from contacting sharp corners and edges, and potential corrosive liquids.
- It is important to locate the wheelchair properly with respect to the anchor points of the upper torso belts to achieve good belt fit geometry.
- Front Clear Zone (FCZ): It is important to establish a clear zone when positioning the wheelchair. This clear zone should be free of any vehicle-mounted component, which may impact with the wheelchair user. Refer to the diagram below. Rigid vehicle components that are inside of the frontal clear zone, and rigid components located behind and within 15-3/4" (400mm) of the occupant should be padded to conform to the impact requirements of FMVSS 201 and ISO 3795.
- Vehicle anchor points may require reinforcement. The mounting surface should conform to or exceed specifications of the manufacturer of the vehicle.
- A vehicle anchored back support should be provided if a head restraint is anchored to the vehicle, in order to minimize rearward deflection of the wheelchair seatback and the potential for neck injury.
- Airbags can cause serious injury if a wheelchair seated occupant sits too close to the airbag module. Contact the appropriate regulatory agency and/or the vehicle manufacturer, as appropriate, for dispensation and advice to disable the airbag.
- After market devices should not be installed in a manner that may block deployment of the airbag.

## Working with the Battery Spacer

The HDPE battery spacer can be cut, drilled, and shaped for a custom and professional installation and will not cause damage to your tools. Final shape for battery spacer should be drawn and cut once the bracket installation is complete and you are ready to replace the batteries.

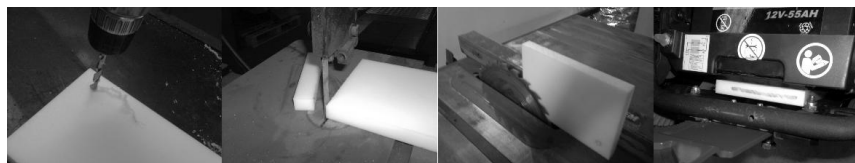

**Q'Straint USA**  
 5553 Ravenswood Road #110  
 Fort Lauderdale, FL 33312  
 (800) 987-9987  
 (954) 986-0021 Fax  
 www.qstraint.com

**Q'Straint Canada**  
 18-100 Sheldon Dr.  
 Cambridge, ON Canada  
 N1R 7S7  
 (800) 987-9987

Q5-1165-075  
 Rev. 01