

The EasyLED Bollards with choice of optics are designed to replace HID lighting systems up to 70w MH or HPS. These fixtures are ideal for retail centers, industrial parks, schools and universities, public transit and airports, office buildings and medical facilities.

## Specifications and Features:

<b>Housing:</b>	Extruded Aluminum Housing with Flush Mounting Base & Vandal-Resistant Screws, Flat Top, Internal Ballast Tray for Easy Maintenance. Bollards Can Be Cut to Custom Lengths Upon Request.
<b>Listing &amp; Ratings:</b>	CSA: Listed for Wet Locations, ANSI/UL 1598, 8750 IP65 Sealed LED Compartment.
<b>Finish:</b>	Textured Powdercoat Finish Over a Chromate Conversion Coating. Custom Colors Available Upon Request.
<b>Style:</b>	Clear Prismatic Borosilicate Glass Refractor, Specially Designed Aluminum Cone Reflector or Internal Louvers
<b>Lens:</b>	Clear Polycarbonate Vandal-Resistant Lens
<b>Mounting Options:</b>	Mounting Kit with 8" Anchor Bolts, Included.
<b>EasyLED LED:</b>	Aluminum Boards
<b>Wattage:</b>	Array: 14.5w, System: 17w; (70w HID Equivalent)
<b>Driver:</b>	Electronic Driver, 120-277V, 50/60Hz or 347V, 50/60Hz; Less Than 20% THD and PF>0.90. Standard Internal Surge Protection 2kV. 0-10V Dimming Standard for a Dimming Range of 100% to 10%; Dimming Source Current is 150 Microamps.
<b>Warranty:</b>	5-Year Warranty for -40°C to +40°C Environment.

See Page 2 for Projected Lumen Maintenance Table.



Glass  
BOFGQ



LED Cone Reflector  
BOFRLQ



Louvers  
BOFLRQ

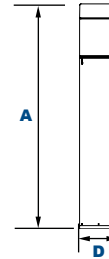

**L70**  
25°C **147,000 Hours**

### Dimensions

**Diameter (D)** 7" (178mm)

**Height (A)** 41 1/8" (1,057mm)

### Certification & Listings:



Model	Optics	1X15 Wattage	Driver	CCT	Color	Height	Options
<b>BOFGQ</b> =Flat Top Bollard with Glass <b>BOFRLQ</b> =Flat Top Bollard with LED Cone Reflector <b>BOFLQ</b> =Flat Top Bollard with Louvers	<b>C</b> =Type III* <b>F</b> =Wide Beam Spread  *BOFRLQ Only	<b>1X15</b> =15w	<b>U</b> =120-277V <b>C</b> =347V	<b>3K</b> =3000K <b>4K</b> =4000K <b>5K</b> =5000K	<b>Z</b> =Bronze <b>B</b> =Black <b>W</b> =White <b>G</b> =Gray <b>C</b> =Custom (Consult Factory)	<b>(Leave Blank)</b> = 42" Standard Height <b>36</b> =36" Height <b>30</b> =30" Height	<b>SF</b> =Single Fuse <b>DF</b> =Double Fuse <b>SP</b> =Surge Protection <b>GF1</b> =GFCI Outlet, 15A, 120V <b>BU</b> =Battery Backup, 90 Minutes

### Order Information Example:

**BOFRLQF1X15U5KZ36SF**

## Accessories & Replacement Parts:

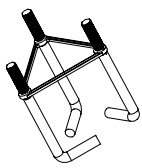

**BOLAN**

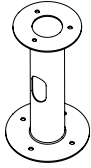

**BOLRM**



**BREBASE\***



**BOLPC**

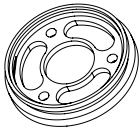

**BORBASE**



**BOADP1**

\*Shown Mounted

### Mounting Accessories (Order Separately, Field Installed)

**BOLAN4** Mounting Kit, Includes Bracket & Three (3) 4" Anchor Bolts

**BOLAN8** Mounting Kit, Includes Bracket & Three (3) 8" Anchor Bolts

**BOLAN12** Mounting Kit, Includes Bracket & Three (3) 12" Anchor Bolts

**BOLAN15** Mounting Kit, Includes Bracket & Three (3) 15" Anchor Bolts

**BOLRM** Root Mount Kit

**BREBASE\*** Bollard Retrofit Base Kit Adapts New Bollards to Most Existing Bolt Patterns. Fits all Bollards. Die Cast with Powdercoat Finish, Hardware Included. 1 1/2" Dia. x 1 1/2" H

\*Specify Color: Z=Bronze, B=Black, W=White, G=Gray, C=Custom (Consult Factory)

### Replacement Parts (Order Separately, Field Installed)

**BOLPC** Replacement Round Polycarbonate Vandal-Resistant Lens

**BORBASE\*** Die Cast Base Plate with Powdercoat Finish over a Chromate Conversion Coating.

**BOADP1\*** Adapter Plate with Gaskets for Outlet Boxes. Fits Round Bollards. Die Cast with Powdercoat Finish.

\*Specify Color: Z=Bronze, B=Black, W=White, G=Gray, C=Custom (Consult Factory)

## Photometric Data

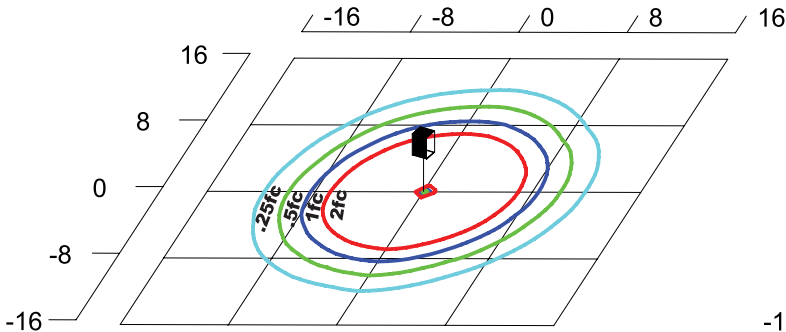

**BOFGQF1X15U5K**

Type V

Grid in feet, Mounting Height = 3.5 ft.

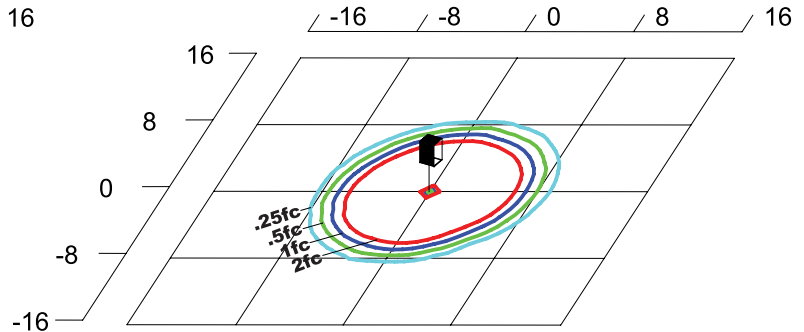

**BOFRLQF1X15U5K**

Type V

Grid in feet, Mounting Height = 3.5 ft.

## Photometric Performance

LED Board Watts	Drive Current (mA)	Input Watts	Optics	5000 CCT 80 CRI					4000 CCT 80 CRI					3000 CCT 80 CRI				
				Lumens	LPW	B	U	G	Lumens	LPW	B	U	G	Lumens	LPW	B	U	G
EasyLED 15w	116	17	BOFG Glass	1,125	66	1	3	1	1,080	64	1	3	1	905	53	1	3	1
			BOFL Round Louvers	778	46	1	2	1	747	44	1	2	1	689	41	1	2	1
			BOFRL Cone Reflector	1,519	89	1	3	1	1,458	86	1	3	1	1,225	72	1	3	1
			BOFRL Type III Optic	1,081	64	0	3	1	989	58	0	2	1	918	54	0	2	1

## Projected Lumen Maintenance

Data shown for 5000 CCT			Compare to MH			
TM-21-11	Input Watts	Initial	25,000 Hrs	50,000 Hrs	100,000 Hrs	Calculated L70@ 25°C
L70 Lumen Maintenance @ 25°C / 77°F	17	1.00	0.95	0.90	0.80	147,000
TM-21-11	Input Watts	Initial	25,000 Hrs	50,000 Hrs	100,000 Hrs	Calculated L70@ 50°C
L70 Lumen Maintenance @ 50°C / 122°F	17	1.00	0.89	0.78	0.55	67,000
TM-21-11	Input Watts	Initial	25,000 Hrs	50,000 Hrs	100,000 Hrs	Calculated L80@ 40°C
L80 Lumen Maintenance @ 40°C / 104°F	17	1.00	0.92	0.85	0.70	66,000

### NOTES:

- Projected per IESNA TM-21-11. Data references the extrapolated performance projections for the 116mA base model in a 25°C ambient, based on 10,000 hours of LED testing per IESNA LM-80-08.
- Compare to MH box indicates suggested Light Loss Factor (LLF) to be used when comparing to Metal Halide (MH) systems.