

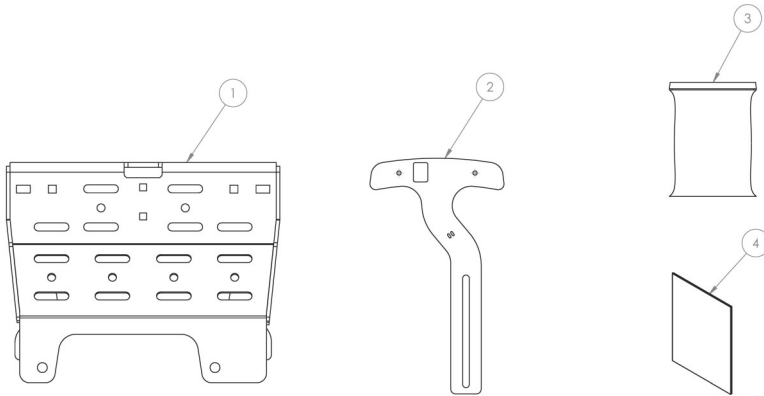

**2021 Ford Bronco**  
**RTR Trail Jack Mount**  
**Part number 14021.0006.14.C**

**Components Included**

- |    |                       |   |
|----|-----------------------|---|
| 1. | RTR Trail Jack Mount  | 1 |
| 2. | Off Set Light Bracket | 1 |
| 3. | Hardware Pack         | 1 |
| 4. | Instructions          | 1 |



The RTR Trail Jack Mount is intended to be installed onto a vehicle that is already fitted with the RTR Tire carrier. RTR recommends using the Hi-Lift® XT485 48" Hi-Lift® X-TREME Jack, the Hi-Lift® HL484, or equivalent. RTR also recommends using Hi-Lift® HK-B Black Handle-Keeper. RTR advises the use of Loctite® Threadlocker Blue 242, or equivalent, on all threaded fasteners during assembly, unless otherwise instructed.



1. With the vehicle parked on a level surface remove the spare tire and set it aside.



2. Open the tailgate to gain access to the third brake light bracket wiring and hardware. Cut the cable tie securing the harness and disconnect the brake light.

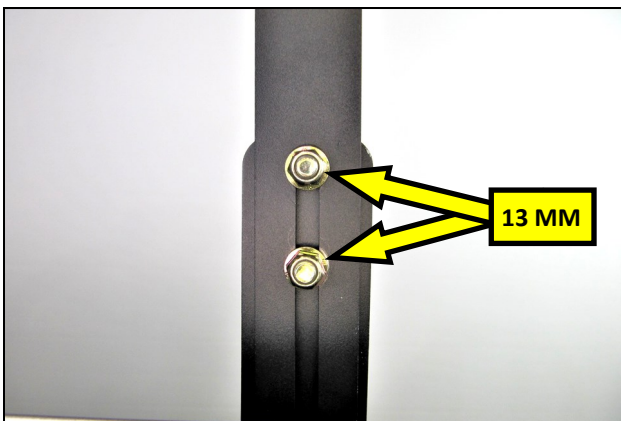

3. Remove the lock nuts securing the upper light bracket to the lower bracket. Remove the upper bracket, light and hardware and set them aside.

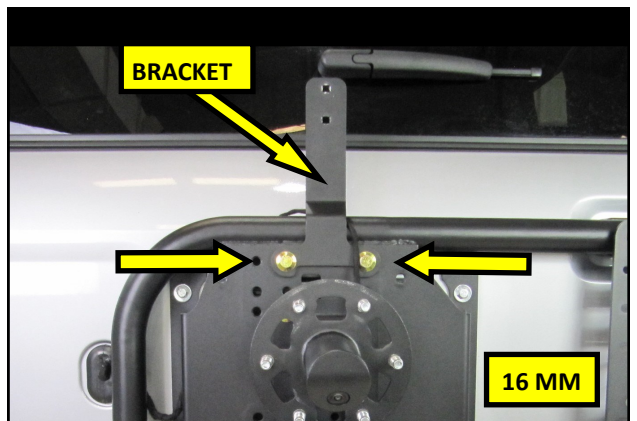

4. Remove the two flange bolts securing the lower bracket to the tire carrier and remove the bracket.

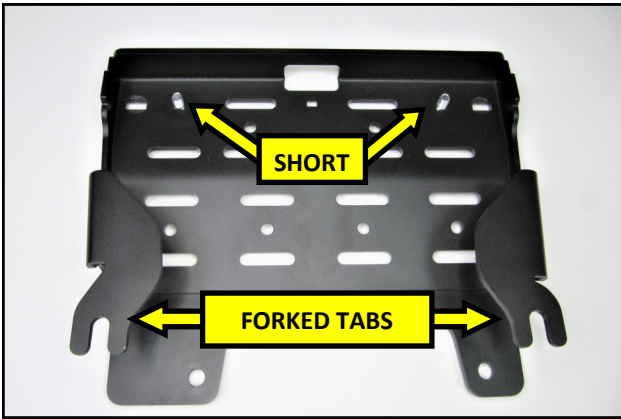

5. Insert the 3/4" (Short) Carriage Bolts into the Mount as shown, face down, with the forked tabs facing up .

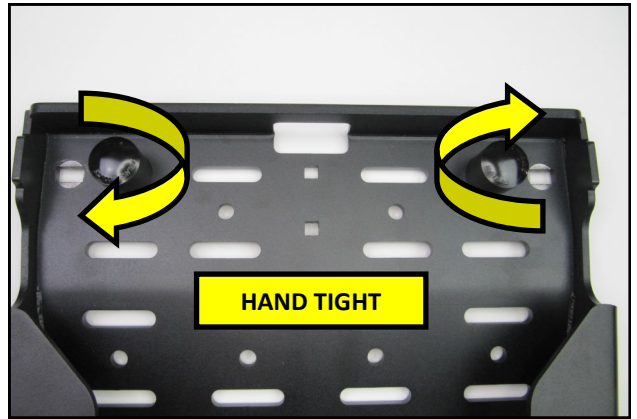

6. Thread the Bumpers onto the Carriage Bolts, hand tight.

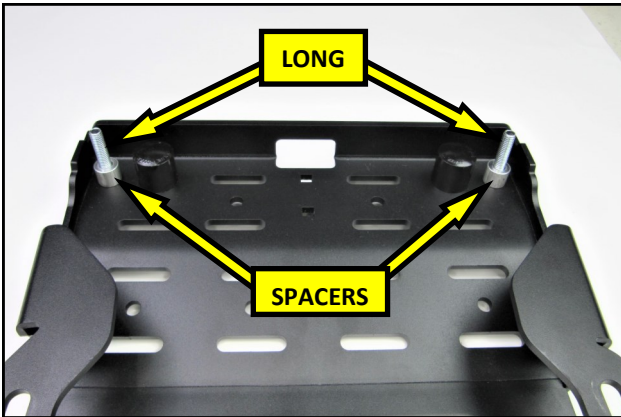

7. Insert the 2 1/2" (Long) Carriage Bolts into the Mount as shown. Slide the Spacers onto the Bolts.

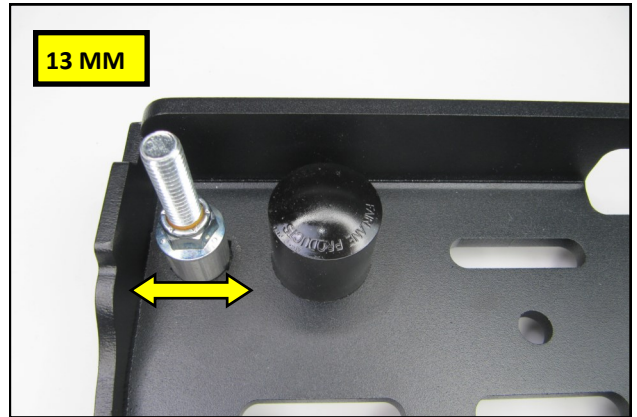

8. Thread the Lock Nuts onto the Long Bolts and Spacers. Leave the Nut snug at this time to allow for side to side movement.

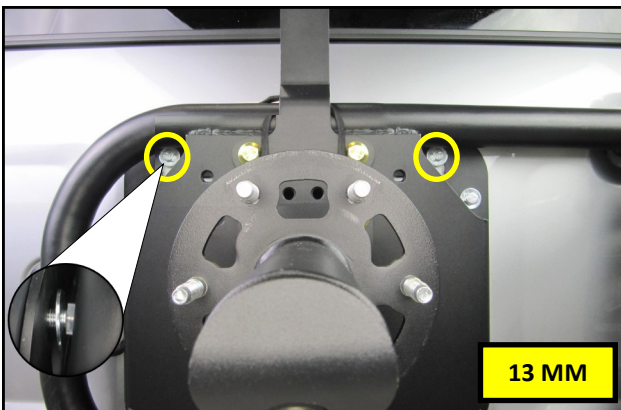

9. Loosen the two top tire carrier bolts approximately 1/4 inch.

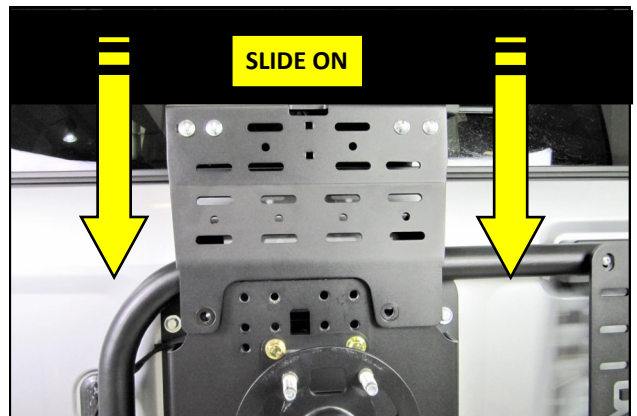

10. Slide the Mount onto the tire carrier as shown, with the forked tabs onto the loosened bolts from step 9.

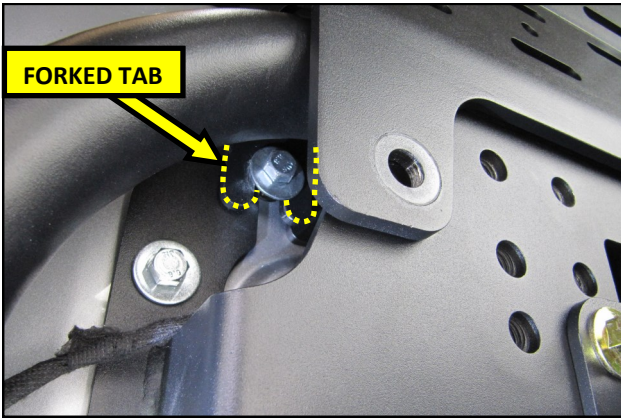

**11.** When properly fitted, the forked tabs will be between the tire carrier and the washers on the loosened bolts from step 9.

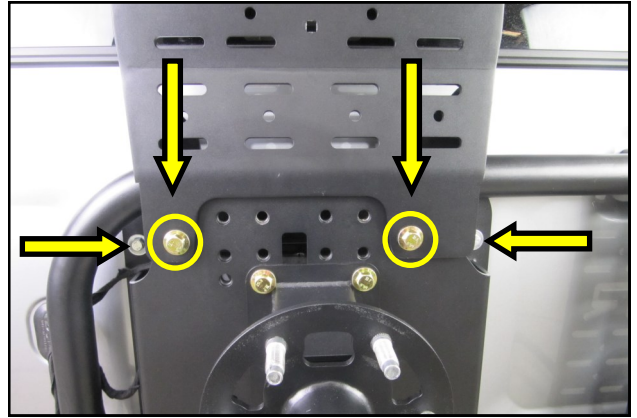

**12.** Use the supplied M12 Flange Bolts to secure the Jack Mount to the tire carrier and torque the Bolts to 45 lb.ft. Tighten the M8 bolts from step 9 to 30 lb.ft.

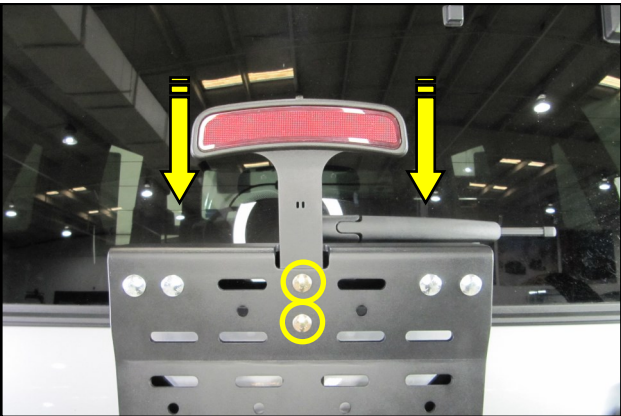

**13. INSTALL OPTION A:** Install the brake light and bracket onto the mount using the hardware removed in step 3.

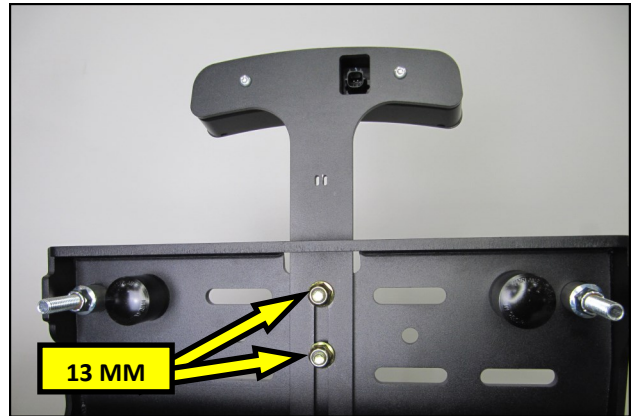

**14.** Torque the Lock Nuts to 14 lb.ft. Threadlocker is not to be used on these fasteners.

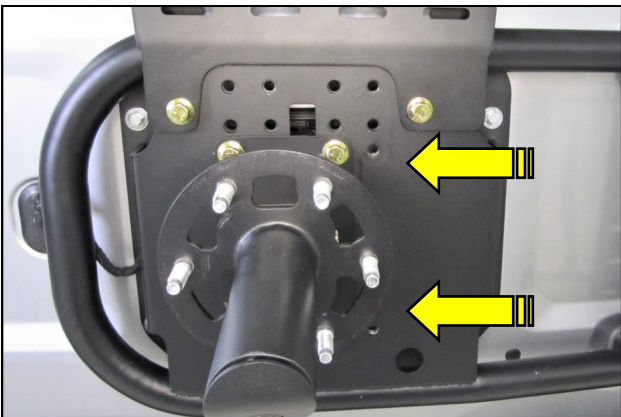

**15. INSTALL OPTION B:** The tire carrier hub can be repositioned to accommodate carrier mounted accessories.



**16.** To help keep the third brake light centered with a repositioned Hub, RTR has included an Off Set Light Bracket. Transfer the Offset bracket onto the brake light and secure it using the hardware from the original bracket. Threadlocker is not to be used on these fasteners.

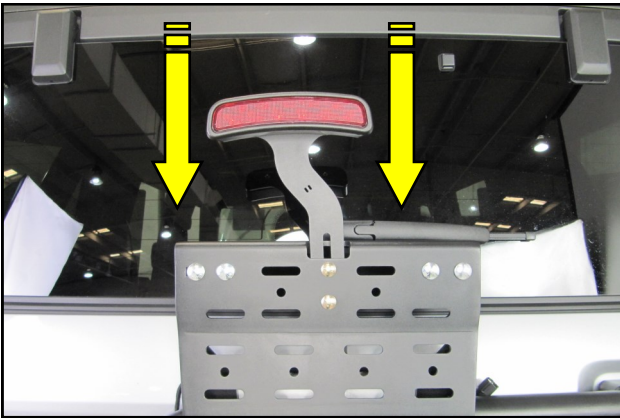

**17.** Install the brake light and Bracket onto the Mount using the hardware removed in step 3.

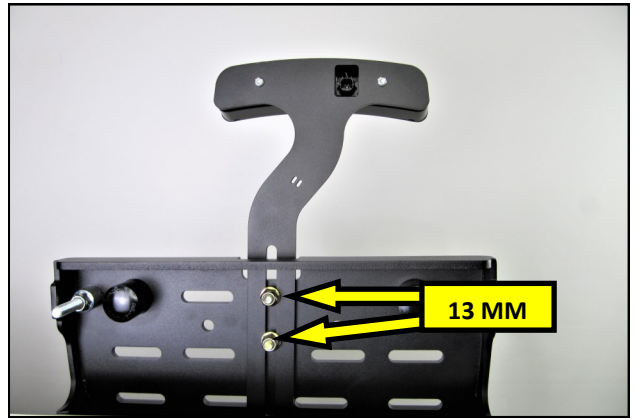

**18.** Torque the nuts to 14 lb. ft. Threadlocker is not to be used on these fasteners.

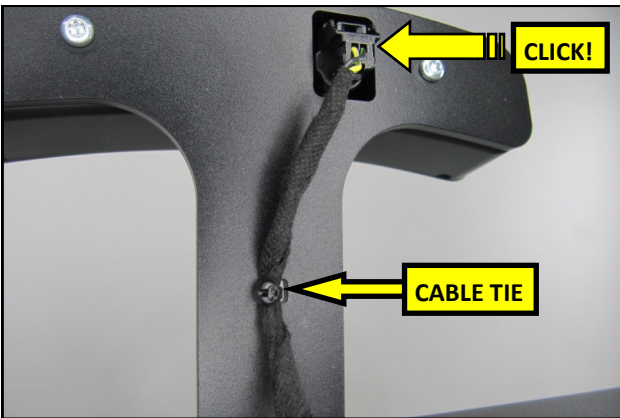

**19.** Reconnect the harness to the third brake light. Secure the wire harness to the Upper Brake Light Bracket using the supplied Cable Tie. Trim the excess length.

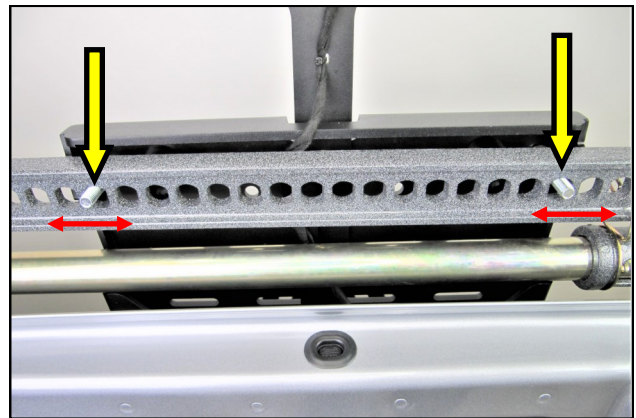

**20.** With the help of an assistant, lift the jack up and onto the Jack Mount Studs as shown. Adjust the Stud positioning left or right to fit the hole spacing of the Jack.

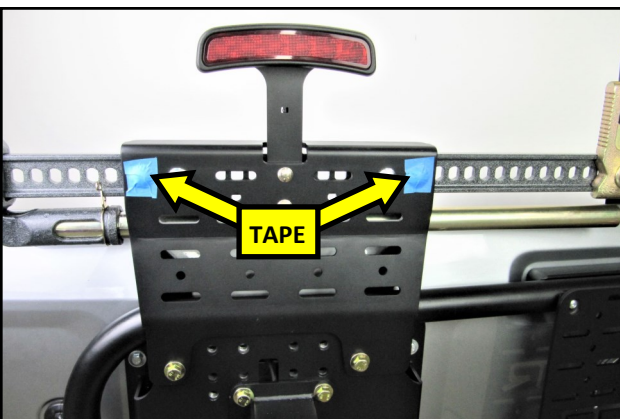

**21.** Use two pieces of painters tape to hold the Studs in position.

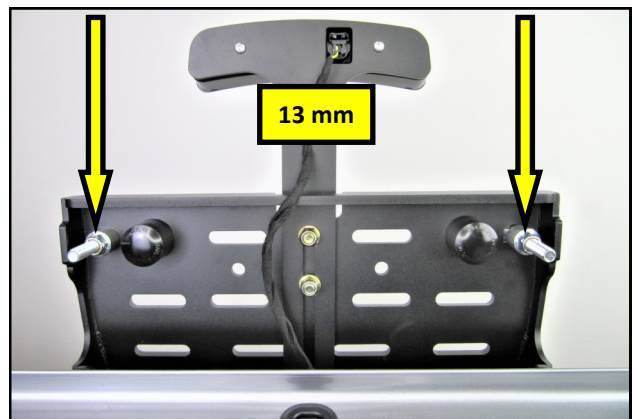

**22.** Tighten the Lock Nuts, final tight, to 15 lb.ft. Threadlocker is not to be used on these fasteners.

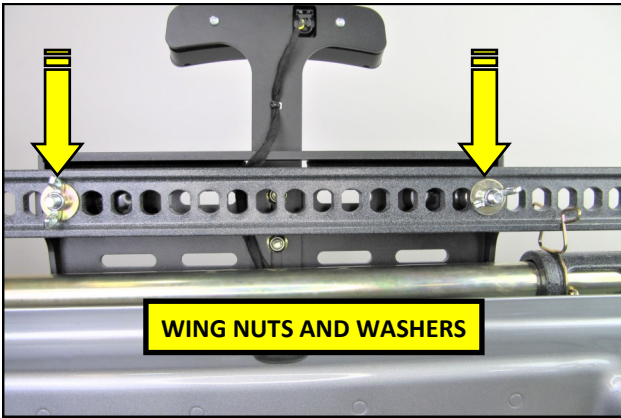

**23.** Secure the jack to the Mount using the supplied Wing Nuts and 3/8 Washers. Tighten the Wing Nuts Hand Tight. Threadlocker is not to be used on these fasteners.

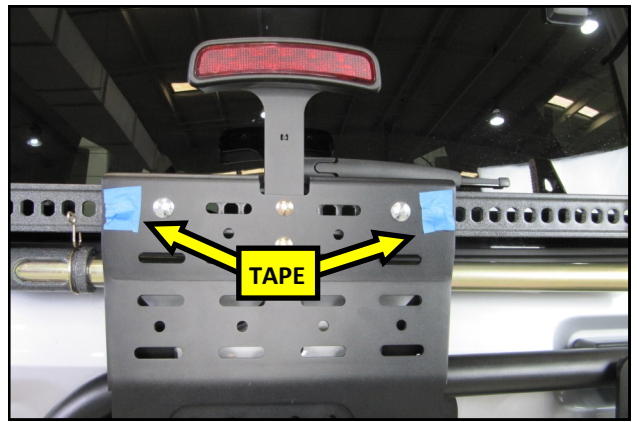

**24.** Remove the painters tape from step 21.

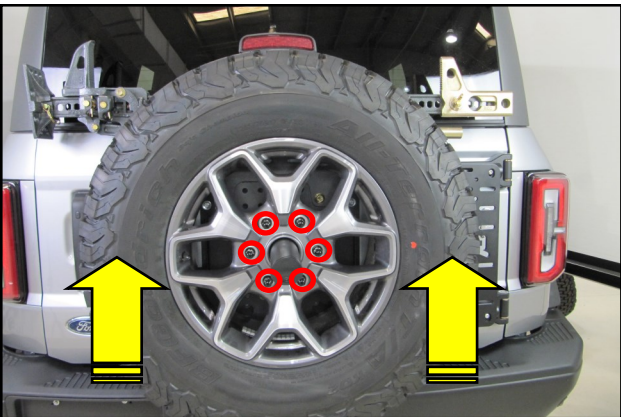

**25.** With the help of an assistant, carefully reinstall the spare tire onto the vehicle to avoid scratching and torque the lug nuts to 41 lb.ft.



**26.** Check the tire to Jack Mount clearance. When properly installed, the tire will be in contact with the Mount but should not require forcing the tire onto the hub. Readjust if necessary.

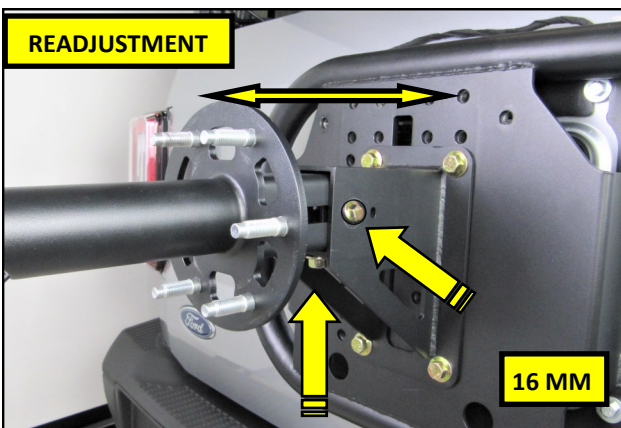

**27.** Loosen the 2 flange bolts on the tire carrier base and adjust as needed. Torque the flange bolts to 45 lb.ft. Reinstall the spare tire and re torque the lug nuts.

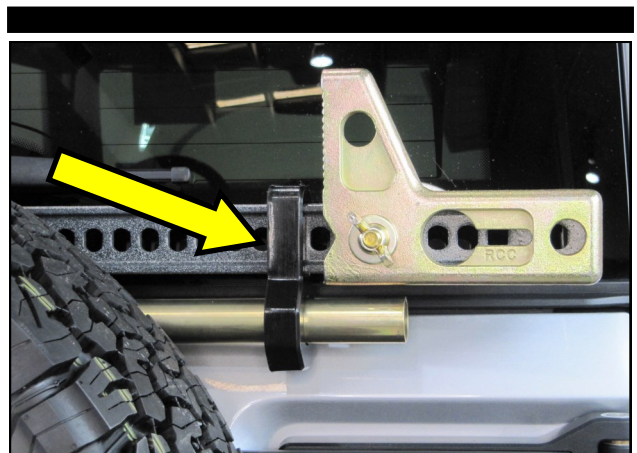

**28.** Install a handle keeper (not included) onto the jack handle to eliminate rattling during transportation.

**THIS PAGE HAS INTENTIONALLY BEEN LEFT BLANK**