

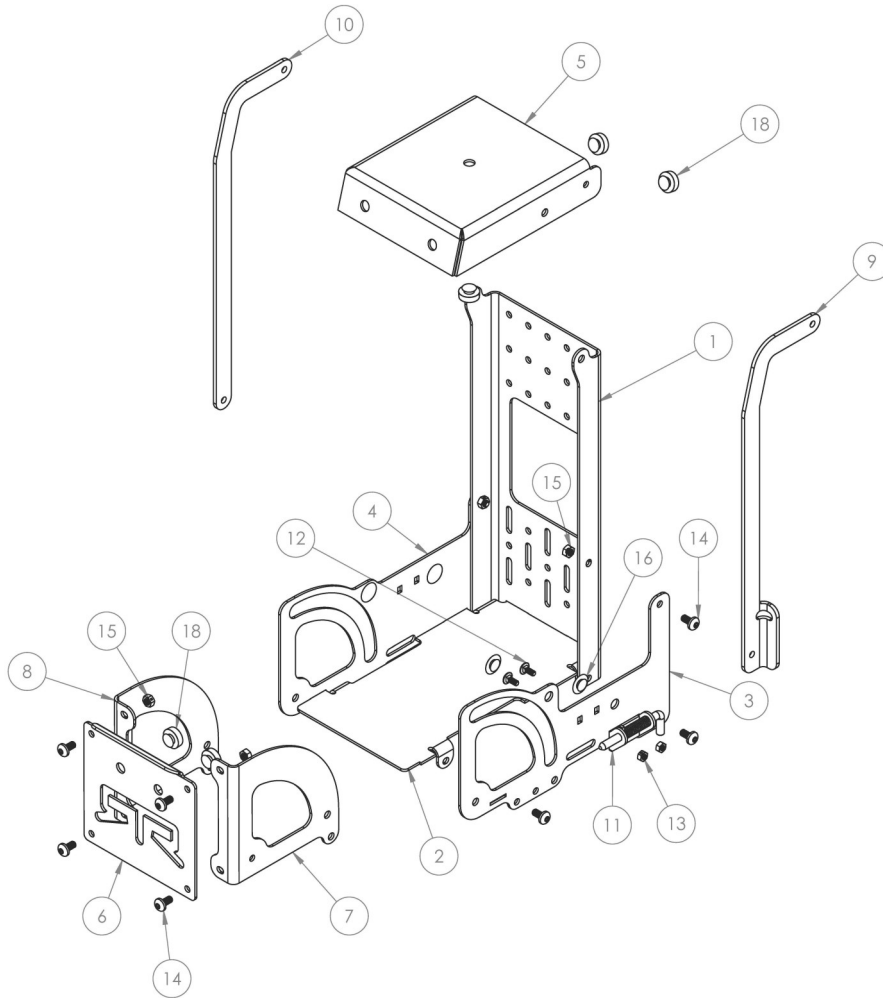

2021 Ford Bronco
RTR Jerry Can Holder
Part number:
14021.0020.15.A



Component Identification

| | | |
|----|---------------------|---|
| 1. | Back Panel | 1 |
| 2. | Floor Panel | 1 |
| 3. | Right Panel (Short) | 1 |
| 4. | Left Panel (Tall) | 1 |
| 5. | Top Panel | 1 |
| 6. | Front Panel | 1 |
| 7. | Right Sub Panel | 1 |
| 8. | Left Sub Panel | 1 |

| | | |
|-----|----------------------|----|
| 9. | Latching Link, Right | 1 |
| 10. | Link | 1 |
| 11. | Spring Latch | 1 |
| 12. | Carriage Bolt | 2 |
| 13. | 1/4-20 Lock Nut | 2 |
| 14. | M8 Button Head Bolt | 10 |
| 15. | M8 Lock Nut | 10 |
| 16. | Domed Bumper | 4 |

| | | |
|-----|---------------------------------|---|
| 18. | Flat Bumper | 5 |
| 19. | Bronze Washer | 8 |
| 20. | Lock Nut, Stainless | 8 |
| 21. | Shoulder Bolt | 8 |
| 22. | Plastic Washer | 4 |
| 23. | Wave Washer | 4 |
| 24. | Latching Link, Left (not shown) | 1 |

Please read this instruction manual in its entirety before beginning this installation. If any part of this manual is unclear to you, please contact RTR Customer Service at +1 704.459.4850. Mon– Fri, 9:00 AM-4:00 ET.

The RTR Jerry Can Holder is intended to be installed onto a vehicle that is already fitted with the RTR Accessory Plate. This Jerry Can Holder is intended to be used with the standard NATO 20L can or equivalent. RTR Strongly recommends using the RTR Tailgate Stop in conjunction with this product to prevent accessory interference with the body of the vehicle.

Design and specifications are subject to change without notice.

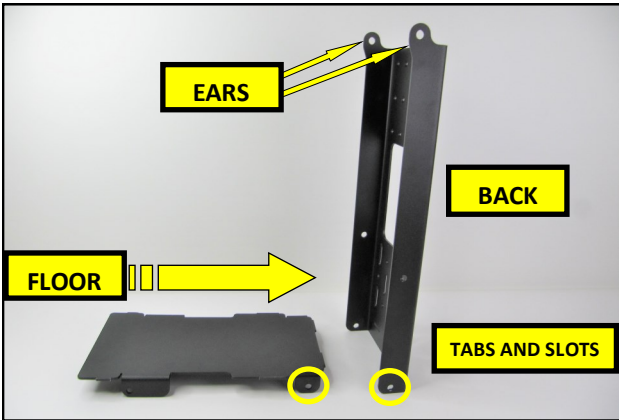

1. Create the Frame assembly: Slide the Floor Plate into the bottom of the Back Panel as shown, with the ears at the top and holes aligned at the bottom.

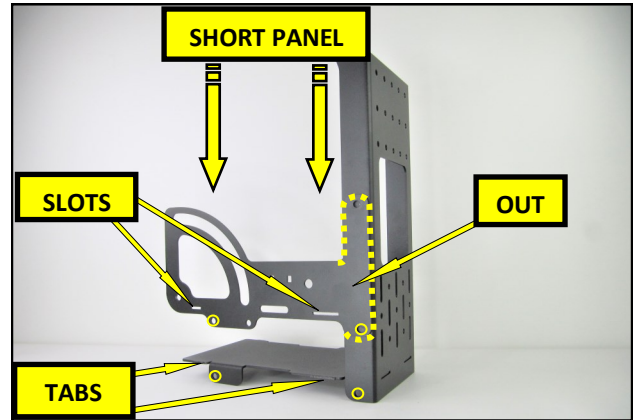

2. Slide the Side Panel– Short, down to the bottom and align the tabs, slots, and holes. The Side Panel is to be on the outside of the Back Panel.

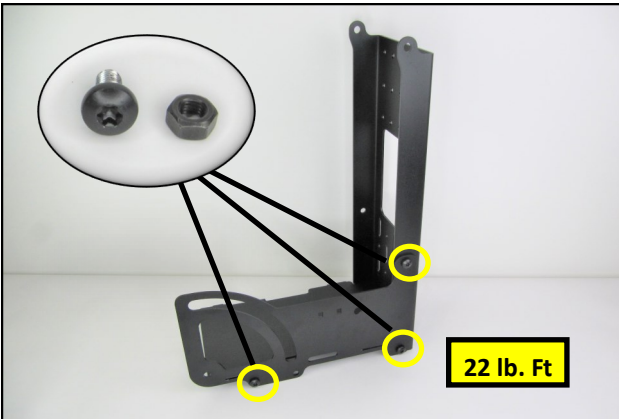

3. Using a T-40 TORX® driver and 13 mm wrench, secure the assembly using the Black M8 Button Head Screws and Nuts. Torque the Fasteners to 22 Lb. Ft.

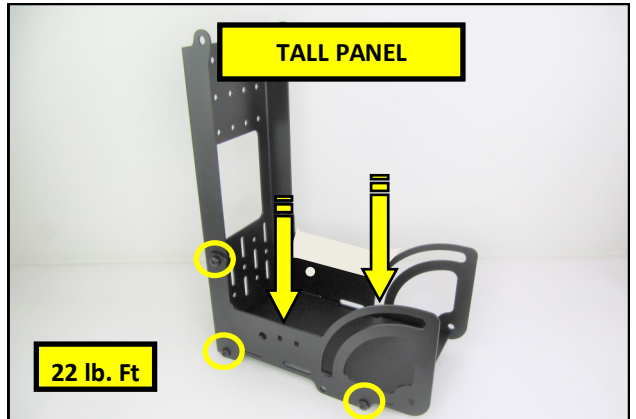

4. Secure the second Side Panel-Tall, to the outside of the Frame assembly as shown, using a second set of M8 hardware. Torque the Fasteners to 22 Lb. Ft.

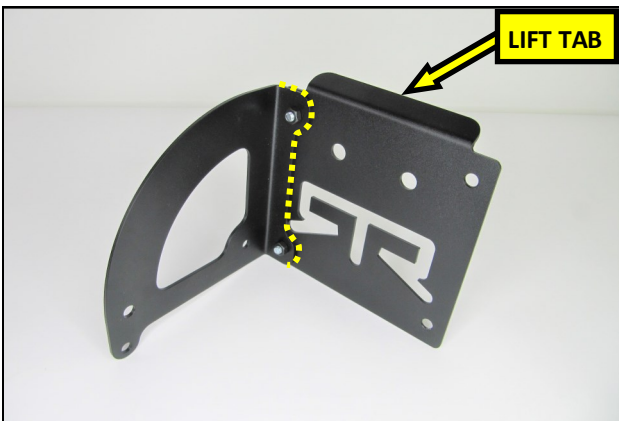

5. Create the Front Panel assembly: Install the Sub Panel onto the Front Panel using 2 M8 Button Heads and Nuts. When properly installed, the Sub Panel tab will be on the inside of the Front Panel.

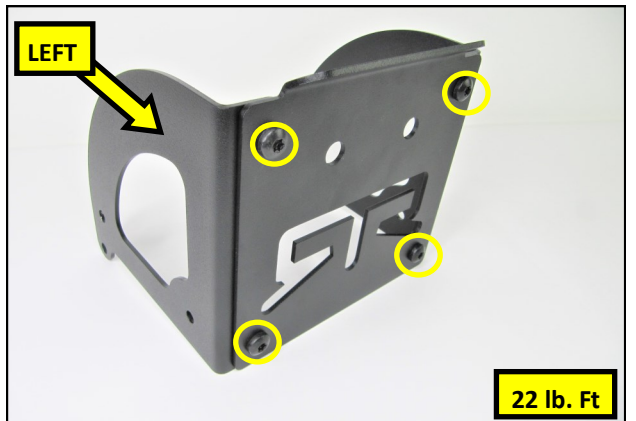

6. Install the Left Sub Panel onto the Front using a second set of M8 hardware. Tighten the Nuts and Bolts on both sides of the Front Panel. Torque the fasteners to 22 Lb. Ft.

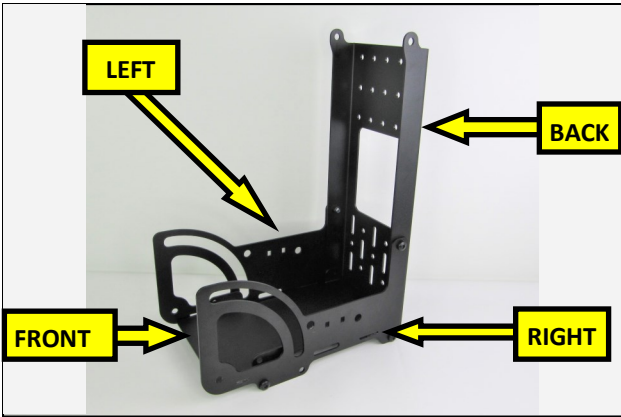

7. Place the RTR Jerry Can Holder Frame onto a work bench for assembly.

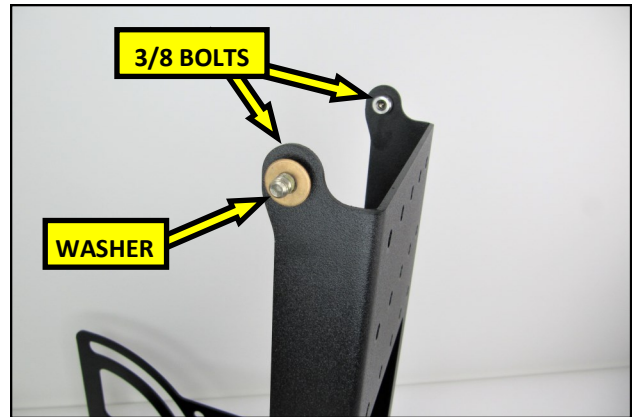

8. Insert 2 of the 3/8 Shoulder Bolts into the holes at the top of the Frame. Slide one Bronze Washer onto each of the Bolts as shown.

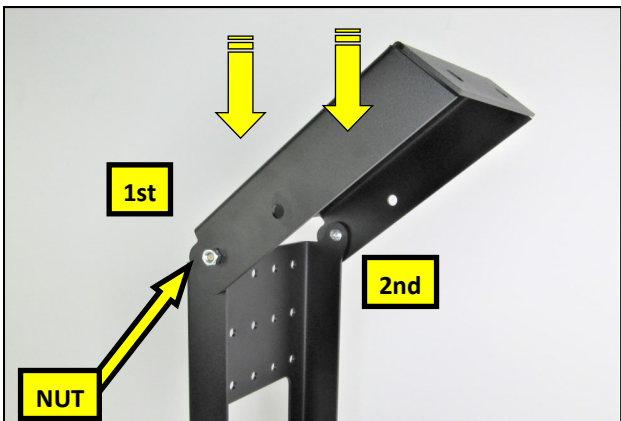

9. Install the Top Panel onto the Frame, one side at a time, and thread one 3/8 Lock Nut onto each of the Bolts.

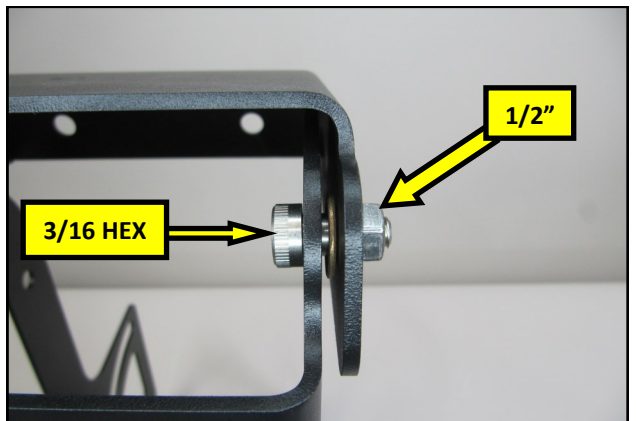

10. Tighten the Nuts and Bolts on both sides of the Top Panel. Torque the fasteners to 60 in-lbs.

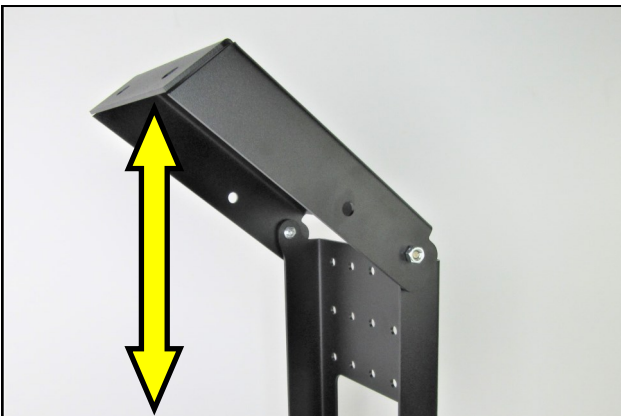

11. Open and close the Top Panel and observe the action. Its should be smooth and have little to no resistance. When properly tightened, there will be some side to side movement.

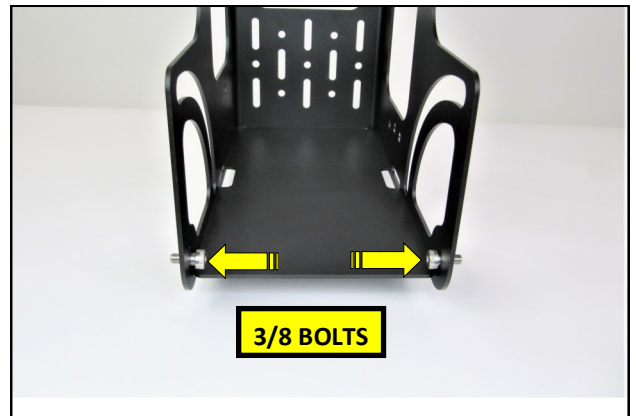

12. Insert 2 of the 3/8 Shoulder Bolts into the holes at the front of the Frame.

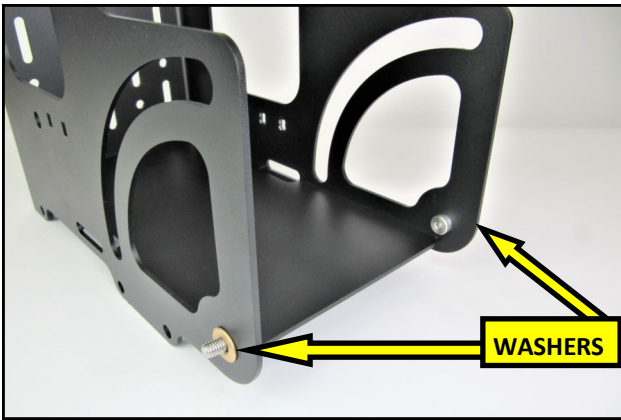

13. Place one Bronze Washer onto each of the 3/8 Bolts as shown.

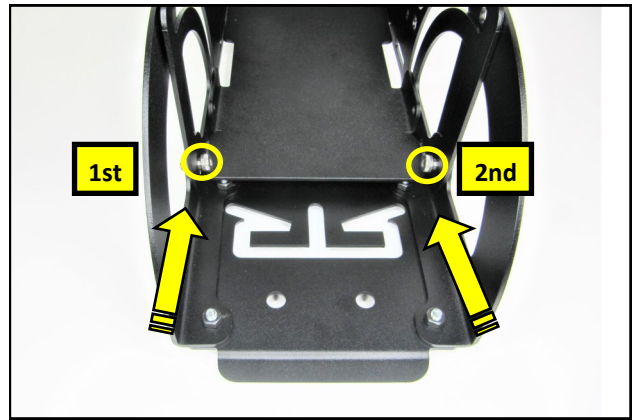

14. Install the Front Panel, over the Bolts from step 12, one side at a time, onto the Frame.

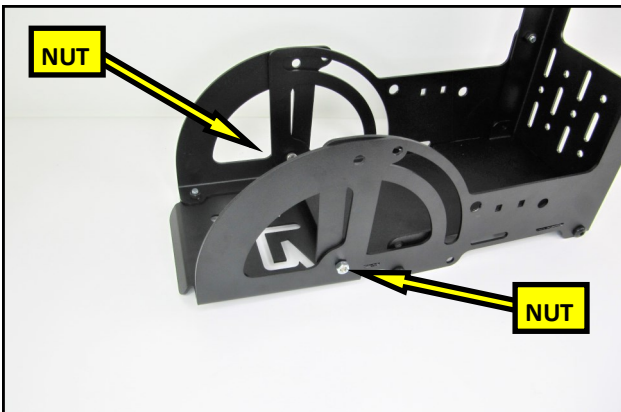

15. Thread one 3/8 Lock Nut onto each of the Bolts. Using a 1/2" wrench and a 3/16" hex driver, tighten the Nuts and Bolts on both sides of the Front Panel. Torque the fasteners to 60 in-lbs.

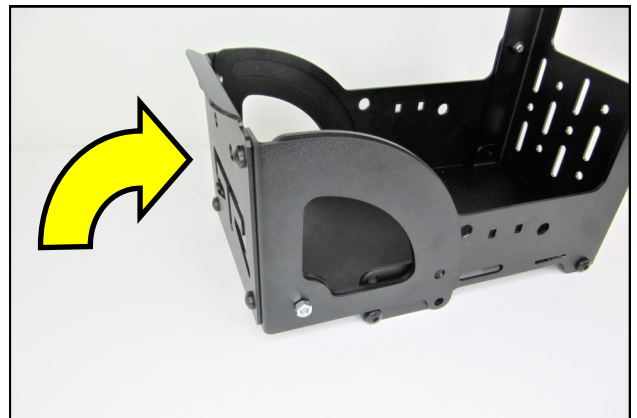

16. Open and close the Front Panel and observe the action. Its should be smooth and have little to no resistance. When properly tightened, there will be some side to side movement.

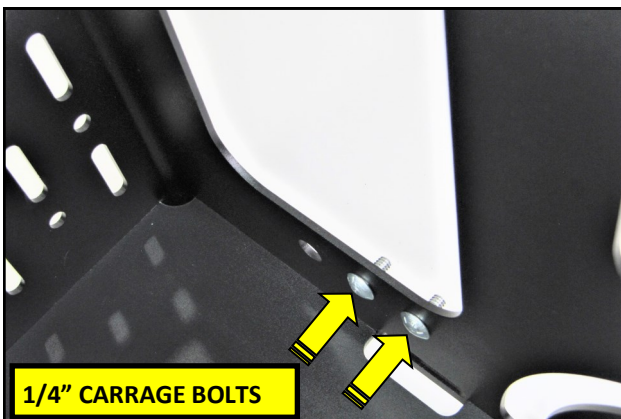

17. Insert the two 1/4- 20 Carriage Bolts into the Square Holes on the right side of the Frame.

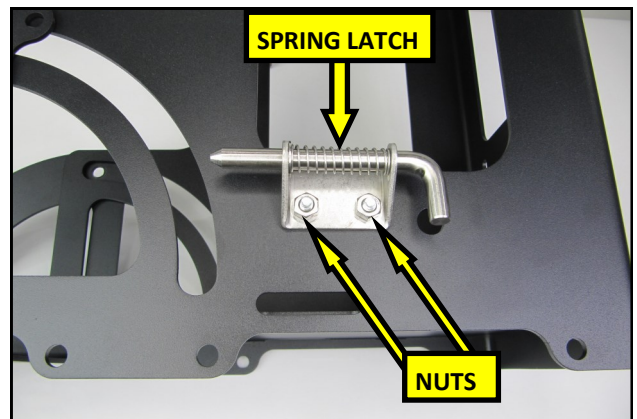

18. Place the Spring Latch over the Carriage Bolts from step 1. and Loosely secure it to the Frame using the 1/4" Lock Nuts and a 7/16" socket. Leave the fasteners finger tight at this time.

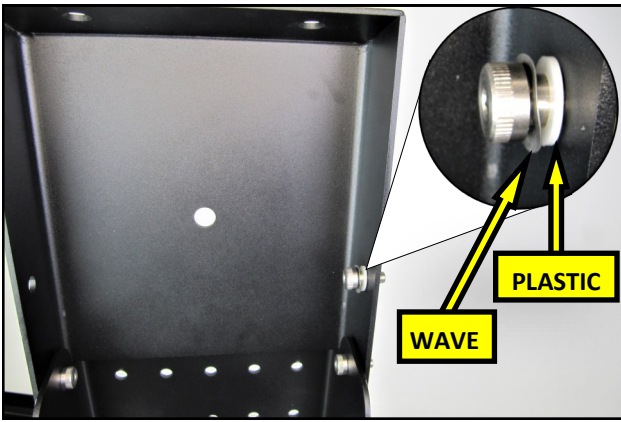

19. Insert one 3/8" Shoulder Bolt with one Wave Washer and one Plastic Washer into the side of the Top Panel as shown.

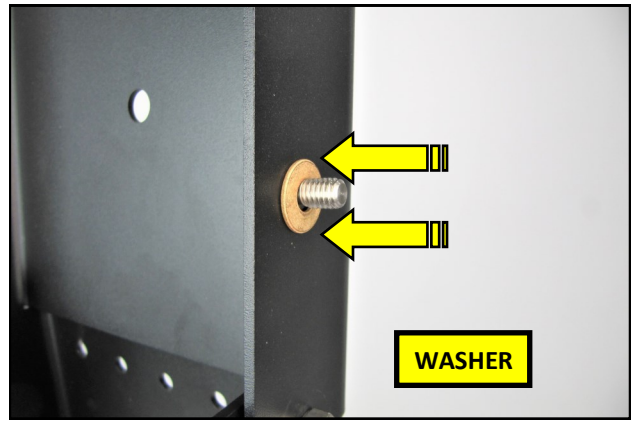

20. Slide one Bronze Washer onto the Bolt on the outside of the Top Panel.

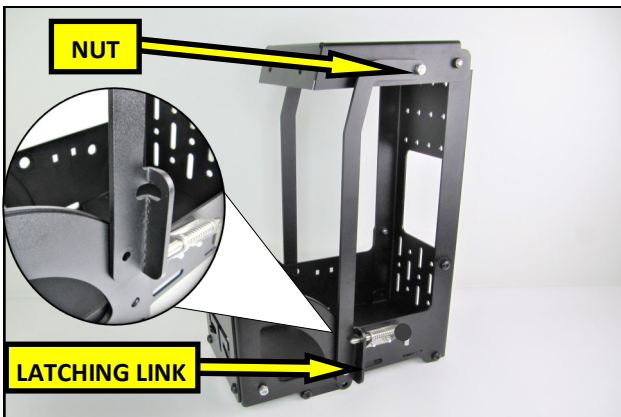

21. Slide the Latching Link over the Bolt from step 19. and thread one 3/8" Lock Nut onto the Bolt.

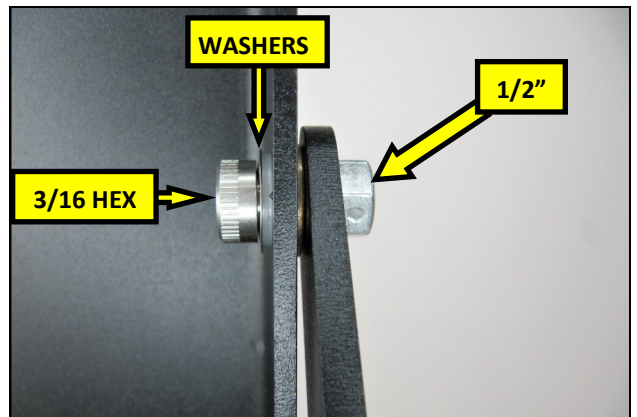

22. Confirm that the Washers are properly seated against the head of the Shoulder Bolt. Tighten the Lock Nut and Shoulder Bolt. Torque to the fasteners to 60 in -lb.

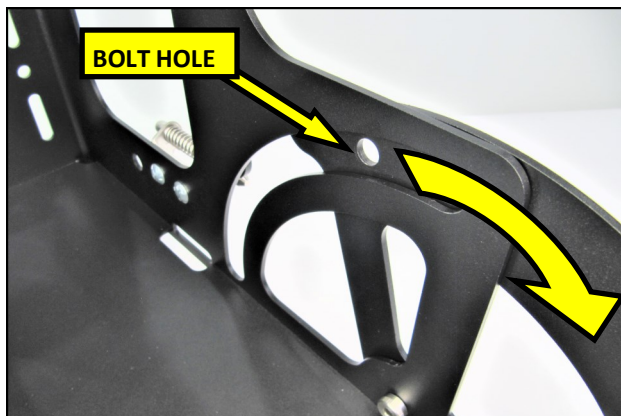

23. Fold the Front Panel down to place the lower Link bolt hole into the 11 O'clock position.

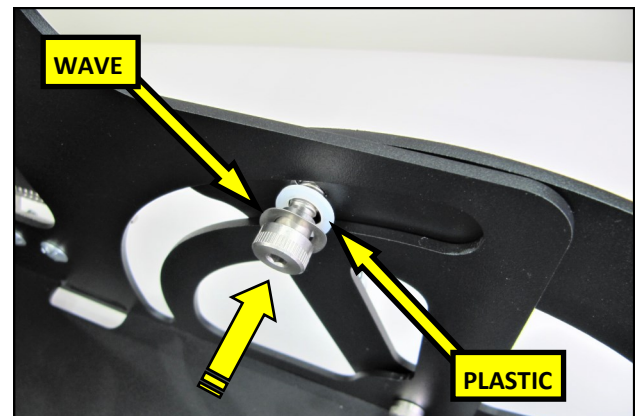

24. Insert one 3/8" Shoulder Bolt with one wave washer and one plastic washer into the side of the Front Panel as shown.

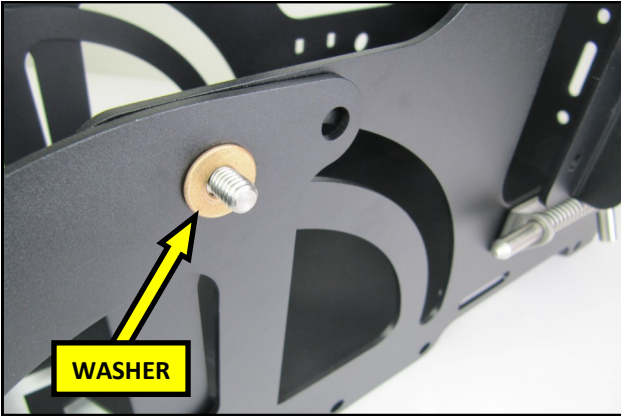

25. Slide one Bronze Washer onto the Bolt on the outside of the Front Panel.

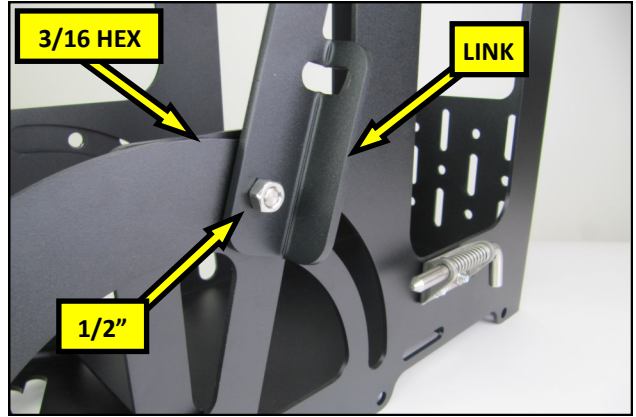

26. Slide the Latching Link over the Bolt from step 23. Confirm that the Washers are properly seated against the head of the Shoulder Bolt. Thread one 3/8 Locknut onto the Bolt and torque the fasteners to 60 in-lb.

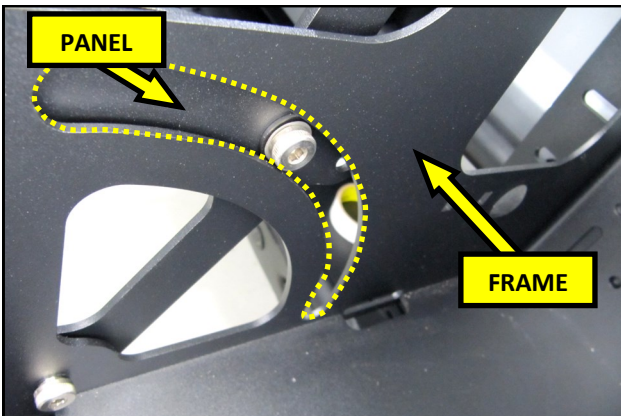

27. When properly installed, the Bolt Head and Washers will be on the Front Panel and will act as a guide as it travels inside the Frame.

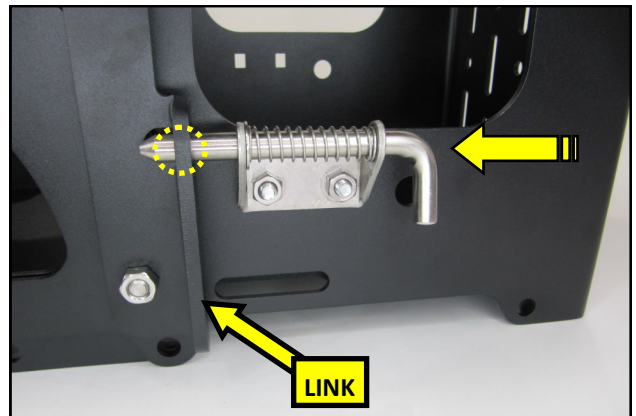

28. Confirm that the Spring Latch has properly engaged the Link.

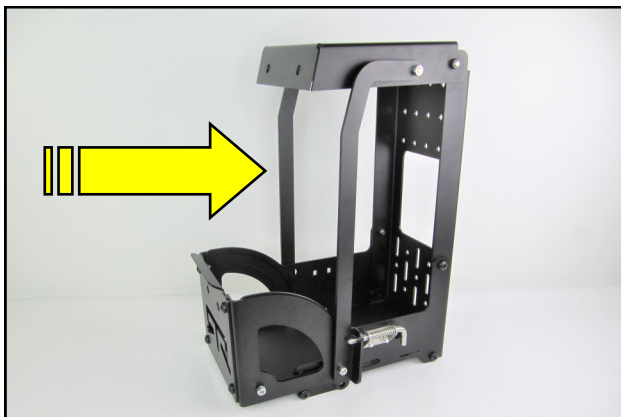

29. Repeat steps 19-26 on the left side of the Jerry Can Holder using the Side Link.

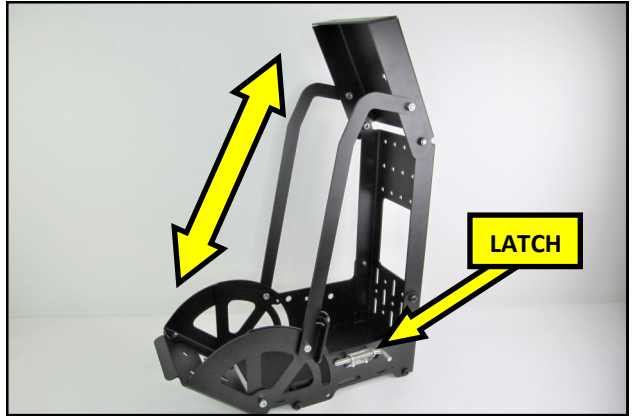

29. Pull the Spring Latch out of the Link, raise the Top Panel up and observe the action. The Front Panel should simultaneously move in the opposite direction.

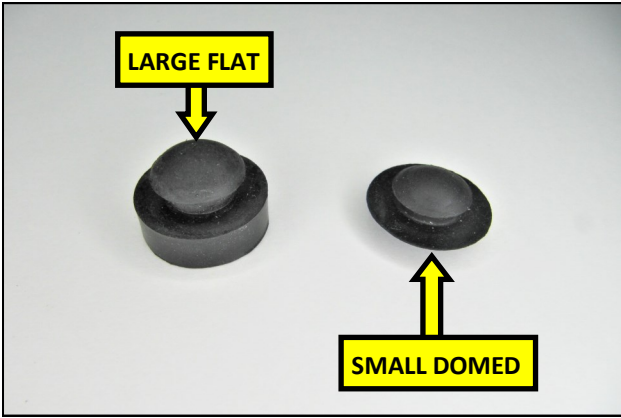

31. The RTR Fuel Can Holder incorporates 2 types of “push in” Rubber Bumpers. They are: Large Flat Topped Bumpers and the Small Domed Top Bumpers. Installation of these Bumpers is best achieved using soapy water as a lubricant.

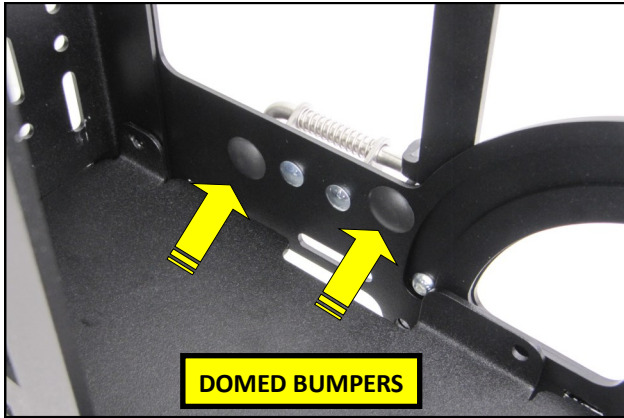

32. Insert two of the Small Domed Bumpers into the lower portion of the Frame as shown.

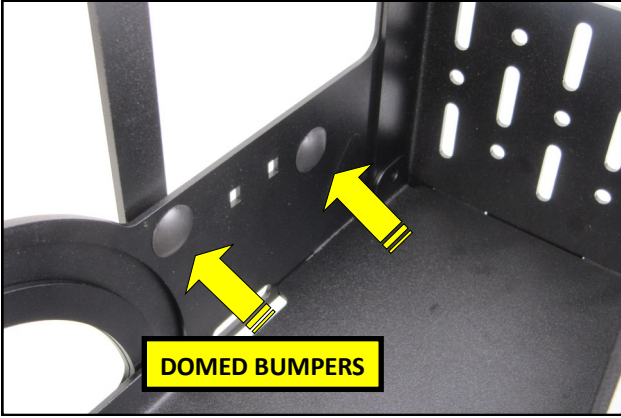

33. Insert two remaining Small Domed Bumpers into the lower portion of the Frame on the opposite side of the Frame.

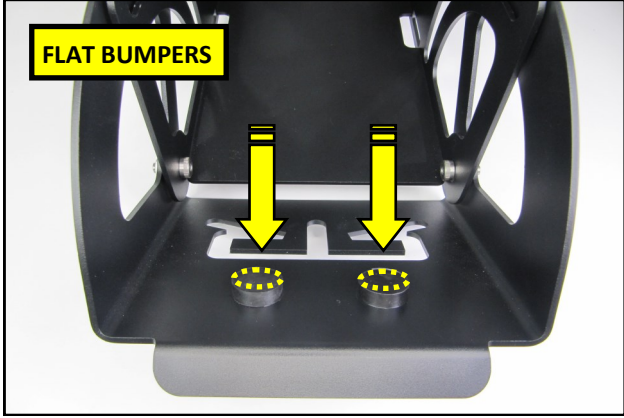

34. Install two of the Flat Topped Bumpers into the Front Panel as shown, with the flat tops on the inside of the Panel.

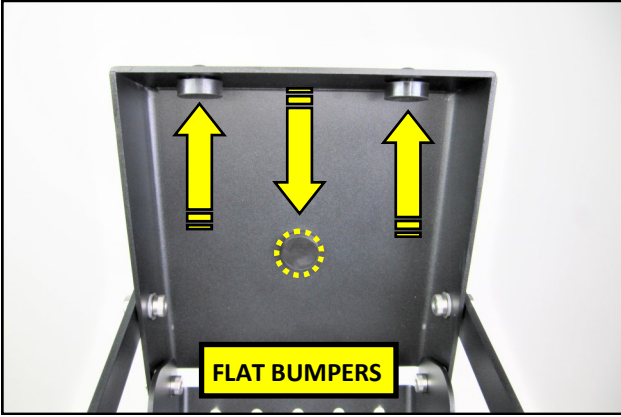

35. Insert three of the Large Flat Topped Bumpers into the Top Panel with the flat tops on the inside of the Panel.

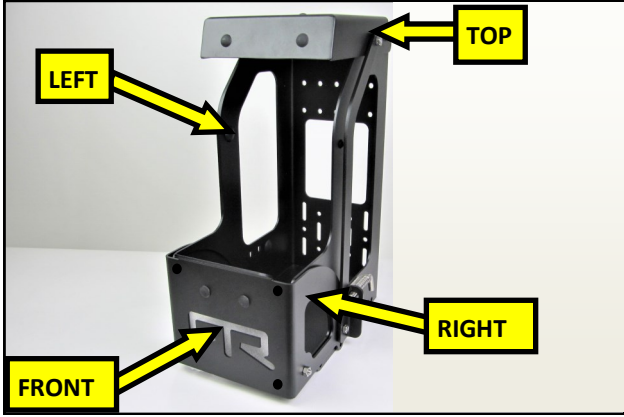

36. View of the completed Jerry Can Holder assembly.



37. For vehicles equipped with the RTR Adjustable Spare Tire Carrier, remove the spare tire and set it aside.

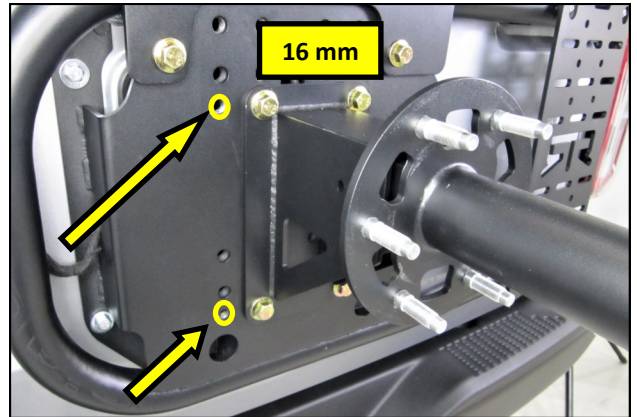

38. Relocate the spare tire Mount using the leftmost set of holes in the Base. Torque the Flange Bolts to 45 Lb-ft.

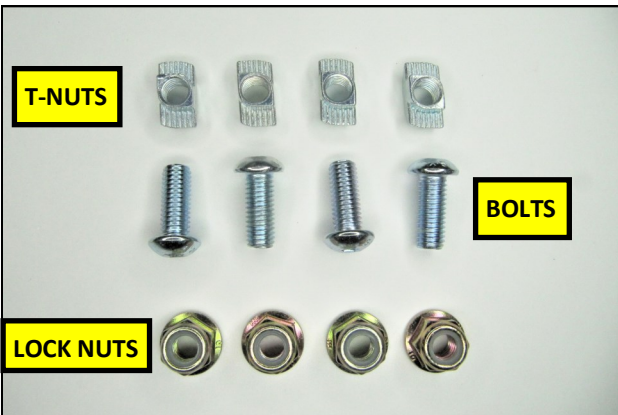

39. The RTR Jerry Can Holder is to be mounted to the RTR Accessory Plate using the supplied M8 Button Head Bolts and one set of “Quick-Fit” T-Nuts or the “Semi-Permanent” Lock Nuts.

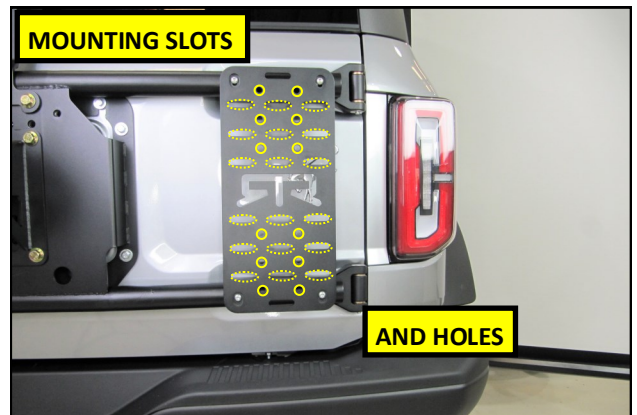

40. Select an appropriate set of mounting slots and or holes in the Accessory Plate based on your particular configuration of accessories.

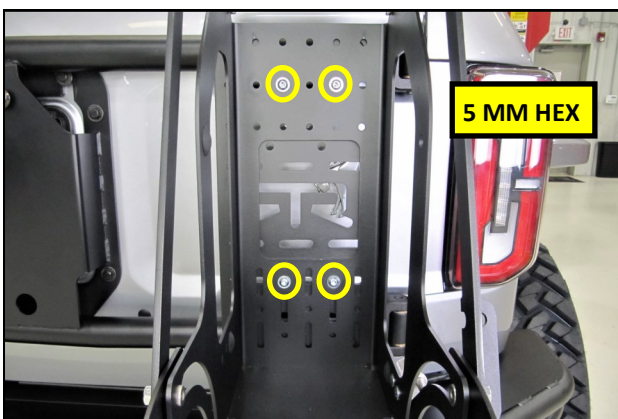

41. Mount the Jerry Can Holder to the Accessory Plate using the Hardware combination selected from step 40.

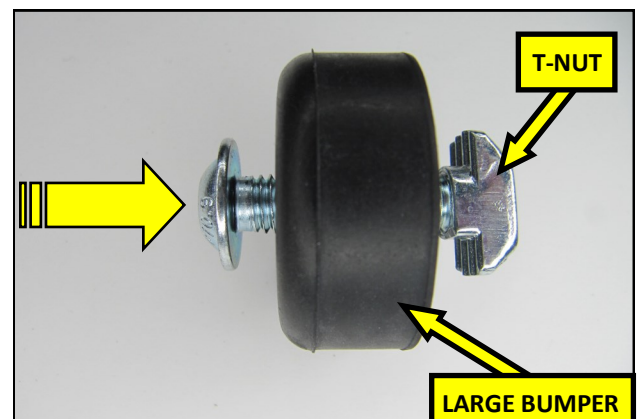

42. Insert the remaining Button Head Bolt into the large Rubber Bumper as shown.

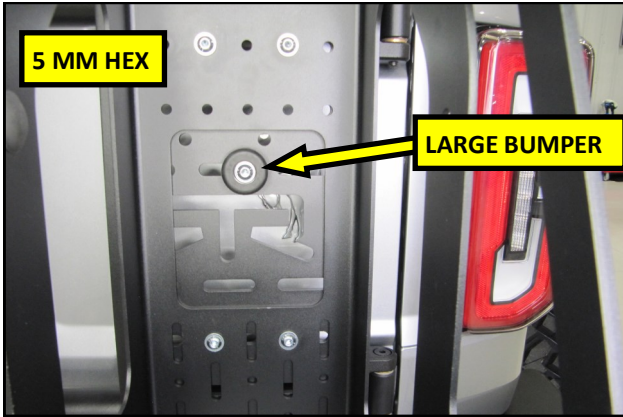

43. Install the large Rubber Bumper onto the Accessory Plate as shown, in the center of the Jerry Can Holder. Secure it using a Lock Nut or T-Nut.

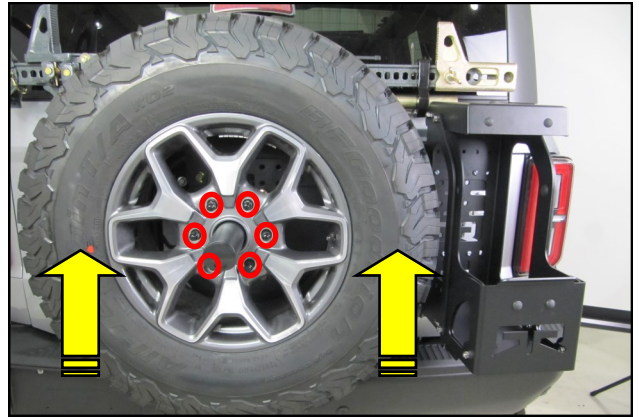

44. Reinstall the spare tire onto the Tire Carrier and torque the lug nuts to 98 lb. ft.



45. Open the Jerry Can Holder and place the fuel can inside of it as shown, with the handles facing forward and the filler neck facing rearward.



46. Close the Holder and position the can so that it has equal contact on all sides. Tighten the Spring Latch Nuts from step 18.

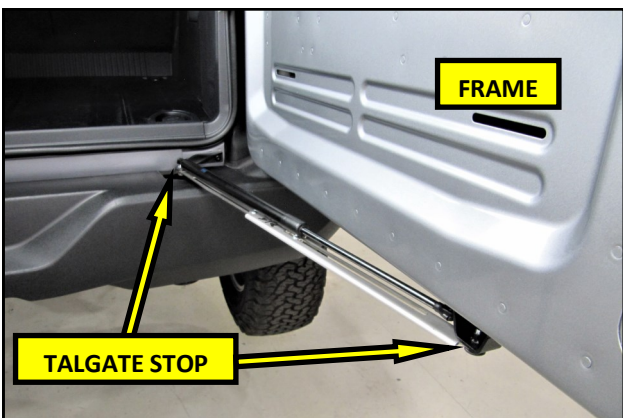

47. Carefully open the tailgate and verify the proper positioning of the holder on the Accessory Plate and that there is no interference with the tail light or any other accessories installed. Adjust the Tailgate Stop, is so equipped, to prevent any accessory interference with the body of the vehicle.

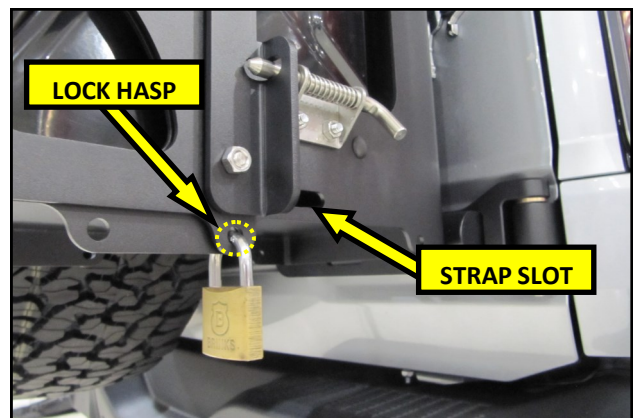

48. For added security, the RTR Jerry Can Holder can accommodate a pad lock with up to a 3/8" shackle on either side of the Holder. A set of slots has been put into the Frame and can be used with a nylon strap to eliminate "rattling" during transportation.

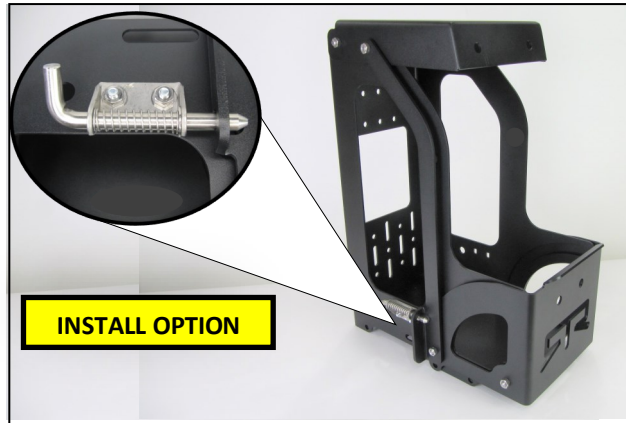

The latching action can also be installed onto the Left side of the Jerry Can Holder if desired. Perform steps **17** and **18** on the opposite side of the frame, with the Latch in the position above and substitute the Side Link with the Left Latching Link .

◆ Warranty information can be found at www.RTRVehicles.com