

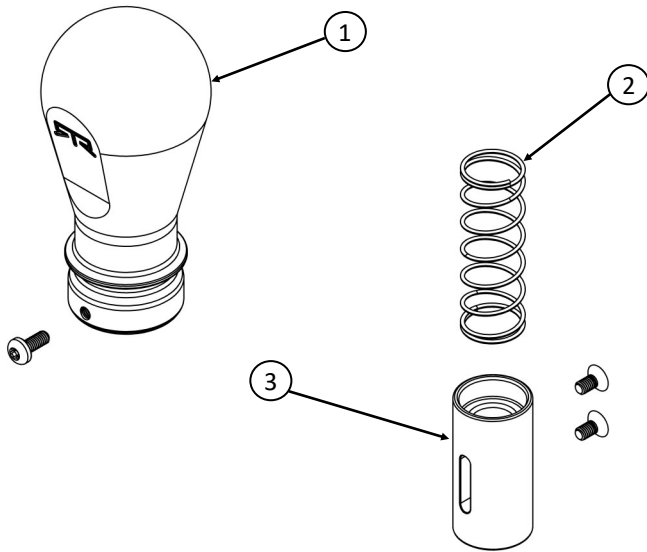

2015-2022 Ford Mustang
RTR Shift Knob Kit
Automatic Transmission
Part Number 11031.0004.11.A



Component Identification

1.	Shift Knob	1
2.	Return Spring	2
3.	Shaft Collar	1
4.	Hardware and Instruction (not shown)	1

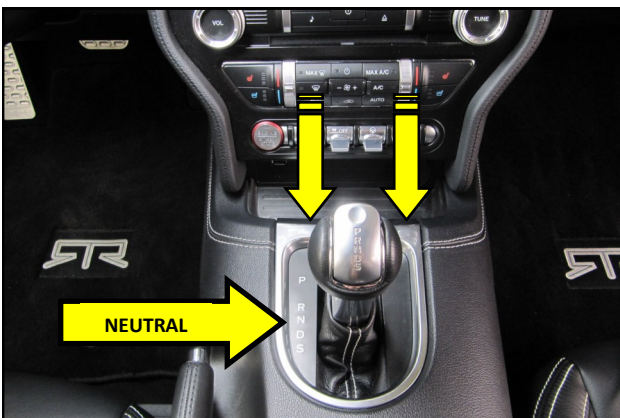

1. With the vehicle parked on level ground, move the shift arm into the Neutral position.



2. Using a plastic trim tool, carefully lift the shifter bezel and boot assembly out of the console by unseating the 5 plastic retention clips.

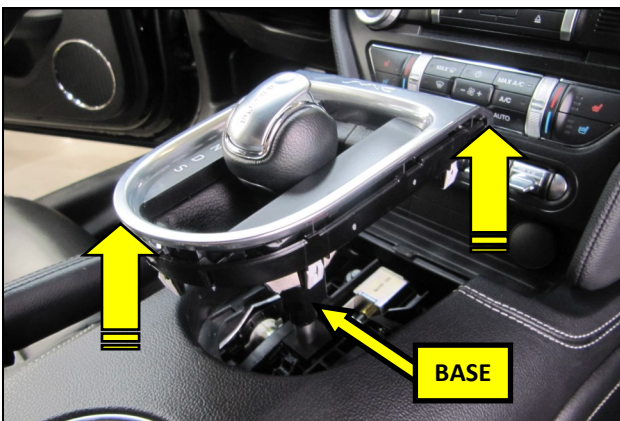

3. Raise the boot and bezel up to gain access to the base of the shift knob. Disconnect the 2 wire accent light harness if so equipped.

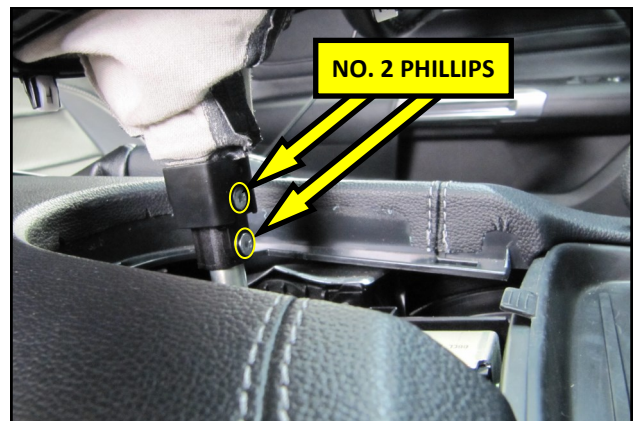

4. Using a short shank Phillips head screwdriver, remove the 2 screws at the forward facing edge of the shifter base. Discard the screws. They will not be re-used with the RTR Shift Knob Kit.

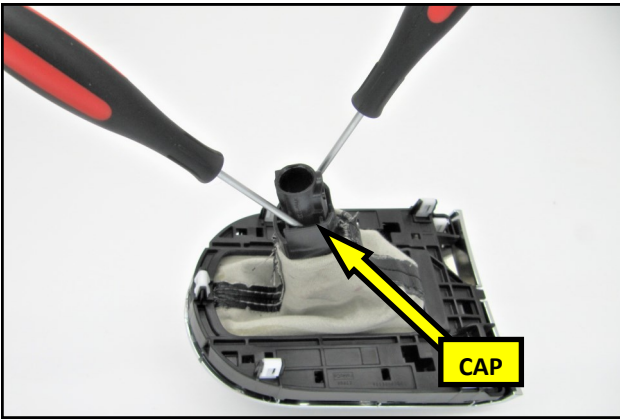

5. Using 2 standard head precision screwdrivers, depress the lock tabs in the shift boot cap.

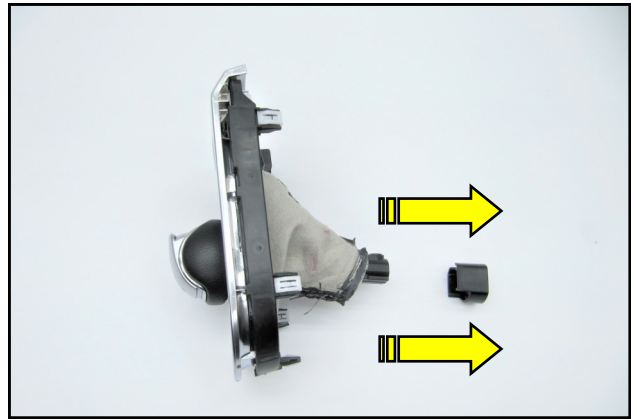

6. Remove the cap and discard it. It will not be reused with the RTR Shift Knob Kit.

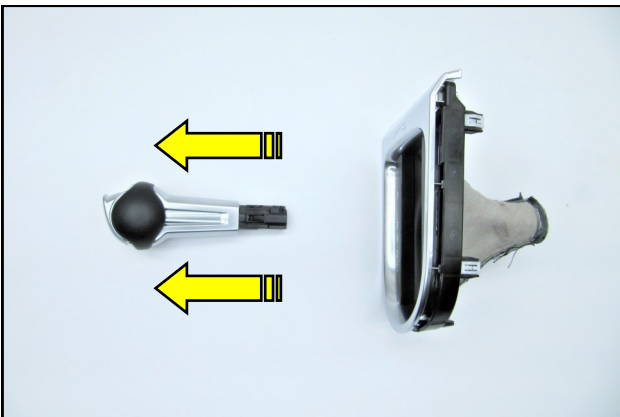

7. Remove the shifter from the boot and discard it. It will not be reused with the RTR Shift Knob Kit.



8. Insert the RTR shift knob into the shift boot as shown.

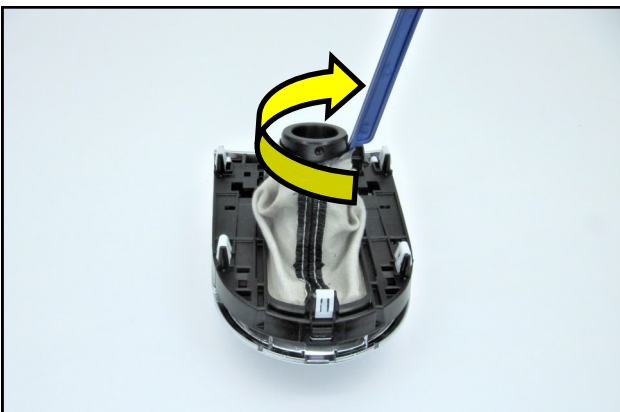

9. Using a small plastic trim tool, push the first tier of the Shift Knob through the boot as shown. **HINT:** Using soapy water as a lubricant will ease installation.

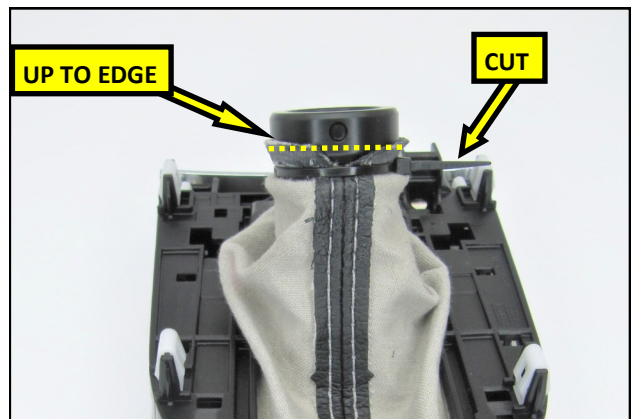

10. Pull the boot down to, and completely around the edge of the groove in the RTR Knob. Use the supplied Cable Tie to secure the shift boot to the Knob as shown. Trim the excess length.

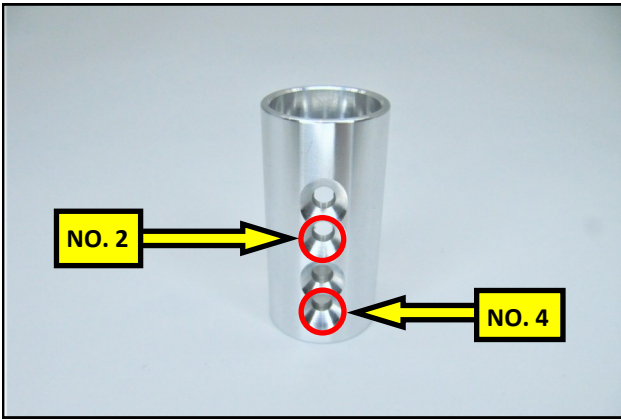

11. The RTR Shaft Collar has 4 screw holes in it. For this installation, only the number 2 and 4 holes will be used.

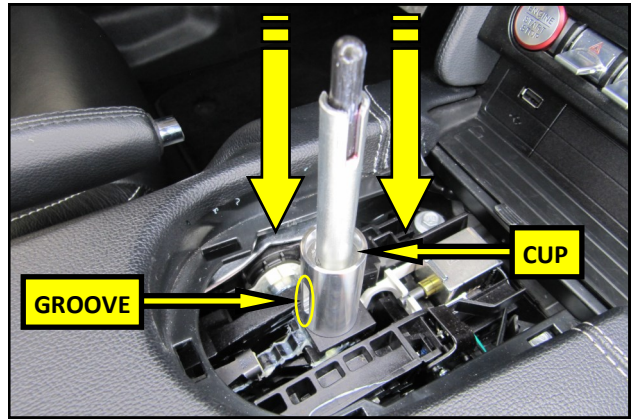

12. Slide the Shaft Collar onto the shifter arm as shown, with the spring cup on top and vertical groove facing rearward.

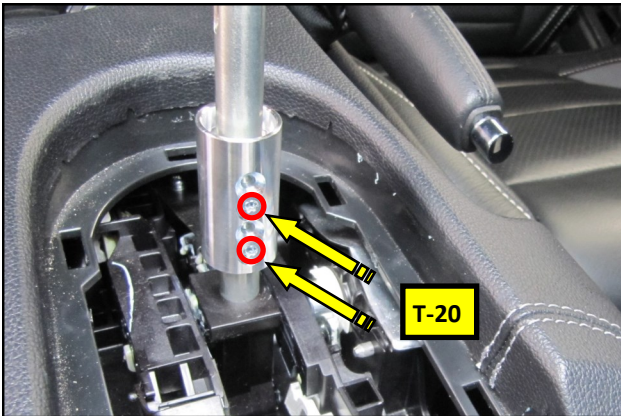

13. Align the number 2 and 4 holes of the Shaft Collar with the holes in the shift arm. Using a T-20 TORX® driver, install the supplied Flat Head Screws to secure the Collar to the shaft.

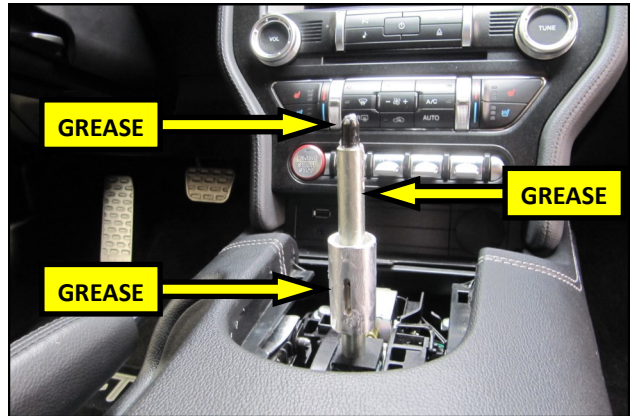

14. Use the RTR supplied Grease to lubricate the Shaft Collar, shaft, and shift plunger.

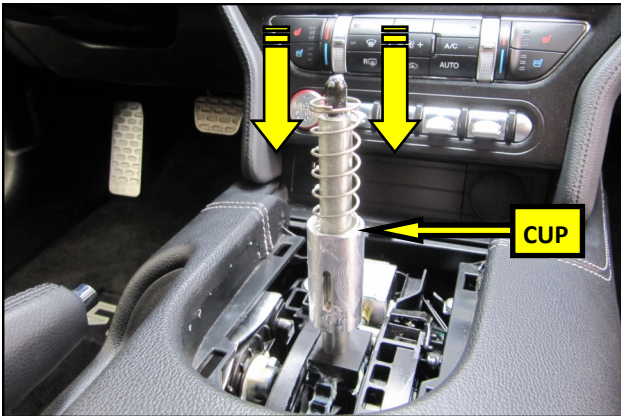

15. Place the Return Spring into the cup of the Shaft Collar as shown.

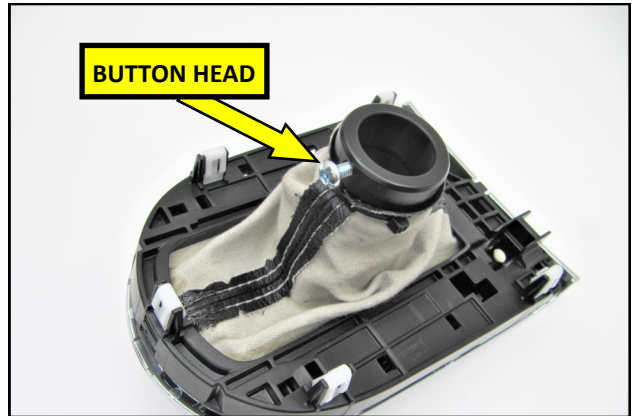

16. Thread the Button Head Screw into the Shift Knob by hand, leaving most of the threads exposed outside of the Knob.

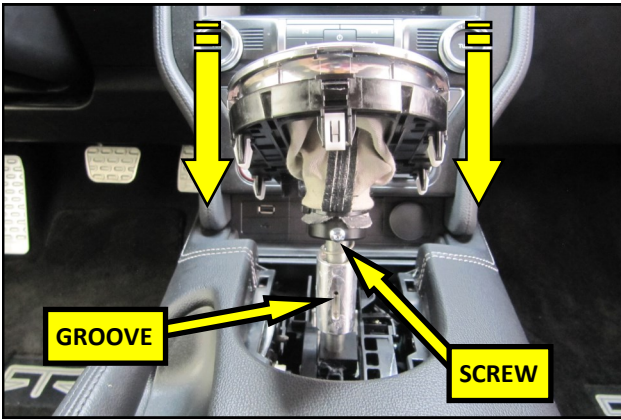

17. Set the Shift Knob, boot, and bezel assembly onto the shift arm as shown. Align the Button Head Screw with the groove in the Shaft Collar.

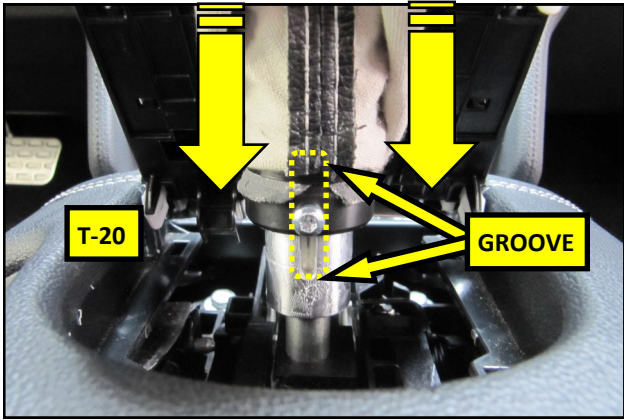

18. Push the shift knob down onto the shaft and using a T-20 TORX® driver, carefully tighten the screw until the head makes contact with the knob and stop. Do not overtighten.

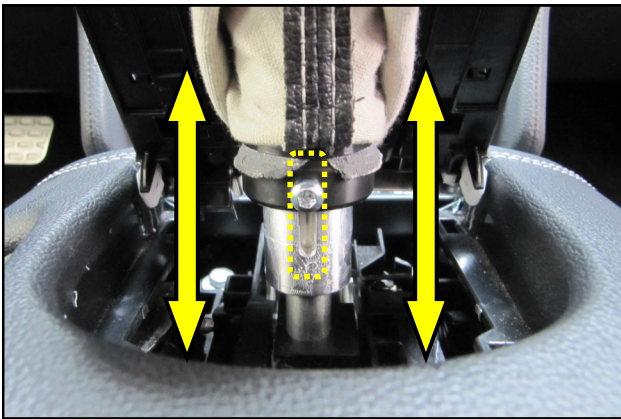

19. The Screw serves as a guide pin and limits travel of the Knob in both directions. Verify the action by pushing down on the Knob and releasing it. When properly installed, the knob will travel smoothly in both directions and not rotate.

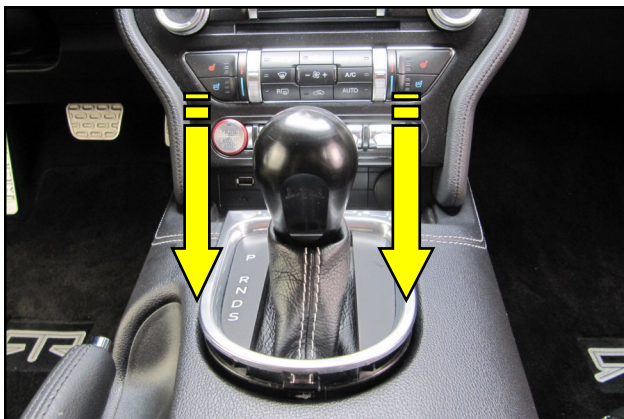

20. Reconnect the 2 wire accent light harness if so equipped. Align the retention clips on the bezel with the slots in the console and carefully reinstall the bezel assembly.

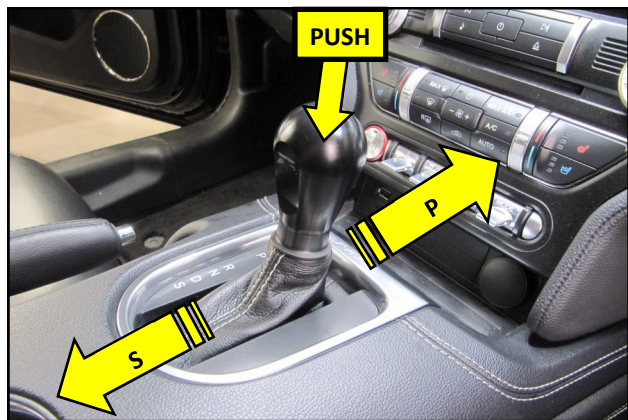

20. Verify the function of the shifter. Press the RTR Shift knob down and cycle the range selector forward and backward, through all ranges, P-S. When released, the RTR Knob will move upward and hold the range selected.