

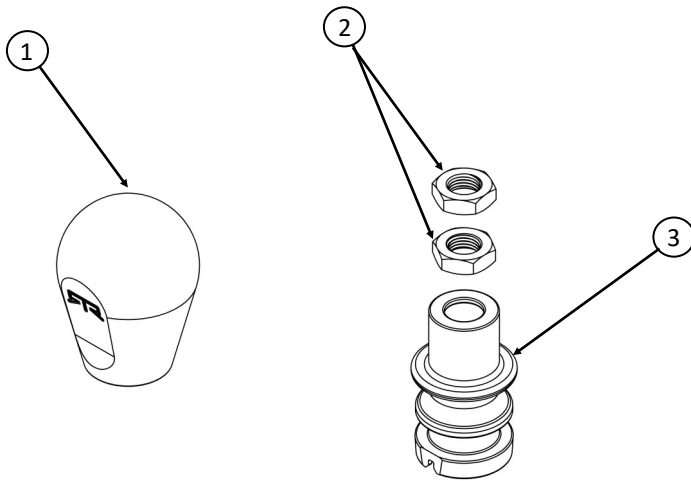

**2015-2022 Ford Mustang  
RTR Shift Knob Kit  
Manual Transmission  
Part Number 11031.0003.11.A**



**Component Identification**

1.	Shift Knob	1
2.	Jam Nut	2
3.	Lockout Collar	1
4.	Hardware and Instruction	1

**NOTE:** Installation of this Shift Knob Kit requires permanent modification of the OEM reverse lockout ring. In addition to common hand tools, installation of this part requires the use of 3 standard blade precision screwdrivers, or equivalent. Please read through the installation instructions in its entirety before beginning the installation.



**1.** Remove the OEM shift knob by turning it by hand, counter clockwise and threading it off of the shaft. No tools will be necessary for removal.



**2.** Starting from the front, carefully lift the shifter bezel, lockout ring, and boot assembly out of the console by overcoming the 5 plastic retention clips.

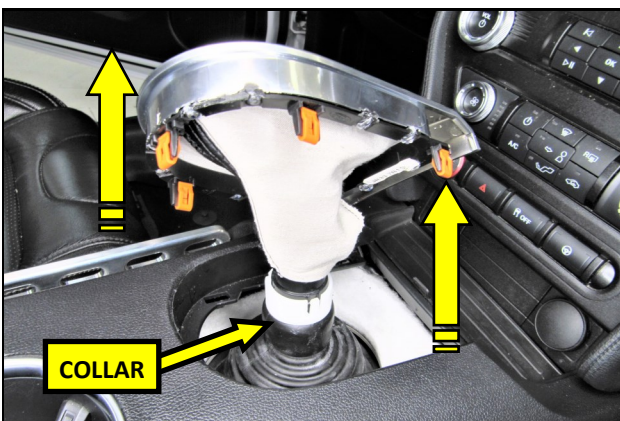

**3.** Raise the boot and bezel up and over the shaft to gain access to the lock collar. Disconnect the 2 wire accent light harness if so equipped.

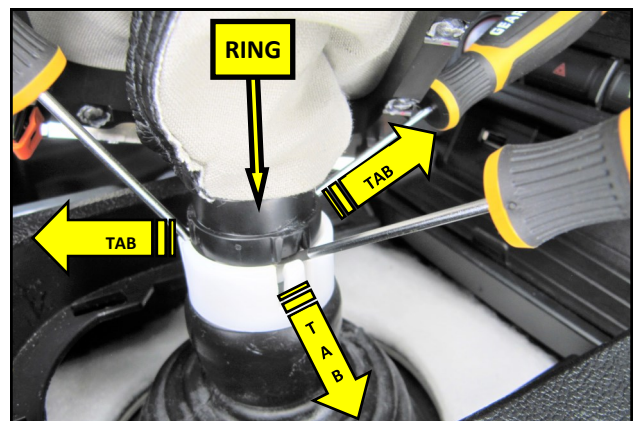

**4.** Using 3 standard head precision screwdrivers, open the 3 lock tabs in the collar to release the shift boot ring.

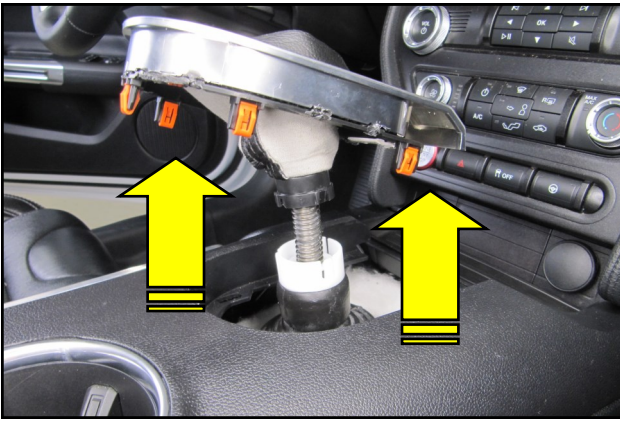

5. Remove the shift boot and bezel assembly from the vehicle.



6. Place the boot and bezel assembly onto a padded work surface as shown.

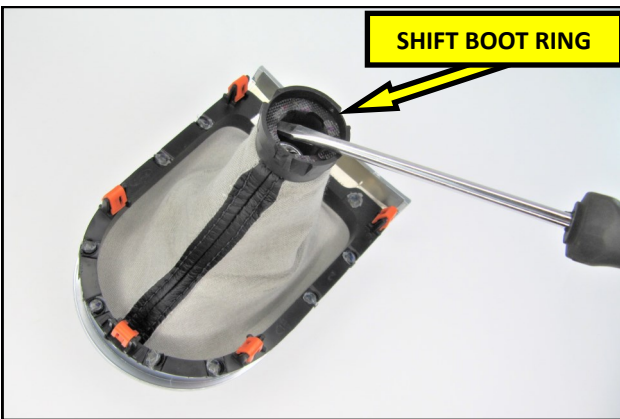

7. Using a medium size standard head screwdriver, pry upward on the inner edge of the shift boot ring to separate it from the reverse lock out ring. Neither the shift boot ring or the lockout ring will be reused with the RTR Shift Knob Kit.

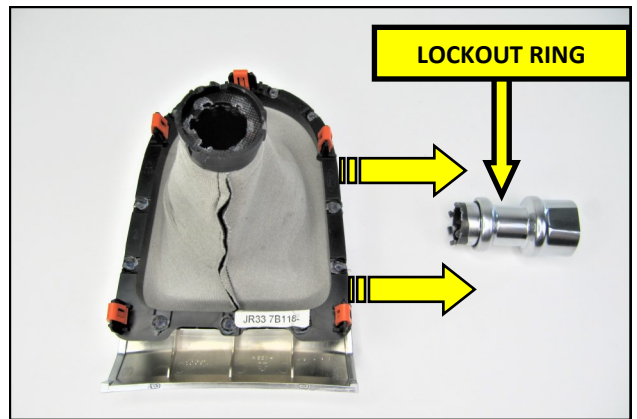

8. Remove the lockout ring from the shift boot and discard it. It will not be reused.

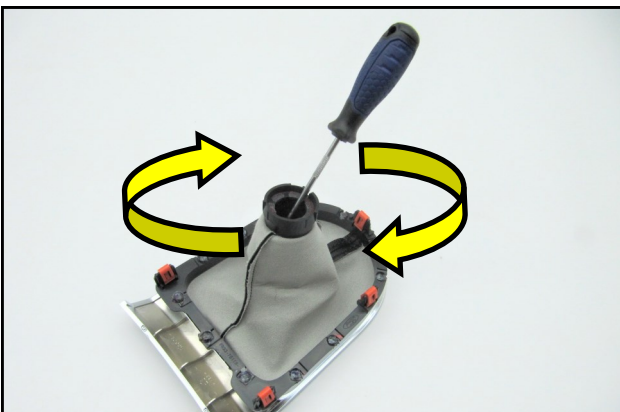

9. Using an o ring pick or equivalent, carefully break the bond between the shift boot and boot ring.

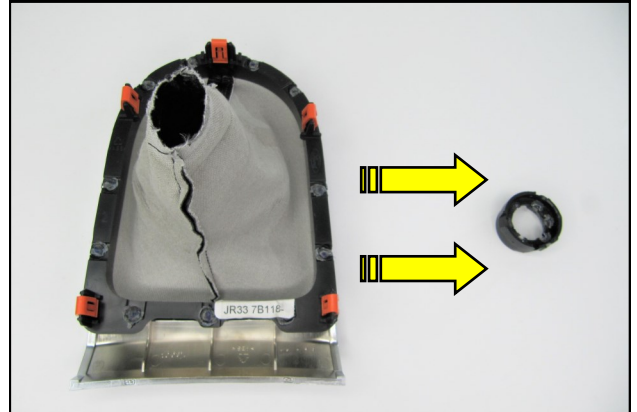

10. Discard the shift boot ring. It will not be reused.

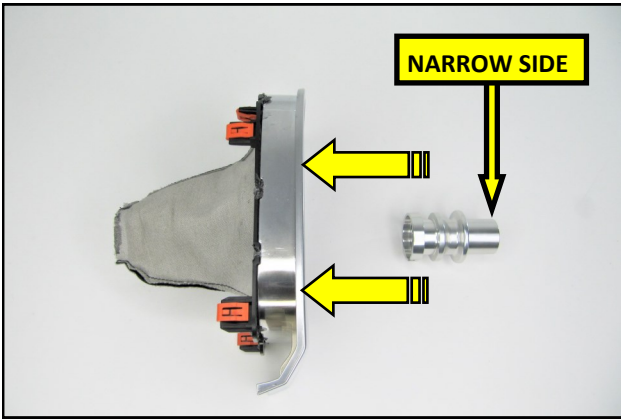

**11.** Insert the RTR Reverse Lockout Collar into the shift boot as shown.

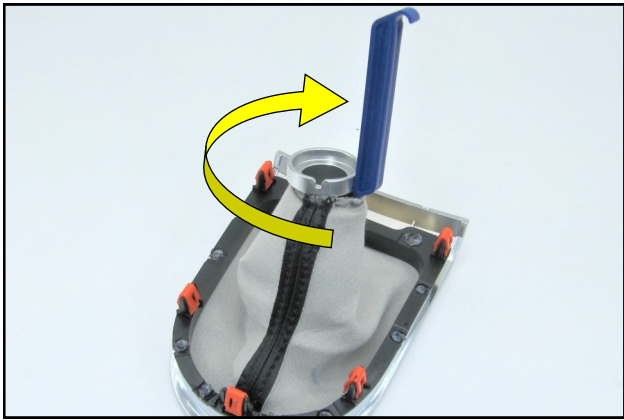

**12.** Using a small plastic trim tool, push the first tier of the Lockout collar through the boot as shown. **HINT:** Using soapy water as a lubricant will ease installation.

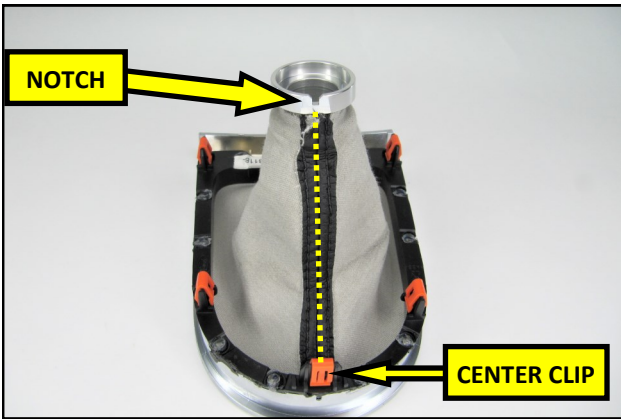

**13.** Rotate the Collar inside the shift boot to align the notch with the center retainer clip in the bezel as shown.

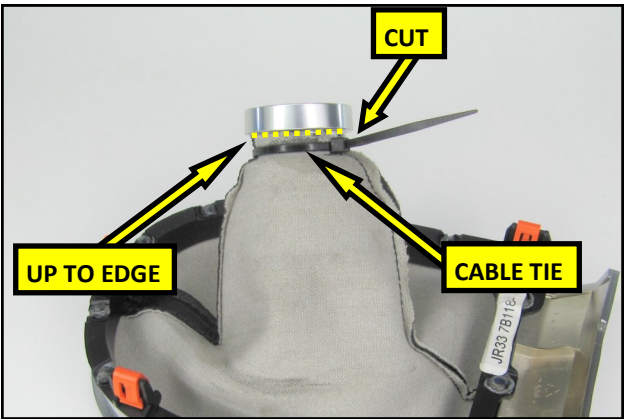

**14.** Pull the boot up to, and completely around the edge of the RTR Collar. Use the supplied Cable Tie to secure the shift boot to the Collar as shown. Trim the excess length.



**15.** Driver's view of a properly installed RTR Lockout Collar.

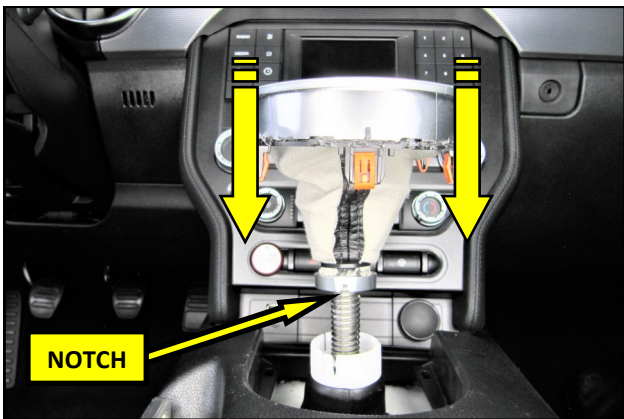

**16.** Slide the Lockout Collar onto the shifter as shown, with the notch from step 13 facing rearward.

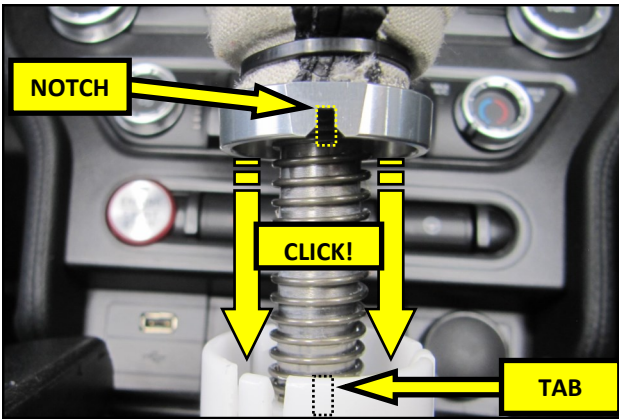

**17.** Lower the RTR Collar down into the OEM shift boot lock ring while guiding the notch over and onto the alignment tab inside the ring. Reconnect the 2 wire accent light harness if so equipped.

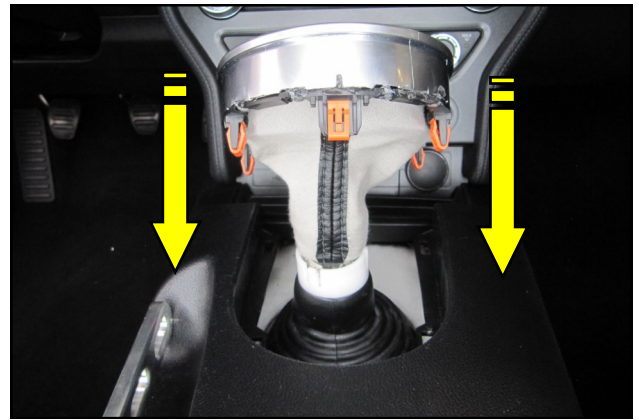

**18.** Align the retention clips on the bezel with the slots in the console and carefully reinstall the bezel assembly.

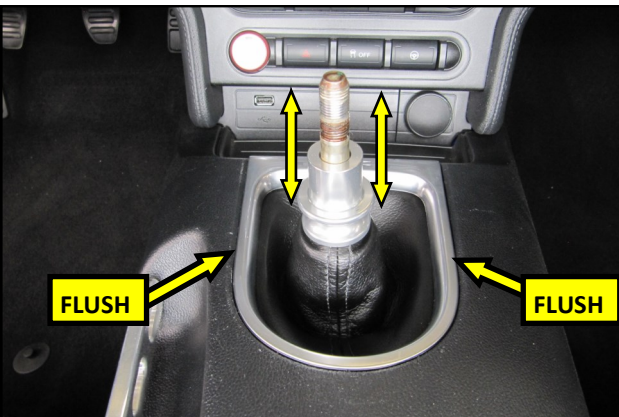

**19.** When properly installed, the bezel will be flush with the console and the lock out collar action is smooth.

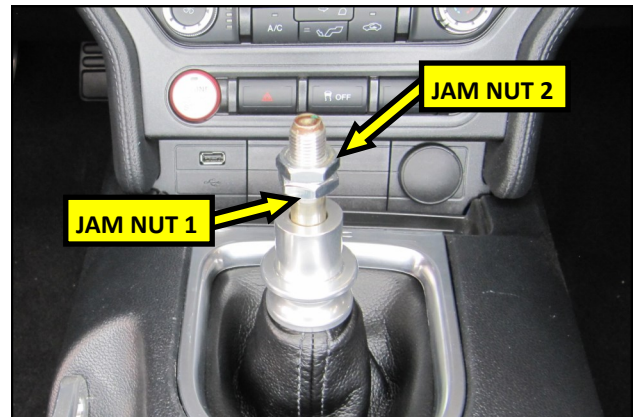

**20.** Thread the supplied Jam Nuts, by hand, all the way down the shaft as shown.



**21.** Thread the RTR Shift Knob onto the shaft until it contacts the Jam Nuts. Observe the positioning of the RTR logo. In most cases, the proper position will need to be established by adjusting the Jam Nuts upward.

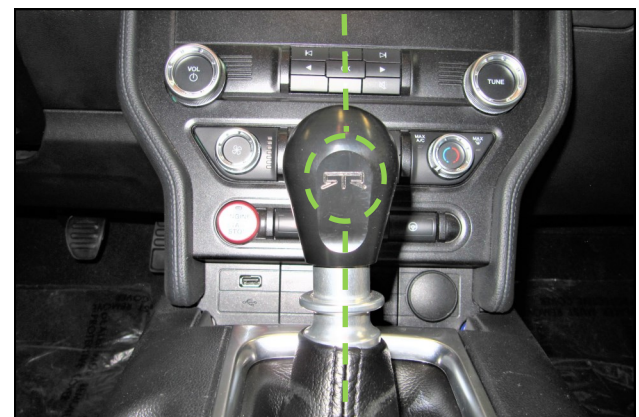

**22.** Adjust the upper Jam Nut until the Shift Knob is properly clocked. Once proper positioning is achieved, remove the Shift Knob and adjust the lower Jam Nut up against the top Nut. Snug the Jam Nuts together using a pair of 19 mm Wrenches. Reinstall the Shift Knob and verify the action of the reverse lock out with the engine running. Readjust the Jam Nut positions if necessary.