



ATS-POL-GEN General Turn Signal System

Thank you for purchasing XTC Power Products Automatic Self-Canceling Turn Signal System. Our Easy Install Turn Signal System is unique from the other kits on the market. This kit is from our Plug & Play™ product line, no wires to cut, no crimping with only power, ground and plugs into the OEM Tail Light Harness, utilizing the brake lights as Brake and Turn Signals.

Please read the instructions fully and familiarize yourself with the components before starting the install.

1. Remove the hood, and center console inspection panel on the passenger side by removing the three fasteners



2. Mount the Control Module on the flat area above the over flow bottle using self-tapping screw provided



WARNING! Make sure to keep the harness away from any hot or moving parts

3. Under the rear bed is the OEM rear tail light harness, unplug the connector and plug our long harness into it. Run the 4 Pin connector to the front of the car. Follow the air intake tube down to the center of the car, the cable can be pulled through the inspection area in the cab up the fire wall through the rubber grommet. Insert this connector into the Control Modules mating connector.



WARNING! Verify that there is clearance where you want to mount the front LED lights before drilling the holes.

- The front LED Turn Indicators can be mounted with the rubber grommet or without. If the grommet is **not** being used drill 5/8" holes. If the grommet is being used drill 3/4" holes. Remove and install the rubber grommet from the LED into the hole if being used. Insert LED into the hole with the Top marking up. NOTE: the TOP marking is on the front of the LED lens. The Lights may be mounted anywhere on the front of the car, for the sample we chose the corner of the trim because it can be seen from both the front and side of the car, **however the clearance is very tight**. If choosing this location use the rubber grommet as a template and mark as far forward and as low as you can to avoid lip on inside.

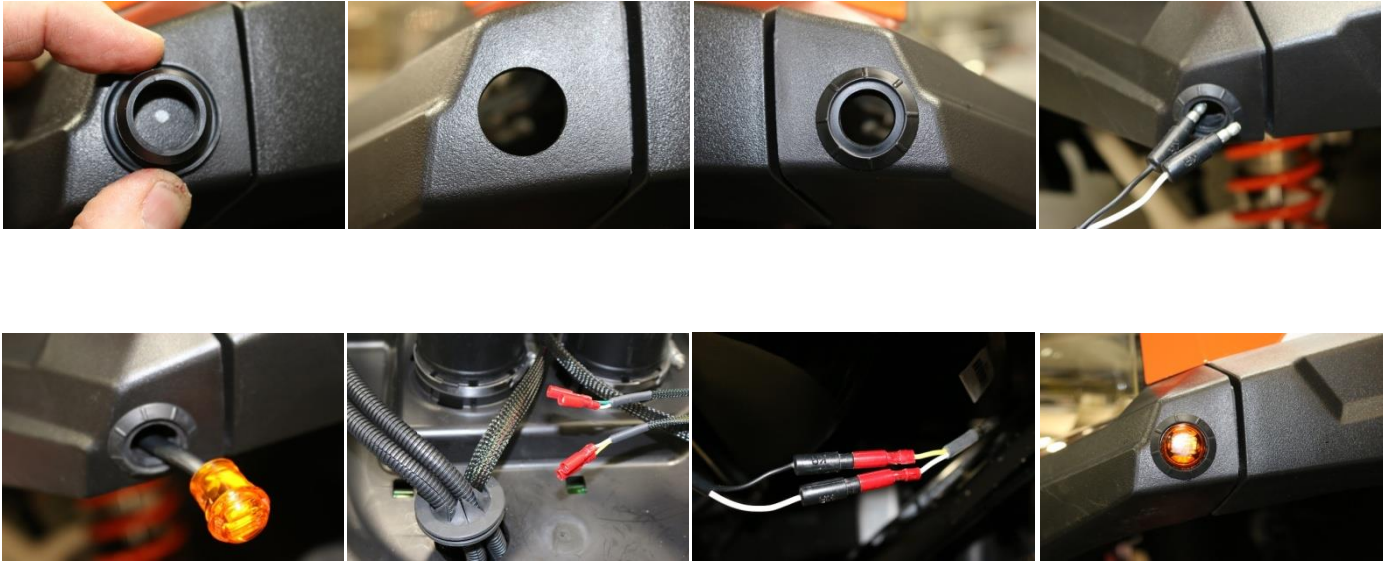

- Plug the short Front Harness into the Control Module. Run the front right and left wire harness through the center grommet as shown, the green and white wire go to the right side of the car and the yellow and white go to the left side, connect the green wire to right black wire and yellow wire to left black wire and white to white on both. **NOTE: The Black LED wire is positive and goes to the yellow and green wires, they will not work if reversed, white is ground. Secure the Harness using the provided cable ties.**
- Install the Turn and Horn/Hazard Switches. The switch cutout can be cut in the dash or the switch panel can be removed by pushing down and out on it as shown. Using a new sharp razor, cut two switch rectangles out. Do not over cut, try inserting switch and trim as necessary. It helps to rock the razor to cut.



7. Run Switch Harness - Push the 10 pin Horn connector through the grommet in center, then push the 8-pin Turn switch connector through. Note: The grommet can be removed and stretched over the switch connector and reinstalled. Run the connectors through the rectangle switch cutouts and use included grease (see step 9) then connect to turn switch and slide switch into dash as shown.



8. **Dielectric Grease** - Just like the OEM uses on their switches, we recommend using Dielectric Grease on all switch terminals, this keeps the water out, thereby reducing corrosion and helps increase reliability! Open the grease and put on the switch terminals and the connector terminals on both the Turn and Horn switches, the more the better.



9. Install the Horn. Using two pairs of pliers bend the horn mounting bracket into a Z bend as shown. Mount onto the horn, using the included #10 x 1" screw, mount the horn into the hole closest to the front left area as shown.



Connect the violet wire to one of the horn terminals and the black wire provided to the other terminal, run the black wire over to Buss Bar and attach to ground. If the car has not been upgraded with the Buss Bar Power Up Kit or Winch Kit, then the black wire will need to be grounded to the buss bar mounting screws

10. Plug the power cable into the Control Module and run over to the factory Busbar.

11. Mount the fuse holder on the fire wall using the provided self-tapping screw as shown below.
12. Attach the Red Wire to the 12vdc accessory stud on the bus bar, also attach the black wire to ground, see note!



Note: The car does not have ground hooked on any of the studs under the hood unless the Bus Bar Power Up kit or Winch kit are installed, the first stud is keyed 12vdc, second stud is ground if wired and the third stud in battery direct if installed, but no fuse or circuit breaker. You must run a ground wire from the chassis to the ground stud or run our black ground wire directly to the chassis for a ground if upgrade is not installed

13. Verify operation of all lights.

Operation: The System uses momentary switches to activate. Press Right or Left Actuator accordingly. Will cancel as follows.

Press 1 Second for Lane Change, will stay on approx. 8 Seconds / 10 Flashes

Press 2 Seconds for Slowing to Turn Corners, will stay on approx. 20 Seconds / 30 Flashes

Press 5 Seconds for Traffic Lights when stopping and waiting, will stay on approx. 75 Seconds / 110 Flashes

The Systems Automatic Self-Cancelling may be overridden/Shut Off at any time by pushing the activated switch.

Hazard Lights - press to activate and press again to deactivate, it does not self-cancel.

14. Using the provided Cable Tie's secure the harness completely. Reinstall removed parts

Optional - The Tan wire next to the Turn Switch is for an optional Dash Indicator. When the ATS is activated it will flash 12 VDC that can be attached to an Optional Dash Mounted LED Light.

For more details on installation go to www.xtcinstall.com

We can also be reached by email at support@xtcpowerproducts.com

XTC Power Products
A Division of XTC Motorsports LLC
380 E Comstock Dr.
Chandler AZ 85225
480-558-8588
www.xtcpowerproducts.com

*Disclaimer: This kit is intended for off road use only and XTC Motorsports claims no responsibility for it use. It is up to the purchaser to make sure it complies with all Federal, State and Local laws.

R2