

SAFETY NOTE

1. This appliance can be used by children aged from 8 years and above and persons with reduced physical, sensory or mental capabilities or lack of experience and knowledge if they have been given supervision or instruction concerning use of the appliance in a safe way and understand the hazards involved.
2. Children shall not play with the appliance.
3. Cleaning and user maintenance shall not be made by children without supervision.
4. If the supply cord is damaged, it must be replaced by the manufacturer, its service agent or similarly qualified persons in order to avoid a hazard.
5. **WARNING:** the drive shall be disconnected from its power source during cleaning, maintenance and when replacing parts.
6. The instructions shall state that the A-weighted emission sound pressure level of the drive is equal to or less than 70 dB(A), e.g. by writing $LpA \leq 70 \text{ dB(A)}$.
7. The mass and the dimension of the driven part shall be compatible with the rated torque and rated operating time.
8. The type of driven part the drive is intended for.
9. **WARNING:** Important safety instructions. It is important for the safety of persons to follow these instructions. Save these instructions.
10. Do not allow children to play with fixed controls. Keep remote controls away from children.
11. Frequently examine the installation for imbalance and signs of wear or damage to cables and springs. Do not use if repair or adjustment is necessary.
12. Watch the moving shutter and keep people away until the shutter is completely closed.
13. **WARNING:** Important safety instructions. Follow all instructions, since incorrect installation can lead to severe injury.
14. Before installing the drive, remove any unnecessary cords and disable any equipment not needed for powered operation.

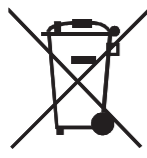

Li-ion



Do not dispose of in general waste.
Please recycle batteries and damaged electrical products appropriately.

DM25LEU/S

Instruction | A-07

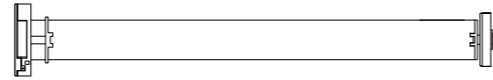

Radio+

Features

- Built-in Receiver
- Jog & Tilt
- Built-in Lithium Battery
- Scan and Program
- Status Feedback
- Switch Direction
- Stall Protection
- Program Button
- Reset to Factory Mode
- Memorized Setting
- Electronic Limit
- Preferred Stop Position
- Speed Regulation
- Scene Control

Fields of Application



The motor is suitable for motorization of roller blinds.

Specifications

Working temperature: $-10^{\circ}\text{C} \sim +50^{\circ}\text{C}$	Radio Frequency: 433.925MHz
Input Voltage: USB 5V 1A / USB 5V 2A	Maximum Running Time: 6 minutes

* For more motor models and specific torque, please refer to the nameplate.

Attention

Never drop, knock, drill or submerge the motor. Keep the power cable in right position as following. Important safety instructions to be read before installation.

Incorrect installation can lead to serious injury and will void manufacturer's liability and warranty.

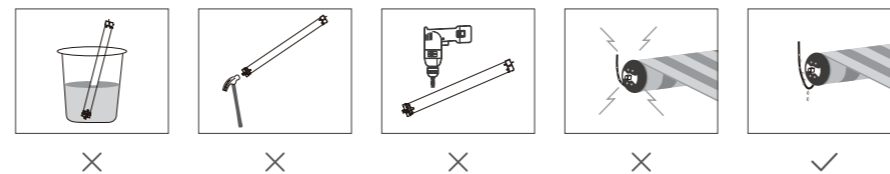

Charging Instructions

Micro-USB Port

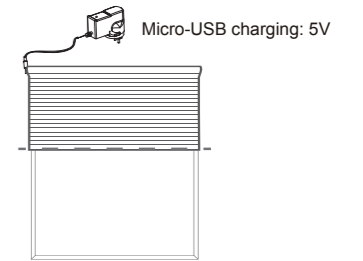
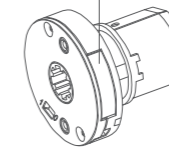

This motor has a built in Li-ion battery pack with integrated charge management.
Max power input for recharging: 5V 2A.
Before first use please charge motor for 6 hours. Using 5V charger (most phones charger is 5V).
During operation, when the motor starts, the buzzer will beep 10 times, indicating a low-voltage alarm and needs to be charged.
During operation, the voltage was detected to be too low, the battery was about to run out, the battery stopped running and needed to be recharged.

Rechargeable Battery



Blinking red:
Low battery alert



Blinking green:
Charging is processing



Solid green:
Battery has finished charging.

Motor Installation

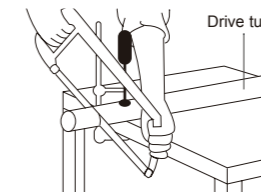

Step 1 Cut drive tube to required length.

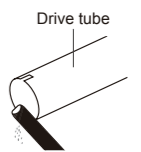

Step 2 Ensure tube edge is clean and burr-free.

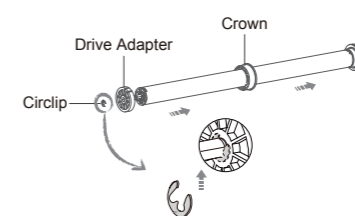

Step 3 Mount correct crown & drive adapter on the motor. Make sure drive adapter fits firmly and crown rotates freely.

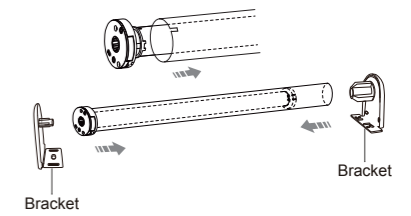

Step 4 Align the notches on the crown and drive adapter with the drive tube, slide and fit the motor into drive tube. Mount idler and bracket on both ends.

Caution

1. Do not expose motor to humid or extreme temperature conditions.
2. Do not drill into motor.
3. Do not cut the antenna and keep it clear from metal objects.
4. Do not allow children to play with this device.
5. If power cable or connector is damaged, do not use.
6. Ensure correct crown and drive adaptor are used.
7. Ensure power cable and aerial is clear and protected from moving parts.
8. Cable routed through walls shall be properly isolated.
9. Motor is to be mounted in horizontal position only.
10. Before installation, remove unnecessary cords and disable equipment not needed for powered operation.
11. Installation and programming to be performed by a qualified professional, use or modification outside the scope of this instruction may void warranty.

Important Safety Instructions To Be Read Prior To Operation.

Setting Notice

Please read following points of attention carefully before setting.

- Don't operate motors when low voltage alarm.
- Operating:
 - The valid interval of the emitter button is 10S, the emitter will quit the set after 10S.
 - The motor will run or beep for hint, please do the next step after the hint.
- Set the limit position:
 - After the upper / lower limit setting, and the upper / lower limit position can't at the same position.
 - After the limit setting, with power off and memory function.
 - Limit delete will clear all limit memory.
 - It will exit limit setting when program there is no operation for 2 minutes.
- If the emitter lost, please set up again with the new emitter.
- One motor can store maximum 10 channels; after fully stored, if pair new channels, only the last one will be covered circularly.

Button Instructions

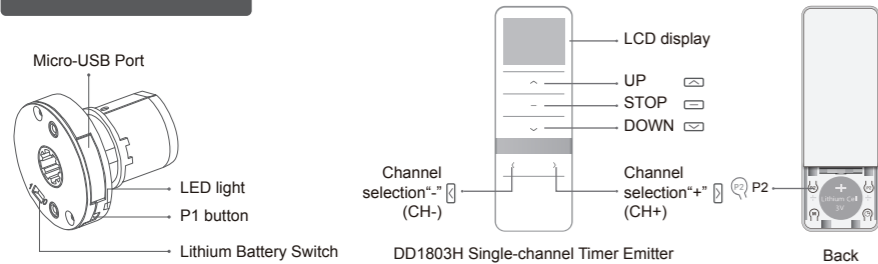

*Dial lithium battery switch, 0 is off switch, 1 is turn on switch.

Functions of P1 button

- Cycle Operation: Press P1 button once and every press the motor will run upward → stop → downward circularly.
- Pairing or Pair Additional Emitter: Press P1 button for 2S, motor jog once, release button and make a long noise, motor is ready for pairing or pair additional emitter.
- Radio Lock: Press and hold P1 button for 6S, the motor will jog twice, release button and beep twice, the motor enters radio lock status, the motor won't receive any signal; press P1 button once to disable Radio Lock.
- Switch Direction: Press and hold P1 button for 10S, the motor will jog 3 times, release button and beep 3 times, the running direction of the motor has been changed.
- Reset to Factory Mode: Press and hold P1 button for 14S, the motor will jog 4 times, release button and beep 4 times, the motor has been reset to factory mode. At this point the motor will go into deep sleep. After entering deep sleep, the motor can't be controlled. At this time, you need to press P1 button for 2S and then the motor turns to prompt to exit deep sleep.

Essential Settings

The steps in factory mode must be completed to ensure proper operation.

Factory mode

1 Pairing

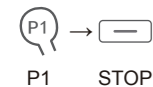

Press P1 button for 2S (1 jog), release button and make a long noise, Or turn the DIP switch to "0" and then to "1" (1 jog and make a long noise), repower the motor, within 10S, press STOP for 2S (2 jogs and 3 beeps), the motor has been paired successfully.

* If within 10S, the motor doesn't receive STOP signal from the any emitter, it will exit the pairing mode automatically. Re-power on after power off, if the motor has saved the emitter, there is no rotation prompt, and the code matching status is not automatically entered at this time.

2 Switch Rotating Direction (Optional)

If press UP, the motor runs downward, try below to switch direction



Press and hold UP and DOWN buttons simultaneously for 2S, motor jog once, the direction has been switched successfully.

* The operation is only valid when there is no limits. If the motor has already set the upper and lower limit, then you can only switch direction by P1 button.

3 Upper and Lower Limits Setting

1 Set upper limit



Press UP for 2S, operate the motor to desired upper limit position, press and hold UP and STOP buttons simultaneously for 2S (2 jogs and 3 beeps), upper limit is set.

* If exit the limits setting status before you finish the limit setting, then the motor will take the previous limits if has; After the limits have been set successfully, the motor will enter the user mode.

2 Set lower limit



Press DOWN for 2S, operate the motor to desired lower limit position, press and hold DOWN and STOP buttons simultaneously for 2S (2 jogs and 3 beeps), lower limit is set.

User mode

1 Add A Preferred Position

1 Set preferred position

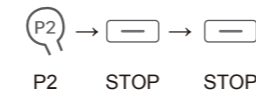

Check both upper and lower limits are set. Operate the product to desired preferred position. Press P2 (1 jog and 1 beep), press STOP (1 jog and 1 beep), STOP again (2 jogs and 3 beeps), the preferred position is set.

* Press STOP for 2S, the motor moves to preferred position automatically.

2 Remove preferred position



Press P2 (1 jog and 1 beep), press STOP (1 jog and 1 beep), STOP again (1 jog and make a long noise), the preferred position is deleted.

2 Jog Mode & Running Mode Switch



Press and hold UP and DOWN buttons simultaneously for 5S (1 jog), press STOP (1 jog and make a long noise), switch to jog mode, if motor jog twice and beep 3 times, switch to running mode.

* When in jog mode, press UP or DOWN once, the motor will be jog running, if press more than 2 second, the motor will be continuously running.

3 Adjust Limits

1 Adjusting the upper limit



Press and hold UP and STOP buttons for 5S (1 jog and make a long noise), operate the product to desired new upper limit position, press and hold UP and STOP buttons for 2S (2 jogs and 3 beeps), the new upper limit is programmed successfully.

2 Adjusting the lower limit



Press and hold DOWN and STOP buttons for 5S (1 jog and make a long noise), operate the product to desired new lower limit position, press and hold DOWN and STOP buttons for 2S (2 jogs and 3 beeps), the new lower limit is programmed successfully.

* After entering the limits fine tuning mode, the original preferred position will not be deleted; If there is no button operation within 2 minutes, it will arrive within 2 minutes, and the motor will turn to prompt, and automatically exit the route adjustment mode; When fine-tuning the limit, press and P1 for more than 2S to exit the mode.

4 Pair / Unpair Additional Emitter

Method one

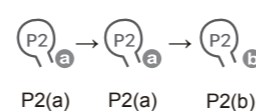

Press P2 (1 jog and 1 beep) and P2 (1 jog and 1 beep) on existing emitter, press P2 on new emitter to add (2 jogs and 3 beeps), new emitter is paired to the motor.

* Repeat same procedure will unpair additional emitter.

Method two

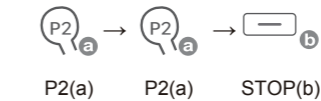

Press P2 (1 jog and 1 beep) and P2 (1 jog and 1 beep) on existing emitter, press STOP on new emitter for 2S to add (2 jogs and 3 beeps), new emitter is paired to the motor.

Method three

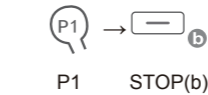

Press P1 button for 2S (1 jog), release button and make a long noise, press STOP on new emitter for 2S to add (2 jogs and 3 beeps), new emitter is paired to the motor.

* Repeat same procedure will unpair additional emitter.

* (a) as existing emitter, (b) as new emitter to pair/unpair; Adding the emitter should be carried out when there is a limits; All the setting of the motor will be kept after adding the new emitter.

5 Speed Regulation / Setting Motor Slow Stop Operation Mode

1 Acceleration setting / Activate the motor slow stop operation mode



Press P2 (1 jog and 1 beep), press UP (1 jog and 1 beep), UP again (2 jogs and 1 beep), the motor running speed is accelerated. When the motor is at the Max. speed, the motor jogs once and make a long noise after the last operation, and the motor slow stop operation mode is activated.

2 Deceleration setting / Deactivate the motor slow stop operation mode



Press P2 (1 jog and 1 beep), press DOWN (1 jog and 1 beep), DOWN again (2 jogs and 1 beep), the motor running speed is decelerated. When the motor is at the Min. speed, the motor jogs once and beep once after the last operation, and the motor slow stop operation mode is deactivated.

* The motor has 3 speed levels, the Max. speed: 28rpm; the Med. speed: 24rpm; the Min. speed: 20rpm. the factory default is 28rpm, slow stop mode (only works after the limits setting).

Quick Index

	Settings	Steps
1	Pairing	P1 (hold down 2s) → Stop (hold down 2s)
2	Switch Rotating Direction	Up + Down (hold down 2s)
3	Upper and Lower Limits Setting	1 Set upper limit Up (hold down 2s) → Up + Stop (hold down 2s)
	2 Set lower limit	Down (hold down 2s) → Down + Stop (hold down 2s)
4	Add / Remove Preferred Position	P2 → Stop → Stop
5	Jog Mode & Running Mode Switch	Up + Down (hold down 5s) → Stop
6	Adjust Limits	1 Adjusting the upper limit Up + Stop (hold down 5s) → Up or Down → Up + Stop (hold down 2s)
	2 Adjusting the lower limit	Down + Stop (hold down 5s) → Up or Down → Down + Stop (hold down 2s)
7	Pair / Unpair Additional Emitter	1 Pair / Unpair Additional Emitter P2(a) → P2 (a) → P2(b)
	2 Pair Additional Emitter	P2(a) → P2 (a) → Stop (b) (hold down 2s)
	3 Pair / Unpair Additional Emitter	P1 (hold down 2s) → Stop (b) (hold down 2s)
8	Speed Regulation / Setting Motor Slow Stop Operation Mode	1 Acceleration setting / Activate the motor slow stop operation mode P2 → Up → Up
	2 Deceleration setting / Deactivate the motor slow stop operation mode	P2 → Down → Down

Troubleshooting

Issues	Possible causes	Solution
The motor has no response	Battery in motor is depleted	Recharge with compatible AC adaptor
	Power Failure Or Incorrect Connection	Double check power and cable connections, follow wiring instructions.
	emitter battery is low capacity	Replace battery
	Radio interference / shielding	Check antenna on motor is intact and exposed. Check for possible source of radio interference.
The emitter can't control single motor	Out of radio control range	Try control within closer range
	Multiple motors are paired to the same channel.	Pair single motor with emitter correctly Try to use multi-channel emitters to control multi-motor projects, ensure each channel to control one single motor
The motor doesn't run or starts too slowly or make loud noise	Connections are incorrect.	Check connections
	Installation is improper or overload	Check installation or overload
The motor stops during the up and down running	The motor has reached the lower limit	Adjust the new lower limit
	The running time more than 6min	Consult the sales for more information