

SAFETY NOTE

- This appliance can be used by children aged from 8 years and above and persons with reduced physical, sensory or mental capabilities or lack of experience and knowledge if they have been given supervision or instruction concerning use of the appliance in a safe way and understand the hazards involved.
- Children shall not play with the appliance.
- Cleaning and user maintenance shall not be made by children without supervision.
- If the supply cord is damaged, it must be replaced by the manufacturer, its service agent or similarly qualified persons in order to avoid a hazard.
- WARNING:** the drive shall be disconnected from its power source during cleaning, maintenance and when replacing parts.
- The instructions shall status that the A-weighted emission sound pressure level of the drive is equal to or less than 70 dB(A), e.g. by writing $LpA \leq 70$ dB(A).
- The mass and the dimension of the driven part shall be compatible with the rated torque and rated operating time.
- The type of driven part the drive is intended for.
- WARNING:** Important safety instructions. It is important for the safety of persons to follow these instructions. Save these instructions.
- Do not allow children to play with fixed controls. Keep remote controls away from children.
- Frequently examine the installation for imbalance and signs of wear or damage to cables and springs. Do not use if repair or adjustment is necessary.
- Watch the moving shutter and keep people away until the shutter is completely closed.
- WARNING:** Important safety instructions. Follow all instructions, since incorrect installation can lead to severe injury.
- Before installing the drive, remove any unnecessary cords and disable any equipment not needed for powered operation.

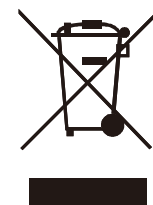

DT82TV/SNA

Instruction | A-04



Product Introduction

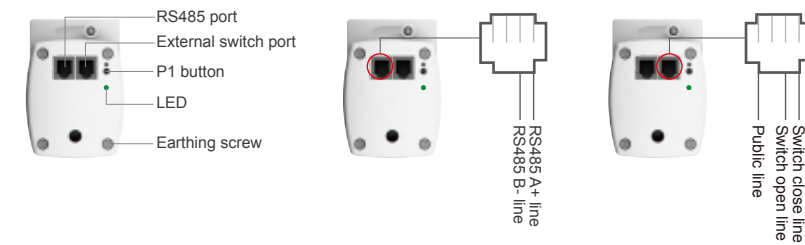

Features

- Built-in Receiver
- Stall Protection
- Preferred Stop Position
- External Switch Function
- Switch Direction
- Manually Set The Open And Close Limits
- RS485 Control
- Electronic Limit
- Run/stop By Pulling Fabric
- Reset To Factory Mode

Fields of Application

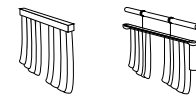

The motor is suitable for motorized curtain and motorized lift curtain.

Specifications

| | |
|--|--|
| Working Temperature: -10°C ~ +55°C | Radio Frequency: 433.925MHz |
| Input voltage: AC 100V-240V, 50Hz / 60Hz | Maximum continuous running time: 4 minutes |

* For more motor models and specific torque, please refer to the nameplate.

Caution

- Do not expose motor to humid or extreme temperature conditions.
- Do not cut the antenna and keep it clear from metal objects.
- Do not allow children to play with this device.
- If power cable or connector is damaged, do not use.
- Ensure power cable and aerial are clear and protected from moving parts.
- Cable routed through walls shall be properly isolated.
- Before installation, remove unnecessary cords and disable equipment not needed for powered operation.
- Installation and programming to be performed by a qualified professional, use or modification outside the scope of this instruction may void warranty.

Motor Installation

- 1 The joint assembly of track**
 - Track joint board
 - Track joint bracket
 - S track
 - Fix the screws

Note: 1. The track needs to be engraved when the length is less than required.
2. The track needs to be engraved when inconvenient to transport.

The following steps pls refer to "the assembly of rubber belt and track"

- 2 The assembly of rubber belt for curtain motor**

The confirmation of profiled material dimension

DT82TV/SNA

The cap length 7cm

The length of profiled material = The total length of track - The cap length × 2

The total length of track is 2m

The length of profiled material: 200cm-14cm=186cm

- Use the screw driver to place the parts like the gear into the lower cover
- Refer the complete lower cover in below picture
- Thread the rubber belt into the lower cover
- Fix the cut rubber belt end with the belt fasten button
- Leave half teeth
- Install the clip part like the reference picture and insert the track into the lower cover
- Slide the slip part to the other end to be flush with the head rail. Cut the other end of rubber belt with 12cm left

- The marked position is in the middle of the slip parts. Half of the slip parts are in the head rail as in the picture
- Leave one teeth between these two belt fasten button
- Install the belt fasten button and the slip part as in the picture

- After one slip part installed, then thread the other end of the belt through the other lower cover
- Install the belt fasten button and the slip part as in the picture
- These two slip parts is successfully installed
- Slide the runners into the track
- The runner are installed
- Place the hook and the upper cover into the track

3 Folding method for joint track (for easy transit)

- Track folding method**
 - Search for the slip part connected with the ends of the rubber belt
 - Take off the screw of the slip parts and the connection bracket
 - Push the connection parts to one side
 - Pull the slip parts slightly and separate the connection part at the same time
 - Fold the track

- Restoring the track**
 - Unfold the folded track
 - Combine the track slowly
 - Push the connection bracket to the connection part
 - Screw the connection bracket and install the slip parts
 - The track is successfully assembled

4 Curtain Motor Installation

- Check the position of brackets, fix it at an appropriate place on the track
- Assemble the curtain motor track at appropriate place, then fix with screws
- Assemble the motor
- Check whether the assembling is OK
- Finish assembling

5 Strong-current Switch installation

Strong-current Switch mode 1 & mode 3:

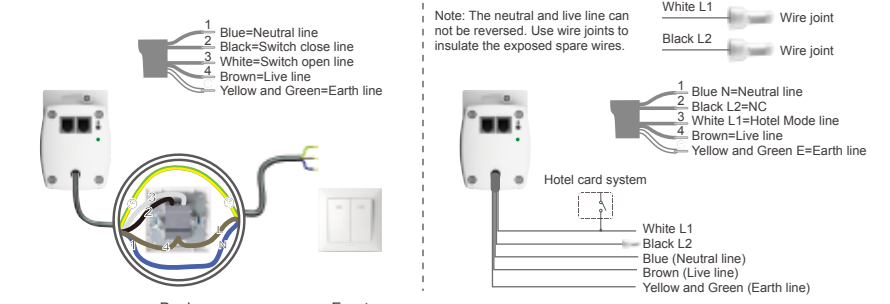

* More information refer to Strong-current Switch Modes.

Important Safety Instructions To Be Read Prior To Operation.

Setting Notice

Please read following points of attention carefully before setting.

- Operation:**
 - The valid interval time of the buttons is within 10S, if there is no operation within 10S, the emitter will exit the present setting.
 - The motor will LED flashes as hint, pls operate after the LED flashes.
- Limits setting:**
 - After the curtain motor installation, pls set the limit switch before usage;
 - After setting the limit switches, the motor is with the memorized setting function, pls open and close curtain one time to recover the limits after re-power on;
 - After replacing the track or the curtains, pls cancel the limit switches then resetting again.
- If lost the emitters, pls repair the new emitters.
- Lightly open and lightly close: when the curtain is running, the running speed is from slow to fast, and when it is close to the limit position, the speed is from fast to slow, and the action is more elegant.
- Stall detection: The motor will stop automatically when it encounters resistance during operation to avoid accidents. If the motor encounters resistance at the same point three times in a row, use this point as the reference point to correct the limit, but the total limit length remains unchanged.
- One motor can store maximum 10 channels; after fully stored, if pair new channels, only the last one will be covered circularly.

Button Instructions

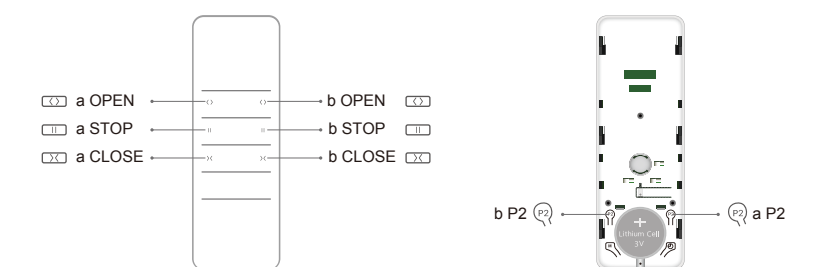

* A channel is the same operation as B channel.



Essential Settings

Step 1 to 3 must be completed to ensure proper operation.

1 Pair / Delete Additional Emitter

Method 1

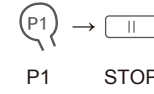

Press and hold P1 button for 2S (LED flashes once), release button, press STOP for 2S (LED flashes 5 times), new emitter is paired to the motor.

• Repeat same procedure will delete additional emitter.

Method 2

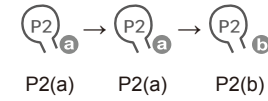

Press P2 (LED flashes once) and P2 (LED flashes once) on existing emitter, press P2 on new emitter to add (LED flashes 5 times), new emitter is paired to the motor.

• Repeat same procedure will delete additional emitter.

2 Switch Rotating Direction (Optional)

Press OPEN and motor is closed, try below to switch direction.

Method 1

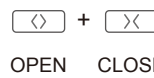

Press and hold OPEN and CLOSE buttons simultaneously for 2S (LED flashes 5 times), the direction has been switched successfully.

* This method is valid only when the motor has no limit.

Method 2

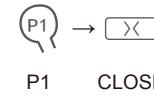

Press and hold P1 button for 10S (LED flashes 3 times), release button, press CLOSE once (LED flashes 5 times), the direction has been switched successfully.

3 Setting Limits

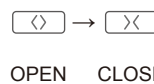

Press OPEN once, the curtain will open until stop against obstacle, then press CLOSE once, the curtain will close until stop against obstacle. The limit has been set successfully.

4 Manually Set The Open And Close Limits

1 Adjusting the open limit



STOP OPEN OPEN CLOSE STOP OPEN

After limits have been set, after running the curtain to the position where the curtain needs to be set, press and hold OPEN and STOP buttons simultaneously for 5S (LED flashes once), press OPEN or CLOSE to adjust to the open limit position that needs to be set, press and hold OPEN and STOP buttons simultaneously for 2S (LED flashes 5 times), the new open limit has been set successfully.

* This operation needs to be set up within 2 minutes.

2 Adjusting the close limit



STOP CLOSE OPEN CLOSE STOP CLOSE

After limits have been set, after running the curtain to the position where the curtain needs to be set, press and hold CLOSE and STOP buttons simultaneously for 5S (LED flashes once), press OPEN or CLOSE to adjust to the close limit position that needs to be set, press and hold CLOSE and STOP buttons simultaneously for 2S (LED flashes 5 times), the new close limit has been set successfully.

* This operation needs to be set up within 2 minutes.

5 Add / Delete A Preferred Position

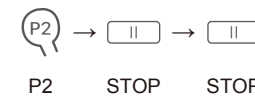

* Press STOP for 2S, the motor moves to preferred position automatically.

Check limits are set. Press OPEN or CLOSE, operate the product to desired preferred position. Press P2 (LED flashes once), press STOP twice (LED flashes 5 times), the preferred position is set.

• Repeat this operation to delete the preferred position.

6 Radio Emitter Function



Press and hold P1 button for 6S to disable the radio emitter function. Short press P1 button to enable the radio emitter function.

7 Remove All Limits

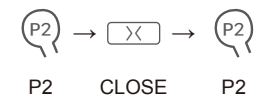

Press P2 (LED flashes once), CLOSE (LED flashes once), and P2 (LED flashes 5 times), all limits are removed, and the manually set open and close limits and the preferred position will also be deleted.

8 Run/Stop By Pulling Fabric

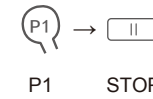

* The factory default Run/Stop by pulling fabric is enabled.

Press and hold P1 button for 10S (LED flashes 3 times), release button, press STOP (LED flashes 5 times), disable the Run/Stop by pulling fabric.

• Repeat this operation to enable the Run/Stop by pulling fabric.

9 Set RS485 Address

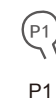

Press and hold P1 button for 10S (LED flashes 3 times), release button, the motor will automatically send RS485 request command and enter RS485 address setting mode.

10 Weak-current Switch Modes

1 Dual button pushbutton switch mode (Factory default)

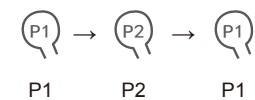

Press and hold P1 button for 10S (LED flashes 3 times), release button, press P2 button once (LED flashes once), then press and hold P1 button for 2S (LED flashes 5 times), the mode has been successfully switched.

2 Dual button interlock switch mode

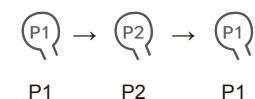

Press and hold P1 button for 10S (LED flashes 3 times), release button, press P2 button twice (LED flashes twice), then press and hold P1 button for 2S (LED flashes 5 times), the mode has been successfully switched.

3 DC246 switch mode

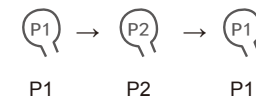

Press and hold P1 button for 10S (LED flashes 3 times), release button, press P2 button 3 times (LED flashes 3 times), then press and hold P1 button for 2S (LED flashes 5 times), the mode has been successfully switched.

4 Single button pushbutton switch mode

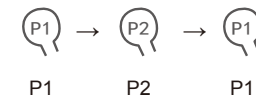

Press and hold P1 button for 10S (LED flashes 3 times), release button, press P2 button 4 times (LED flashes 4 times), then press and hold P1 button for 2S (LED flashes 5 times), the mode has been successfully switched.

11 Strong-current Switch Modes

1 Dual button interlock switch mode (Factory default)

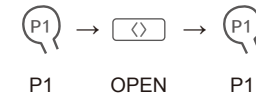

Press and hold P1 button for 10S (LED flashes 3 times), release button, press OPEN button once (LED flashes once), then press and hold P1 button for 2S (LED flashes 5 times), the mode has been successfully switched.

2 Hotel mode

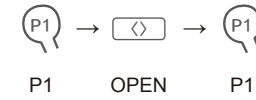

Press and hold P1 button for 10S (LED flashes 3 times), release button, press OPEN button twice (LED flashes twice), then press and hold P1 button for 2S (LED flashes 5 times), the mode has been successfully switched.

3 Dual button pushbutton switch mode

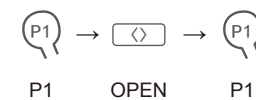

Press and hold P1 button for 10S (LED flashes 3 times), release button, press OPEN button 3 times (LED flashes 3 times), then press and hold P1 button for 2S (LED flashes 5 times), the mode has been successfully switched.

12 Forwarding Function

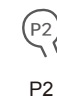

Press and hold P2 button for 5S (LED flashes once), the motor enable the forwarding function; if the LED flashes twice, the motor disable the forwarding function.

13 Speed Regulation

1 Acceleration setting

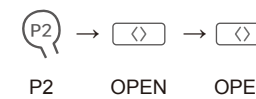

Press P2 (LED flashes once), press OPEN (LED flashes once), OPEN again (LED flashes 5 times), the motor running speed is accelerated. If the LED flashes 10 times, the setting has failed.

2 Deceleration setting

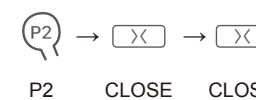

Press P2 (LED flashes once), press CLOSE (LED flashes once), CLOSE again (LED flashes 5 times), the motor running speed is decelerated. If the LED flashes 10 times, the setting has failed.

* The motor has 3 speed levels, the Max. speed: 110r/min; the Med. speed: 90r/min; the Min. speed: 70r/min.

14 Reset to Factory Mode

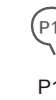

Press and hold P1 button for 14S (LED flashes 5 times), release button, the motor clears all settings and reset to factory status.

Quick Index

| | Settings | Steps |
|----|--|---|
| 1 | Pair / Delete Additional Emitter | P1 (hold down 2S) → Stop (hold down 2S) P2(a) → P2(a) → P2(b) |
| 2 | Switch Rotating Direction | Open + Close (hold down 2S) P1 (hold down 10S) → Close |
| 3 | Setting Limits | Open → Close |
| 4 | Manually Set The Open And Close Limits | 1 Adjusting the open limit Stop + Open (hold down 5S) → Open / Close → Stop + Open (hold down 2S) 2 Adjusting the close limit Stop + Close (hold down 5S) → Open / Close → Stop + Close (hold down 2S) |
| 5 | Add / Delete Preferred Position | P2 → Stop → Stop |
| 6 | Radio Emitter Function | P1 (hold down 6S) |
| 7 | Remove All Limits | P2 → Close → P2 |
| 8 | Run/Stop By Pulling Fabric | P1 (hold down 10S) → Stop |
| 9 | Set 485 Address | P1 (hold down 10S) |
| 10 | Weak-current Switch Modes | 1 Dual button pushbutton switch mode P1 (hold down 10S) → P2 (press once) → P1 (hold down 2S) 2 Dual button interlock switch mode P1 (hold down 10S) → P2 (press twice) → P1 (hold down 2S) 3 DC246 switch mode P1 (hold down 10S) → P2 (press 3 times) → P1 (hold down 2S) 4 Single button pushbutton switch mode P1 (hold down 10S) → P2 (press 4 times) → P1 (hold down 2S) |
| 11 | Strong-current Switch Modes | 1 Dual button interlock switch mode P1 (hold down 10S) → Open (press once) → P1 (hold down 2S) 2 Hotel mode P1 (hold down 10S) → Open (press twice) → P1 (hold down 2S) 3 Dual button pushbutton switch mode P1 (hold down 10S) → Open (press 3 times) → P1 (hold down 2S) |
| 12 | Forwarding Function | P2 (hold down 5S) |
| 13 | Speed Regulation | 1 Acceleration setting P2 → Open → Open 2 Deceleration setting P2 → Close → Close |
| 14 | Reset to Factory Mode | P1 (hold down 14S) |

Troubleshooting

| Issues | Solution |
|---------------------------------------|---|
| Motor does not work | Check power |
| The emitter cannot be controlled | Replace the emitter battery |
| Emitter reverse | Perform the "Switch Rotation Direction" |
| External switch reverse | Replace the wire sequence of the switch |
| The curtains can't close together | a. Check whether the direction of the emitter and switch is reversed. If it is reversed, please follow the "Switch Rotation Direction" b. Delete limit position and reset set limit position itinerary |
| Curtains always hit or go to the side | Delete limit position and reset set limit position and boundary |
| Hand pull curtains will get stuck | Set limit position and boundary |
| The motor against obstacle not stop | Check the fixing screws on the upper and lower covers of the track |