

ROUND STAINLESS STEEL BURNER

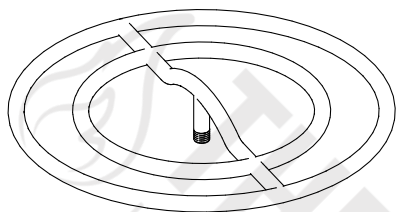

ISOMETRIC VIEW

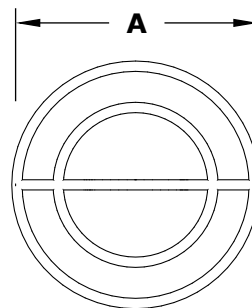

TOP VIEW

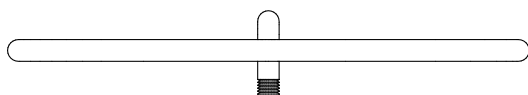

RIGHT SIDE VIEW

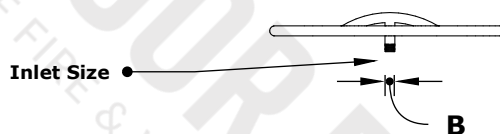

FRONT SIDE VIEW

SKU	A	B	Rings	BTU
OPT-158-5	5"	0.5"	1 Ring	30,000
OPT-158	6"	0.5"	1 Ring	35,000
OPT-158-8	8"	0.5"	1 Ring	45,000
OPT-159	12"	0.5"	1 Ring	65,000
OPT-160	18"	0.5"	2 Rings	160,000
OPT-161	24"	0.5"	2 Rings	190,000
OPT-161-30	30"	0.75"	3 Rings	330,000
OPT-162	36"	0.75"	3 Rings	380,000
OPT-162-48	48" (M)	0.75"	4 Rings	630,000

M = Manifold

Burner Material:
304 Stainless Steel / High Quality Brass

Drawn By	Murguia M.
Date Created	August 12, 2021