



HIGH-EFFICIENCY DIRECT-VENT FURNACES

Enjoy money savings, high-efficiency and the attractive, low-profile, modern appearance of Williams' High-Efficiency Direct-Vent Furnaces. These furnaces require no inside air for operation, making them a safe choice for adding comfort to almost any room. Ideal for homes, apartments, offices, garages and room additions.

FEATURES

- Natural and propane models
- Easy installation
- Attractive, durable fresh-white finish
- Small, low-profile vent size
- Sealed combustion chamber uses no inside air
- Unique wall-mount design requires no floor space
- Air-to-air system offers instant heat.



17,700 BTU/hr.



7,400 BTU/hr.





HIGH-EFFICIENCY DIRECT-VENT FURNACES

MODEL NUMBER		BTU/hr. INPUT	BTU/hr. OUTPUT	EFFICIENCY PERCENT		DIMENSIONS (INCHES)			CFM 120V	ELECTRICAL LOAD (W)	THERMOSTAT	SHIPPING WEIGHT (LBS.)
NATURAL	PROPANE			THERMAL	AFUE	WIDTH	DEPTH	HEIGHT				
0743512	0743511	7,400	5,500	74	72	18 7/8	6 3/4	22 1/4	-	-	BUILT-IN	44
1773512	1773511	17,700	13,500	76	76	21 3/4	8 1/4	28 1/8	129	86	BUILT-IN	57

Elevation rating from sea level to 2,000' but may be derated up to a maximum of 5,500'

1/2" Gas Connection

FEATURES

UNIQUE WALL-MOUNT DESIGN

Furnaces require no floor space.

"MATCHLESS" PILOT IGNITER

Assures convenient pilot lighting without matches.

REQUIRES NO ELECTRICITY

MODELS: 0743512 / 0743511

PROGRAMMABLE TIMER

A programmable thermostat in your home is one of the easier ways to save energy and money. On/Off, seven-day timer/clock.



SUMMERTIME VENTILATION

A two-speed recirculating fan will move the cool air off the floor and circulate it throughout your home, keeping it more comfortable.



TERMINATION CAP (FLUE)

Small, low-profile termination cap goes on the exterior of the building.

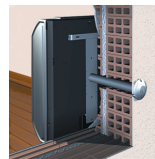

DIRECT-VENT SAFETY

For clean, comfortable heat when and where you want it. The gas flame is completely sealed inside, away from all contact with room air. Air necessary for combustion is drawn into the chamber from outside through the vent, and combustion products are vented directly to the outside. Only clean, gentle heat, in continuous circulation is delivered into the room. Windows and doors stay closed because no room air is used for combustion.

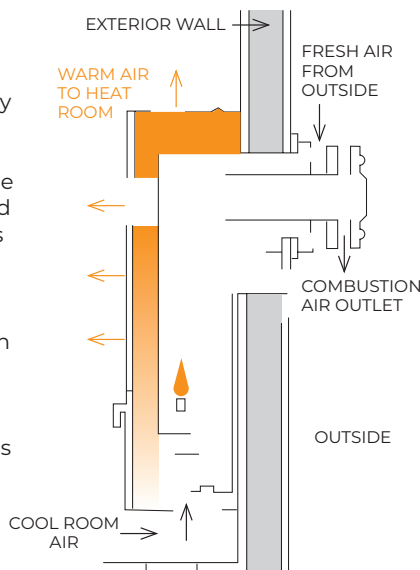

INTERIOR FURNACE CLEARANCES

MODELS: 0743512 / 0743511

- 2" from an intersecting wall.
- 1/4" from unit to back of wall (0" to spacers).
- 2" to finished floor.
- 10" from the top of the appliance to the ceiling or other obstructions or combustibles.
- 19 1/2" maximum wall thickness.

MODELS: 1773512 / 1773511

- 3 1/8" from an intersecting wall.
- 0" from unit to back of wall.
- 2" from finished floor.
- 10" from the top of the appliance to the ceiling or other obstructions or combustibles.
- 19 5/8" maximum wall thickness.

ACCESSORIES

VENT ADAPTER

The Vent Adapter Accessory is used to compensate for the extra space left around the vent hole when replacing a furnace with a larger vent opening. It can also be used to extend the flue terminal on homes with vinyl siding so that the vent cap will be flush against the edge of the siding.

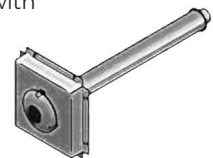

IMPORTANT

- Read owner's manual before using/installing.
- Photographs are representative only.
- Check local codes and ordinances for permitted uses.
- Consult installation manual for clearances prior to installation.
- We reserve the right to amend product specifications without notice.
- Installation and servicing recommended by a qualified service person.
- Please read the warranty for any limitations of disclaimers. Combustion chamber carries a 10-year limited warranty. All other parts carry a one-year limited warranty.
- Venting must comply with the "Venting and Chimney Requirements" section of the instruction manual.
- Massachusetts Approval GI-0816-23.



WARNING: This product can expose you to chemicals can which is known including to the State epichlorohydrin of defects California to and/or cause other cancer reproductive and birth harm. For more information go to www.p65warnings.ca.gov