

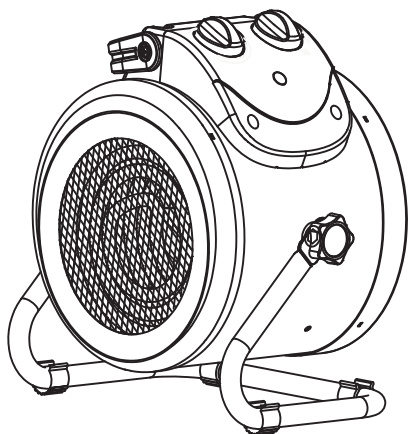

OWNER'S MANUAL

**ELECTRIC HEATER
MODEL # HIL-BG-E2B**



⚠ WARNING

IF THE INFORMATION IN THIS MANUAL IS NOT FOLLOWED EXACTLY, A FIRE MAY RESULT CAUSING PROPERTY DAMAGE, PERSONAL INJURY OR LOSS OF LIFE.

FOR YOUR SAFETY
DO NOT STORE
OR USE GASOLINE OR
OTHER FLAMMABLE VAPORS
OR LIQUIDS
IN THE VICINITY OF THIS OR
ANY OTHER APPLIANCE

ANS Z83.26-2014 • CSA 2.37-2014 Gas-Fired Outdoor Infrared Patio Heaters

ATTACH YOUR RECEIPT HERE

Serial Number _____ Purchase Date _____

INTENDED USE: This product is intended only for indoor household or office use.
It is **NOT** intended for industrial or commercial use. **DO NOT USE OUTDOORS**

IMPORTANT INSTRUCTIONS

PLEASE READ AND SAVE THESE IMPORTANT SAFETY INSTRUCTIONS When using electrical appliances, basic precautions should always be followed to reduce the risk of fire, electrical shock, and injury to persons, including the following:

1. Read all instructions before using this heater.
2. This heater is hot when in use. To avoid burns, do not let bare skin touch hot surfaces. If provided, use handles when moving this heater. Keep combustible materials, such as furniture, pillows, bedding, papers, clothes and curtains at least 3 feet (0.9m) from the heater.
3. Extreme caution is necessary when any heater is used by or near children, pets or invalids and whenever the heater is left operating unattended.
4. If possible always unplug this appliance when not in use.
5. Do not operate any heater with a damaged cord or plug or after the heater malfunctions, has been dropped or damaged in any manner.
6. Any repairs to this appliance should be carried out by a qualified service person.
7. Under no circumstances should this appliance be modified. Parts having to be removed for servicing must be replaced prior to operating this appliance again.
8. Do not use outdoors.
9. Use your heater only in dry environments. This heater is not intended for use in bathrooms, laundry areas and similar indoor locations. Never locate the heater where it may fall into a bathtub or other water container. Do not use your heater outdoors. Do not use near sinks, swimming pools or other damp areas such as flooded basements, garages, etc or anyplace where the heater could come in contact with water.
10. Do not use this heater in elevated locations, such as on shelves, raised platforms, etc.
11. Do not run cord under carpeting. Do not cover cord with throw rugs, runners, or similar coverings. Arrange cord away from traffic area and where it will not be tripped over.
12. To disconnect heater, first turn controls to off, then remove plug from outlet. Always unplug the heater when not in use.
13. Connect to a properly grounded outlets only.
14. This appliance, when installed, must be electrically grounded in accordance with local codes, with the current CSA C22.0 Canadian Electrical codes or for USA installations, follow local codes or for USA installations, follow local codes and the National Electric code ANSI/NFPA No. 70.
15. Do not insert or allow foreign objects to enter any ventilation or exhaust opening as this may cause an electrical shock or fire, or damage the heater.
16. To prevent a possible fire, do not block air intakes or exhaust in any manner. Do not use on soft surfaces, like a bed, where openings may become blocked.
17. This appliance has hot and arcing or sparking parts inside. Do not use it in areas where gasoline, paint or flammable liquids are used or stored. This appliance should not be used as a drying rack for clothing, nor should Christmas stockings or decorations be hung or near it.
18. Use this heater only as described in this manual. Any other use not recommended by the manufacturer may cause fire, electric shock, or injury to persons.
19. Always plug heaters directly into a wall outlet/receptacle. Never use with an extension cord or relocatable power strip.
20. Do not use this heater with missing, damaged, or broken legs.
21. "SAVE THESE INSTRUCTIONS"

ALWAYS OBSERVE THESE SAFETY PRECAUTIONS WHEN OPERATING YOUR ELECTRIC HEATER

- ALWAYS** Read all instructions before operating.
 - ALWAYS** Locate your electric heater away from furniture or loose hanging drapes.
 - ALWAYS** Keep the rear grill away from walls or drapes so as not to block the air intake. (If applicable)
 - ALWAYS** Unplug electric heater when not in use.
 - ALWAYS** Use electric heater on a flat dry surface.
 - ALWAYS** Use on 110-120 volt 60Hz AC power supply.
 - ALWAYS** Route the cord so it will not be walked on tripped over or pinched by furniture.
 - ALWAYS** Keep electrical cords, drapes and other furnishings away from your electric heater.
 - ALWAYS** Keep your electric heater clean and the filter free of dust. (If applicable)
 - ALWAYS** Use indoors only.
-
- NEVER** Place drapes, clothing or towels over electric heater to dry.
 - NEVER** Use in the presence of explosive or flammable vapors such as gas or paint.
 - NEVER** Plug another electrical appliance into the same circuit. Blown fuses, tripped circuits and fire hazards may result.
 - NEVER** Use water or liquids to clean your electric heater.
 - NEVER** Let bare skin touch hot surfaces as this may cause burns.
 - NEVER** Leave electric heater unattended.
 - NEVER** Leave electric heater when children or pets are present.
 - NEVER** Locate electric heater where it may fall into a bath tub or other water containers.
 - NEVER** Operate electric heater with a damaged cord, plug or after the heater malfunctions, or has been dropped or damaged in any manner.
 - NEVER** Run cord under carpeting or cover with throw rugs or runners.
 - NEVER** Insert or allow foreign objects to enter any ventilation or exhaust openings, as this may cause an electrical shock, fire or damage.

“SAVE THESE INSTRUCTIONS”



IMPORTANT: Read all instructions and warnings carefully before installation and use. Failure to follow these instructions may result in a possible electric shock, injury to persons, fire hazard and will void the warranty



OPERATING INSTRUCTIONS

Note: When using the heater for the first time, you may notice a slight emission of smoke. This is normal and will stop after a short time. The heating element is made of steel and was coated with a layer of protective oil during production.

Setting	Function
	Unit is off
	Fan Runs – No Heat
	Fan Runs – Full Power Heat

1. Position the fan heater so that it stands on a firm level surface (When used as portable) and at a safe distance from wet locations and flammable objects.
2. Connect the fan heater to the proper electrical power. See grounding instructions.
3. Set the power settings knob to Fan or Heating Position.
4. Set the thermostat dial to the maximum temperature.
5. Once the room reaches the desired temperature, turn the thermostat dial back until heating element turns off. The heater will cycle automatically around this present temperature. To increase temperature, turn the thermostat knob clockwise. To lower temperature, turn the thermostat counterclockwise.



Electrical outlet wiring must comply with local building codes and other applicable regulations to reduce the risk of fire, electrical shock and injury to persons.



Do not use this appliance if any part of it has been underwater. Immediately call a qualified service technician to inspect the appliance and replace any part of the electrical system which has been under water.



Grounding Instructions:

Make sure the heater is switched OFF before plugging the heater into the outlet. Connect to properly grounded outlets only. Note: The power cord has a polarized plug (with one blade wider than the other) that will only fit in a polarized outlet one way. If it does not insert easily try reversing the plug. If it still does not fit contact your electrician to replace your outlet.

DO NOT defeat the safety purpose of the polarized plug.

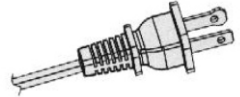

Automatic Overheat Safety Control

- This heater is equipped with an internal heat limiting thermostat and overheats protection circuit. When a potential overheat temperature is reached, the system will automatically shut the heater off. Unplug the heater to allow to cool down for 10 minutes, and then restart.



CAUTION:
RISK OF ELECTRIC SHOCK
DO NOT OPEN
NO SERVICEABLE PARTS INSIDE



Cleaning and Maintenance

Any electrical repairs or rewiring of this unit should be carried out by a licensed electrician in accordance with national and local codes.

- Before cleaning the appliance, disconnect it from the power outlet and let it cool down.
- In order to protect the enclosure, don't splash water onto the heater, and never use a solvent like gasoline, isoamyl acetate, toluene, etc. to clean the heater. **DO NOT** open the heater or attempt to clean the inside of this appliance.

SPECIFICATIONS

Model	BG-E2B (All specifications +5% / -10% tolerance)
BTU's per/Hour	5120
Voltage	120V
Watts	1500
Amps	15
Heating Area (m ²)	15

TROUBLE SHOOTING

PROBLEM	CAUSE	SOLUTION
Heating element does not glow red	Stainless steel elements won't glow red to produce heat.	Heater is operating correctly
Do not feel heat or air flow	No power to heater	Check power connection to heater
	Desired room temperature reached.	Thermostat will shut off heater once desired room temperature is reached.
	Auto-Reset has tripped	Unplug heater allow to cool down for 10 minutes, then restart.
	Heater has fan only setting.	Set to run on full power for heating.

ILLUSTRATED PARTS BREAKDOWN

MODEL: HIL-BG-E2B

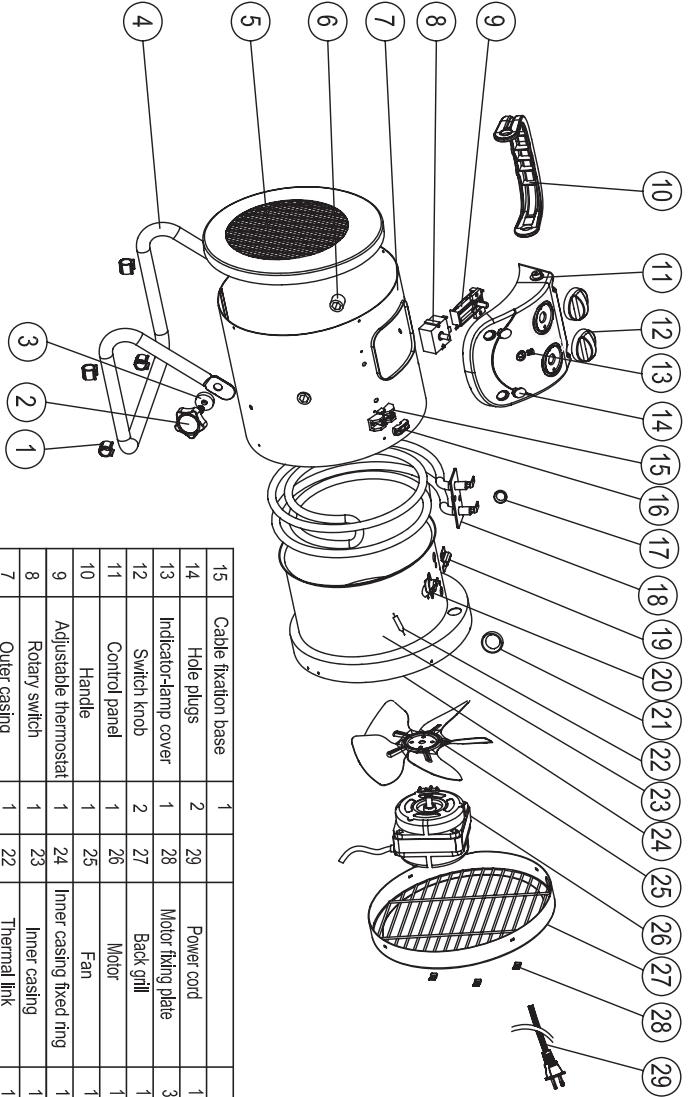

Key No.	Description	QTY	Key No.	Description	QTY
1	Rubber feet	4	16	Wire fixing plate	1
2	Pinching screw	2	17	Protection bush	1
3	Plastic gasket	2	18	Thermal link plate	1
4	Steel pipe	1	19	Thermal link	1
5	Front grill	1	20	Re-set thermostat	1
6	Rivet	2	21	Protection bush	1
7	Outer casing	1	22	Thermal link	1
8	Rotary switch	1	23	Inner casing	1
9	Adjustable thermostat	1	24	Inner casing fixed ring	1
10	Handle	1	25	Fan	1
11	Control panel	1	26	Motor	1
12	Switch knob	2	27	Back grill	1
13	Indicator-lamp cover	1	28	Motor fixing plate	3
14	Hole plugs	2	29	Power cord	1
15	Cable fixation base	1			