

Halo Installation Step 1



Brackets facing out →



Remove glass face by lifting face up off the firebox with 2 people. Set glass face against the wall with brackets facing you.

Halo Installation Step 2

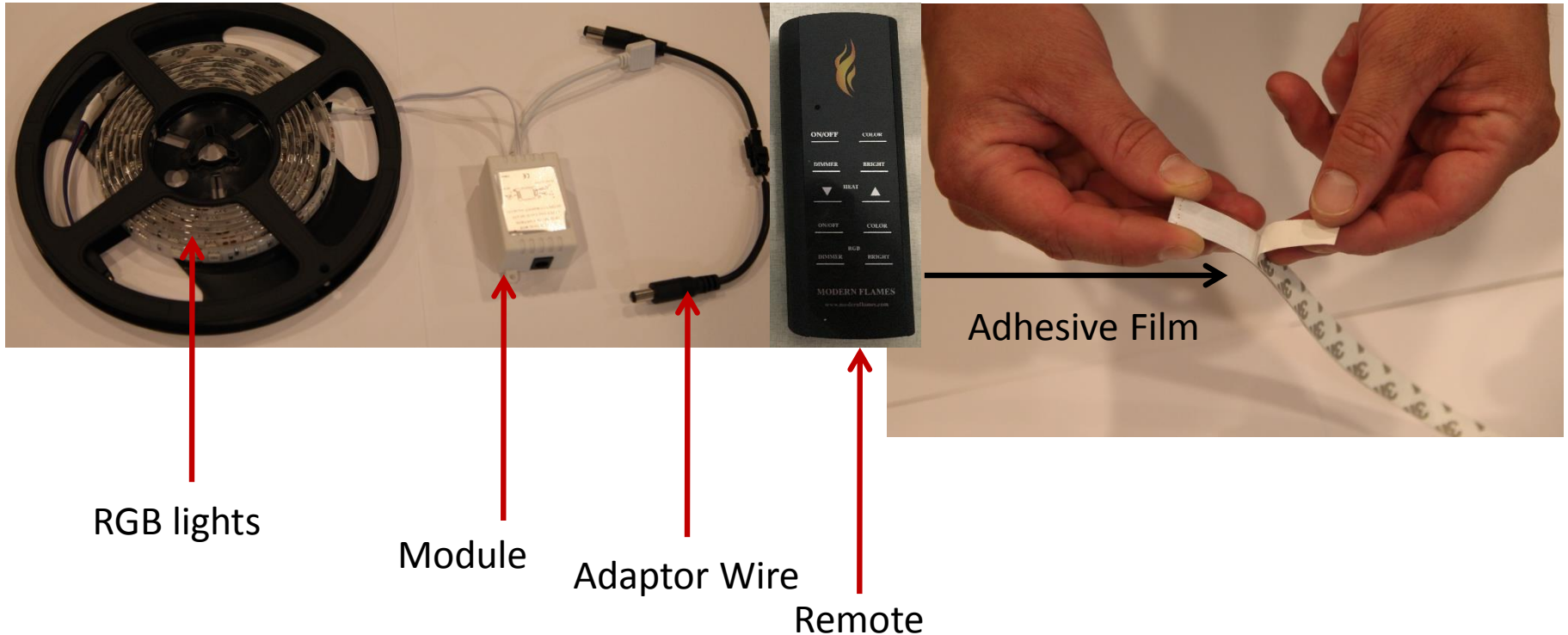

Locate Halo light kit. Contents are (1) RGB light wheel (1) module (1) Adaptor Wire (1) Remote. Remove RGB lights from wheel and remove adhesive cover

Halo Installation Step 3



With adhesive side down, center RGB lights on “L” metal of the glass and wrap around



Remove adhesive cover from back of module and press against left side of the glass low enough so you can connect the RGB lights to and hang IR sensor just below the glass. Connect Adaptor wire to module and RGB lights to plug connecting the arrows together on 4prong connector

Halo Installation Step 4

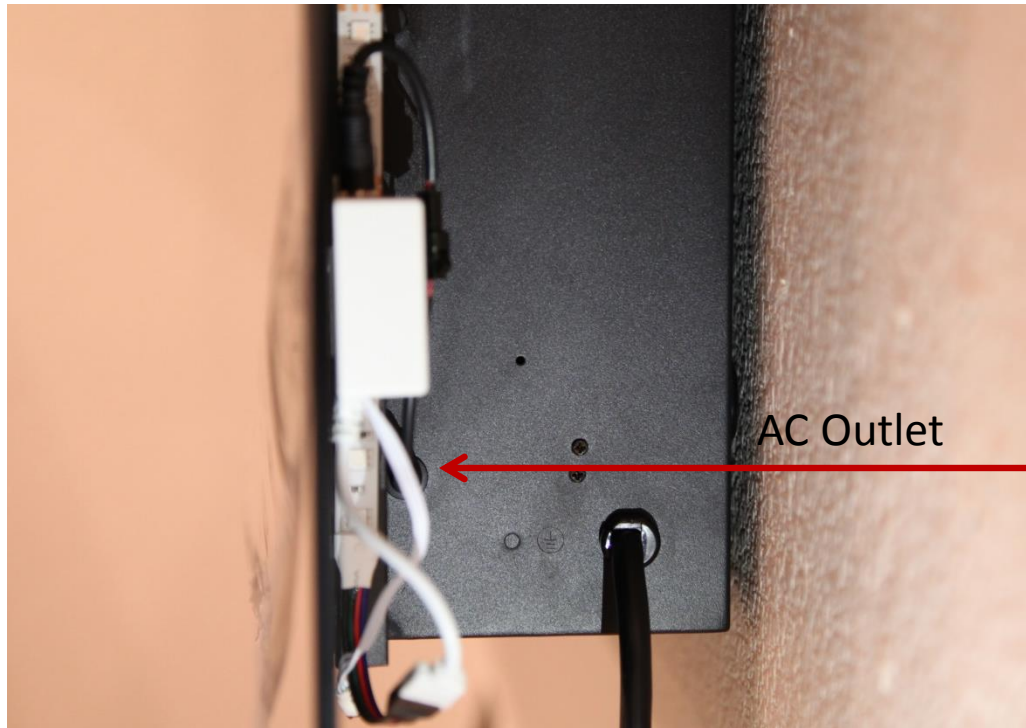

Re-attach glass face and plug adaptor wire into the AC outlet on the right side of the firebox

Halo Installation Step 5

HALO/CGEK I.R. SENSOR

VIEWING SIDE

WALL/FIREBOX

MAKE SURE ROUND SIDE OF IR SENSOR IS FACING AWAY FROM THE UNIT, FOR EXAMPLE AIM TOWARD WHERE THE FIREPLACE WILL BE VIEWED AND CONTROLLED FROM

It is best to hang IR sensor just below the glass face for best functionality



MFR2-10
CLX2 REMOTE WITH
HALO OPTION

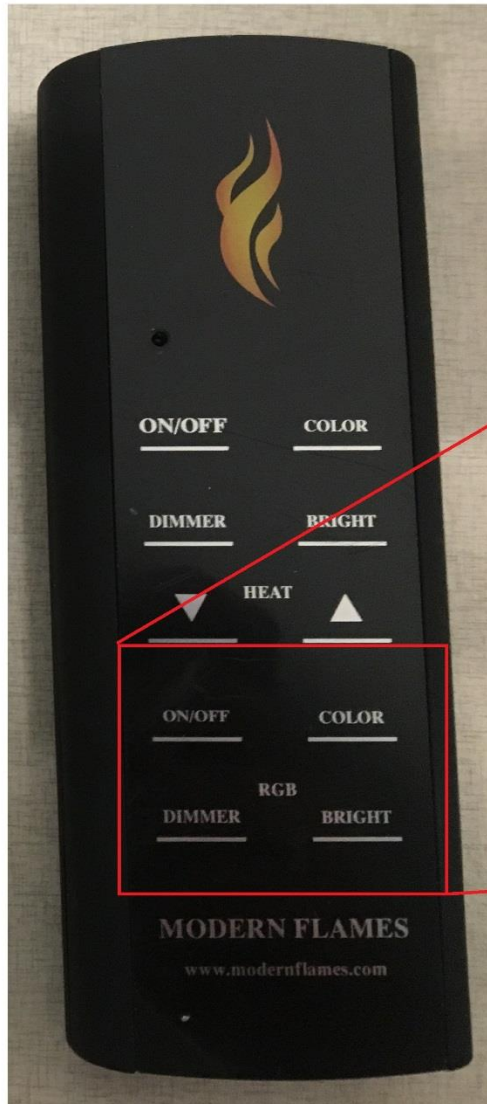

HALO CONTROLS

