

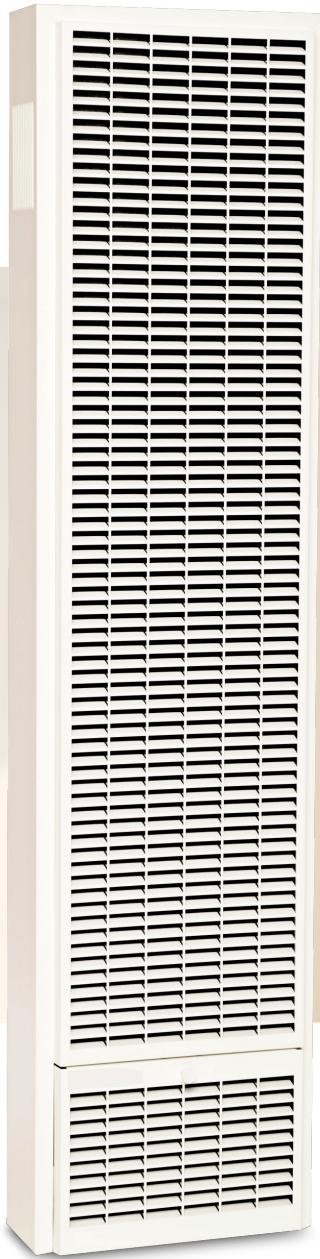

NEW - AC2030T TOP VENT GAS WALL HEATER



The future is here. Introducing the Next Generation high performance, affordable, vented wall furnace heating solution. The AC2030T Top Vent Gas Wall Heater offers traditional home comfort with lower heating costs, convenience and high efficiency. Easily recessed or surface-mounted options are great in homes, schools, cabins, apartments, offices and shops.

Heating rooms individually allows comfort in areas being used while saving fuel costs in unused areas.

FEATURES

- Superior comfort and efficiency 82% AFUE
- Ultra low NOx emissions
- Dynamic Response - for energy savings and a constant and comfortable temperature - just enough heat for your desired environment.
- No standing pilot - eliminates seasonal relighting, saves energy and eliminates methane emissions.
- Easy to install
- Quiet fans offer improved comfort and air circulation
- Reduced carbon footprint - fits into the same opening and uses the same venting as the traditional Monterey wall furnace.

- Programmable thermostat included for energy savings and comfort:



- Easy to use
- Dynamic response
- Programmable heating schedule
- Shows date and time
- Manual and auto modes

20,000 - 30,000 BTU/hr.
(Heat rooms up to 1,000 sq. ft.)



DESIGNED
& ASSEMBLED
IN THE USA
SINCE 1916



AC2030T TOP VENT GAS WALL HEATER

MODEL NUMBER		BTU/hr. INPUT	BTU/hr. OUTPUT	EFFICIENCY PERCENT	DIGITAL THERMOSTAT
NATURAL	PROPANE			AFUE	
AC2030TN	AC2030TP	30,000	24,600	82%	PROGRAMMABLE

Conversion Kit Available

MODEL DIMENSIONS	WIDTH	DEPTH	HEIGHT	WEIGHT (LBS.)
FURNACE DIMENSIONS (INCHES)	10	9	68 2/5	106
SHIPPING DIMENSIONS (INCHES)	17 1/2	11	71	110

Settable elevation rating from sea level (0) to 4,500'

1/2" Gas Connection

FEATURES

CONTEMPORARY FINISH

Soft-white, powder-coat, heat-resistant finish to compliment any decor.

INTERIOR FURNACE CLEARANCES

- 1" from an intersecting wall.
- 16" from the top of the appliance to the ceiling or other obstructions.
- 48" from the furnace front to draperies, furniture or other obstructions or other combustibles.
- 2 1/2" from finished floor.

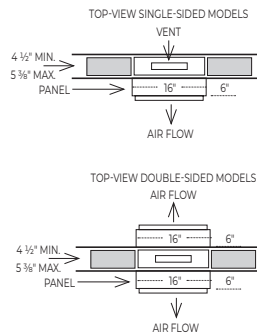
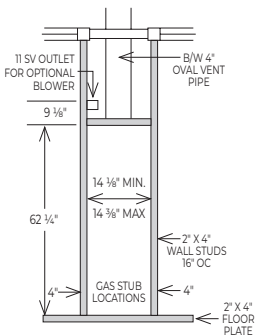

ACCESSORIES

REAR-OUTLET REGISTER

Chain operated damper with register flush on rear wall, adjusts amount of heat delivered through rear register. Motorized rear outlet register for increased airflow also available.

Model 6901 - Standard model, shipping weight 4 lbs.

Model 6919 - Motorized model for recessed installation.

Model 6920 - Motorized model for surface mounted installation. Shipping weight 6919 and 6920, 10 lbs.



GAS CONVERSION KIT

Natural gas to LP or LP to Natural gas orifice selections included.

OVAL-VENT STARTER KIT

Contains hold down plate, oval-to-round adapter, spacer plates and two pieces of 2-foot lengths of oval pipe.

Model 9929 - USA

Model 9930 - Canada

Shipping weight 9 lbs.



REPLACEMENT FACE PANEL

Soft white powder coat face panel

Model 4915 - shipping weight 30 lbs.

FREE-STANDING KIT

Allows single sided furnaces to be surface mounted instead of recessed. Ideal for remodeling in existing masonry construction or when studs are substandard. (furnace and face panel not included.)

Model 4901 - Shipping weight 23 lbs.

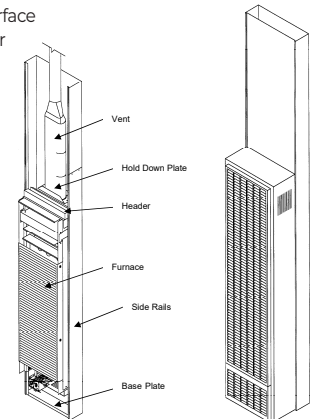

IMPORTANT

- Read owner's manual before using/installing.
- Photographs are representative only.
- Check local codes and ordinances for permitted uses.
- Consult installation manual for clearances prior to installation.
- We reserve the right to amend product specifications without notice.
- Installation and servicing recommended by a qualified service person.
- Please read the warranty for any limitations of disclaimers. All parts carry a one-year limited warranty.
- Venting must comply with the "Venting and Chimney Requirements" section of the instruction manual.

WARNING: This product can expose you to chemicals including epichlorohydrin which is known to the State of California to cause cancer and birth defects and/or other reproductive harm. For more information go to www.p65warnings.ca.gov

