

ASTORIA COLLECTION

## 2-DRAWER END TABLE

Item#: 63709

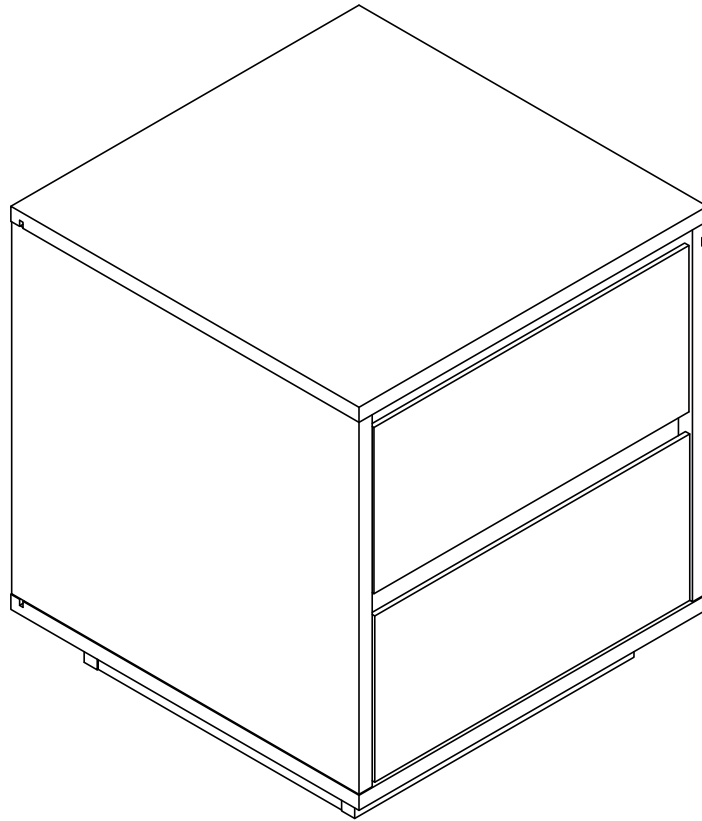

### ATTACH YOUR RECEIPT HERE

Keep a copy of your proof of purchase or order confirmation which will be needed if you need to contact us about warranty coverage.

Purchase Date: \_\_\_\_\_



### SAVE THESE INSTRUCTIONS FOR FUTURE REFERENCE.



### Questions, problems, missing parts?

Before returning to your retailer, our Florida-based customer service team is available:

Call toll-free **(866) 985-7877**

9 a.m. – 9 p.m., EST

Email **[cservice@welltraveled.net](mailto:cservice@welltraveled.net)**

Live chat **[www.balkenehome.com](http://www.balkenehome.com)**

9 a.m. – 6 p.m., EST, Monday – Friday



## BEFORE YOU BEGIN

Before beginning assembly, make sure all parts are present. Compare parts received with the “Parts List.” If any part is missing or damaged, do NOT attempt to assemble the product. Please read and understand this entire manual before attempting to assemble, operate or install this product. If you have any questions regarding the product, please contact Customer Service:

Call toll-free	<b>(866) 985-7877</b>	9 a.m. – 9 p.m., EST
Email	<b><a href="mailto:cservice@welltraveled.net">cservice@welltraveled.net</a></b>	
Live chat	<b><a href="http://www.balkenehome.com">www.balkenehome.com</a></b>	9 a.m. – 6 p.m., EST, Monday – Friday



## GENERAL INFORMATION

This item is made of particle board. For safe assembly, set up on a dry, soft, secure and clean surface. Do not clean with detergent or chemicals. Do not place hot items such as coffee cups directly on the surface of this furniture item. Keep away from direct sunlight and water. Do not drag the unit. For indoor use only.



## SAFETY INFORMATION

### WARNING

DO NOT sit or stand or allow children to sit or stand on the assembled product. Make sure connectors are securely in place. Perform periodic checks to make sure the connectors are secure and adjust if needed. Keep unassembled parts and hardware away from children and infants. This package contains small parts and sharp points. Adult assembly required.

### CAUTION

READ all instructions before beginning assembly. Failure to do so may result in faulty assembly and potential injury. Assemble the item on a soft, non-abrasive surface such as carpet or cardboard to avoid damaging the item.

Max safe load limit: Tabletop: 15 KG / 33 LB and Drawer: 5 KG / 11 LB.

# PARTS LIST

## CABINET

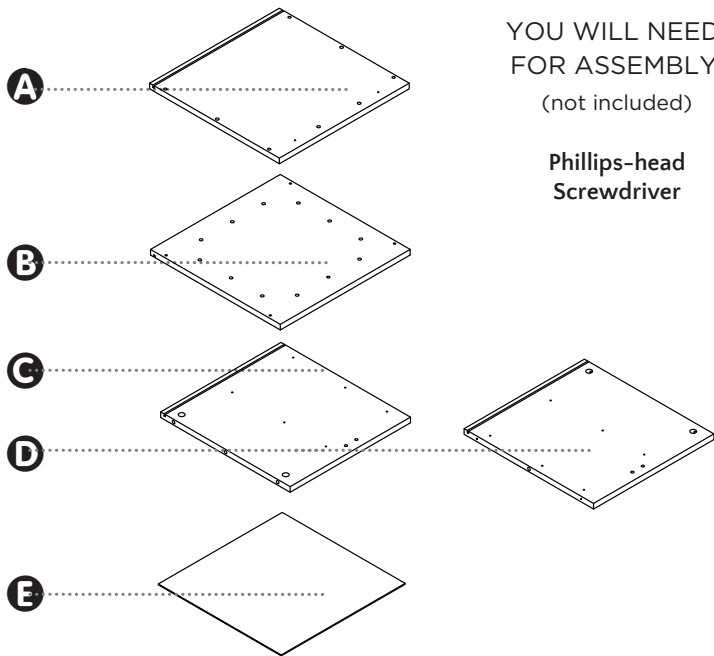

# BALKENE —HOME—

PART	DESCRIPTION	QUANTITY
<b>A</b>	Top Panel	1
<b>B</b>	Bottom Panel	1
<b>C</b>	Left Side	1
<b>D</b>	Right Side	1
<b>E</b>	Back Panel	1
<b>F</b>	Drawer Front	2
<b>G</b>	Drawer Side (Left)	2
<b>H</b>	Drawer Side (Right)	2
<b>I</b>	Drawer Back	2
<b>J</b>	Drawer Bottom	2
<b>K</b>	Middle Face Frame	1
<b>L</b>	Base Front/Back Panel	2
<b>M</b>	Base Side Panel	2
<b>N</b>	Upper Face Frame	1

## DRAWERS

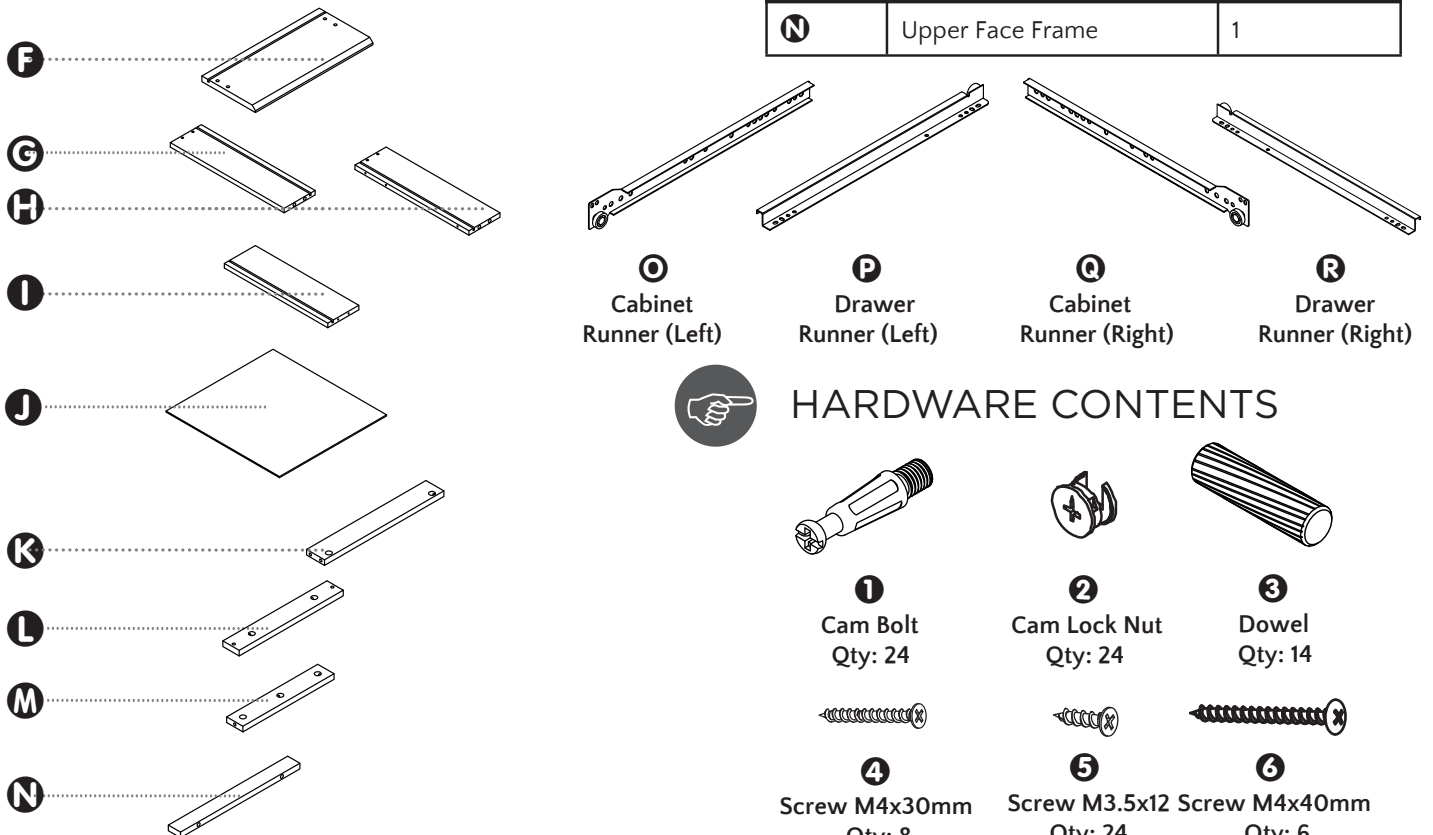

## HARDWARE CONTENTS

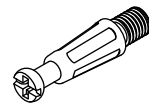

**1**  
Cam Bolt  
Qty: 24



**2**  
Cam Lock Nut  
Qty: 24

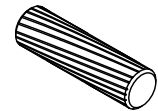

**3**  
Dowel  
Qty: 14



**4**  
Screw M4x30mm  
Qty: 8



**5**  
Screw M3.5x12  
Qty: 24



**6**  
Screw M4x40mm  
Qty: 6

# ASSEMBLY PREPARATION

# BALKENE —HOME—

Before beginning assembly, be sure to empty contents of carton and make sure all parts are present. If any parts are missing, please contact Customer Service before proceeding.

Place all parts on a soft, level surface for assembly. You will need a **Phillips-head screwdriver** for assembly. Estimated Assembly Time: 1 Hour | DO NOT over-tighten hardware!

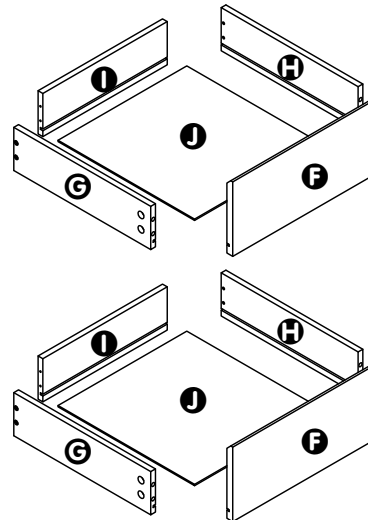
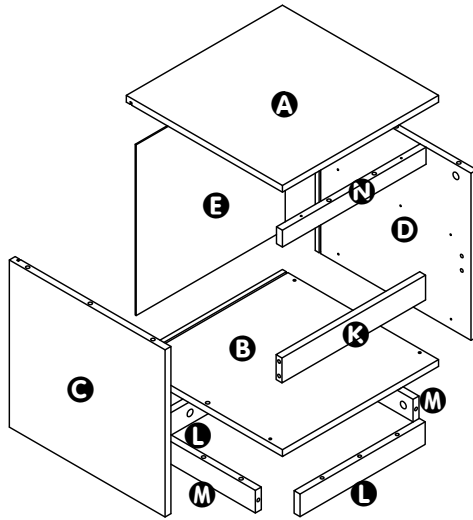

**1** Locate the **Top Panel A**, **Bottom Panel B**, **Left and Right Sides C/D**, **Drawer Fronts F**, **Upper Face Frame N**, **Middle Face Frame K**, **Base Front/Back Panels L**, and **Base Side Panels M**.

Lay indicated parts inside-up (or blank/non-drilled sides facing down). Prepare for assembly by inserting **Cam Bolts 1** into flat surfaces and **Dowels 2** into edges according to the diagram at right.

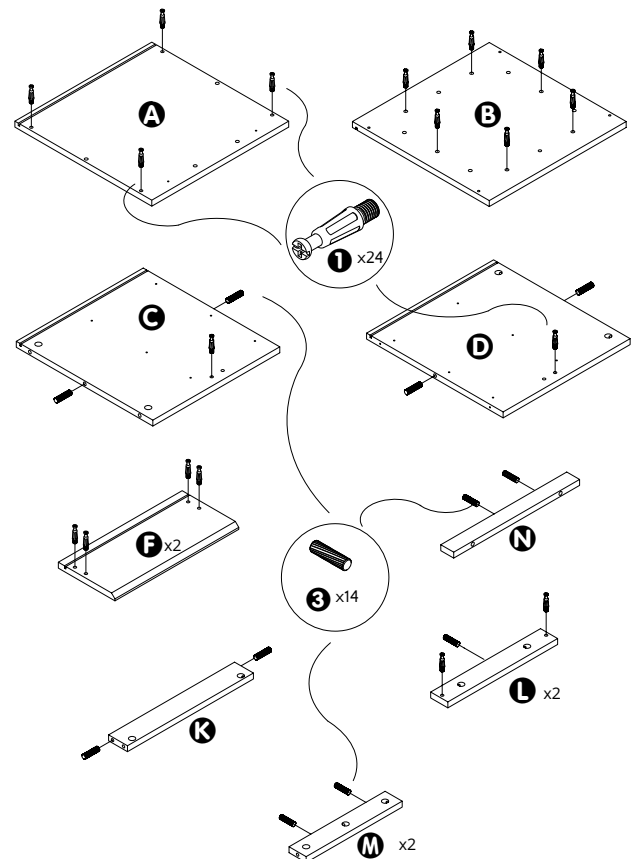

# ASSEMBLY

# BALKENE —HOME—

**2** Align the **Cabinet Runners (Left)** ① with the holes in the interior face of the **Left Side** ②. Fasten using 3 **Screws** ③ per runner as shown in the screw placement diagram.

Repeat the above steps to attach the **Cabinet Runners (Right)** ① to the **Right Side** ②.

Hardware Used:      ③ Screw (M3.5x12) x 12

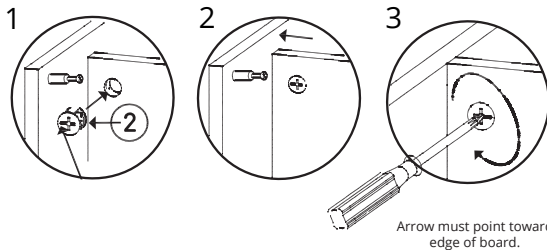

**3** Insert **Cam Lock Nuts** ② into the holes on one side of the **Middle Face Frame** ④. Rotate each **Cam Lock Nut** so the arrow (at one point of the Phillips head cross marking) points toward the adjacent hole in the edge of the panel as shown in the diagram above.

*NOTE: the Side Panels in the drawing are shown upside-down.* Join the **Left** and **Right Sides** by installing the **Middle Face Frame** as shown. Rotate each **Cam Lock Nut** clockwise until it catches securely on its corresponding **Cam Bolt**.

Hardware Used:      ② Cam Lock Nut x 2

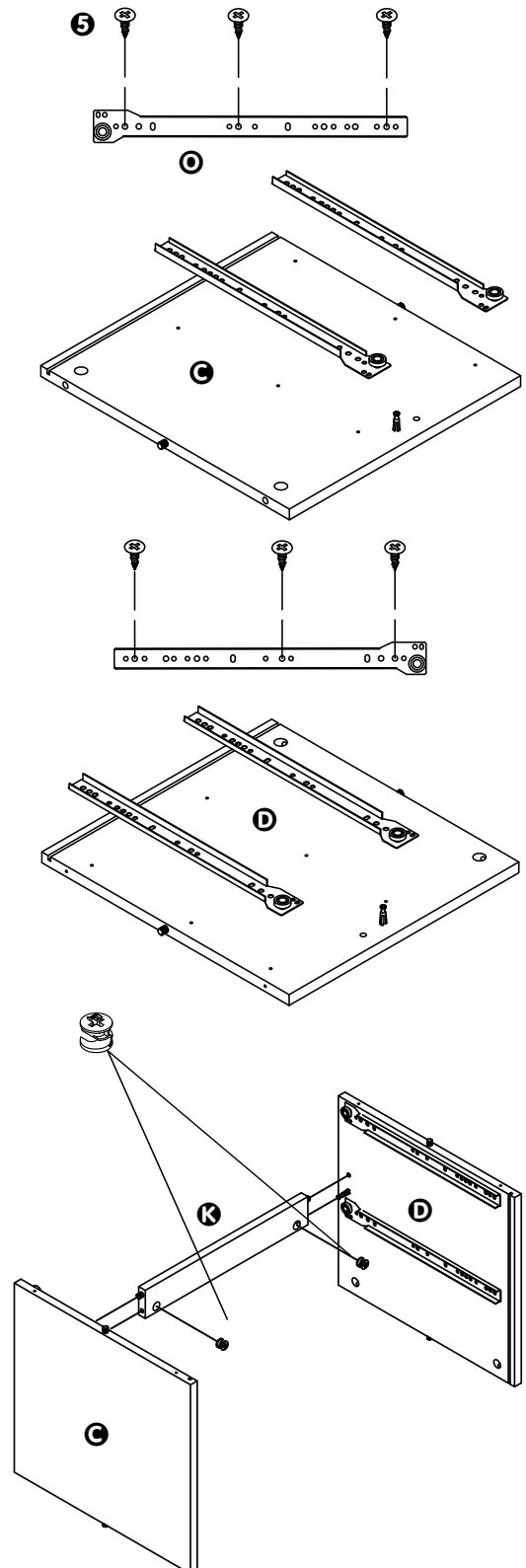

# ASSEMBLY

# BALKENE —HOME—

**4** Insert **Cam Lock Nuts 2** into the holes on the inside of each **Side Panel**, rotating the arrows toward the closest panel edge as before.

Place the **Top Panel A** upside-down. Align the holes in the edges of the partially-assembled cabinet box with the **Cam Bolts** previously installed in the **Table Top**. Join the **Left** and **Right Sides** to the **Top Panel** by rotating the 4 **Cam Lock Nuts** until they catch the corresponding **Cam Bolts**.

Hardware Used:      **2** Cam Lock Nut x 4

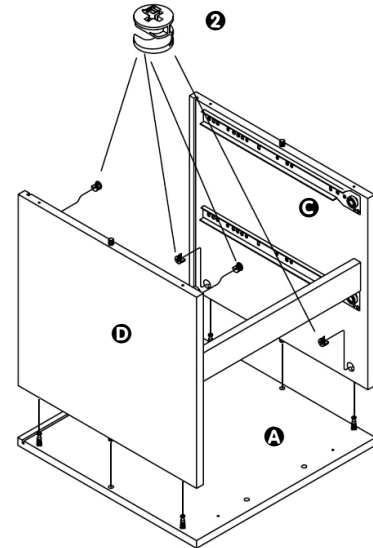

**5** Install the **Upper Face Frame N** by fitting the previously-installed **Dowels** in its edge into the holes in the underside of the **Table Top** as shown. Secure using 2 **Screws 6**.

Hardware Used:      **6** Screw (M4x40) x 2

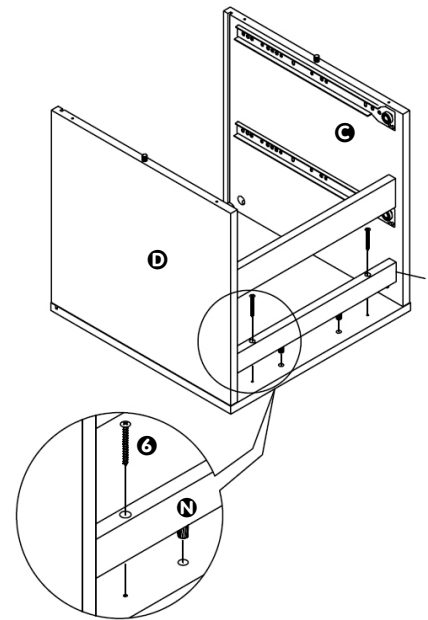

**6** Slide the **Back Panel E** into place along the grooves in the assembled panels.

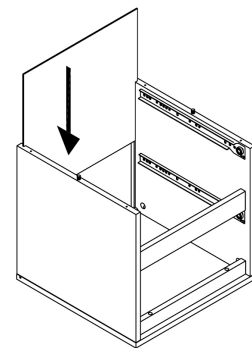

# ASSEMBLY

# BALKENE —HOME—

**7** Install the **Bottom Panel B** by fitting it onto the **Dowels** previously installed in the bottom edges of the **Left** and **Right Sides**. Secure using a **Screw G** near each corner as shown.

Hardware Used: **G Screw (M4x40) x 4**

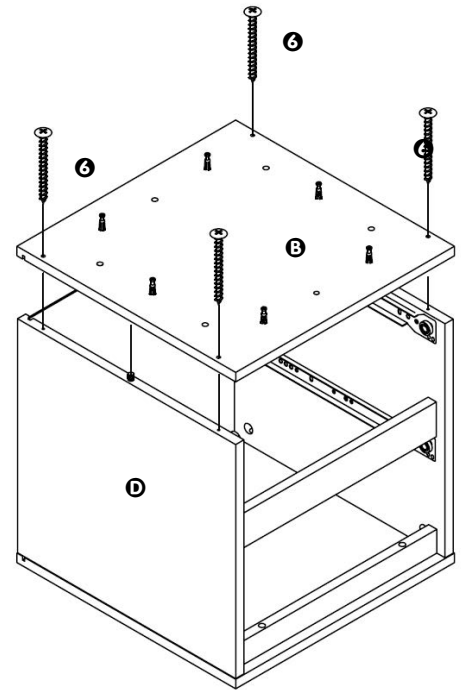

**8** Assemble the table base by first inserting **Cam Lock Nuts L** into the holes near either end of each **Base Side Panel M**. Rotate each **Cam Lock Nut** so the arrow points toward the short edge of the panel.

Insert the previously-installed **Cam Bolts** near the ends of the **Base Front/Back Panels** into the corresponding holes in the short edges of both **Base Side Panels** to form a rectangular base as shown.

Hardware Used: **L Cam Lock Nut x 4**

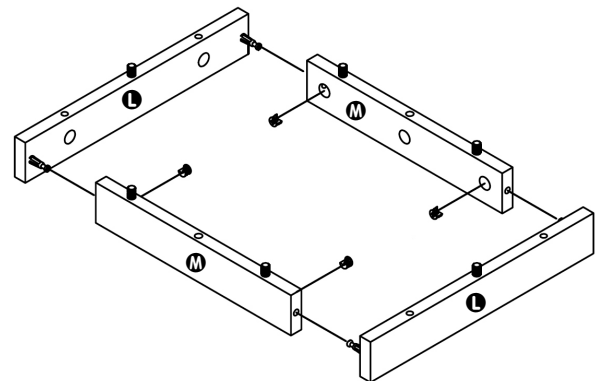

**9** Attach the assembled table base to the **Bottom Panel B** by first inserting **Cam Lock Nuts L** into the 6 remaining holes on the interior of the table base. Rotate each **Cam Lock Nut** so the arrow points toward the adjoining cam bolt hole in the edge of the table base.

Lower the table base onto the previously-installed **Cam Bolts** in the **Bottom Panel** and secure by turning each **Cam Lock Nut** **clockwise** until it catches securely on the corresponding **Cam Bolt**.

Hardware Used: **L Cam Lock Nut x 6**

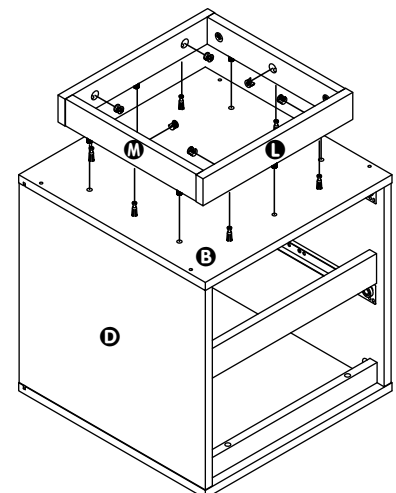

# ASSEMBLY

# BALKENE —HOME—

**10** Begin assembling the drawers: Attach **Drawer Side (Left)** **G** to **Drawer Back** **I** using 2 **Screws** **4**, ensuring that the grooved sides are facing in and the groove lines up continuously. Attach the **Drawer Side (Right)** **H** in the same manner. Repeat these steps to begin the second drawer.

Hardware Used: **4** Screw (M4x30) x 8

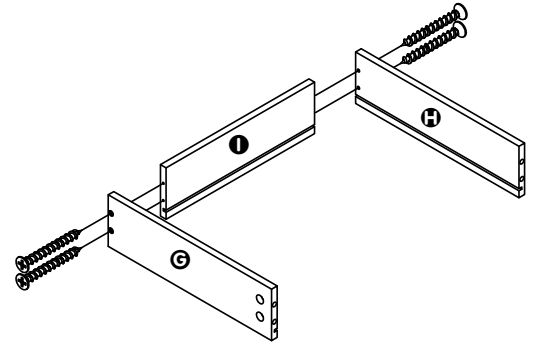

**11** Slide the **Drawer Bottoms** **J** into position in the grooves of the partially-assembled drawers.

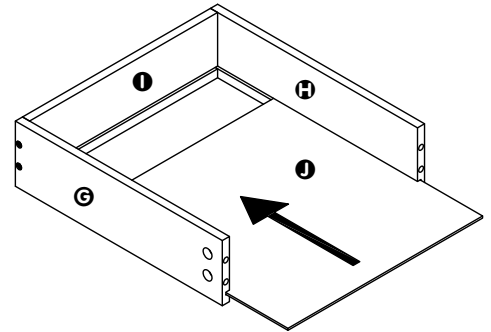

**12** Attach the **Drawer Fronts** **F** by first inserting **Cam Lock Nuts** **2** into the holes on the outside of the table base near the open end of the drawer. Rotate each **Cam Lock Nut** so the arrow points toward the adjoining cam bolt hole in the open edge of the drawer.

Insert the previously-installed **Cam Bolts** in the **Drawer Fronts** into the holes in the edges of the **Drawer Sides** and secure by turning each **Cam Lock Nut** clockwise until it catches securely on the corresponding **Cam Bolt**.

Hardware Used: **2** Cam Lock Nut x 8

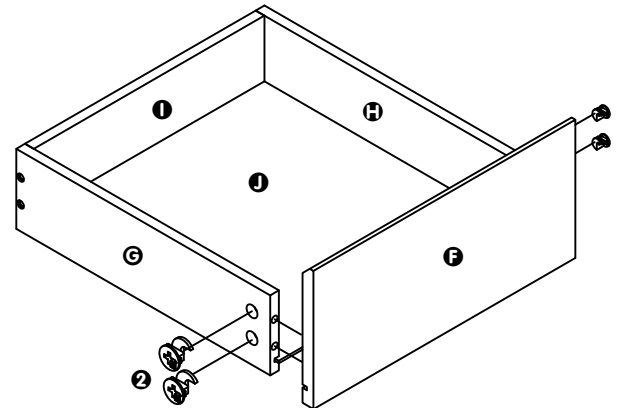



# ASSEMBLY

# BALKENE —HOME—

**13** Install the **Drawer Runners P/R**: Align each **Drawer Runner** with the wheel toward the back of the drawer and parallel to the **Drawer Side**. Attach each **Runner** using 3 **Screws S** positioned as shown in the diagram above the drawer illustration.

Repeat to install **Runners** on the second drawer.

**Hardware Used:**      **S** Screw (M3.5x12) x 12

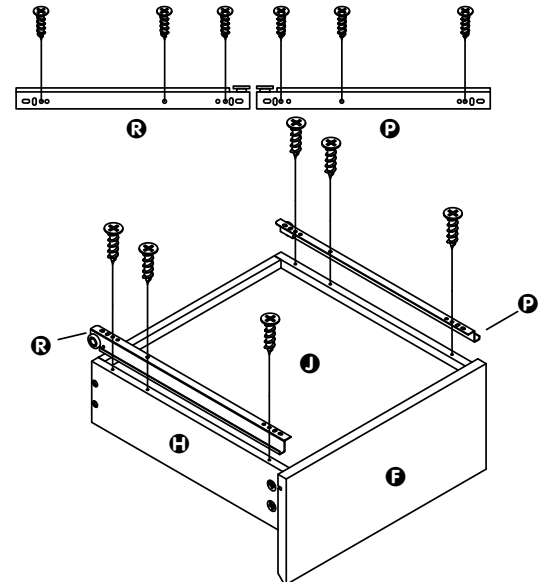

**14** Insert the drawers by guiding the wheels at the back of the **Drawer Runners** OVER the wheels at the front of the **Cabinet Runners**. You may need to angle the front of the drawer up slightly until the drawer wheels have settled into the track of the **Cabinet Runners**.

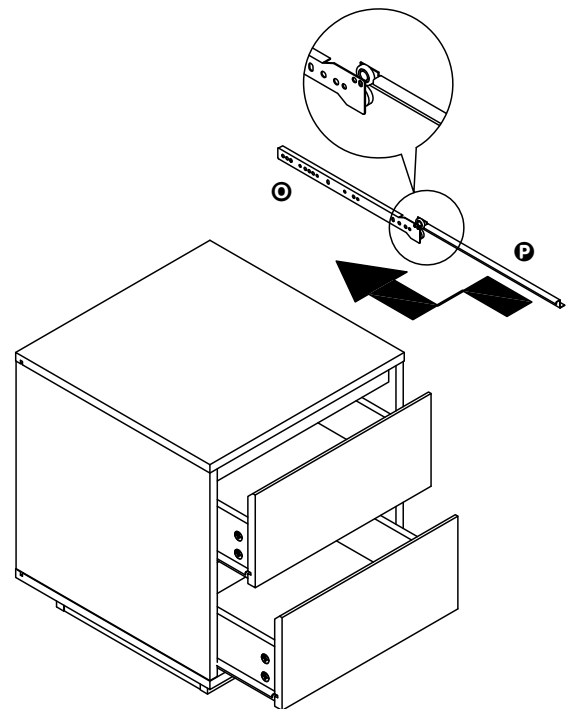

**15** Your **Astoria 2-Drawer End Table** is ready for use!

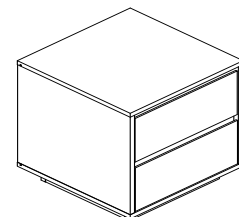



## LIMITED WARRANTY

Customers in the Contiguous US

With proof of purchase from an authorized retailer, this product is warranted for a period of 1 year from original purchase date against defects in materials and workmanship under normal use. This warranty does NOT cover normal wear/weathering, exposure to water, freezing temperatures, oils, fluids, or chemicals OR use in a commercial context if the unit is not designated as a commercial model. At Well Traveled Living's sole discretion, products under warranty will be repaired and/or replaced at no charge to the customer. Returns sent back to Well Traveled Living must be sent via prepaid freight in the original retail packaging.

For warranty service, contact Balkene Home/Well Traveled Living at the address, phone numbers or website and email listed in this owner's manual. Be sure to have your sales receipt, date of purchase and catalogue/model numbers available when calling. All warranty service will be coordinated by Well Traveled Living's Amelia Island, Florida service center. This warranty is extended only to the original owner. Proof of purchase will be required before warranty service is rendered. The sales receipt is the only valid proof of purchase. This warranty only covers failures due to defects in materials or workmanship which occur during normal use. Failures and/or damage which result from accident, negligence, misuse, abuse, neglect, mishandling, alteration or modification, failure to maintain, improper assembly or maintenance, service by unauthorized agency or use of unauthorized components or damage that is attributable to acts of God are NOT covered.

This limited warranty gives you specific legal rights and you may also have other rights which vary from jurisdiction to jurisdiction. The provisions of the United Nations Convention on Contracts for the Sales of Goods shall not apply to this limited warranty or the sale of products covered by this limited warranty.

- THERE ARE NO EXPRESS WARRANTIES EXCEPT AS LISTED.
- PURCHASER ASSUMES ALL RISKS IN THE ASSEMBLY AND OPERATION OF THIS UNIT.
- FAILURE TO FOLLOW WARNINGS AND OPERATIONAL INSTRUCTIONS CONTAINED IN THIS MANUAL CAN RESULT IN SEVERE PROPERTY DAMAGE AND/OR PERSONAL INJURY.
- IN NO EVENT WILL WELL TRAVELED LIVING, OR ITS DIRECTORS, OFFICERS OR AGENTS BE LIABLE TO THE PURCHASER OR ANY THIRD PARTY, WHETHER IN CONTRACT, IN TORT, OR ON ANY OTHER BASIS, FOR ANY INDIRECT, SPECIAL, PUNITIVE, EXEMPLARY, CONSEQUENTIAL, OR INCIDENTAL LOSS, COST, OR DAMAGE ARISING OUT OF OR IN CONNECTION WITH THE SALE, MAINTENANCE, USE, OR INABILITY TO USE THE PRODUCT, EVEN IF WELL TRAVELED LIVING OR ITS DIRECTORS, OFFICERS OR AGENTS HAVE BEEN ADVISED OF THE POSSIBILITY OF SUCH LOSSES, COSTS OR DAMAGES, OR IF SUCH LOSSES, COSTS, OR DAMAGES ARE FORESEEABLE. IN NO EVENT WILL WELL TRAVELED LIVING, OR ITS OFFICERS, DIRECTORS, OR AGENTS BE LIABLE FOR ANY DIRECT LOSSES, COSTS OR DAMAGES THAT EXCEED THE PURCHASE PRICE OF THE PRODUCT.
- SOME JURISDICTIONS DO NOT ALLOW THE EXCLUSION OR LIMITATION OF INCIDENTAL OR CONSEQUENTIAL DAMAGES, SO THE ABOVE LIMITATION OR EXCLUSION MAY NOT APPLY TO THE PURCHASER.

## EXTEND YOUR WARRANTY

When you purchase a Fire Sense or Balkene Home product from any authorized retailer, you'll have peace of mind in knowing that it comes with a one-year warranty. Extend your warranty for *an additional year* when you review your item at [balkenehome.com](http://balkenehome.com) within 365 days of purchase.



### Important Notice

Do NOT return to place of purchase—for customer service and warranty issues:

Call toll-free  
Email  
Live chat

**(866) 985-7877**  
**[cservice@welltraveled.net](mailto:cservice@welltraveled.net)**  
**[balkenehome.com](http://balkenehome.com)**

9 am – 9 pm, EST

9 am – 6 pm, EST, Mon – Fri

Distributed by:

Well Traveled Living  
716 S 8th Street, Amelia Island, FL 32034  
[balkenehome.com](http://balkenehome.com)  
[cservice@welltraveled.net](mailto:cservice@welltraveled.net)  
(866) 985-7877