



Human friendly

EV Charger Adapter (TESLA to J1772) User Manual



IP55



Qualify 2ton
Drive Over



Flame Retardant
94-V0



Withstand Voltage
2000V



Other test are compliant according
to UL2251 SAE J1772 standard



No-load Plug
>10000 Times

Please read all instructions before use

EV Smart Charger Adapter

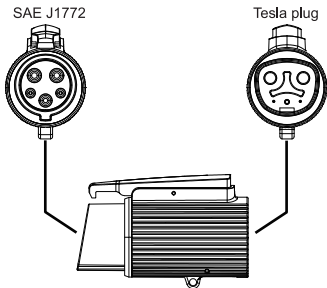

Lock and open the Tesla charger plug

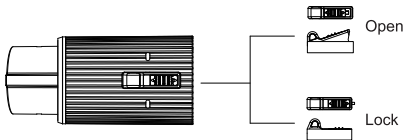

Product Information

Voltage	Max 240V AC
Current	Max 60A
Applicable charging station	TESLA DESTINATION CHARGER TESLA MOBILE CONNECTOR
Applicable electric vehicle	EV with J1772 charging interface
Protection level	IP55
Working temperature	-31°F to +122°F
Mechanical life	No load plug in / pull out >10000 times
Impact of external forces	Qualify 1m drop or 2 Ton vehicle run over

Important Note

1. Ensure the output current doesn't over 60A when using Tesla Destination Chargers.
2. Allow up 30 seconds to pass after connecting the adapter to Tesla Charger before connecting your EV with J1772 charging interface.
3. Please note that the output port of Tesla charging pile is tightly connected with the charger adapter.
4. The above charging power is for reference only, and the actual power is related to the charging pile you choose, as well as the specifications of your vehicle and the ambient temperature.
5. To stop charging, please unlock the car's display screen or the mobile APP, do not unplug the charging gun directly.

Instruction

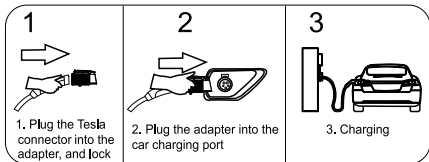

Clean the adapter only when it is disconnected by using a damp cloth. Please do not use water or chemicals when cleaning the adapter.

If your electronics vehicle isn't recognized to show charging, pls don't be anxious, pls Start your engine and then turn it off again.

Compatible Connector (Tesla)

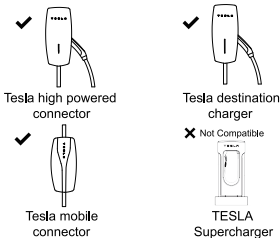

Compatible Models (Non-Tesla EV)

Audi	e-tron, e-tron Sportback
BMW	5 Series 530e, X5 xDrive40e, i3, ix3
Chevrolet	Bolt EV, EUV, Volt
Chrysler	Pacifica
Fiat	500e, 500
Ford	C-Max Energi, Fusion Energi, Mustang March-E
Honda	Clarity Electric, Clarity PHEV
Hyundai	Ioniq Electric, Kona Electric, Ioniq 5, Ioniq 6
Jaguar	I-PACE
KIA	Niro PHEV, EV6, Niro EV
Mitsubishi	Outlander PHEV
Nissan	LEAF, LEAF S, LEAF S PLUS
Porsche	Cayenne S E-Hybrid, Taycan
Subaru	Crosstrek Hybrid
Toyota	Prius Prime, RAV4 Prime, Mirai
Volkswagen	E-Golf, ID3 & ID4, ID6
Mercedes-benz	EQS Series
Other brands	Other J1772-compliant EVs

WARNINGS

- Please do not use the adapter if it is defective (racked frayed, broken or damaged in any means).
- Please do not insert the adapter if any electrical outlet is wet or dirty. -Please do not try to disassemble the sheil or any part of the adapter. It will cause damages to the item and thus cause serious resious results when charging.
- Accordingly to your charging device and vehicle, the power rate is backwards compliant, yet couldn't handle higher power rate, which will cause temperature rise and charging shutdown.
- Please handle the adapter with care. Do not drop or step on it.

