



Human friendly

USB-C Bidirectional Switch User Manual

Thank you for choosing Unitek USB-C Bi-Direction Switch. Please read the user manual carefully before use and save them. If you need any help, please contact our professional customer service team at: support_us@unitek-products.com

Product Overview

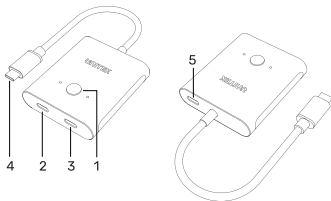

- ① Key Switch
- ② Input or Output: USB Type C Female(USB-C 1)
- ③ Input or Output: USB Type C Female(USB-C 2)
- ④ Input or Output: USB Type C Male(USB-C)
- ⑤ Power: USB-C Female(DC/5V)

Two In One Out

Two hosts share one display.

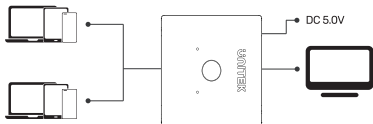

One In Two Out

One host switch between two displays or USB-C 10Gbps data ports.
Two downstream ports cannot function simultaneously.

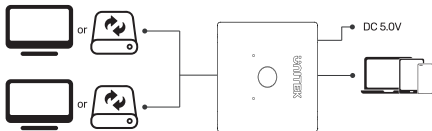

Function

1. USB-Type C bi-directional switcher, support two into one out, one into two out bi-directional switching.
2. Support USB-C DP Alt Mode bidirectional switching , up to 8K60Hz resolution transmission.
3. Support USB PD 100W transmission, PD power output lossless switching.
- 4.Support USB 10Gbps data transmission, two-way switching devices (does not support Thunderbolt peripheral data transmission, Thunderbolt for PCIe signals).
5. One key switching, convenient for users to choose between 2 in1out and 1 in 2 out for use.

6. A wide range of application scenarios, full-featured bidirectional switching, more options for switching between USB Type hosts and devices.

7. Status indication LEDs:

- a. White LED indicator
- b. When switching to the corresponding interface, the corresponding LED lights up.

Technical Data

Compatibility	USB-C port (not compatible with Thunderbolt)
System requirements (PC, Laptop, Phone & Tablet)	<ul style="list-style-type: none">• iPad or Android Phone with full-featured USB-C.• Windows XP or later ver.• Mac OS X or later ver.• Linux
USB specification	USB 10Gbps

Q&A

Why can't my TV or monitor reach 8K@60Hz resolution?

A: Please make sure that the host device supports DP1.4 alt mode and the display device needs to support HDMI2.1 protocol in order to output 8K@60Hz HD resolution.

Why can't my cell phone/computer or tablet device connect to the product and output the video screen normally?

A: Please confirm the host device, you need to confirm whether the device's Type C port supports video output, some electronic devices' Type C port only supports data and charging function (please refer to the product brand's official website for the

device's related parameters and specifications).

Why is the speed slow when reading and writing data?

A: This product has been rigorously tested, the normal read and write state of the hard disk read and write speed can reach the USB3.2 (10Gbps) standard transmission speed. If the read/write speed is slow, please make sure that the USB port/storage device/data cable connected to the host computer is up to the 10Gbps version. In addition some 10Gbps M.2 hard disk enclosure, it is not recommended to use a long cable to connect this product, because too long cable will affect the 10Gbps signal transmission, it is recommended to use 20-30cm cable to connect the M.2 hard disk enclosure.

Package Content

1 x USB-C Bi-Direction Switch

1 x USB A to C Cable 1m

2 x USB C to C Cable 1m

Warranty

The Unitek USB-C Bi-Direction Switch is covered by Unitek warranty for 24 months. If the product fails due to manufacturer defects, please contact us by email at:

support_us@unitek-products.com

