

Perimeter Series Range Hoods EMS9018 Spec Sheet

FOTILE

A BREATH OF FRESH ENGINEERING®

FOTILE EMS9018 Perimeter Vent Range hood is powerful and has a modern canopy design. Wall mountable, this powerful certified Range Hood offers superior smoke, grease, and odor extraction due to its large Capture Shield and M Shape Canopy. Best of all, this powerful range hood not only offers excellent venting performance, it is also exceptionally quiet so you can have a casual conversation as you are preparing a meal. Available in Stainless Steel.



Key Features



Capture Shield Technology to
Actively Absorb Smoke



Auto Turbo Mode for Quick Extra
Power



97% Odor Reduction Rate &
92% Grease Separation Rate



Covers 7.2 ft² of Cooking Area
(5-6 Burners)

Secondary Features

- Auto Delay Shutoff
Extracts Lingering Odors After You Are Done
Cooking
- Powerful LED Light
Lights Up Your Cooktop
- Large Oil Collection Cup
Detachable and Easy to Clean
- Detachable Capture Shield
Easy to Clean

Perimeter Series Range Hoods EMS9018 Spec Sheet

FOTILE

A BREATH OF FRESH ENGINEERING®

Specifications Table

Model	EMS9018
Certification	ETL, HVI, CEC
Width(inch)	35 7/16
Packing-Box Size(WxDxH)(inch)	40 * 28 * 25
Installation	Wall Mount
Speed Setting	2+Turbo (stays on for 5 sec.)
CFM(HVI)	350 / 460*
Max Static Pressure(Pa)	500
Power Supply(V/Hz)	120/60
Noise Level(sones)	2.1 / 3.6*
Noise Level(dB)	43.78 / 49.83 / 56.63
Illumination(W)	2W (LED)
Motor	AC Motor
Operation Type	Touch
Delay Shutoff	2/5/10min
Screen Lock	Y
Grease Filtration Rate	92%
Odor Reduction Rate	97%
Warranty	Labor: 2 Years Parts: 5 Years(Limited) Motors: Lifetime Limited Warranty

*Due to HVI's testing method, the Turbo Mode/Max Power level of EMS9018 can not be tested.

Installation Dimensions

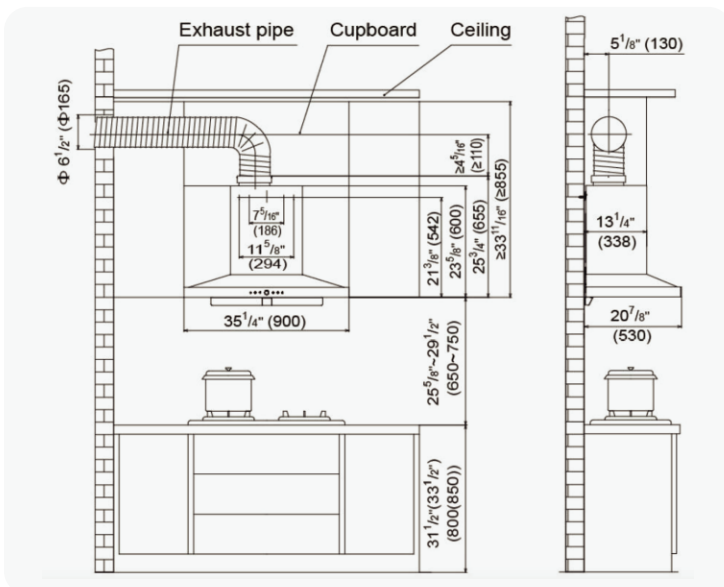

Installation Examples

